

First Floor Plan

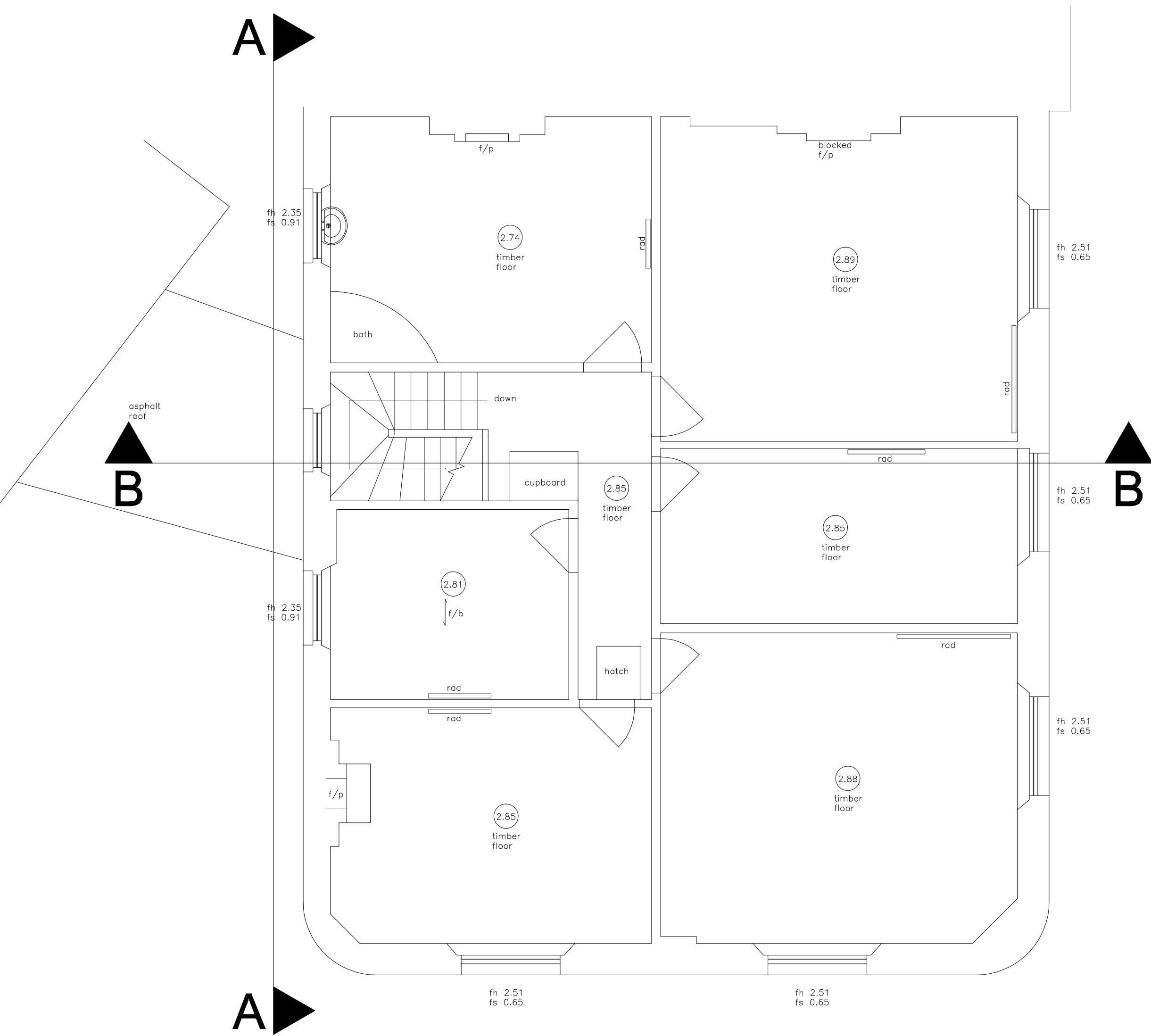

Second Floor Plan

Subject to:
Planning and Highways
Redline based on Title No. 312503
Any easements, covenants and contractual agreements restricting, limiting or preventing potential development of the site to be brought to the immediate attention of jsa architects.

Revision A : Section line B added 25-02-10

■ Criterion Asset Management
■ The Murray Arms (PH), Camden
■ Existing FF + 2nd Plans

■ Project CMAC
■ Dwg No/rev. PL-203 A
■ Scale 1/50@A1
■ Date JAN 10