

SECOND FLOOR PLAN.

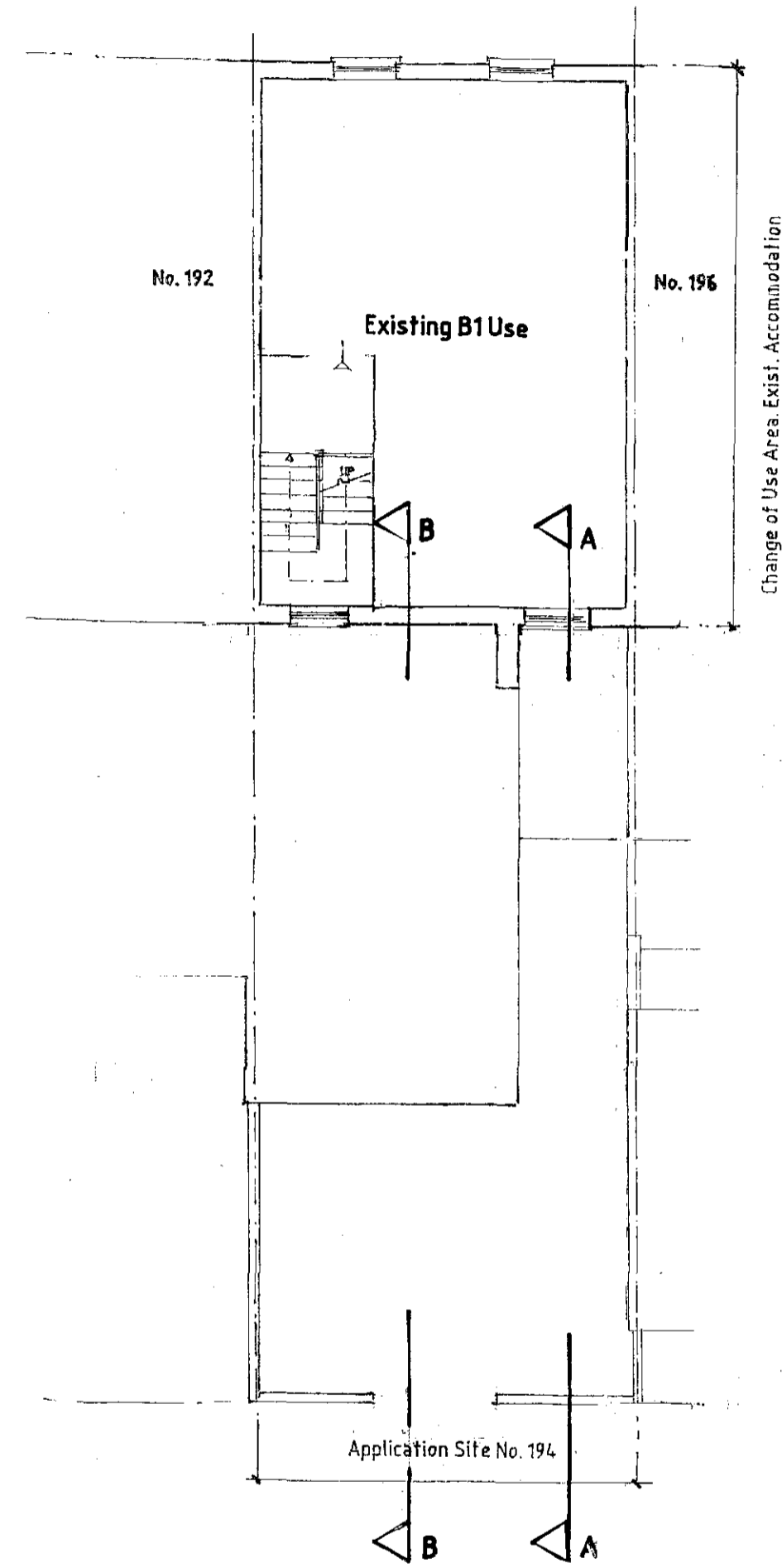

3rd. FLOOR PLAN

General Notes

No.	Revision/Issue	Date

**Direct Planning Limited**

Town Planning Consultants and Architects, Established, 1988

Riverbank House 95/97 High Street Tel: 01689 875999  
 St. Mary Cray Orpington, Kent Fax: 01689 875599  
 BR5 3NH Email: enquiries@directplanning.co.uk

Client **Mr. Malik Sadik**

Project  
**PROPOSED NEW RESIDENTIAL ACCOM.  
 194, KILLBURN HIGH ROAD  
 ACCOM. AS EXISTING**

Drwg. Title  
**SECOND AND THIRD FLOOR PLANS**

Scale **1/100 at A2** Date **JANUARY 2010**

Project/Drwg. No. **DP/1245./ 8**