

**PLAN OF FRONT LIGHTWELL 1:20
LOWER GROUND FLOOR LEVEL**

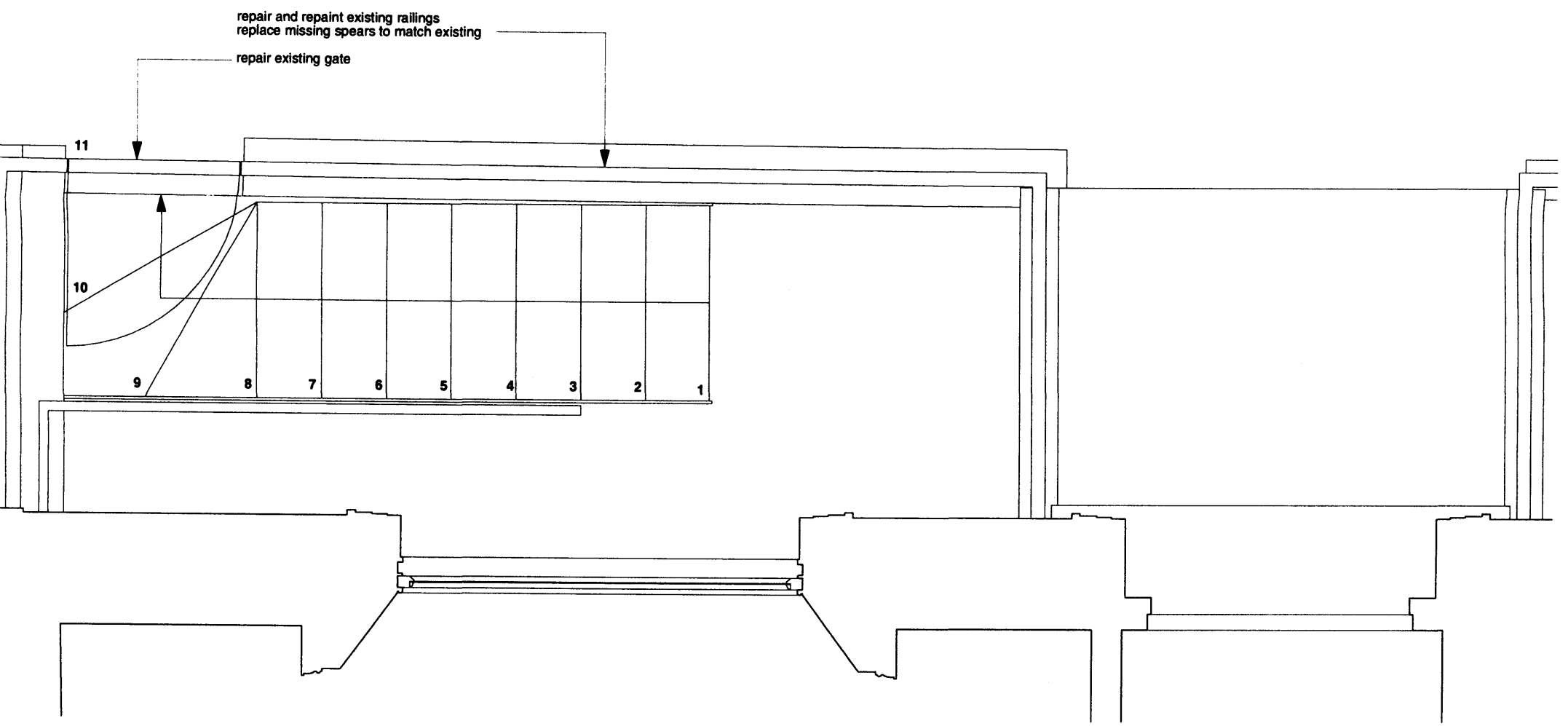

**PLAN OF FRONT LIGHTWELL 1:20
GROUND FLOOR LEVEL**

stair stringer 200 x 10 mm mild steel flat
 6 mm thick non-slip solid 'Durbar' pattern treads with welded 10 mm dia rod
 in compliance with building regulations
 handrail to be convex 35 x 10 mm mild steel solid bar
 handrail standards to be welded 10 x 10 mm solid mild steel rod

JOB: 92 ALBERT STREET LONDON NW1 7NE	
DRG. TITLE : NEW EXTERNAL STAIRS PROPOSED PLAN	
DRG. NO: 95-119/P.22	
SCALE: 1:20 @ A3	DATE: DEC 2009
REVISION:	
READING + WEST ARCHITECTS LLP 30 NOTTINGHAM PLACE LONDON W1U 5NP TEL: 020 7486 2048 FAX: 020 7486 2148 info@readingandwest.co.uk www.readingandwest.co.uk	

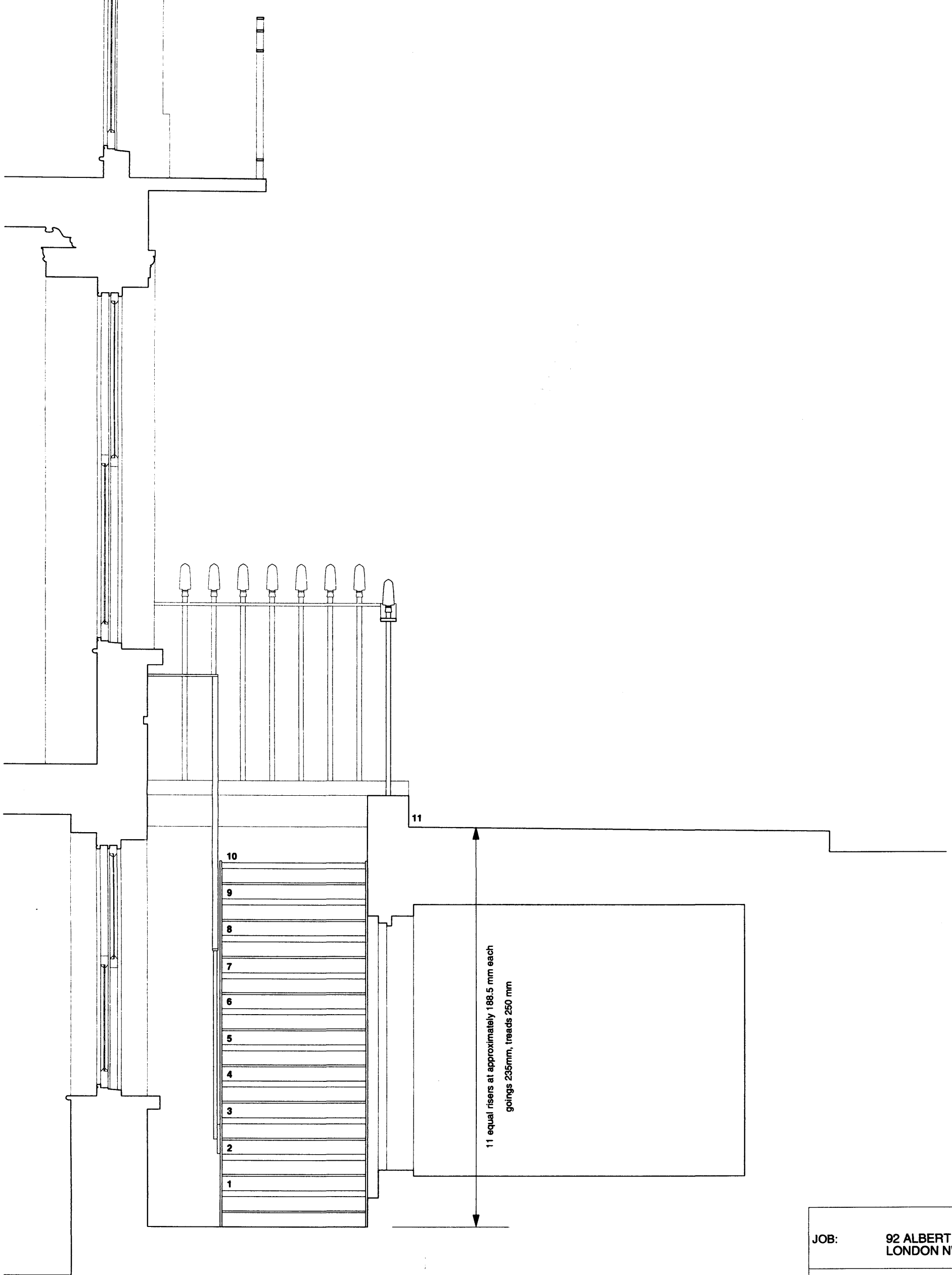

**SECTION THRO' FRONT LIGHTWELL 1:20
ELEVATION OF NEW EXTERNAL STAIR**

stair stringer 200 x 10 mm mild steel flat

6 mm thick non-slip solid 'Durbar' pattern treads with welded 10 mm dia rod
in compliance with building regulations

handrail to be convex 35 x 10 mm mild steel solid bar
handrail standards to be welded 10 x 10 mm solid mild steel rod

JOB: 92 ALBERT STREET LONDON NW1 7NE	
DRG. TITLE : NEW EXTERNAL STAIRS PROPOSED ELEVATION	
DRG. NO: 95-119/P.23	
SCALE: 1:20 @ A3	DATE: DEC 2009
REVISION:	
READING + WEST ARCHITECTS LLP 30 NOTTINGHAM PLACE LONDON W1U 5NP TEL: 020 7486 2048 FAX: 020 7486 2148 info@readingandwest.co.uk www.readingandwest.co.uk	



**SECTION THRO' FRONT LIGHTWELL 1:20
SECTION THRO' NEW EXTERNAL STAIR**

stair stringer 200 x 10 mm mild steel flat
 6 mm thick non-slip solid 'Durbar' pattern treads with welded 10 mm dia rod
 in compliance with building regulations
 handrail to be convex 35 x 10 mm mild steel solid bar
 handrail standards to be welded 10 x 10 mm solid mild steel rod

JOB: 92 ALBERT STREET LONDON NW1 7NE	
DRG. TITLE : NEW EXTERNAL STAIRS PROPOSED SECTION	
DRG. NO: 95-119/P.24	
SCALE: 1:20 @ A3	DATE: DEC 2009
REVISION:	
READING + WEST ARCHITECTS LLP 30 NOTTINGHAM PLACE LONDON W1U 5NP TEL: 020 7486 2048 FAX: 020 7486 2148 info@readingandwest.co.uk www.readingandwest.co.uk	

stair stringer 200 x 10 mm mild steel flat

6 mm thick non-slip solid 'Durbar' pattern treads with welded 10 mm dia rod
in compliance with building regulations

all mild steel to be galvanized and painted

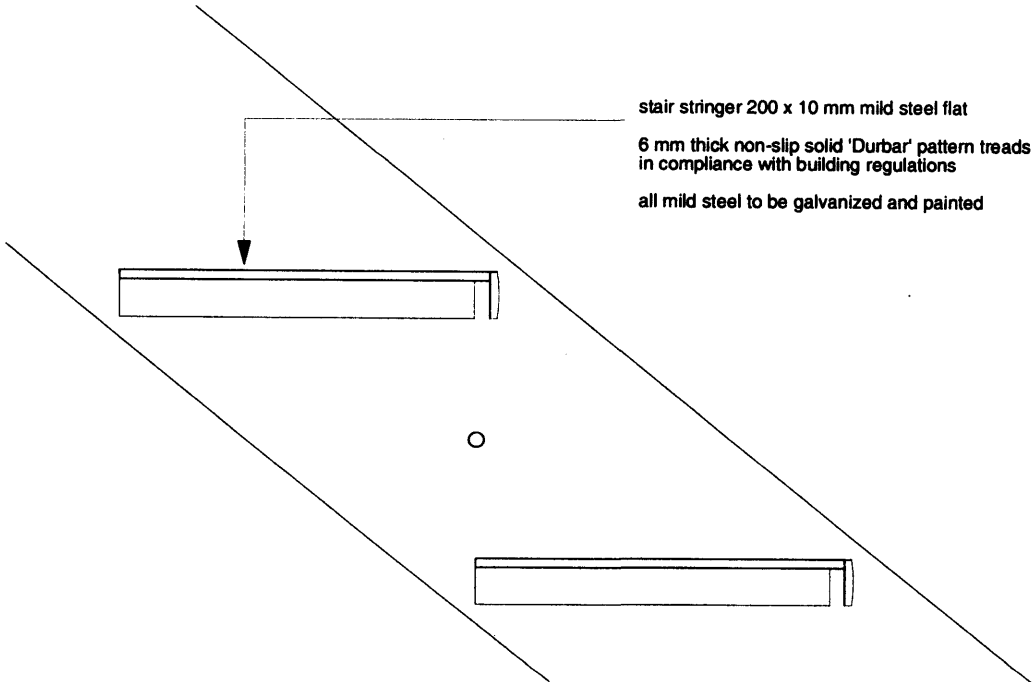

DETAIL OF STAIR TREADS 1:2

existing gate in railings repaired

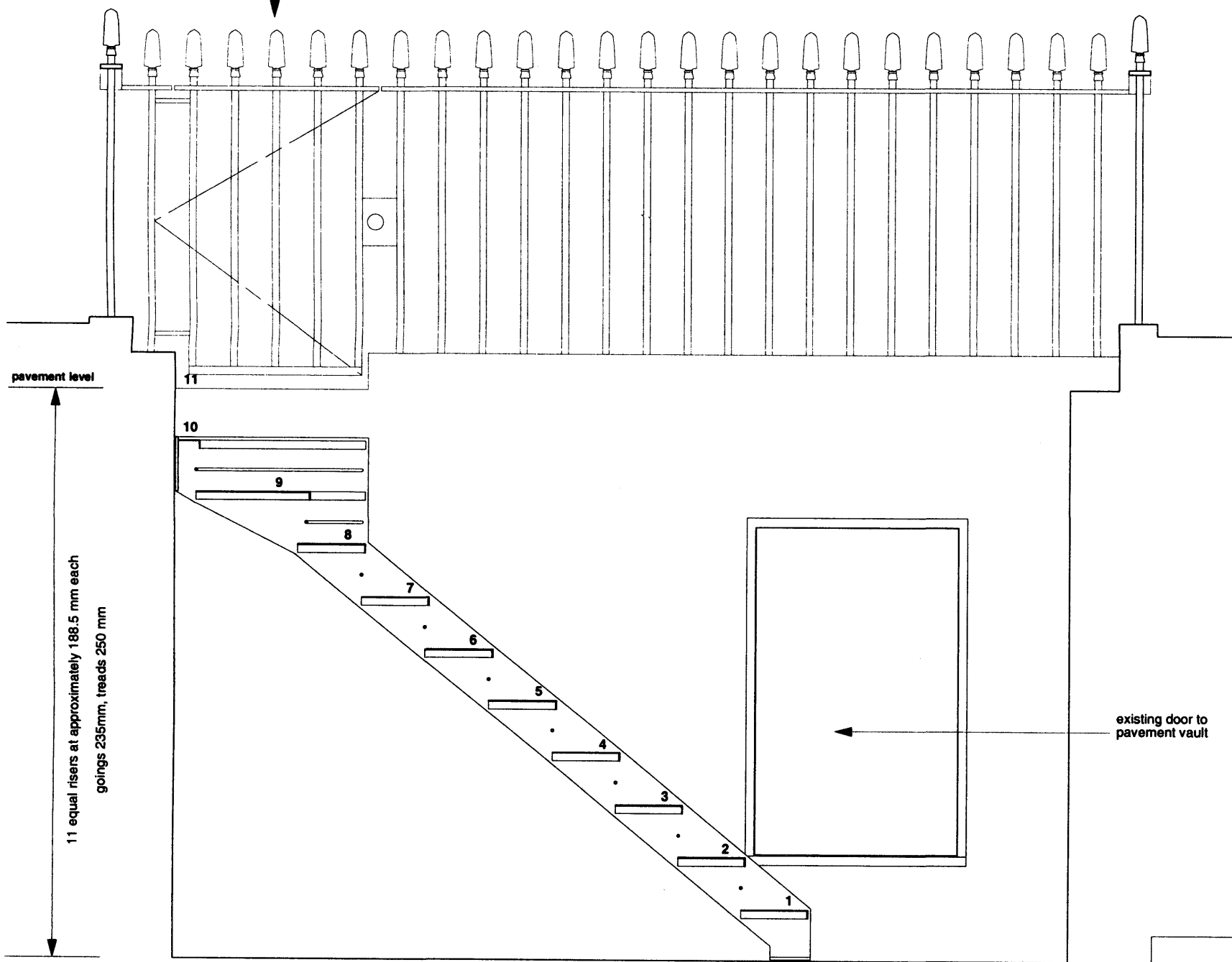

**SECTION THRO' FRONT LIGHTWELL 1:20
SECTION THRO' NEW EXTERNAL STAIR**

stair stringer 200 x 10 mm mild steel flat

6 mm thick non-slip solid 'Durbar' pattern treads with welded 10 mm dia rod
in compliance with building regulations

handrail to be convex 35 x 10 mm mild steel solid bar
handrail standards to be welded 10 x 10 mm solid mild steel rod

JOB:	92 ALBERT STREET LONDON NW1 7NE											
DRG. TITLE :	NEW EXTERNAL STAIRS PROPOSED SECTION AND DETAIL OF TREADS											
DRG. NO:	95-119/P.25											
SCALE:	1:20/1:2 @ A3	DATE: DEC 2009										
REVISION:	<table border="1"> <tr> <td> </td> <td> </td> <td> </td> <td> </td> <td> </td> <td> </td> <td> </td> <td> </td> <td> </td> <td> </td> </tr> </table>											
READING + WEST ARCHITECTS LLP 30 NOTTINGHAM PLACE LONDON W1U 5NP TEL: 020 7486 2048 FAX: 020 7486 2148 info@readingandwest.co.uk www.readingandwest.co.uk												