

2010/1294/T
2010/1323/T.

Treework Contractors and Consultants
R. G. Usher – Director of Arboriculture

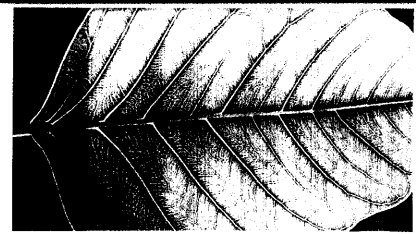

I M S (Ushers) Ltd
Arboriculture

1st March 2010
Ref: 008845

Mr K Fisher - Planning Department
London Borough of Camden
Planning Services
Town Hall
Argyle Street
London WC1H 8ND

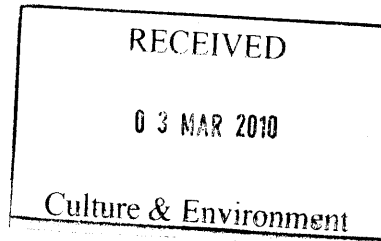

5 Pond Close, Walkern
Road
Stevenage, Herts. SG1 3QP
t 01438 727-252
f 01438 351-335

Email
amy.p@imsushers.co.uk

Dear Mr Fisher

NOTICE OF INTENT

Re: Tree work at Coram Community Campus, 49 Mecklenburgh Square, Camden, London, WC1N 2QA

We have been contracted to carry out tree work at the above site.

Please confirm by return fax whether or not this is in a conservation area or if there are any TPO's on the trees in question.

If so then the specification for works is as per attached schedule.

If you require any further information please do not hesitate to contact me at the office. Otherwise I will expect to hear from you within the due statutory six-week period.

Your urgent response would be greatly appreciated.

Yours sincerely

Amy Pennington
IMS (Ushers) Ltd

Enc:



Planning Services
Camden Town Hall
Argyle Street
London WC1H 8EQ

Email (enquiries only): env.devcon@camden.gov.uk
Telephone : 020 7974 1911
Fax : 020 7974 5713

For office use
Date
Payee
App. No. Fee

Application for tree works: works to trees subject to a tree preservation order (TPO)
and/or notification of proposed works to trees in a conservation area.

Town and Country Planning Act 1990

Publication of applications on planning authority websites

Please note that the information provided on this application form and in supporting documents may be published on the Authority's website. If you require any further clarification, please contact the Authority's planning department.

Please complete using block capitals and black ink.

You must use this form if you are applying for work to trees protected by a tree preservation order (TPO). (You may also use it to give notice of works to trees in a conservation area).

It is important that you read the accompanying guidance notes before filling in the form. Without the correct information, your application / notice cannot proceed.

1. Applicant Name and Address

Title:	<input type="text"/>	First name:	<input type="text"/>
Last name:	<input type="text"/>		
Company (optional):	<input type="text"/>		
Unit:	<input type="text"/>	House number:	<input type="text"/>
		House suffix:	<input type="text"/>
House name:	<input type="text"/>		
Address 1:	<input type="text"/>		
Address 2:	<input type="text"/>		
Address 3:	<input type="text"/>		
Town:	<input type="text"/>		
County:	<input type="text"/>		
Country:	<input type="text"/>		
Postcode:	<input type="text"/>		

2. Agent Name and Address

Title:	<input type="text" value="MISS"/>	First name:	<input type="text" value="AMY"/>
Last name:	<input type="text" value="PENNINGTON"/>		
Company (optional):	<input type="text" value="IMS (USHERS) LTD"/>		
Unit:	<input type="text" value="5"/>	House number:	<input type="text"/>
		House suffix:	<input type="text"/>
House name:	<input type="text"/>		
Address 1:	<input type="text" value="POND CLOSE"/>		
Address 2:	<input type="text" value="WALKERN ROAD"/>		
Address 3:	<input type="text"/>		
Town:	<input type="text" value="STEVENAGE"/>		
County:	<input type="text" value="HERTS"/>		
Country:	<input type="text"/>		
Postcode:	<input type="text" value="SG1 3QP"/>		

3. Trees Location

If all trees stand at the address shown in Question 1, go to Question 4. Otherwise, please provide the full address/location of the site where the tree(s) stand (including full postcode where available)

Unit:	<input type="text"/>	House number:	<input type="text" value="49"/>	House suffix:	<input type="text"/>
House name:	<input type="text"/>				
Address 1:	<input type="text" value="CORAM COMMUNITY CAMPUS"/>				
Address 2:	<input type="text" value="MECKLENBURGH SQUARE"/>				
Address 3:	<input type="text" value="CAMDEN"/>				
Town:	<input type="text" value="LONDON"/>				
County:	<input type="text"/>				
Postcode (if known):	<input type="text" value="WC1N2QA"/>				

If the location is unclear or there is not a full postal address, either describe as clearly as possible where it is (for example, 'Land to the rear of 12 to 18 High Street' or 'Woodland adjoining Elm Road') or provide an Ordnance Survey grid reference:

Description:

4. Trees Ownership

Is the applicant the owner of the tree(s): ☐ Yes ☒ No
If 'No' please provide the address of the owner (if known and if different from the trees location)

Title:	<input type="text"/>	First name:	<input type="text"/>		
Last name:	<input type="text"/>				
Company (optional):	<input type="text"/>				
Unit:	<input type="text"/>	House number:	<input type="text" value="49"/>	House suffix:	<input type="text"/>
House name:	<input type="text"/>				
Address 1:	<input type="text" value="CORAM COMMUNITY CAMPUS"/>				
Address 2:	<input type="text" value="MECKLENBURGH SQUARE"/>				
Address 3:	<input type="text" value="CAMDEN"/>				
Town:	<input type="text" value="LONDON"/>				
County:	<input type="text"/>				
Country:	<input type="text"/>				
Postcode:	<input type="text" value="WC1N2QA"/>				

Telephone numbers

Country code:	National number:	Extension number:
<input type="text"/>	<input type="text"/>	<input type="text"/>
Country code:	Mobile number (optional):	
<input type="text"/>	<input type="text"/>	
Country code:	Fax number (optional):	
<input type="text"/>	<input type="text"/>	

Email address (optional):

5. What Are You Applying For?

Are you seeking consent for works to tree(s) subject to a TPO? ☒ Yes ☒ No

Are you wishing to carry out works to tree(s) in a conservation area? ☒ Yes ☒ No

6. Tree Preservation Order Details

If you know which TPO protects the tree(s), enter its title or number below.

7. Identification Of Tree(s) And Description Of Works

Please identify the tree(s) and provide a full and clear specification of the works you want to carry out. Continue on a separate sheet if necessary. You might find it useful to contact an arborist (tree surgeon) for help with defining appropriate work. Where trees are protected by a TPO, please number them as shown in the First Schedule to the TPO where this is available. Use the same numbers on your sketch plan (see guidance notes).

Please provide the following information below : tree species (and the number used on the sketch plan) and description of works. Where trees are protected by a TPO you must also provide reasons for the work and, where trees are being felled, please give your proposals for planting replacement trees (including quantity, species, position and size) or reasons for not wanting to replant.

E.g. Oak (T3) - fell because of excessive shading and low amenity value. Replant with 1 standard ash in the same place.

PLEASE SEE ATTACHED SPEC

7. Identification Of Tree(s) And Description Of Works continued ...

8. Trees - Additional Information

Additional information may be attached to electronic communications or provided separately in paper format.

For all trees

A sketch plan clearly showing the position of trees listed in Question 7 must be provided when applying for works to trees covered by a TPO. A sketch plan is also advised when notifying the LPA of works to trees in a conservation area (see guidance notes). It would also be helpful if you provided details of any advice given on site by an LPA officer.

For works to trees covered by a TPO

Please indicate whether the reasons for carrying out the proposed works include any of the following. If so, your application must be accompanied by the necessary evidence to support your proposals. (See guidance notes for further details)

1. **Condition of the tree(s)** - e.g. it is diseased or you have fears that it might break or fall: ☐ Yes ☒ No
If YES, you are required to provide written arboricultural advice or other diagnostic information from an appropriate expert.

2. **Alleged damage to property** - e.g. subsidence or damage to drains or drives. ☐ Yes ☒ No
If YES, you are required to provide for:

Subsidence

A report by an engineer or surveyor, to include a description of damage, vegetation, monitoring data, soil, roots and repair proposals. Also a report from an arboriculturist to support the tree work proposals.

Other structural damage (e.g. drains, walls and hard surfaces)

Written technical evidence from an appropriate expert, including description of damage and possible solutions.

Documents and plans (for any tree)

Are you providing separate information (e.g. an additional schedule of work for Question 7)? ☐ Yes ☒ No

If YES, please provide the reference numbers of plans, documents, professional reports, photographs etc in support of your application. If they are being provided separately from this form, please detail how they are being submitted.

9. Application For Tree Works - Checklist

Only one copy of the application form and additional information (Question 8) is required. Please use the guidance and this checklist to make sure that this form has been completed correctly and that all relevant information is submitted. Please note that failure to supply precise and detailed information may result in your application being rejected or delayed. You do not need to fill out this section, but it may help you to submit a valid form.

Sketch Plan

- A sketch plan showing the location of all trees (see Question 8)



For all trees

(see Question 7)

- Clear identification of the trees concerned
- A full and clear specification of the works to be carried out



For works to trees protected by a TPO

(see Question 8)

Have you:

- stated reasons for the proposed works?
- provided evidence in support of the stated reasons? in particular:
 - if your reasons relate to the condition of the tree(s) - written evidence from an appropriate expert
 - if you are alleging subsidence damage - a report by an appropriate engineer or surveyor and one from an arboriculturist.
 - in respect of other structural damage - written technical evidence
- included all other information listed in Question 8?



10. Declaration - Trees

I/we hereby apply for consent/give notice for tree work as described in this form and the accompanying plans and additional information.

Signed - Applicant:

Or signed - Agent:

A.PENNINGTON

Date (DD/MM/YYYY):

01.03.10

(This date must not be before the date of sending or hand-delivery of the form)

11. Applicant Contact Details

Telephone numbers

Country code:	National number:	Extension number:
<input type="text"/>	<input type="text"/>	<input type="text"/>

Country code:	Mobile number (optional):
<input type="text"/>	<input type="text"/>

Country code:	Fax number (optional):
<input type="text"/>	<input type="text"/>

Email address (optional):

12. Agent Contact Details

Telephone numbers

Country code:	National number:	Extension number:
<input type="text"/>	<input type="text"/>	<input type="text"/>

Country code:	Mobile number (optional):
<input type="text"/>	<input type="text"/>

Country code:	Fax number (optional):
<input type="text"/>	<input type="text"/>

Email address (optional):

Electronic communication - If you submit this form by fax or e-mail the LPA may communicate with you in the same manner.

(Please see guidance notes)

Work Instruction-planning

26 February 2010

Mohamed Chakour
Coram Family
Coram Community Campus
49 Mecklenburgh Square
London, WC1N 2QA

I M S (Ushers) Ltd
Arboriculture

5 Pond Close, Walkern Road
Stevenage, Herts. SG1 3QP
t: 01438 727 252 f: 01438 351 335

Amy Pennington

Email: amy.p@imsushers.co.uk



Quotation No: 008845
Estimator: Rod Usher
Work date:

Site Address: Coram Community Campus, 49 Mecklenburgh Square, Camden, London, WC1N 2QA

Site Contact: Mohamed Chakour Tel: 07984 344532

Client Contact: Tel: Mob: 07984 344532 Fax: 0207 520 0301

JOB DESCRIPTION

**URGENT WORK AT COLLINGHAM GARDEN NURSERY AREA
TREES AS PER ENCLOSED PLAN**

T1 = MULTI-STEM SYCAMORE this tree has been badly burnt by a tent underneath catching on fire, it has suffered severe bark scorch and there is a large volume of deadwood in the crown
some of this is now falling out. I have advised the nursery manager to take of the drip line of the tree to prevent children and staff entering that area, we advise reduce crown 40%, removing all deadwood and fire damaged branches
T2 = MATURE ASH heavy deadwood in crown some of which is now falling out on to the play area beneath, we advise - clean through crown removing deadwood

I inspected all the trees within the Coram Family site, and those located within Collingham Garden Site (leased from the London Borough of Camden)

We have dealt with the remainng part of the Collingham Garden Site and the trees located at Coram Family as part of the routine maintenance which our company has been carrying out on this site for the last 10 years.

Remainder of the Collingham Garden Site see enclosed sketch plan.

Trees numbered as per enclosed sketch.

T1 = recently reduce LIME - NO WORK REQUIRED

T2 = recently pruned LIME - NO WORK REQUIRED

T3 = recently pruned SYCAMORE - NO WORK REQUIRED

T4 = MATURE SYCAMORE large deadwood in crown, we advice, clean through crown removing deadwood

T5 = AILANTHUS - NO WORK REQUIRED

T6 = SYCAMORE poor tree with no room to develop - fell as close as possible to ground level

T7 = ELDER overgrown, breaking up - reduce crown 30%, prune to shape and tidy up

NB: A further quote referring to routine maintenance work at Coram Cummunity Campus will be with you shortly.

TEAM

Arrival time	Departure time	Completed?

Please note any of the following that are relevant to this job:

- the trees done (name and number on the map)
- new instructions from the client
- special requirements for the next site visit
- any incidents to vehicles, persons or property
- any other information about this job that would be helpful

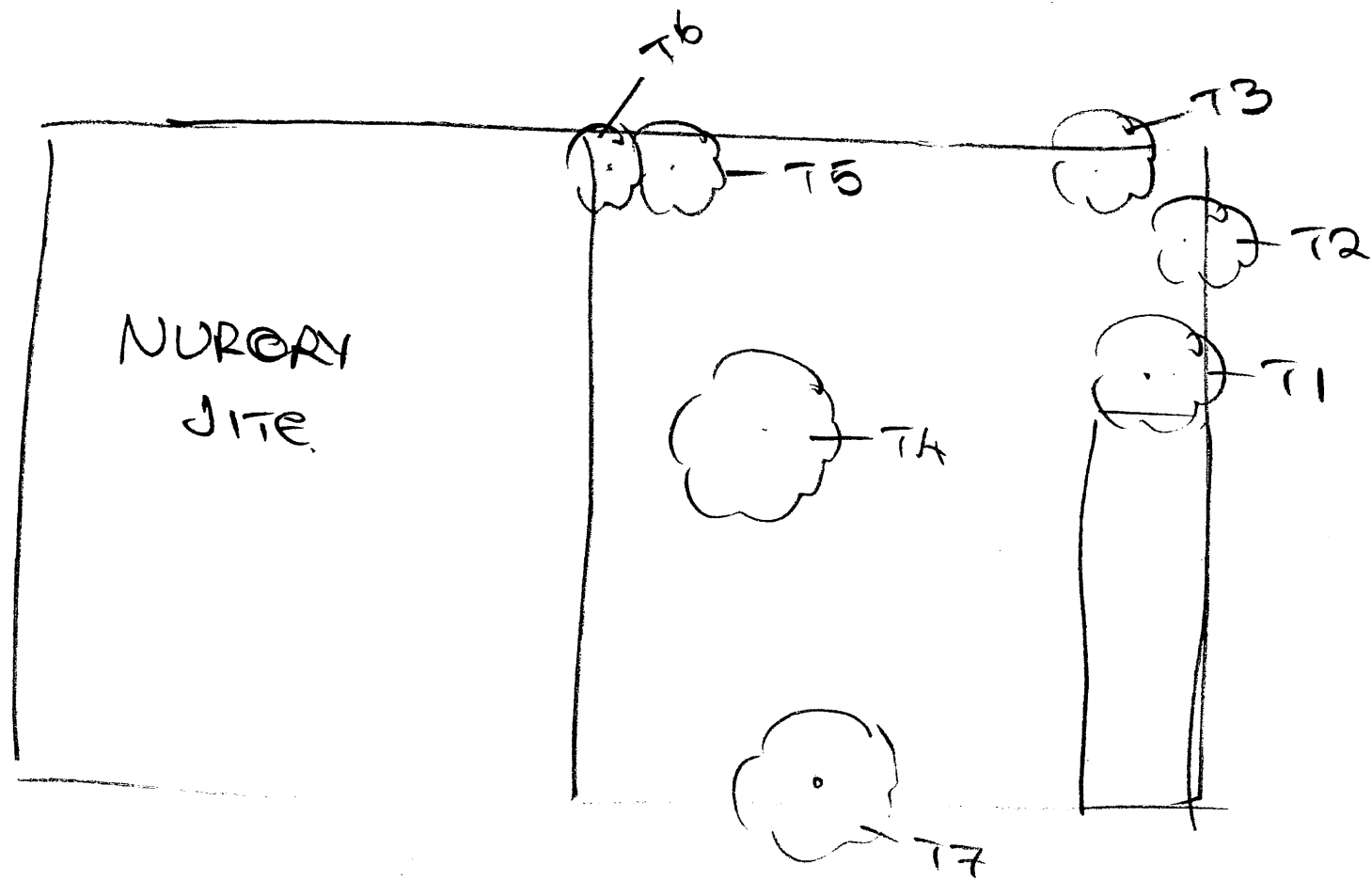

CAR
DORK.

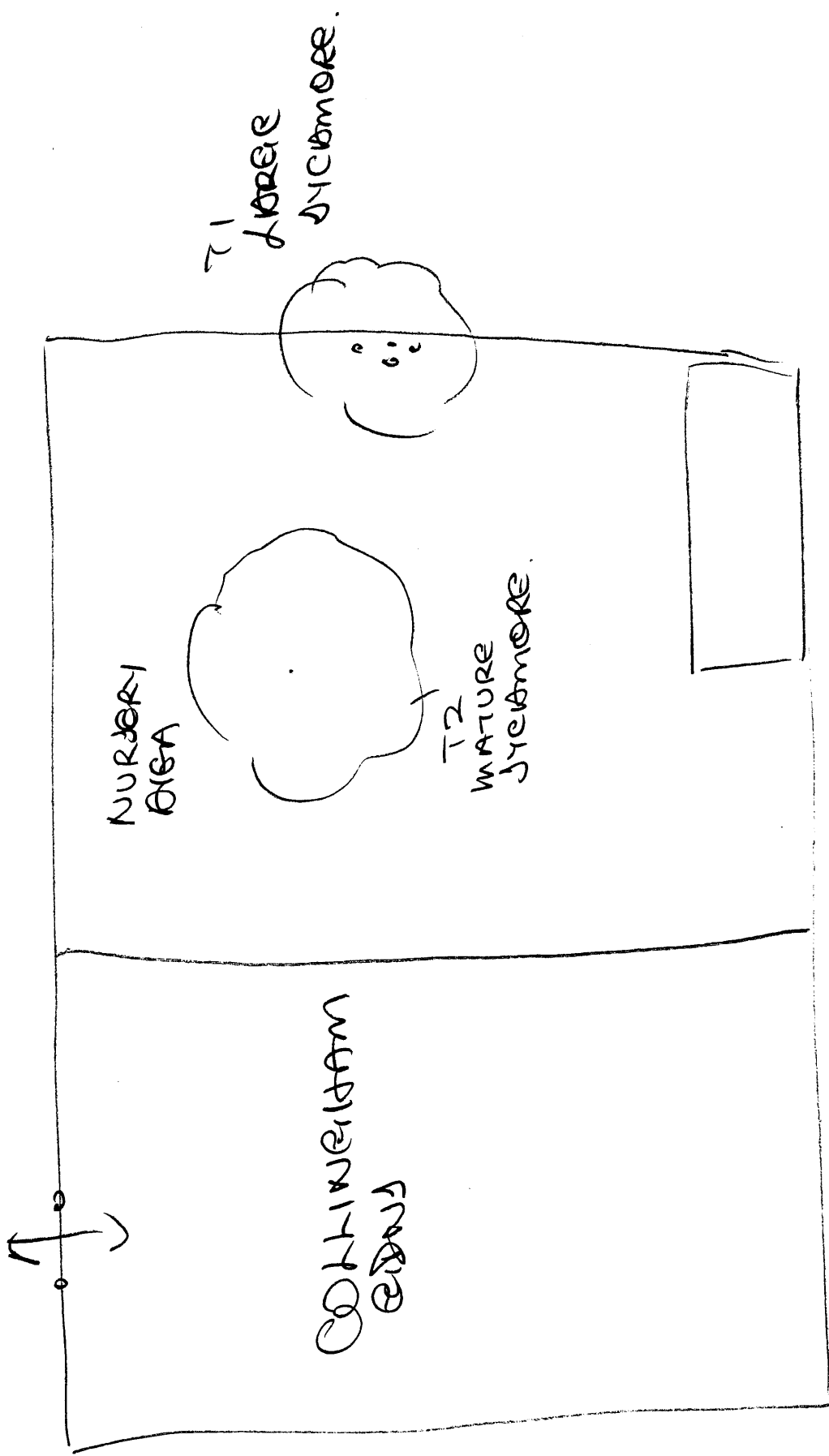

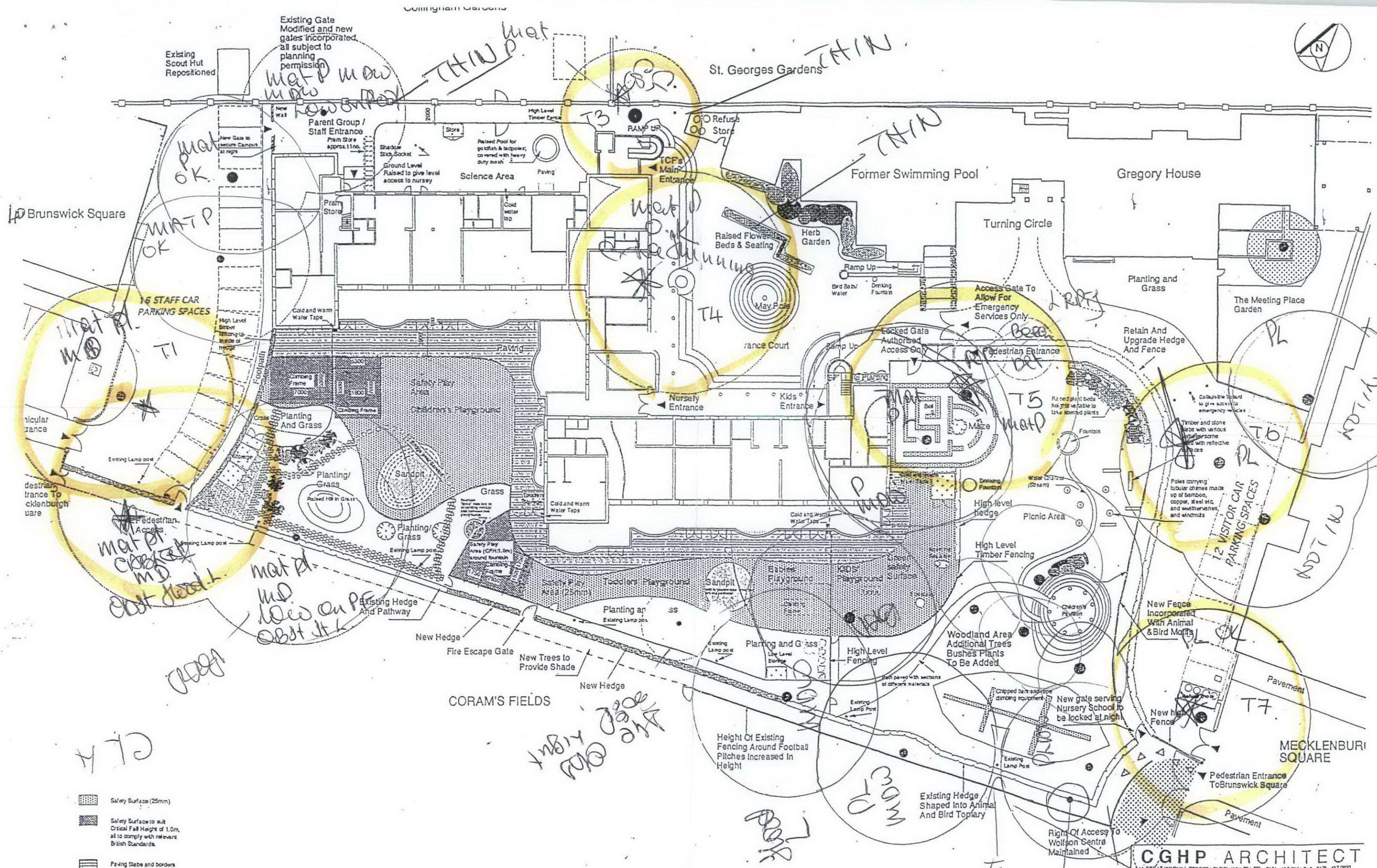

0 2 4 6 8 10m
SCALE

CGHP ARCHITECT
AT GREAT WINDMILL STREET LONDON W1V 7PA TEL: 0171-439 0254 FAX: 0171-437 0000

CLIENT : THOMAS CORAM FOUNDATIO
JOB TITLE : CHILDRENS CENTRE
DRAWING : LANDSCAPING FEASIBILITY

SCALE : 1:400 DATE : APR '98
DWG No : 529/98/h REV : D 07.5.98

Rev. D-27.05.98 - Footpath to north of fenced wall (boundary of site) and access to the site moved to south of fenced wall. T1 and T2 moved to Nursery Playground. T3 moved to Parent's Centre garden. T4 moved to Nursery. T5 moved to Nursery. T6 moved to Nursery. T7 moved to Nursery. T8 moved to Nursery. T9 moved to Nursery. T10 moved to Nursery. T11 moved to Nursery. T12 moved to Nursery. T13 moved to Nursery. T14 moved to Nursery. T15 moved to Nursery. T16 moved to Nursery. T17 moved to Nursery. T18 moved to Nursery. T19 moved to Nursery. T20 moved to Nursery. T21 moved to Nursery. T22 moved to Nursery. T23 moved to Nursery. T24 moved to Nursery. T25 moved to Nursery. T26 moved to Nursery. T27 moved to Nursery. T28 moved to Nursery. T29 moved to Nursery. T30 moved to Nursery. T31 moved to Nursery. T32 moved to Nursery. T33 moved to Nursery. T34 moved to Nursery. T35 moved to Nursery. T36 moved to Nursery. T37 moved to Nursery. T38 moved to Nursery. T39 moved to Nursery. T40 moved to Nursery. T41 moved to Nursery. T42 moved to Nursery. T43 moved to Nursery. T44 moved to Nursery. T45 moved to Nursery. T46 moved to Nursery. T47 moved to Nursery. T48 moved to Nursery. T49 moved to Nursery. T50 moved to Nursery. T51 moved to Nursery. T52 moved to Nursery. T53 moved to Nursery. T54 moved to Nursery. T55 moved to Nursery. T56 moved to Nursery. T57 moved to Nursery. T58 moved to Nursery. T59 moved to Nursery. T60 moved to Nursery. T61 moved to Nursery. T62 moved to Nursery. T63 moved to Nursery. T64 moved to Nursery. T65 moved to Nursery. T66 moved to Nursery. T67 moved to Nursery. T68 moved to Nursery. T69 moved to Nursery. T70 moved to Nursery. T71 moved to Nursery. T72 moved to Nursery. T73 moved to Nursery. T74 moved to Nursery. T75 moved to Nursery. T76 moved to Nursery. T77 moved to Nursery. T78 moved to Nursery. T79 moved to Nursery. T80 moved to Nursery. T81 moved to Nursery. T82 moved to Nursery. T83 moved to Nursery. T84 moved to Nursery. T85 moved to Nursery. T86 moved to Nursery. T87 moved to Nursery. T88 moved to Nursery. T89 moved to Nursery. T90 moved to Nursery. T91 moved to Nursery. T92 moved to Nursery. T93 moved to Nursery. T94 moved to Nursery. T95 moved to Nursery. T96 moved to Nursery. T97 moved to Nursery. T98 moved to Nursery. T99 moved to Nursery. T100 moved to Nursery.