

## NOTES

Do not scale off this drawing.  
All dimensions to be checked on site



Hawthorn Tree approx 6m tall, trunk girth of approx 150mm  
To be removed

Hawthorn

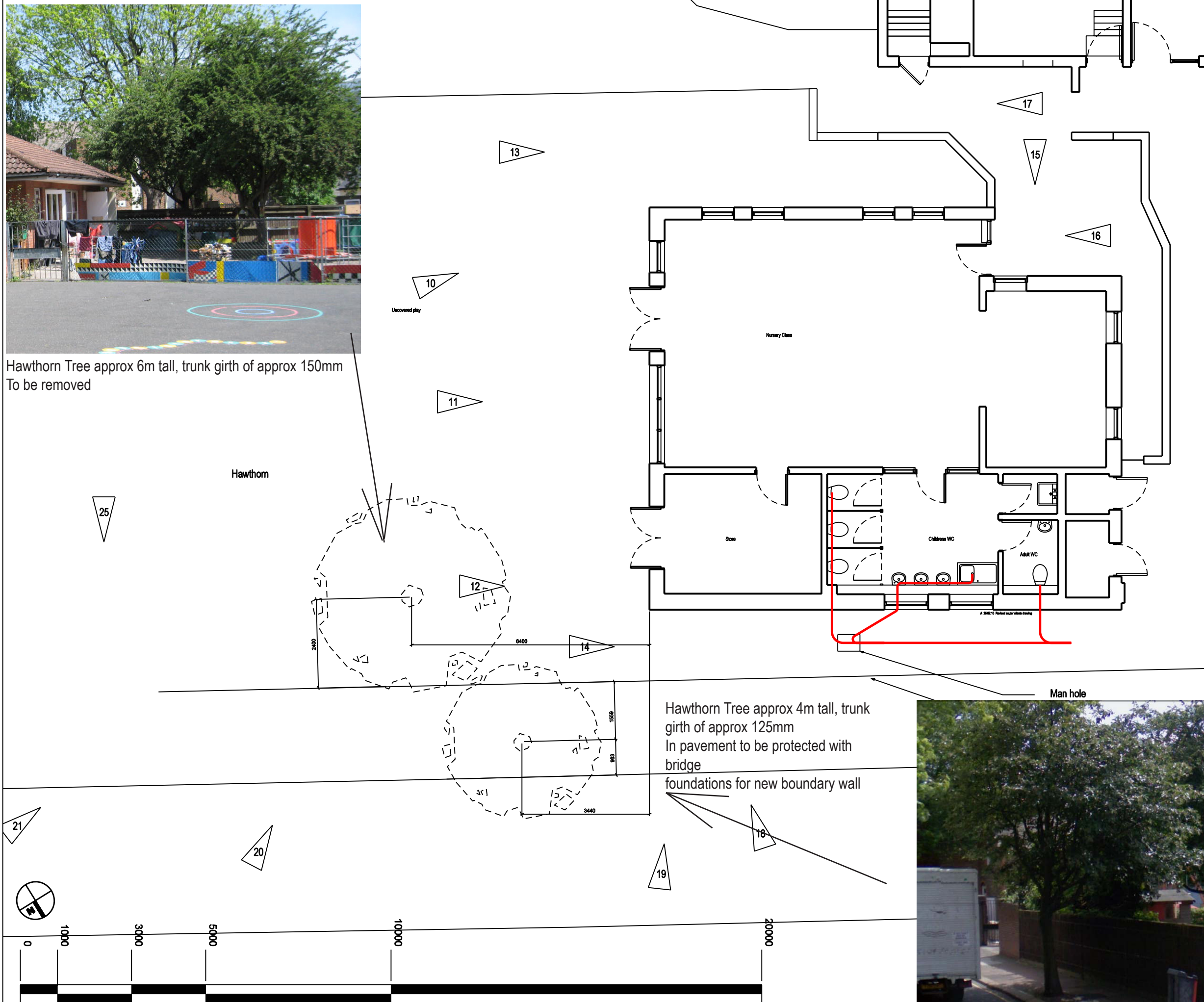

Hawthorn Tree approx 4m tall, trunk girth of approx 125mm  
In pavement to be protected with bridge  
foundations for new boundary wall

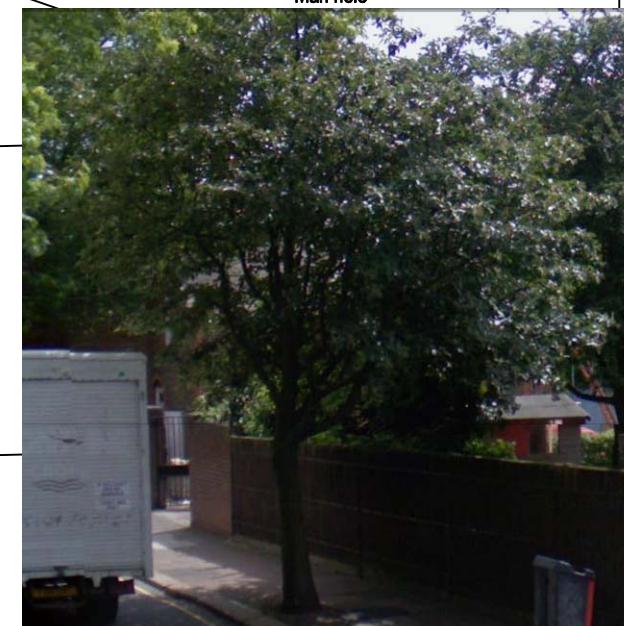

Stage D Presentation



**ultra violet**  
DESIGNERS ARCHITECTS  
16-24 underwood street  
london n1 7jq  
t 020 7490 3387 f 020 7490 8236  
mail@uv architects.co.uk

TITLE: Tree Survey  
SCALE: n/a  
DATE: 21st January 2010

Tree Survey