

RECEIVED  
12 APR 2010

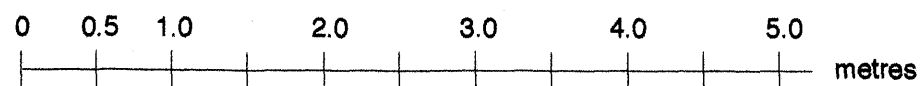
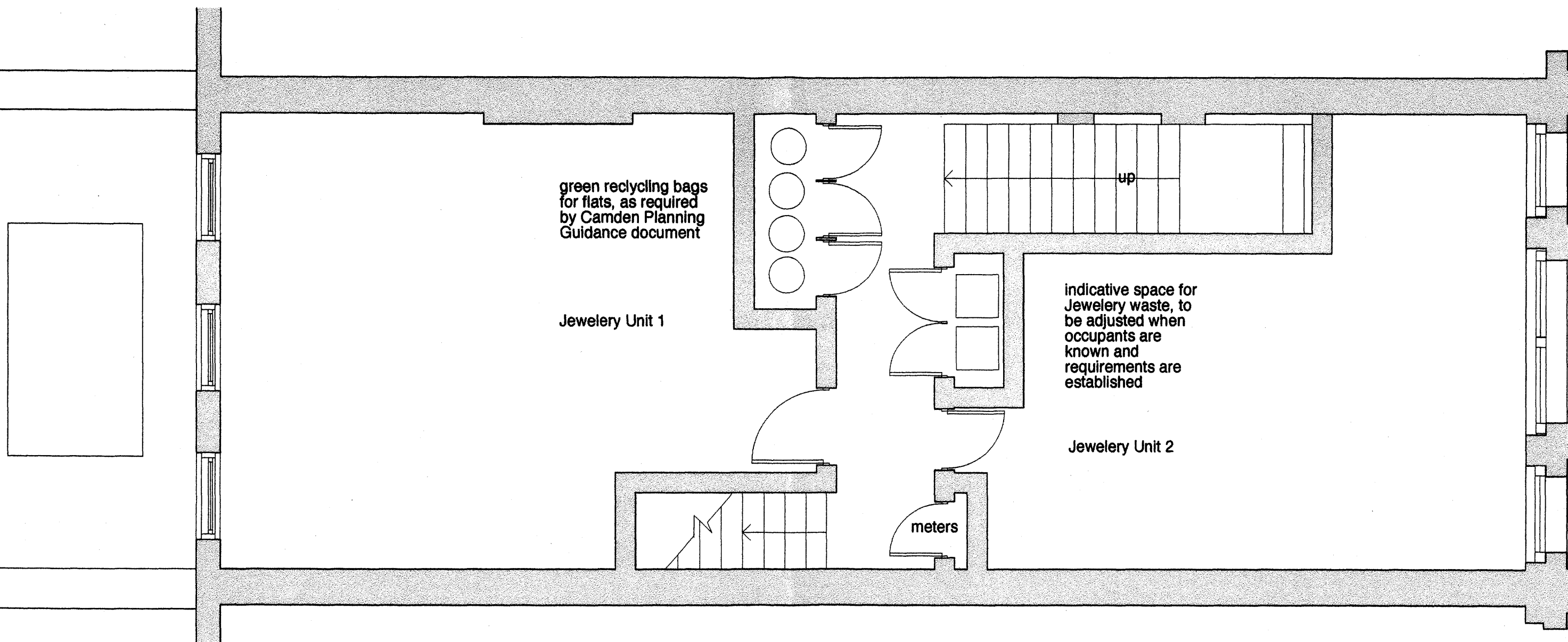

		Revisions	Note: Print A3 1. Separate consent will be sought for extract ductwork & equipment if required by jewellery unit tenants when tenancies have been agreed.	project	45 Farringdon Road EC1	Trips Architects Corner House, High Street, Wrotham, Kent TN15 7AD tel: 01732 789667 e-mail: info@tripsarchitects.co.uk	Scale	1: 50
				drawing	Proposed First Floor		Date	June 2009