

EXISTING FLOORBOARDS TAKEN UP
FOR INSERTION OF INSULATION AND
PIPEWORK, THEN RELAID OVER

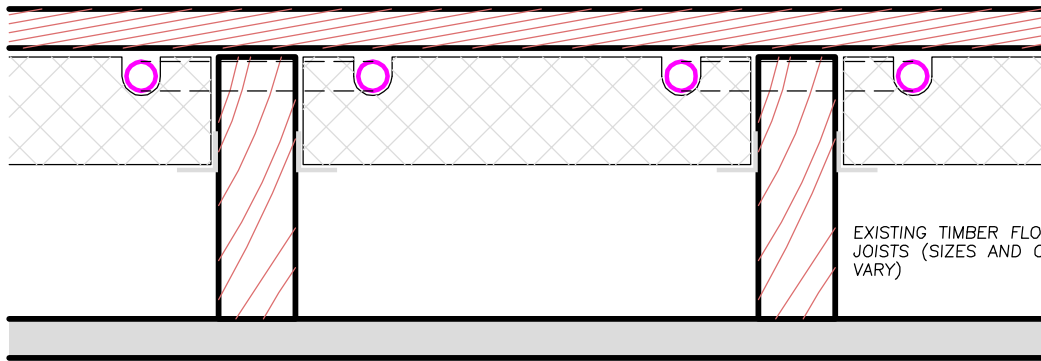

FLEXIBLE PIPEWORK
LAID INTO GROOVED
INSULATION BOARDS
FITTED ONTO PLASTIC
SUPPORTS FIXED TO
JOISTS

EXISTING TIMBER FLOOR
JOISTS (SIZES AND CENTRES
VARY)

CEILING PLASTERWORK NOT
AFFECTED BY WORKS

SECTION 1:5

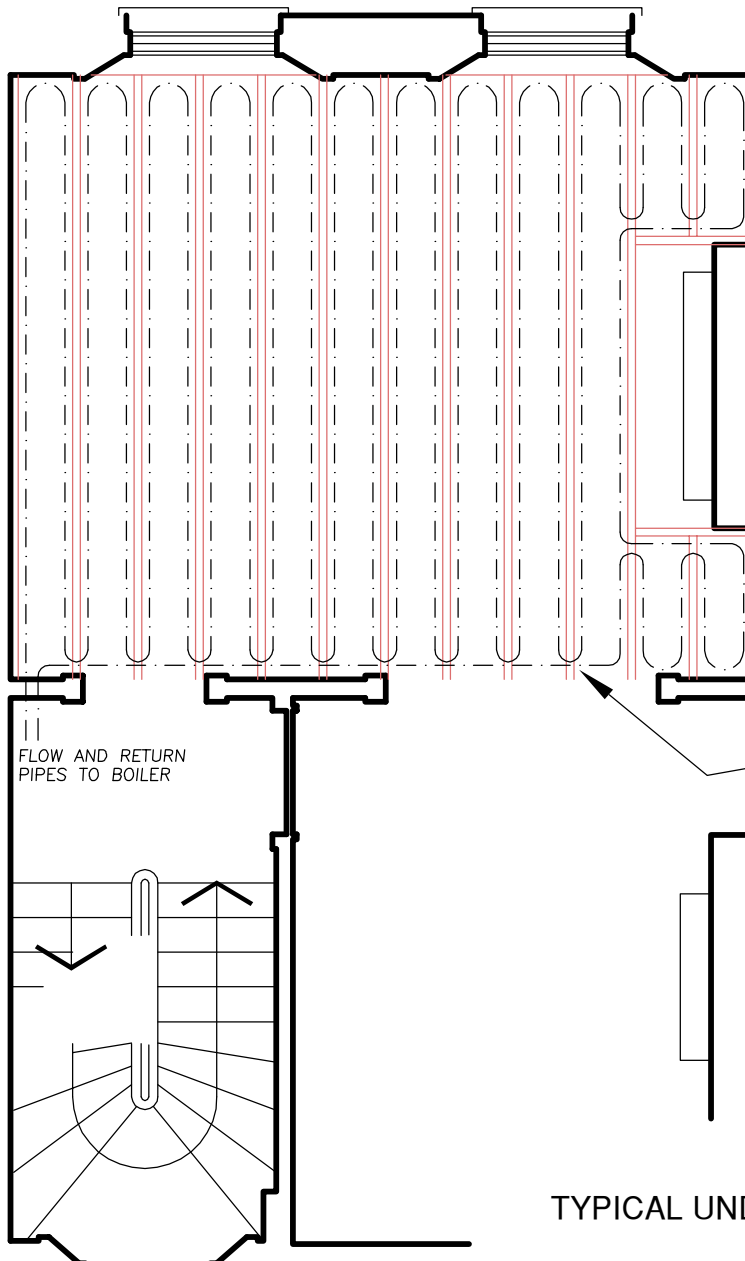

UNDERFLOOR HEATING PIPEWORK
LAYOUT COORDINATED WITH
EXISTING FLOOR JOISTS

FLOW AND RETURN
PIPES TO BOILER

PIPE LOOPS NOTCHED
THROUGH JOIST ENDS
EXTENT OF NOTCHING
SIMILAR (OR LESS) THAN
WOULD ARISE FROM
RADIATOR PIPEWORK
INSTALLATION

PROPOSED



TYPICAL UNDERFLOOR HEATING TO TIMBER FLOOR
3 CHAMBERLAIN STREET
STEPHEN BRANDES ARCHITECTS
SCALE 1:5 & 1:50 @ A4

PLAN 1:50

JAN 2010
526 LB 112