

Proposed Scheme: Visual Privacy and Overlooking

The proposed scheme will very significantly reduce overlooking and increase privacy between 48B and all its neighbors. This is achieved by changing the form and layout of the house on the site:

- The windows to the primary habitable rooms are now very largely located along the front and back elevation. This is a more conventional and appropriate arrangement which will lessen overlooking.
- The demolition of the present half extension to 48B will remove oblique overlooking between

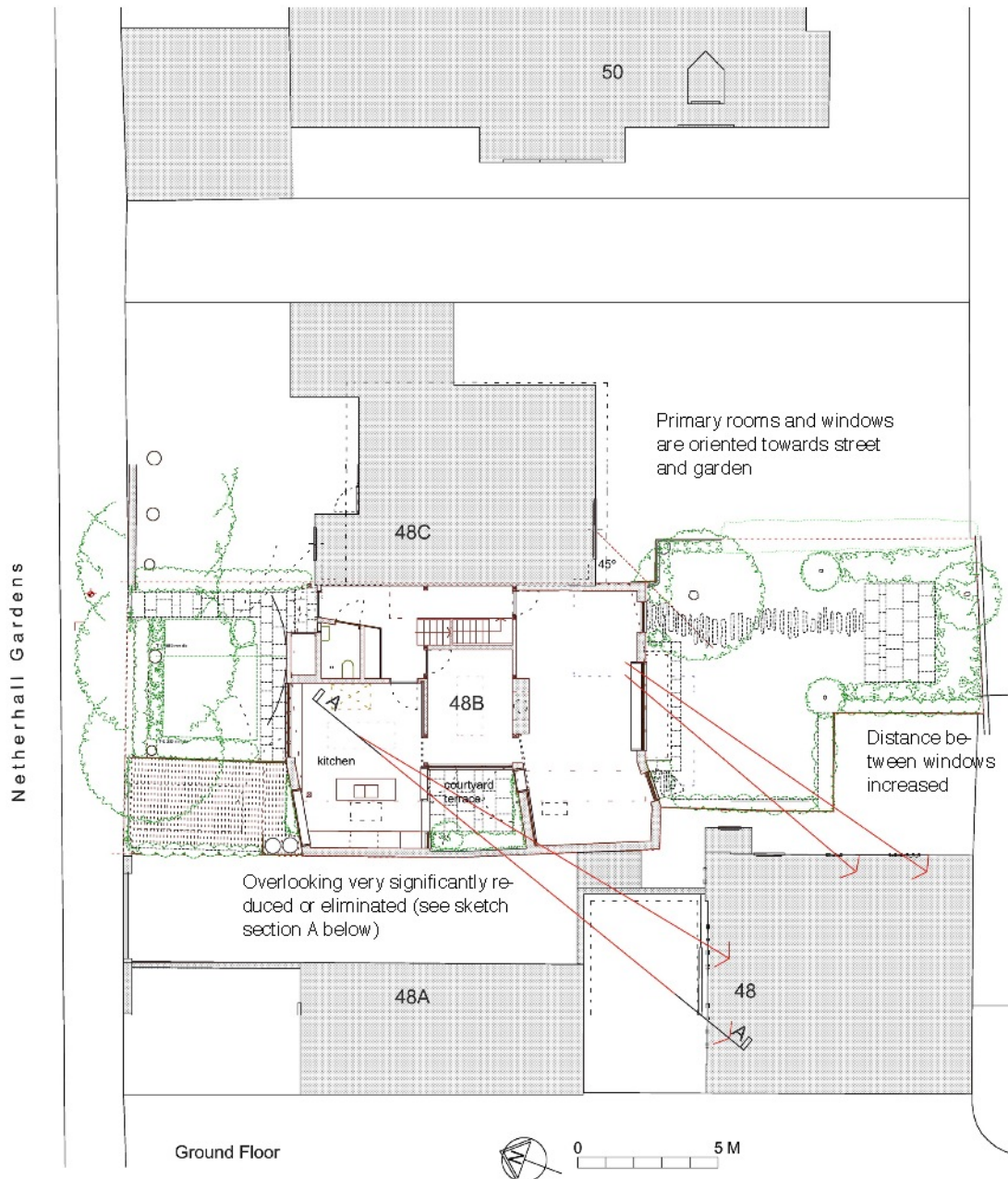

Proposed Ground Floor Plan