

Existing Booking Hall Key Plan
N.T.S.

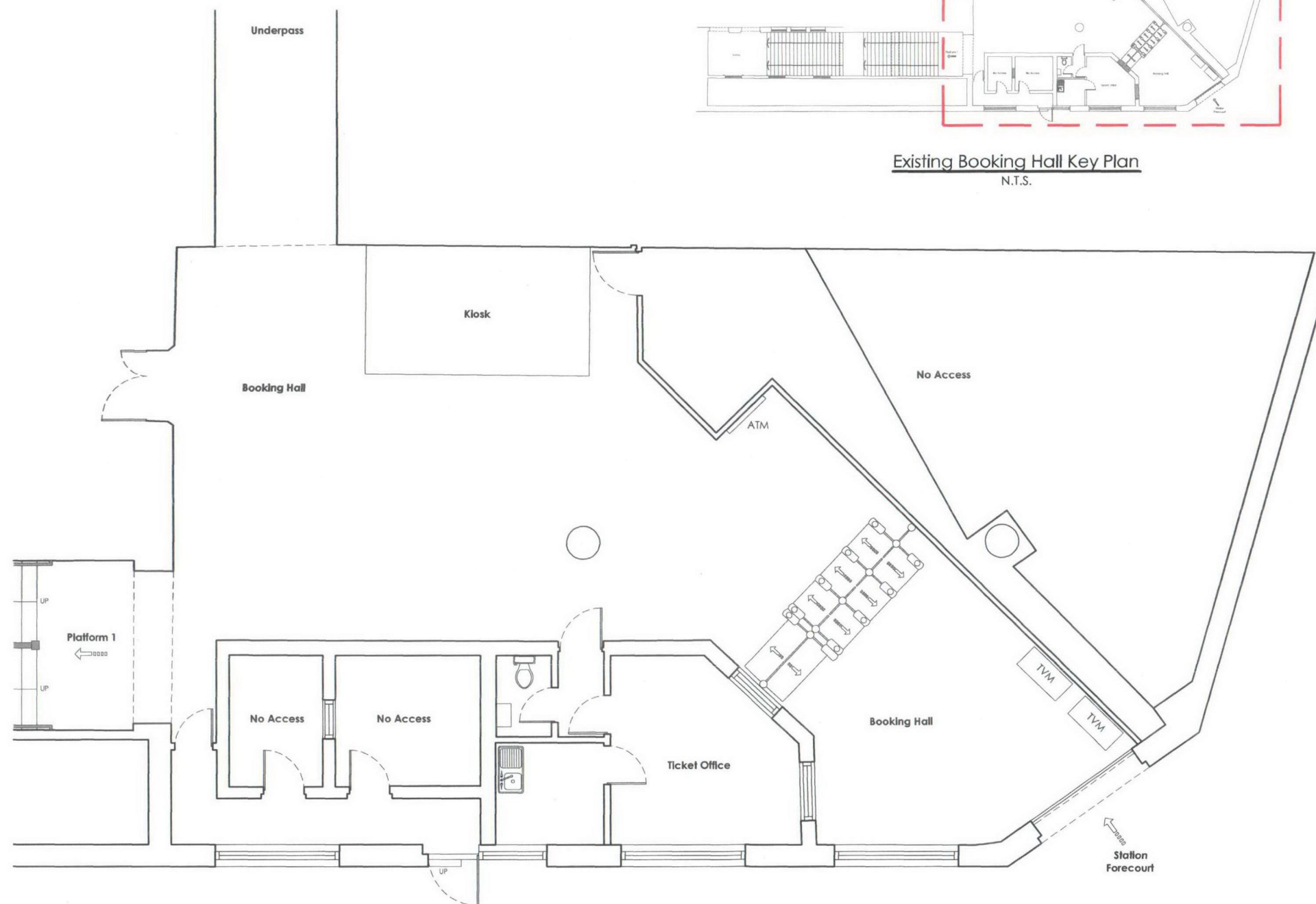

Existing Booking Hall Plan

- general notes
1. This drawing is the copyright of GCP Rail Ltd, and should not be reproduced without prior written approval.
 2. This drawing is to be read in conjunction with all relevant Drawings, Specifications, and Contract Documents.
 3. This drawing must only be reproduced in colour.
 4. All dimensions in millimetres (mm) and all levels are in metres (m). Do not scale from this drawing.
 5. For Standard notes used on Civil/Architectural (Ambience Works) drawings, refer to Drawing No. STD-PAD-P-110-5-01. For Standard notes used on the Electrical (Ambience Works) drawings, refer to Drawing No. STD-EL-E-110-5-01.
 6. For Symbols and Abbreviations used on the Civil/Architectural (Ambience Works) drawings, refer Drawing No. STD-PAD-P-110-5-02. For Symbols and Abbreviations used on the Electrical (Ambience Works) drawings, refer to Drawing No. STD-EL-E-110-5-02.
 7. This drawing has been produced without topographical or geometrical survey data. The relative positions of existing structures, station furniture, fixtures, etc., which are not subject to Phase 3 ambience works, are shown indicatively. It is the responsibility of the 'User' of this drawing to check and verify the accuracy of the information provided prior to its use. In the event that such verification is not undertaken no liability will be accepted for claims, additional cost or extension of time resulting from any inaccuracies contained within the information provided. All dimensions must be checked on site to ensure the proposed works can be installed correctly and in accordance with the design intent prior to commencing work.
 8. All materials and workmanship shall be in accordance with current and specified standards.
 9. The systems equipment design which includes Closed Circuit Television Cameras (CCTV), Public Address Speakers (PA), Customer Information Screens (CIS), Next Train Indicators (NTI), Train Information Display Screens (TIS), Closed Circuit Television Camera Live Monitor Display Screens (CCTV D5), Public Help Points (PHP) and Induction Loops (IL) is by LOROL's System Designer. New CCTV cameras & PA speakers are shown in the general location indicated on the System Designer's CCTV Desktop Survey drawings. The systems equipment locations, where shown, is indicative and are provided for coordination and information purposes only. Lighting columns that support existing operational systems equipment shall not be removed until the new systems equipment is installed and operational. No reliance should be placed upon the accuracy of the systems information provided. Find connections to Systems Equipment to be by LOROL's System Designer. Structural assessment of new or existing structures supporting Systems equipment is by the Systems Designer.
 10. Repair and reinstatement / replacement of any existing assets damaged by the 'User' of these documents works is the responsibility of the 'User'. The 'User' shall replace the damaged area / materials with new to a standard no less than equal quality and to the satisfaction of the Engineer. Replacement materials shall be Network Rail compliant. Repair will only be acceptable with prior written approval of the Engineer. The 'User' shall be responsible for all direct and indirect costs associated with such damage.
 11. The 'User' of these documents shall be familiar with the 'Designer's Risk Assessment' prior to commencement of any work on site, and shall take all appropriate measures necessary to minimise Health & Safety risks associated with the works.

project no.
1036 - 029

revision

00 Issued to LOROL for systems design purposes. IK 14.01.10 MT
N° Revision By Date C/M

contract

GCP Rail Ltd
42 Tabard Street
London SE1 4JU
T: 020 7407 3047
F: 020 7357 9949
www.gcp Partnership.co.uk

gc
partnership

drawing status
FOR INFORMATION

project
client
project title
LOROL
London Overground
Camden Road Station

drawing title
Existing Station
Booking Hall Plan
Sheet 1 of 3
scale (A1)
1:50
date
12.01.10
drawn
IK
checked
MT

reference
drawing no.
CMD-PAD-E-30-1-01
revision
00