

Key							
	Acoustic Ceiling, as CLG-22		Suspended Luminaire with Spacer		Smoke Detector / Sounder / Xenon		Ceiling type - refer to specification Height (mm) above FFL
	Plasterboard Double layer, as CLG-21		Surface Mounted Rectangular Luminaire		PIR		Access Panel, as AP-02a
	Fireboard Lining, as CLG-01a		Recessed Rectangular Luminaire		Supply		VRV unit wall fixed
	Suspended perforated metal ceiling panel, as CLG-15		Surface Mounted Circular Luminaire		Extract		VRV unit flush to ceiling
	Suspended Timber Ceiling (Corridor), as CLG-08		Recessed Circular Luminaire		Sprinkler		CCTV camera - final setting out to be agreed with specialist consultant
	Existing Ceiling, as CLG-50						Ceiling mounted speaker - final setting out to be agreed with specialist consultant
<b>GENERAL</b> Underside of suspended light fittings to be 3000 mm minimum above FFL - Level to be confirmed on site for each location. Underside of VRV unit to be 3500 - 3700 mm above FFL - Level to be confirmed on site for each location. For setting out of corridor panelling refer to WRB-CAD-2600 to WRB-CAD-2699 and WRB-CAD-2371/2. For ceiling details refer to WRB-CAD-5600 and WRB-CAD-5607-5609.							

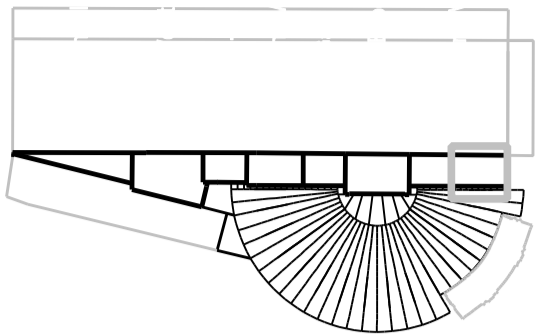

Notes

Drawings are based on survey data and may not accurately represent what is physically present.

Do not scale from this drawing. All dimensions are to be checked on site and any discrepancies noted in writing to the Employer's Representative. All dimensions are in millimetres unless noted otherwise.

Where there appears to be ambiguity between the drawings and other information, the Contractor shall seek the advice of the Employer's Representative for clarification.

Refer to drawing KXG-CAG-0000 for general notes and abbreviations. For detail of Architectural Specification codes (shown on drawings as 'LIN-01', for example) refer to the Technical Reference Sheet.

Drawings to be read in conjunction with the Architectural Specification and other relevant information, including the schedules and Engineer's documents. For individual repair locations, details and scopes, refer to the Repair Schedule and Architectural Specification as applicable.

Half tone line work shows scope by others. Refer to detail drawings for further scope definition.

ddd - Dimension subject to detail design development

01	09/04/10	DJ		
For LB08 Submission				
Issue	Date	By	Chkd	Appd

ARUP

13 Fitzroy Street  
London W1T 4BQ  
Tel: +44 (0)20 7727 4800  
Fax: +44 (0)20 7727 4801  
www.arup.com

John McAslan + Partners

49 Princes Place London W11 4QA  
Tel: +44 (0)20 7727 2663  
Fax: +44 (0)20 7221 8835  
www.mcaslan.co.uk



Client

Job Title

King's Cross Station  
Redevelopment Programme  
Package 6

Drawing Title

Western Range Building  
Station Control Room  
1/01  
Sections

Scale at A1

CCMS No

Drawing Status

For Information

OAP Job No	Drawing No	Rev.
123345-00	WRB-CAZ-0415	01