

REVISIONS			
REV.	DATE	DESCRIPTION	BY
-	16.04.2010	ISSUED FOR PLANNING PURPOSES ONLY.	IM

WALL TYPES:

- BLOCKWORK WALL
- STUD WALL
- EXISTING WALLS
- ADJACENT UNIT
- 1 LAYER PLASTERBOARD ON GYPLINER FRAME
- 1 LAYER PLASTERBOARD ON STUDWORK
- 2 LAYER PLASTERBOARD ON STUDWORK
- PLASTERBOARD & 12MM PLY ON STUDWORK
- PLASTERBOARD & 12MM PLY WITH ACCESS PANEL
- PLASTERBOARD & 18MM PLY ON STUDWORK
- MELAMINE FACED CHIPBOARD ON STUD
- PAINT TO BLOCKWORK
- LOCATION REFERENCE DOOR NUMBER
- LOCATION REFERENCE WINDOW NUMBER
- FIRE RATED DOOR

NOTE: REFER TO THE TK MAXX CONSTRUCTION MANUAL:  
SECTION 6.1 FOR DETAILS  
SECTION 6.3 FOR DOOR TYPES  
SECTION 7.1 SPEC P21 FOR IRONMONGERY DETAILS.

THIRD FLOOR AREAS:

Demise: 315qm/ 3,391 sqft  
(treat as separate demise to other floors)

NOTE:  
1. THESE DRAWINGS ARE FOR PLANNING PURPOSES ONLY.



client  
TJX EUROPE

project  
TK MAXX:  
118-120 CHARING CROSS RD  
LONDON, WC2H 0JR

drawing title  
PROPOSED ROOF PLANS  
AND PLANT LAYOUT

date  
16:04:2010

scale  
1:100 @ A1

drawn by  
IM

checked by  
CB

status  
PLANNING

drawing no.  
1122-TK50-C52\_PP

revision

LOM architecture and design  
Boulevard House 92 Fortis Green London N2 9EY  
T +44(0)20 8444 2999 F +44(0)20 8444 5999  
W lom-fdp.com E mail@lom-fdp.com

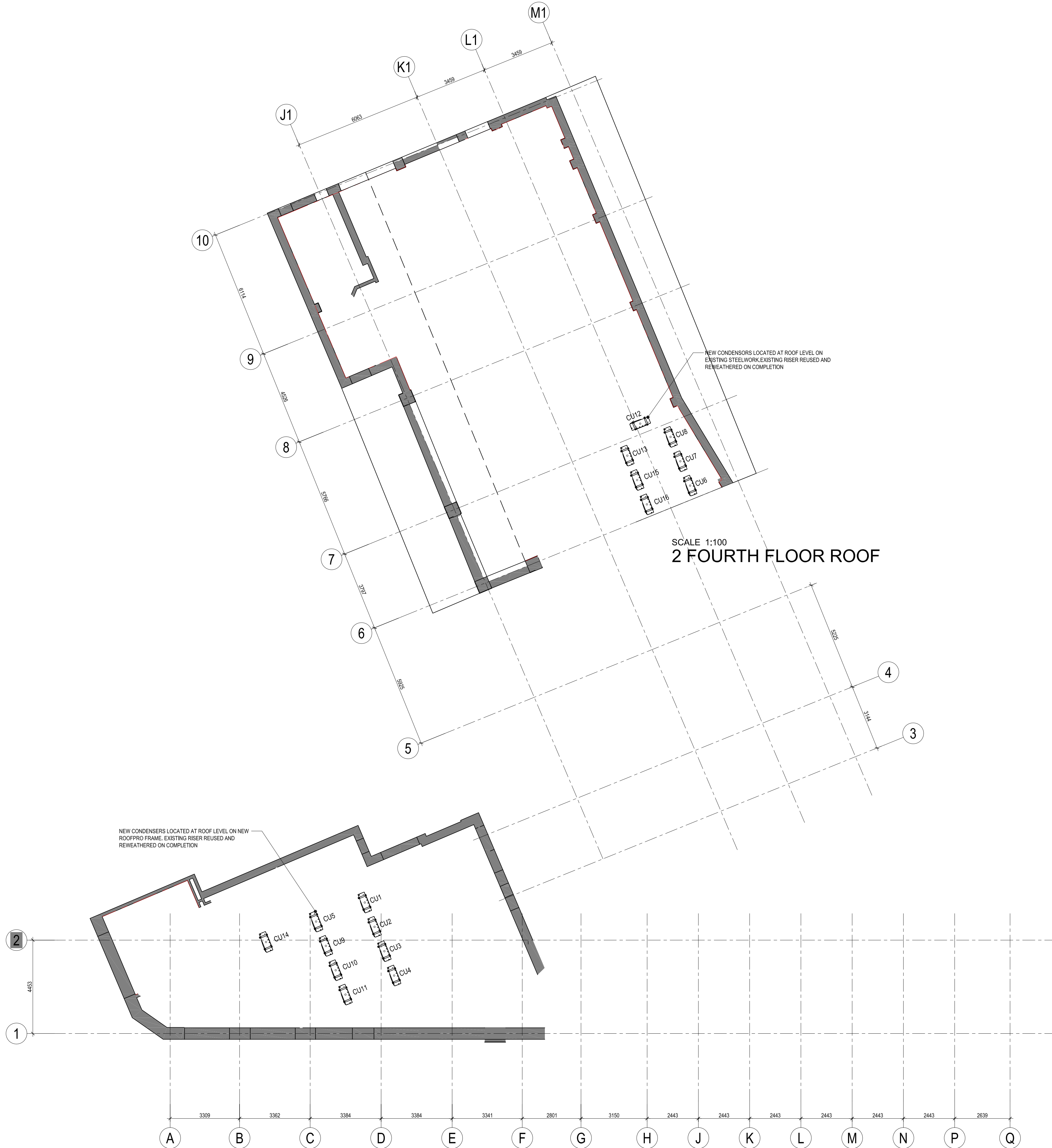

SCALE 1:100  
1 FIRST FLOOR ROOF

SCALE 1:100  
2 FOURTH FLOOR ROOF



 **D.B. GREEN LTD**  
Heating, Ventilation, Air Conditioning  
Design, Installation, Maintenance

**LEWES—MANCHESTER—Huddersfield—GLASGOW**

Brook House, South Downs Business Park,  
Brooks Road, Lewes, East Sussex BN2 2BQ

TELEPHONE : LEWES +44 (0)1273 480251  
FAX : LEWES +44 (0)1273 480252