







This drawing should be read in conjunction with the specification and shall not be used in lieu of the service contractors working drawings. At construction stage, the service contractors are required to prepare co-ordinated drawings for construction purposes under the terms of the contract.

A1

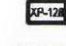
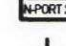
- LEGEND**
-  STAND ALONE EMERGENCY LUMINAIRE
  -  STAND ALONE (EXTERNAL) EMERGENCY LUMINAIRE
  -  ILLUMINATE EXIT SIGN
  -  THORN EXPANDER PANEL
  -  THORN DATA COMMS COMMUNICATION
  -  FUSED CONNECTION UNIT
  -  JUNCTION BOX FOR DATA CABLE TO EMERGENCY LUMINAIRES
  -  UCL NETWORK DATA POINT
  -  EXISTING DISTRIBUTION BOARD

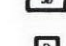

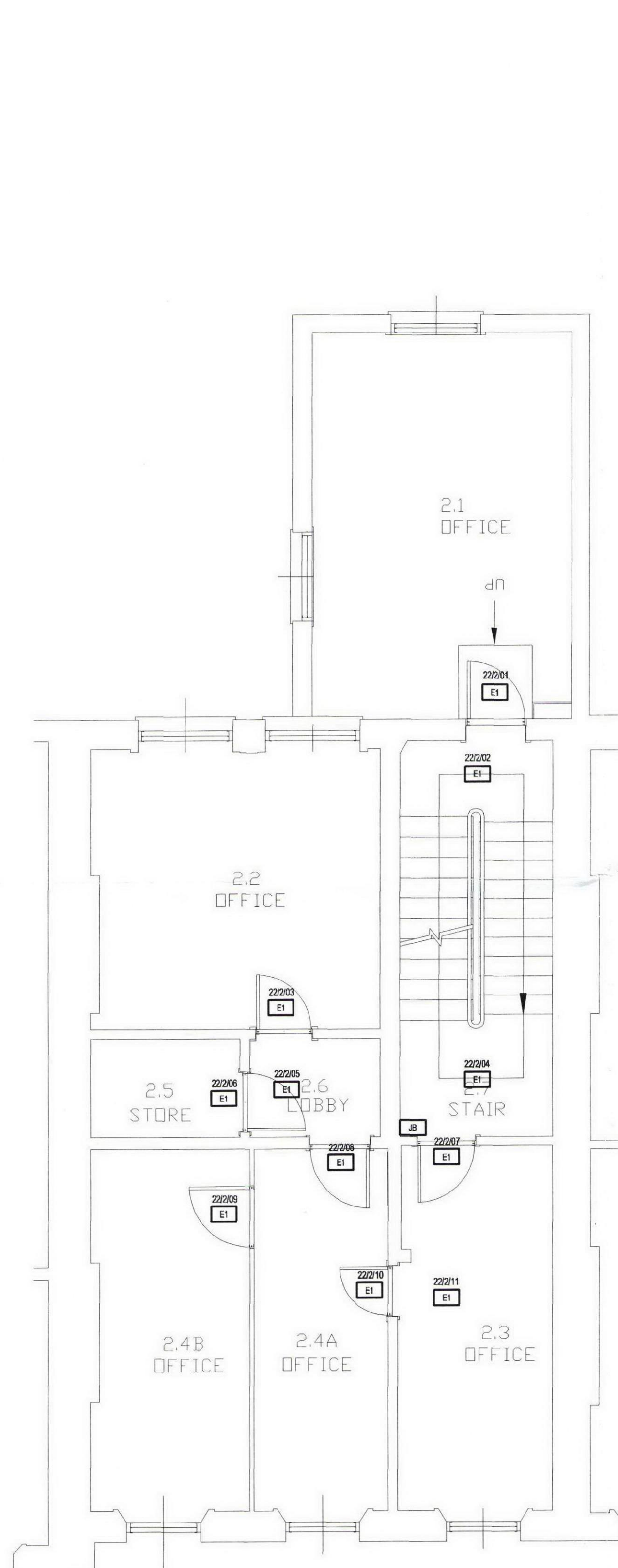
SECOND

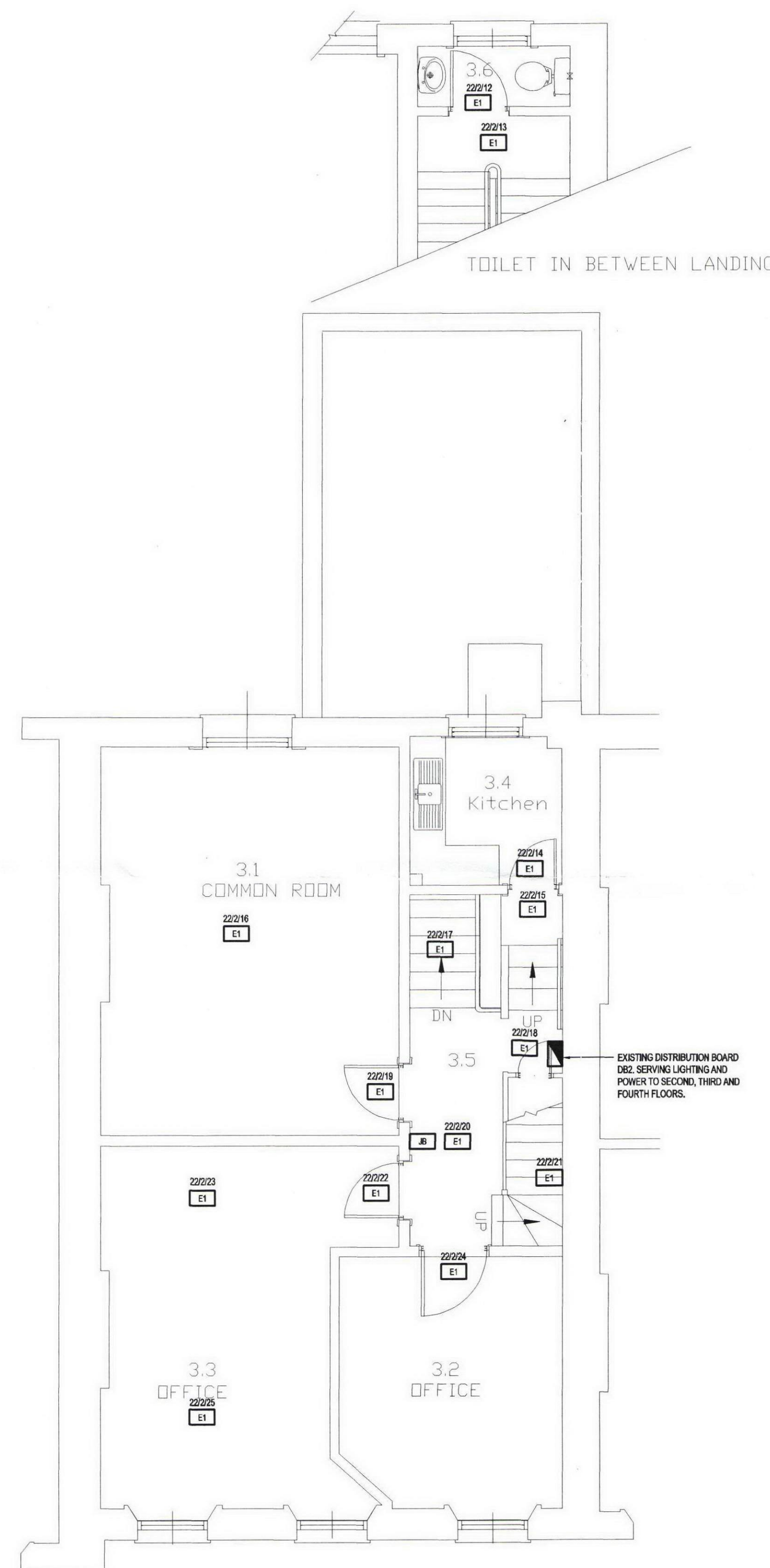

THIRD

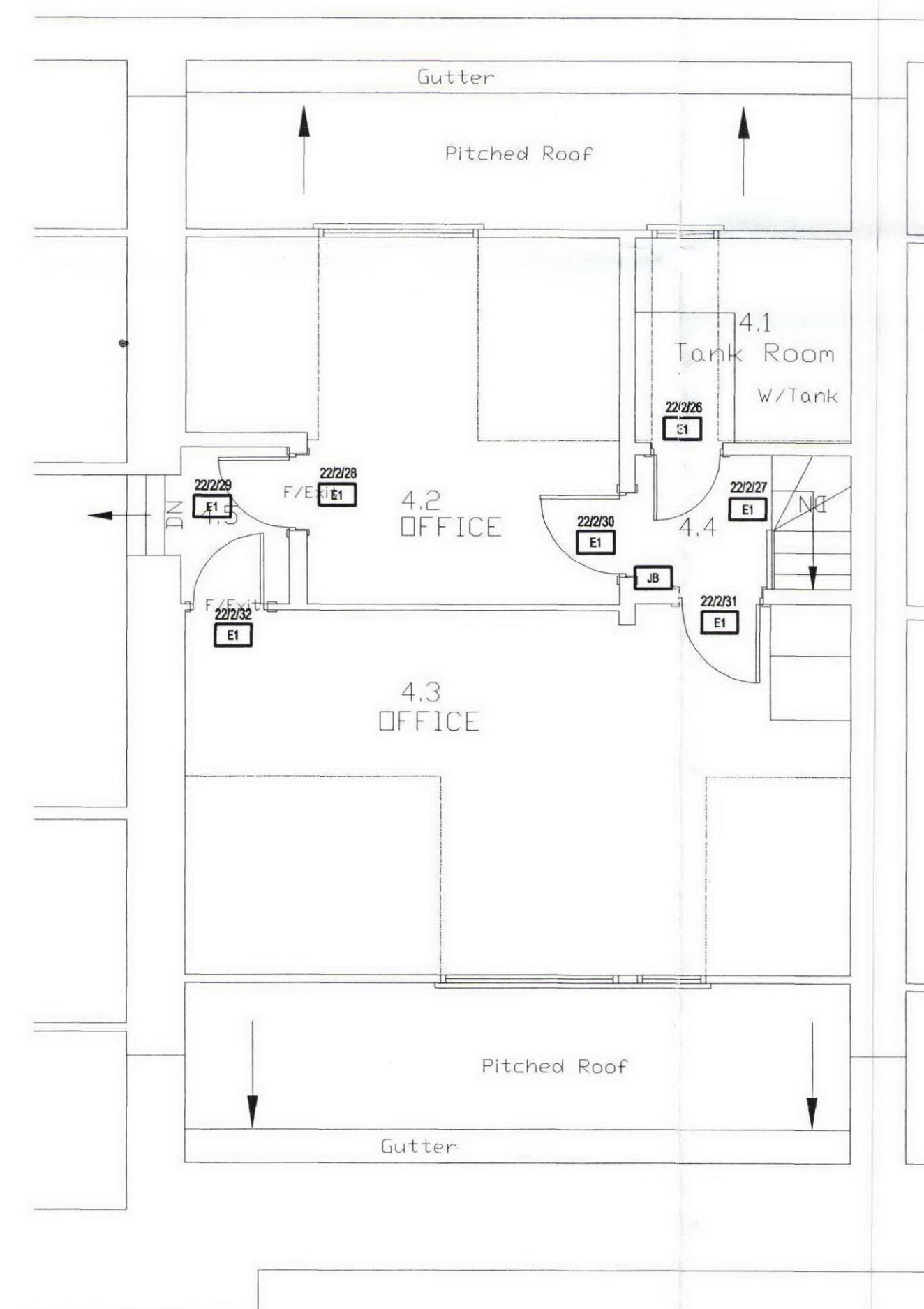

FOURTH

REV	DATE	DESCRIPTION	ALT	DO	ORIG	APP
				CHK	CHK	
<b>TGA Consulting Engineers LLP</b> Armstrong House, Norton Road Stevenage Hertfordshire, SG1 2LX T: 01438 314422 F: 01438 314433 E: stevenage@tga.co.uk			 Consulting Engineers LLP			
<b>Project</b> UNIVERSITY COLLEGE LONDON 22 GORDON SQUARE HOUSES						
<b>Title</b> ELECTRICAL ENGINEERING SERVICES SECOND, THIRD AND FOURTH FLOOR REPLACEMENT EMERGENCY LIGHTING SYSTEM						
<b>Architect</b> -						
<b>Client</b> UCL ESTATES AND FACILITIES DIVISION.						
<b>Drawing Number</b>  6888E(63)-014		<b>Revision</b>	<b>Scale</b>			
			A1	1:50		
			A3	N.T.S.		
			A4	N.T.S.		
<b>Path</b> J:\6888\ELEC\6888E(63)-013						
<b>Architects Drawing Reference</b> -						
<b>Drawn</b>  JB	<b>DO Check</b>  GK	<b>Originator</b>  ED	<b>Approved</b>  ED			
<b>Date</b>  JAN 2010			<b>Status</b>  TENDER			

This drawing is the copyright of TGA Consulting Engineers LLP and must not be reproduced without their permission. This drawing shall not be scaled for construction purposes.