

**Planning Services**  
Camden Town Hall  
Argyle Street  
London WC1H 8EQ

**Email (enquiries only):** env.devcon@camden.gov.uk  
**Telephone** : 020 7974 1911  
**Fax** : 020 7974 5713

**For office use**  
**Date**  
**Payee**  
**App. No.** **Fee**

**Application for tree works: works to trees subject to a tree preservation order (TPO) and/or notification of proposed works to trees in a conservation area.**  
**Town and Country Planning Act 1990**

**Publication of applications on planning authority websites.**

Please note that the information provided on this application form and in supporting documents may be published on the Authority's website. If you require any further clarification, please contact the Authority's planning department.

**1. Applicant Name, Address and Contact Details**

Title:	Mr	First name:	Leon	Surname:	Blitz		
Company name:							
Street address:	Perceval Avenue			Country Code	National Number	Extension Number	
				Telephone number:			
				Mobile number:			
Town/City:	London			Fax number:			
County:				Email address:			
Country:	United Kingdom						
Postcode:	nw3 4py			lblitz@btinternet.com			

Are you an agent acting on behalf of the applicant? ☐ Yes ☒ No

**2. Agent Name, Address and Contact Details**

No Agent details were submitted for this application

**3. Trees Location**

Please provide the address of the site where the tree(s) stands (full address if possible):

House:	10	Suffix:	
House name:			
Street address:	PERCEVAL AVENUE		
Town/City:	LONDON		
County:			
Postcode:	NW3 4PY		

Description:

If the location is unclear or there is not a full postal address, either describe as clearly as possible where it is (for example, 'Land to rear of 12 to 18 High Street' or 'Woodland adjoining Elm Road') or provide an Ordnance Survey grid reference:

**4. Trees Ownership**

The applicant is the owner of the trees

**5. What Are You Applying For?**

Are you seeking consent for works to a tree(s) subject to a TPO? ☒ Yes ☐ No

Are you wishing to carry out works to tree(s) in a conservation area? ☐ Yes ☒ No

## 6. Tree Preservation Order Details

If you know which TPO protects the tree(s) enter its title or number below

T10

## 7. Identification Of Tree(s) And Description Of Works

Please identify the tree(s) and provide a full and clear specification of the works you want to carry out. Continue on a separate sheet if necessary. You might find it useful to contact an arborist (tree surgeon) for help with defining appropriate work. Where trees are protected by a TPO, please number them as shown in the First Schedule to the TPO where this is available. Use the same numbers on your sketch plan (see guidance notes).

Please provide the following information below : tree species (and the number used on the sketch plan) and description of works. Where trees are protected by a TPO you must also provide reasons for the work and, where trees are being felled, please give your proposals for planting replacement trees (including quantity, species, position and size) or reasons for not wanting to replant.

*E.g. Oak (T3) - fell because of excessive shading and low amenity value. Replant with 1 standard ash in the same place.*

T10 - Cropped Plane Tree.

Request for Crown reduction of 30%, Prune to shape and balance crown lift to 16 Foot Said tree has resulted in entire house (10 Perceval Avenue) being underpinned. Tree was pruned a number of years ago.

Arboriculturist consulted who had met with Mr Kevin Fisher of Camden on site previously when works to underpin and trial pits were undertaken. Mr Fisher prepared Delegated Report on 5/12/2006 in relation to 2006/4685/P where he agreed previously to crown raising of 5m on garden side and 6m on road side - 'this is considered acceptable' Main reason for work: Plane tree now has branches that are dangerously low and branches recently falling off tree and tree grown significantly since last agreed works and poses risk to property foundations.

## 8. Trees - Additional Information

### For all trees

A sketch plan clearly showing the position of trees listed in Question 7 must be provided when applying for works to trees covered by a TPO. A sketch plan is also advised when notifying the LPA of works to trees in a conservation area (see guidance notes). It would also be helpful if you provided details of any advice given on site by an LPA officer.

### For works to trees covered by a TPO

Please indicate whether the reasons for carrying out the proposed works include any of the following. If so, your application must be accompanied by the necessary evidence to support your proposals. (See guidance notes for further details)

1. **Condition of the tree(s)** - e.g. it is diseased or you have fears that it might break or fall:

If YES, you are required to provide written arboricultural advice or other diagnostic information from an appropriate expert.

☒ Yes ☐ No

2. **Alleged damage to property** - e.g. subsidence or damage to drains or drives.

If YES, you are required to provide for:

☒ Yes ☐ No

#### Subsidence

A report by an engineer or surveyor, to include a description of damage, vegetation, monitoring data, soil, roots and repair proposals. Also a report from an arboriculturist to support the tree work proposals.

#### Other structural damage (e.g. drains, walls and hard surfaces)

Written technical evidence from an appropriate expert, including description of damage and possible solutions.

### Documents and plans (for any tree)

Are you providing additional information in support of your application?

☐ Yes ☒ No

## 9. Authority Employee/Member

With respect to the Authority, I am:

- (a) a member of staff
- (b) an elected member
- (c) related to a member of staff
- (d) related to an elected member

Do any of these statements apply to you?

☐ Yes ☒ No

## 10. Trees - Declaration

I/we hereby apply for planning permission/consent as described in this form and the accompanying plan, drawings and additional information.



Date:

27/04/2010

# Tom La Dell

*Chartered Landscape Architect*

Stocks Studio Grafty Green Maidstone Kent ME17 2AP  
Tel: 01622-850 245 Fax: 01622-858 063  
Email: tomladell@aol.com

Planning Services  
London Borough Camden  
Town Hall  
Argyle Street  
London  
WC1H 8ND

25 January 2005  
Our Ref: 895

For Kevin Fisher

Dear Mr Fisher

## 10 PERCEVAL AVENUE, NW3 - PLANE TREE

With reference to our telephone conversation today I enclose a copy of two pages of photographs of the roots and a location plan.

I confirm that the engineer has a problem with the foundation designs as the roots are very close to the surface and the floor level is close to ground level.

My assessment is that the cutting of roots shown in the photographs on a tree of this size would not cause any damage. Some pruning is needed over the public highway and the garden and a limited crown thinning would be beneficial. This would balance the root loss.

*What written  
2009*

I would be pleased to hear if you agree with this. If so, the application will be accompanied by a tree protection plan showing ground protection during the full course of construction. Piled foundations can still be used if you find this preferable to strip foundations.

Please let me know if you have preferred pruning requirements and these details will also accompany the planning application.

Yours sincerely



Tom La Dell

cc Mr L Blitz

Mr A Rosenberg

**AREA FOR CONSTRUCTION AROUND TREE:**

1. Contract temporary driveway to Arboricultural Practice Note No.1.

OR

2. Construct platform to work off 50 to 100mm above ground level.

Contractor to provide construction detail of piling and decking for approval in writing by C.B.Camden before any work commences on site.

Works in 1. or 2. to be completed before any works start on site and removed when all construction works are completed.

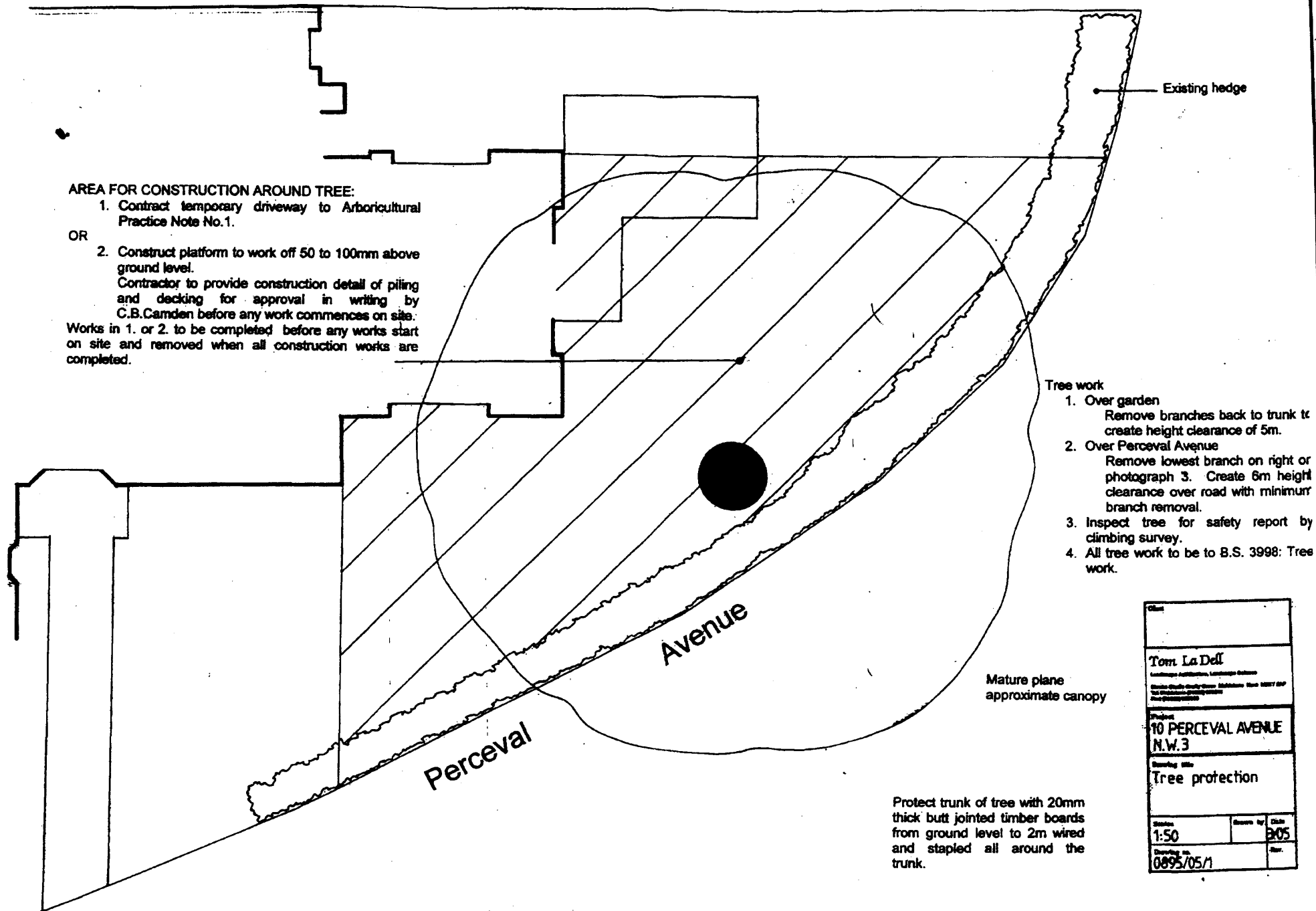

**Tree work**

1. Over garden  
Remove branches back to trunk to create height clearance of 5m.
2. Over Perceval Avenue  
Remove lowest branch on right or photograph 3. Create 6m height clearance over road with minimum branch removal.
3. Inspect tree for safety report by climbing survey.
4. All tree work to be to B.S. 3998: Tree work.

Client		
Tom La Dell		
Landscape Architect, Landscape Garden		
Studio 10 Perceval Avenue, N.W.3		
Project		
10 PERCEVAL AVENUE		
N.W.3		
Drawing title		
Tree protection		
Scale	Drawn by	Date
1:50		2005
Drawing no.	Rev.	
0095/05/1		

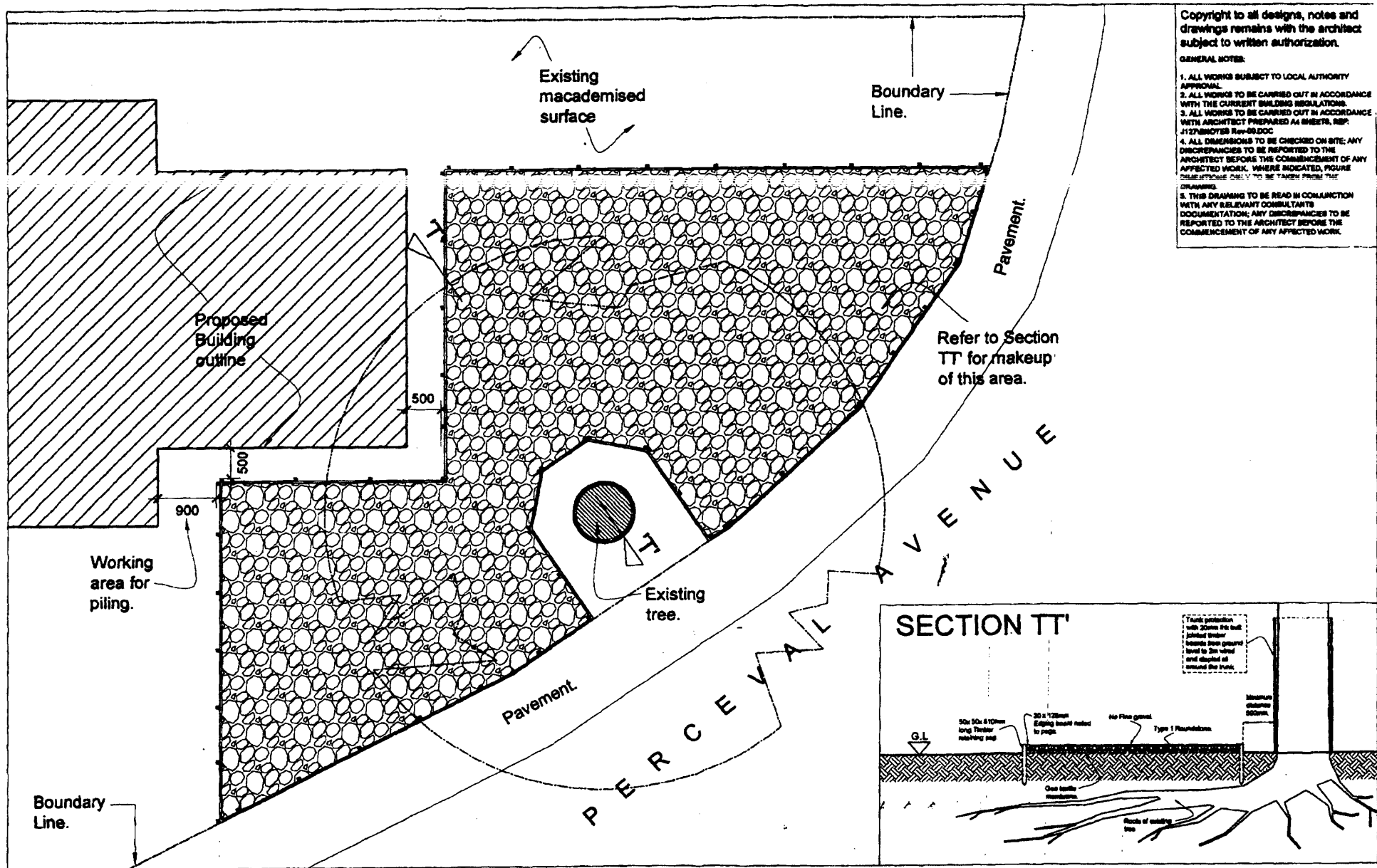

Copyright to all designs, notes and drawings remains with the architect subject to written authorization.

GENERAL NOTES:

1. ALL WORKS SUBJECT TO LOCAL AUTHORITY APPROVAL.
2. ALL WORKS TO BE CARRIED OUT IN ACCORDANCE WITH THE CURRENT BUILDING REGULATIONS.
3. ALL WORKS TO BE CARRIED OUT IN ACCORDANCE WITH ARCHITECT PREPARED AS SHEETS, REF: J127/MS/06-06-000
4. ALL DIMENSIONS TO BE CHECKED ON SITE; ANY DISCREPANCIES TO BE REPORTED TO THE ARCHITECT BEFORE THE COMMENCEMENT OF ANY AFFECTED WORK. WHERE INDICATED, FIGURE DIMENSIONS ONLY TO BE TAKEN FROM THE DRAWING.
5. THIS DRAWING TO BE READ IN CONJUNCTION WITH ANY RELEVANT CONSULTANTS DOCUMENTATION; ANY DISCREPANCIES TO BE REPORTED TO THE ARCHITECT BEFORE THE COMMENCEMENT OF ANY AFFECTED WORK.

**ARA**  
ALLAN ROSENBERG ARCHITECTS  
RIBA

19A Nant Road  
Child's Hill  
LONDON NW2 2AL  
Tel: (020) 8456-1444  
Fax: (020) 8922-5601

Client:

Mr. & Mrs. L. Blitz

B. Issued for information  
A. Issued for information  
No. Revisions:

Oct 06  
Oct 06

Drawing:

Tree Protection works

Scale:

1:100

Date: Oct 06

Project:

10 Perceval Av.  
London NW3

Draw No:

J127/ SK 15<sup>B</sup>

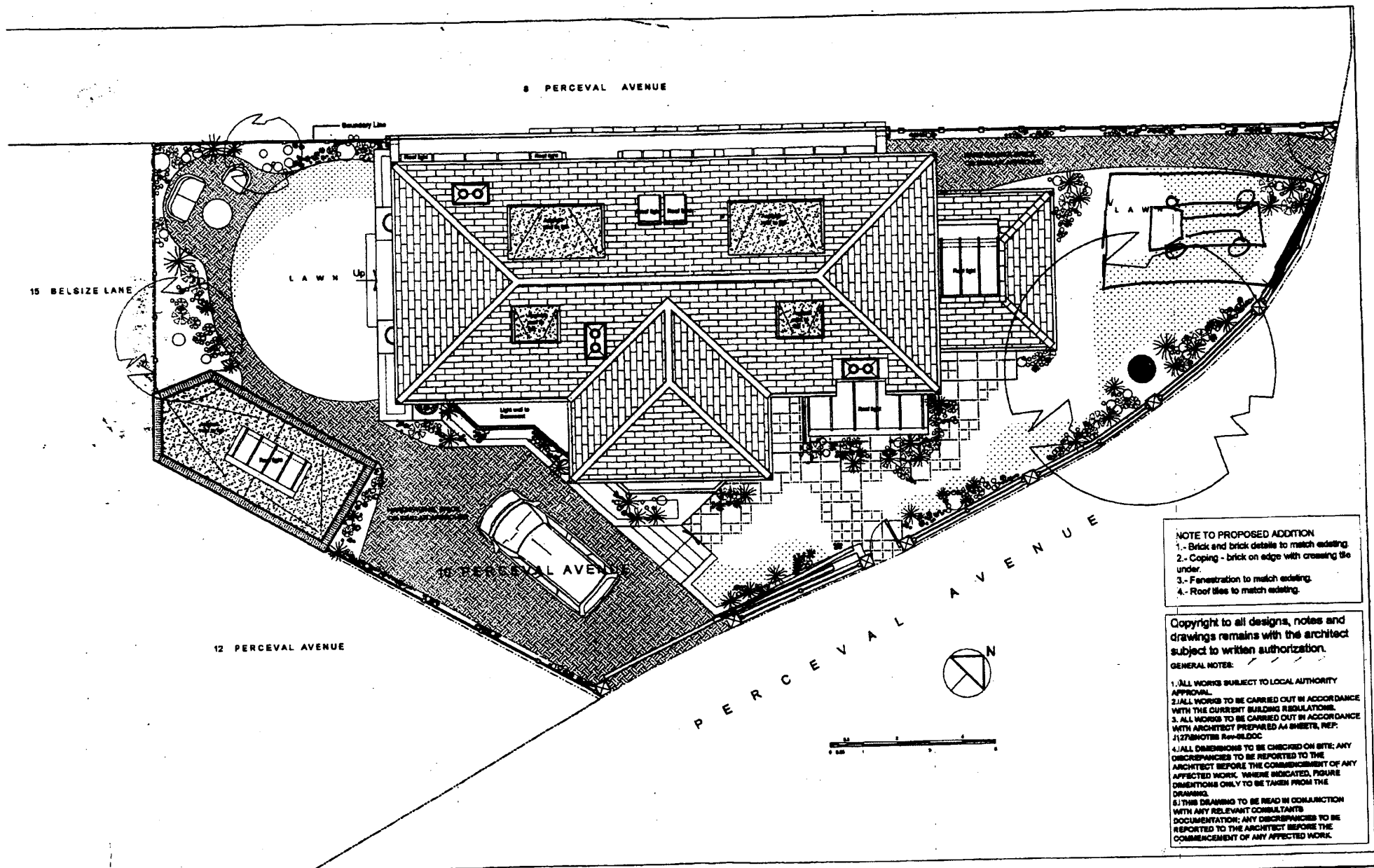

**NOTE TO PROPOSED ADDITION**  
 1.- Brick and brick details to match existing.  
 2.- Coping - brick on edge with crossing tile under.  
 3.- Fenestration to match existing.  
 4.- Roof tiles to match existing.

Copyright to all designs, notes and drawings remains with the architect subject to written authorization.

**GENERAL NOTES:**

1. ALL WORKS SUBJECT TO LOCAL AUTHORITY APPROVAL.
2. ALL WORKS TO BE CARRIED OUT IN ACCORDANCE WITH THE CURRENT BUILDING REGULATIONS.
3. ALL WORKS TO BE CARRIED OUT IN ACCORDANCE WITH ARCHITECT PREPARED A4 SHEETS, REF: J127/NOTES Rev-01/00.
4. ALL DIMENSIONS TO BE CHECKED ON SITE; ANY DISCREPANCIES TO BE REPORTED TO THE ARCHITECT BEFORE THE COMMENCEMENT OF ANY AFFECTED WORK. WHERE INDICATED, FIGURE DIMENSIONS ONLY TO BE TAKEN FROM THE DRAWING.
5. THIS DRAWING TO BE READ IN CONJUNCTION WITH ANY RELEVANT CONSULTANTS DOCUMENTATION; ANY DISCREPANCIES TO BE REPORTED TO THE ARCHITECT BEFORE THE COMMENCEMENT OF ANY AFFECTED WORK.

**ARA**  
 ALLAN ROSENBERG ARCHITECTS  
 RIBA

18A Nant Road  
 Child's Hill  
 LONDON NW2 2AL  
 Tel: (020) 8455-1444  
 Fax: (020) 8922-5901

Client:

Mr. & Mrs. L Blitz

F.	Issued for B.Rags	Sep 06
E.	Issued for Information	Jul 06
D.	Issued for Planning	Jun 06
B.	Issued for Planning	Aug 06
A.	Issued for Planning	Feb 04
No:	Revision:	

Drawing: Proposed Site Plan

Scale: 1:100 Date: March 05

Project: 10 Perceval Av.  
 London NW3

Drwg No: J127/ D22 F.