

10/5.

2010/2568/T



Camden

RECEIVED

11/10/10

Culture &amp; Environment

Application for tree works: works to trees subject to a preservation order (TPO)  
and/or notification of proposed works to trees in conservation areas (CA).

## Town and Country Planning Act 1990

### Publication of planning applications on council websites

Please note that with the exception of applicant contact details and Certificates of Ownership, the information provided on this application form and in supporting documents may be published on the council's website.

If you have provided any other information as part of your application which falls within the definition of personal data under the Data Protection Act which you do not wish to be published on the council's website, please contact the council's planning department.

Please complete using block capitals and black ink.

It is important that you read the accompanying guidance notes as incorrect completion will delay the processing of your application.

### 1. Applicant Name and Address

Title:	MR	First name:	DAVID
Last name:	GRAM		
Company (optional):			
Unit:		House number:	61
		House suffix:	
House name:			
Address 1:	ROSSLYN HILL		
Address 2:			
Address 3:			
Town:	HAMPSTEAD		
County:	LOWDON		
Country:	UK.		
Postcode:	NW3 5UQ		

### 2. Agent Name and Address

Title:		First name:	
Last name:			
Company (optional):			
Unit:		House number:	
		House suffix:	
House name:			
Address 1:			
Address 2:			
Address 3:			
Town:			
County:			
Country:			
Postcode:			

### 3. Trees Location

Full address/location of the site where the tree(s) stand (including full postcode where available)

Unit:		House number:	61	House suffix:	
House name:					
Address 1:	ROSSLYN HILL				
Address 2:	HAMPSHIRE				
Address 3:					
Town:					
County:	LONDON				
Postcode (if known):	NW3 5LQ				

If there is not a full postal address, describe as clearly as possible where it is (for example, 'Land to the rear of 12 to 18 High Street' or 'Woodland adjoining Main Road') or provide a grid reference:

Easting:	
Northing:	

Description:

ALDER TREE STANDING APPROX 20 METRES FROM THE REAR OF THE HOUSE, AND 1 METRE FROM THE WESTERN BOUNDARY FENCE OF THE GARDEN. THE TREE IS APPROXIMATELY 10 METRES TALL, AND 135 CM IN DIAMETER 1.5 M'S FROM THE GROUND. IT HAS SHOWN NO SIGN OF LIFE FOR OVER A YEAR NOW. HAVING BEEN STRUGGLING EVER SINCE WE FIRST BOUGHT THE HOUSE IN 2006.

### 4. Trees Ownership

Is the applicant the owner of the tree(s): ☒ Yes ☐ No  
If 'No' please provide the address of the owner (if known and if different from the trees location)

Title:		First name:	
Last name:			
Company (optional):			
Unit:		House number:	
House name:			
Address 1:			
Address 2:			
Address 3:			
Town:			
County:			
Country:			
Postcode:			

Telephone numbers

Country code:	National number:	Extension number:
+44	207 443 9050	
Country code:	Mobile number (optional):	
Country code:	Fax number (optional):	

Email address (optional):

divdav@ihcrecords.com.

### 5. What Are You Applying For?

Are you wishing to carry out works to tree(s) in a Conservation Area (CA)? ☒ Yes ☐ No

Are you seeking consent for works to tree(s) Subject to a Tree Preservation Order (TPO)? ☐ Yes ☐ No *DON'T KNOW*

### 6. Tree Preservation Order Details

Do you know the title of the Tree Preservation Order (TPO)? ☐ Yes ☒ No

If Yes, please provide the title of the TPO:

--

### 7. Identification Of Tree(s) And Description Of Works

Please identify the tree(s) and provide a full and clear specification of the works you want to carry out. Enter the species of the tree(s) and include a sketch plan showing position(s) of the tree(s) in relation to buildings, named roads and boundaries.

If the trees are protected by a TPO, if possible please number them as shown in the First Schedule to the Tree Preservation Order (for example T3 Oak; two Beech and one Birch in G2; seven Ash in A1; sycamore in W1).

Trees and proposed works:

THE PROPOSAL IS TO REMOVE THE TREE IN ORDER THAT A REPLACEMENT TREE MAY BE PLANTED. WHETHER THIS MEANS REMOVING THE STUMP AND ROOTS AS WELL AS THE TREE ITSELF, IS YET TO BE DECIDED, THERE BEING A CONSIDERABLE COST DIFFERENCE IN SO DOING.

You might find it helpful to consult a tree surgeon to clarify what needs to be done.

Please state the reference number you have given the plan: PLAN 1 RH61

## 8. Trees - Reasons For Works

This section only needs to be completed if you are seeking consent to trees under a Tree Preservation Order (TPO)

Please state the reasons for carrying out the proposed works on the tree(s):

THE TREE HAS DIED AND NEEDS TO BE REMOVED AND REPLACED.

Please indicate whether the reasons for carrying out the proposed works include any of the following. If so, your application must be accompanied by the documents specified.

Health or safety of the tree(s) - e.g. it is diseased, fears that it might break or fall:

☐ Yes

☒ No

If Yes, information required - report by a tree professional (e.g. arboriculturist, horticultural adviser).

Alleged subsidence damage:

☐ Yes

☒ No

If Yes, Information required: Full report by an engineer or surveyor, together with one from a tree professional - to include date and description of property damage; sub-soil type and shrinkage potential; location of any roots found and their identification; history of ground and building movement through a distortion survey and/or level or crack monitoring over suitable period; other vegetation in the vicinity and its management since discovery of the damage.

## 9. Trees - Additional Information

Are you providing additional information in support of your application?

☐ Yes

☒ No

If Yes, please provide the reference numbers of plans, documents, professional reports etc in support of your application:

## 10. Application For Tree Works - Checklist

Please use this checklist to ensure that the form has been completed correctly and that all relevant information is submitted.

For works to trees protected by a Tree Preservation Order, failure to supply sufficiently precise and detailed information may result in your application being rejected or delay in dealing with it. In particular, you MUST provide the following:

3 copies of a completed and dated application form. ☐

3 copies of a sketch plan showing the location of all tree(s). ☐

3 copies of a full and clear specification of the works to be carried out. ☐

3 copies of a statement of reasons for the proposed work. ☐

- evidence in support of statement of reasons. In particular, you should provide:

3 copies of a report by a tree professional (e.g. arboriculturist or horticultural adviser) if your reasons relate to the health and/or safety of the tree(s) ☐

3 copies of a report by an engineer or surveyor, together with one from a tree professional (arboriculturist) if you are alleging subsidence damage. ☐

For works to trees in conservation areas, it is important to supply precise and detailed information on your proposal. You may, therefore, wish to provide the following:

3 copies of a completed and dated form, with all questions answered. ☐

3 copies of a sketch plan showing the precise location of all tree(s). ☐

3 copies of a full and clear specification of the works to be carried out. ☐

Whether the trees are protected by a TPO or in a conservation area, please indicate which of the following types of additional information you are submitting (3 copies of each need to be provided):

- photographs. ☒

- report by a tree professional (arboriculturist) or other. ☐

- details of any assistance or advice sought from a Local Planning Authority officer prior to submitting this form. ☒ SEE BELOW.

## 11. Declaration - Trees

I/we hereby apply for consent/give notice as described in this form and the accompanying plans and additional information.

Signed - Applicant:

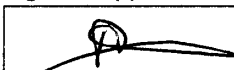

Or signed - Agent:

Date (DD/MM/YYYY):

10.5.10

(date cannot be pre-application)

## 12. Applicant Contact Details

Telephone numbers

Country code: National number: Extension number:

Country code: Mobile number (optional):

Country code: Fax number (optional):

Email address (optional):

## 13. Agent Contact Details

Telephone numbers

Country code: National number: Extension number:

Country code: Mobile number (optional):

Country code: Fax number (optional):

Email address (optional):

I RANG THE APPROPRIAT COUNCIL DEPT., AND WAS ADVISED TO FILL OUT THE ABOVE FORM AND RETURN BY POST. I EXPLAINED THAT THE TREE WAS DEAD AND THAT I WAS UNSURE WHETHER IT HAD A TPO ON IT OR NOT, AND WAS TOLD TO FILL IN THE ABOVE FORM.

PLAN 1 RH61

DRAWING STATUS

A3

## PLANNING

### GENERAL NOTES

1. No dimensions to be scaled from this drawing
2. Any discrepancies found between this drawing and other documents should be referred immediately to the consultants
3. This drawing should be removed from currency immediately a revised version is issued
4. This drawing is copyright.
5. All dimensions in mm's

### General Construction Notes -

1. IMPORTANT - Drawing to be read in conjunction with schedule of works prepared by GS and Powell-Tuck Associates specification.
2. IMPORTANT - All setting out dimensions are to be checked onsite by contractor.
3. Structure - Refer to Structural Engineer's drawings and specification for information.
4. Electrical and mechanical works - Refer to Services Engineer's drawings and specification.

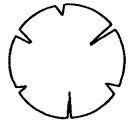

Existing Tree Retained

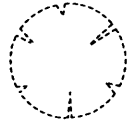

Existing Tree Removed

ROSSLYN HILL

ALDER TREE

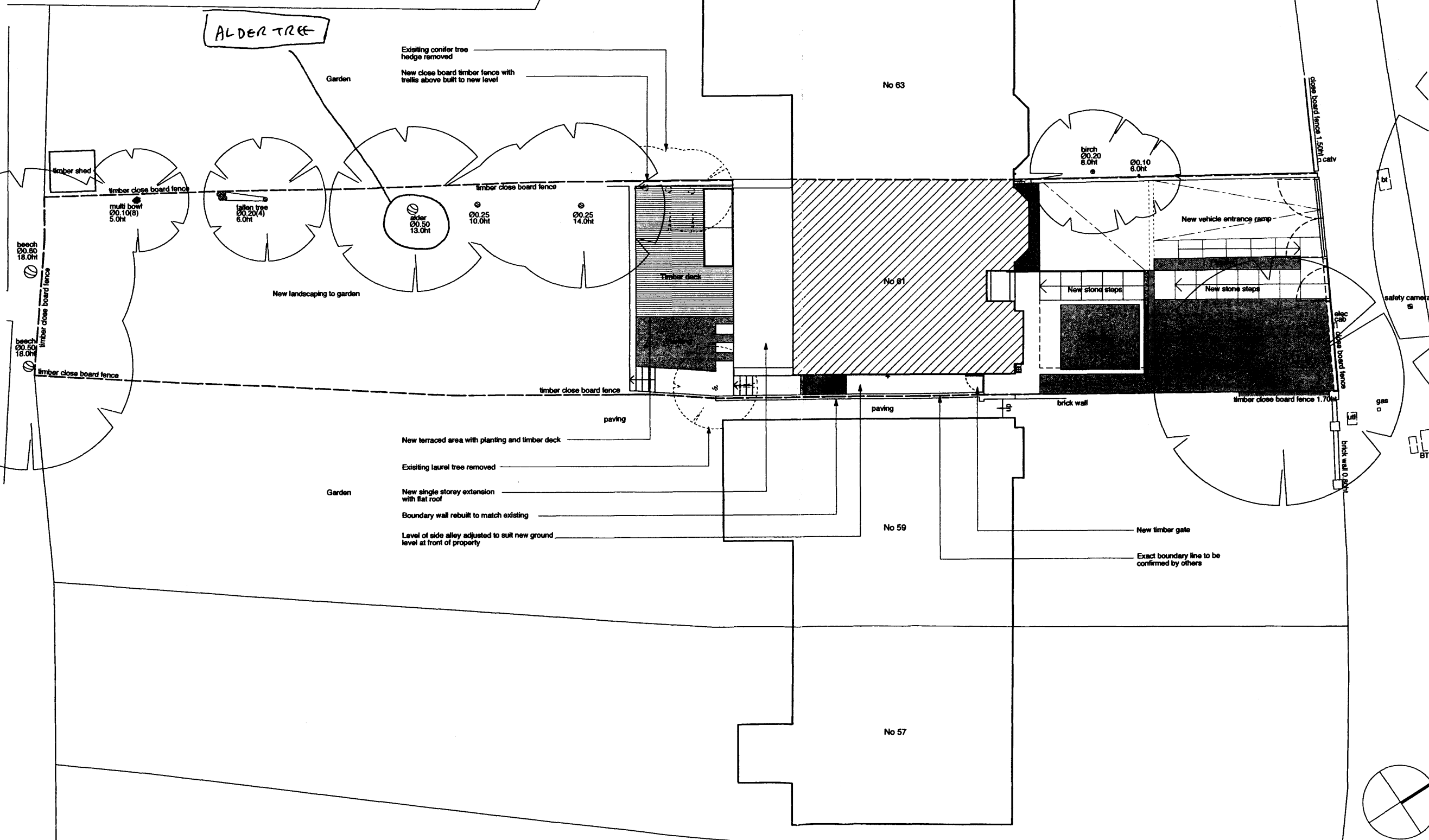

PL2	PLANNING ISSUE	03/07	HM
PL1	PLANNING ISSUE	21/02/07	HM
REV	DESCRIPTION	DATE	NAME

Powell Tuck Associates  
6 Stamford Brook Road  
London W8 0XH  
+44 (0)20 8746 7700 T  
+44 (0)20 8746 8737 F

pt

Architecture  
Design

PROJECT TITLE  
**61 ROSSLYN HILL  
LONDON  
NW3 5UQ**

DRAWN	HM	CHECKED	AS
DATE	19.01.07	SCALE	1:100 @ A1 1:200 @ A3

DRAWING TITLE  
**PROPOSED SITE PLAN**

JOB NO.	DRAWING NO.	REV
2381	PL-002	PL2











