

**Notes**  
 Copyright remains the property of Canaway Fleming Architects and this drawing is not to be used for any purposes without the express permission of the Architect. No implied License is given for its use.

Do not scale from this drawing. All dimensions should be checked on site for accuracy.

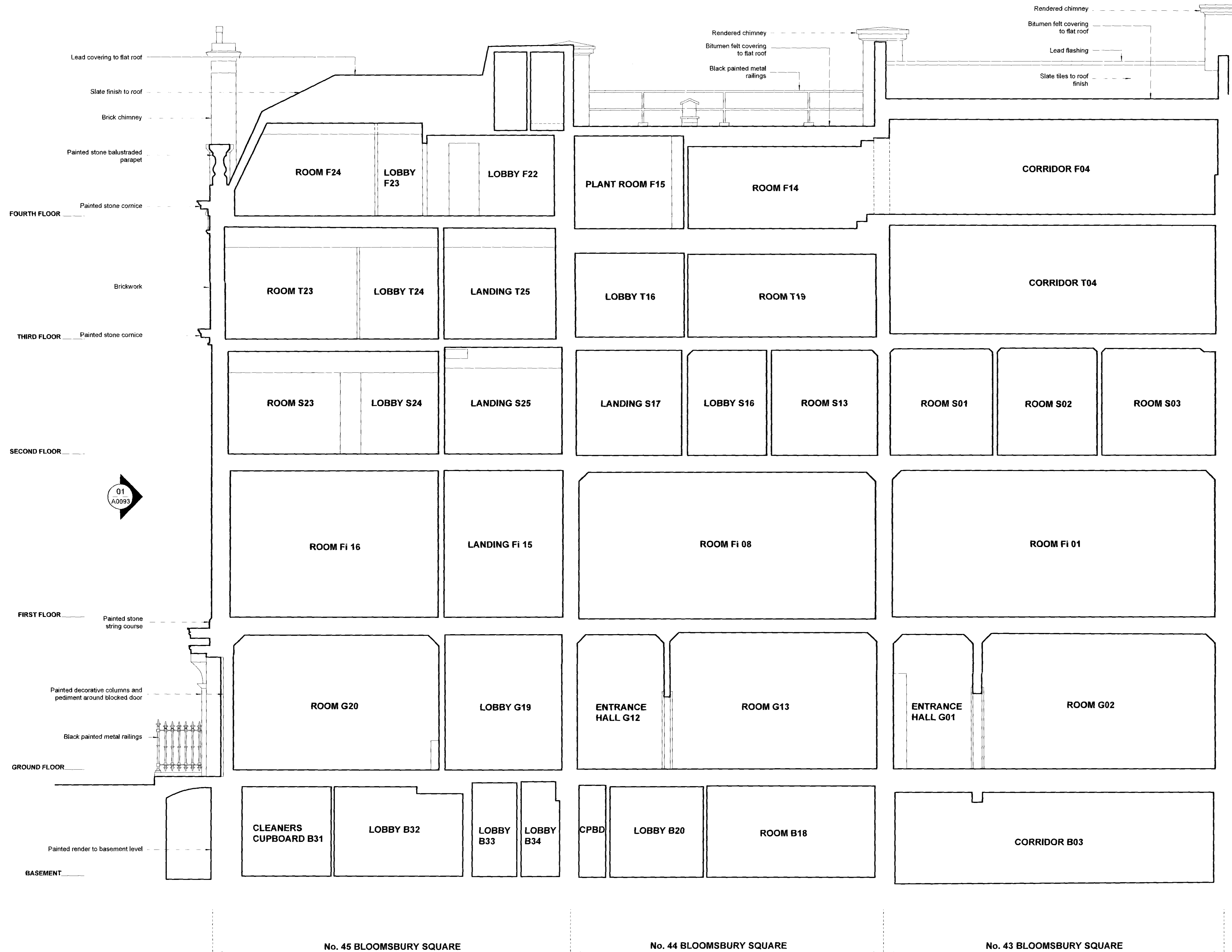

Revisions

**CANAWAY FLEMING ARCHITECTS**

Canaway Fleming Architects Ltd  
 The Dutch House  
 307-308 High Holborn  
 London WC1V 7LL  
 T: 020 7430 2262  
 F: 020 7430 2274  
 E: mailbox@canawayfleming.com

Client: Holborn Links Limited.

Project: 43-45 Bloomsbury Square.

Drawing Title: Existing Section D-D

Date: April 2010 Scale: 1:50 @ A1

© Copyright Canaway Fleming Architects Ltd.

Project	Origin	No.	Revision
059	A	0091	-
Status	PLANNING	Drawn	LH
		Checked	MC