

Notes
 Copyright remains the property of Canaway Fleming Architects and this drawing is not to be used for any purposes without the express permission of the Architect. No implied License is given for its use.
 Do not scale from this drawing. All dimensions should be checked on site for accuracy.

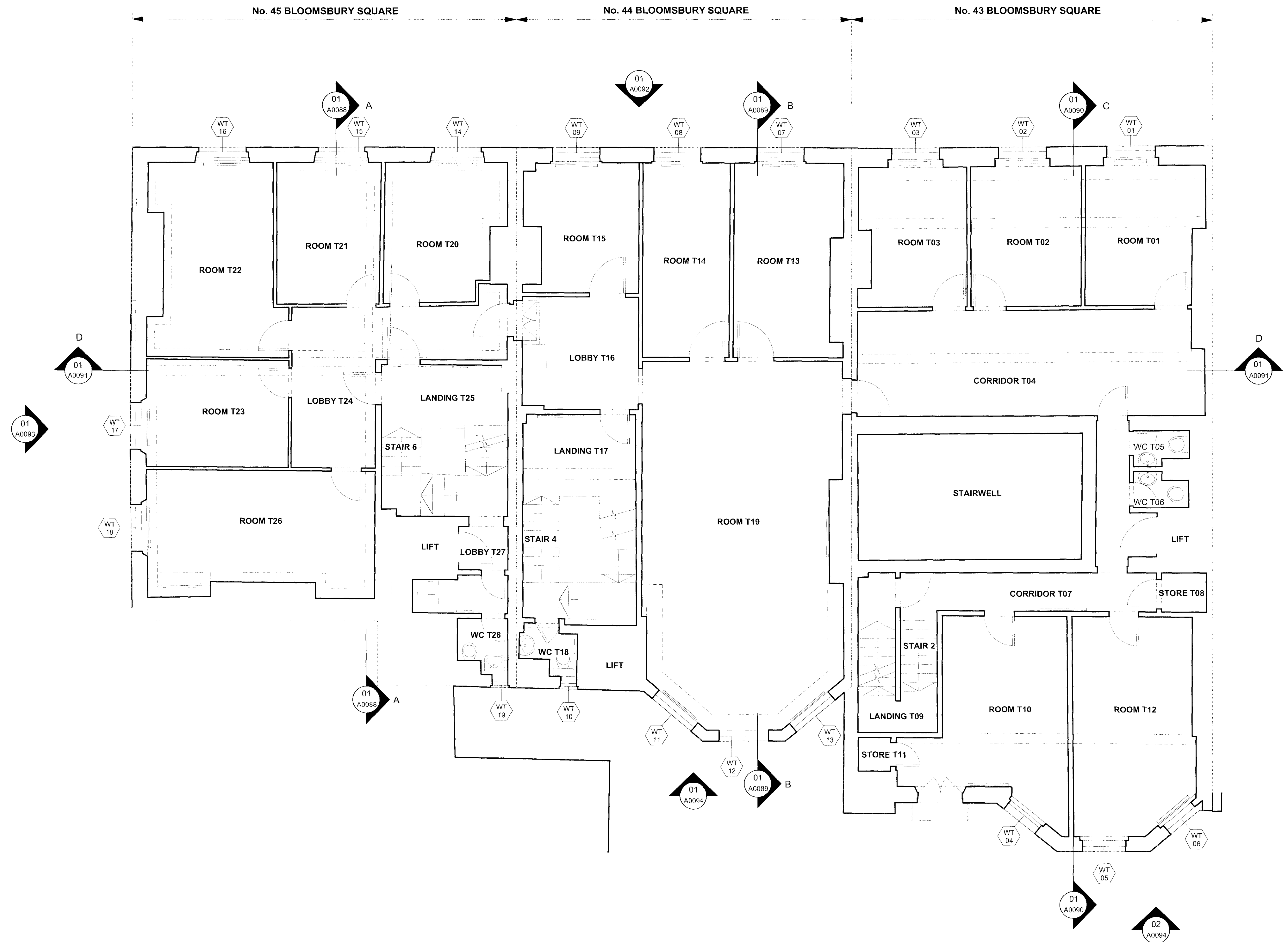

KEY:
 - - - - - Site Boundary
 WT 00 Window reference: (Level-No)



01 THIRD FLOOR GENERAL ARRANGEMENT PLAN
 A0085 EXISTING1:50

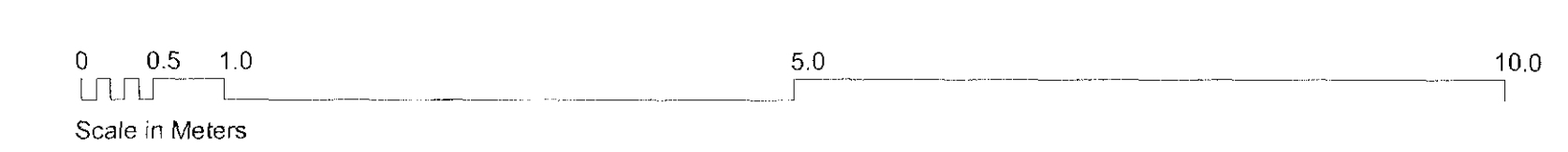

CANAWAY FLEMING ARCHITECTS
 Canaway Fleming Architects Ltd
 The South House
 207 - 208 High Holborn
 London WC1V 7TL
 T: 020 7430 2260
 F: 020 7430 2274
 E: mail@canawayfleming.com

Client: Holborn Links Limited.
 Project: 43-45 Bloomsbury Square, London.
 Drawing Title: Existing Third Floor General Arrangement Plan
 Date: February 2010 Scale: 1:50 @ A0

Project No:	059	Origin:	A	No.:	0085	Revision:	
Scale:	PLANNING	Drawn:	LH	Check:	LCB		