

Notes
 Copyright remains the property of Canaway Fleming Architects and this drawing is not to be used for any purposes without the express permission of the Architect. No implied License is given for its use.
 Do not scale from this drawing. All dimensions should be checked on site for accuracy.

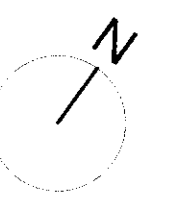

KEY:
 Site Boundary
 Window reference: (Level No)

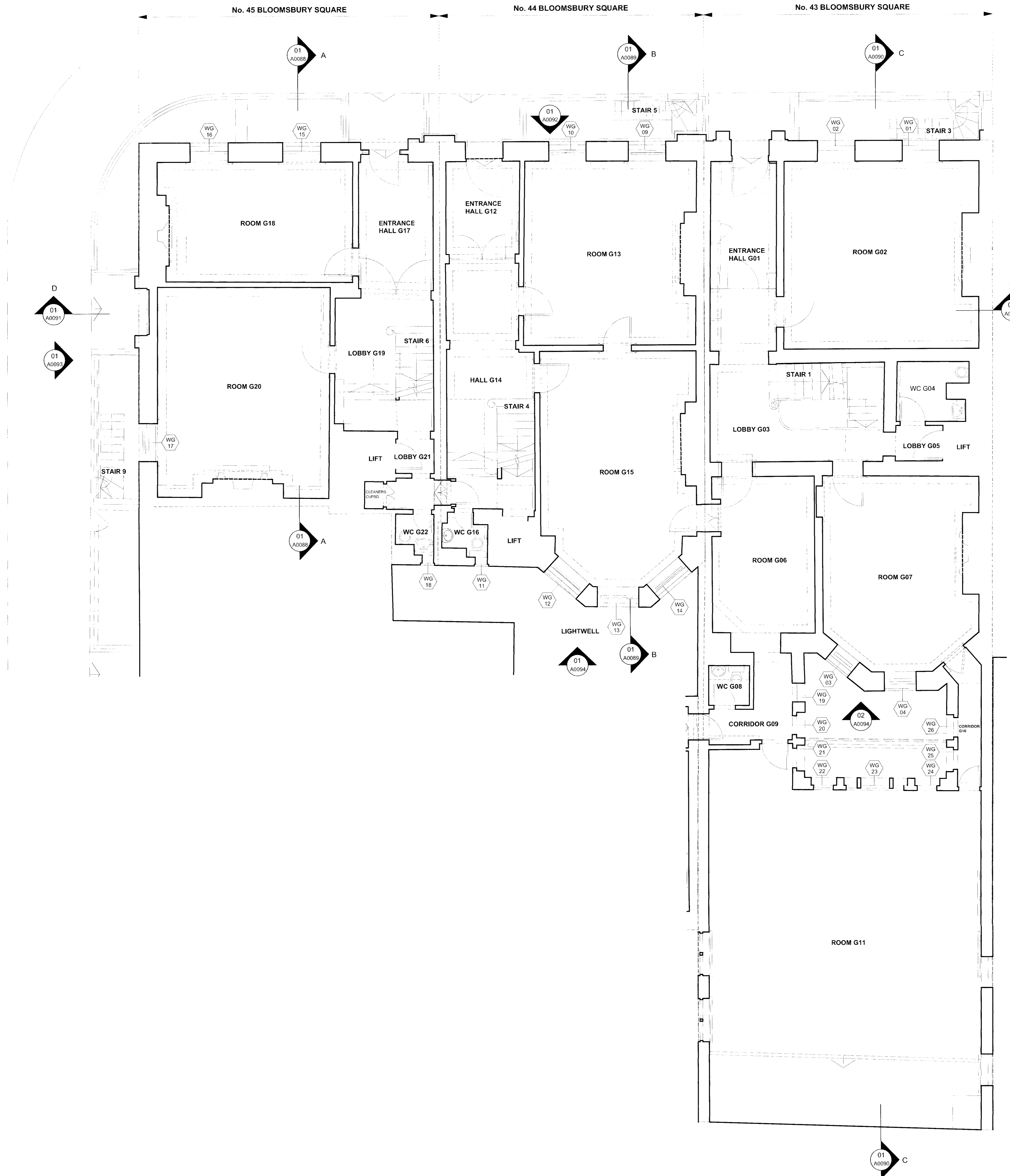

01 GROUND FLOOR GENERAL ARRANGEMENT PLAN
 A0082 EXISTING:1:50

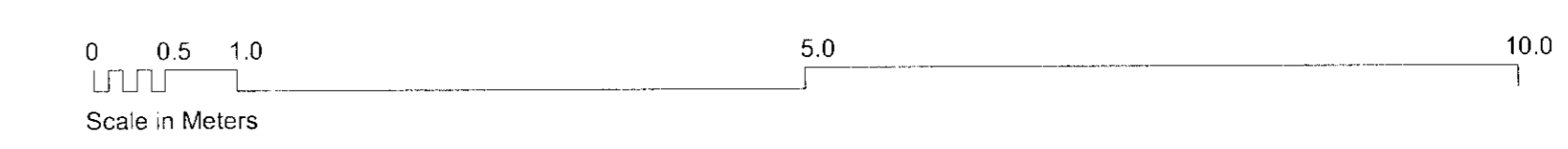

Revisions
CANAWAY FLEMING ARCHITECTS
 Canaway Fleming Architects Ltd
 The Dutch House
 301-303 High Holborn
 London WC1V 7LL
 T: 020 7430 2282
 F: 020 7430 2274
 E: mail@canawayfleming.com

Client: **Holborn Links Limited**
 Project: **43-45 Bloomsbury Square, London**
 Drawing Title: **Existing Ground Floor General Arrangement Plan**
 Date: **March 2010** Scale: **1:50 @ A0**

Project	Origin	No.	Revision
059	A	0082	-
Stage	PLANNING	Drawn	LH
		Checked	MC