

1.1 Basement Floor Plan Zones 2-5 - Demolition drawings

The following drawings show the amended extent of demolition at Basement Level Zones 2-5 Gridlines W1-W26 of The Western Range Building:

WRB-CAP-0021 Rev.05	Western Range Building, Basement Floor Plan - Zone 2 GL W23-W32 Demolition
WRB-CAP-0022 Rev.07	Western Range Building, Basement Floor Plan - Zone 3 GL W15-W23 Demolition
WRB-CAP-0023 Rev.07	Western Range Building, Basement Floor Plan - Zone 4 GL W10-W15 Demolition
WRB-CAP-0024 Rev.07	Western Range Building, Basement Floor Plan - Zone 5 GL W10-W01 Demolition

1.2 Ground / First / Second Floor Plans Zone 2 - Demolition drawings

The following drawings show the amended extent of demolition at Ground / First / Second Levels Zone 2 Gridlines W23-W32 of The Western Range Building:

WRB-CAP-0026 Rev.08	Western Range Building, Ground Floor Plan - Zone 2 GL W23-W32 Demolition
WRB-CAP-0031 Rev.06	Western Range Building, First Floor Plan - Zone 2 GL W23-W32 Demolition
WRB-CAP-0037 Rev.05	Western Range Building, Second Floor Plan - Zone 2 GL W23-W32 Demolition

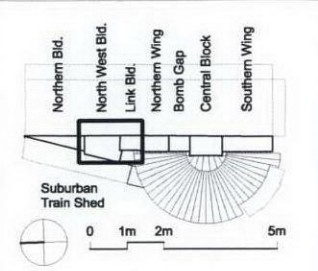
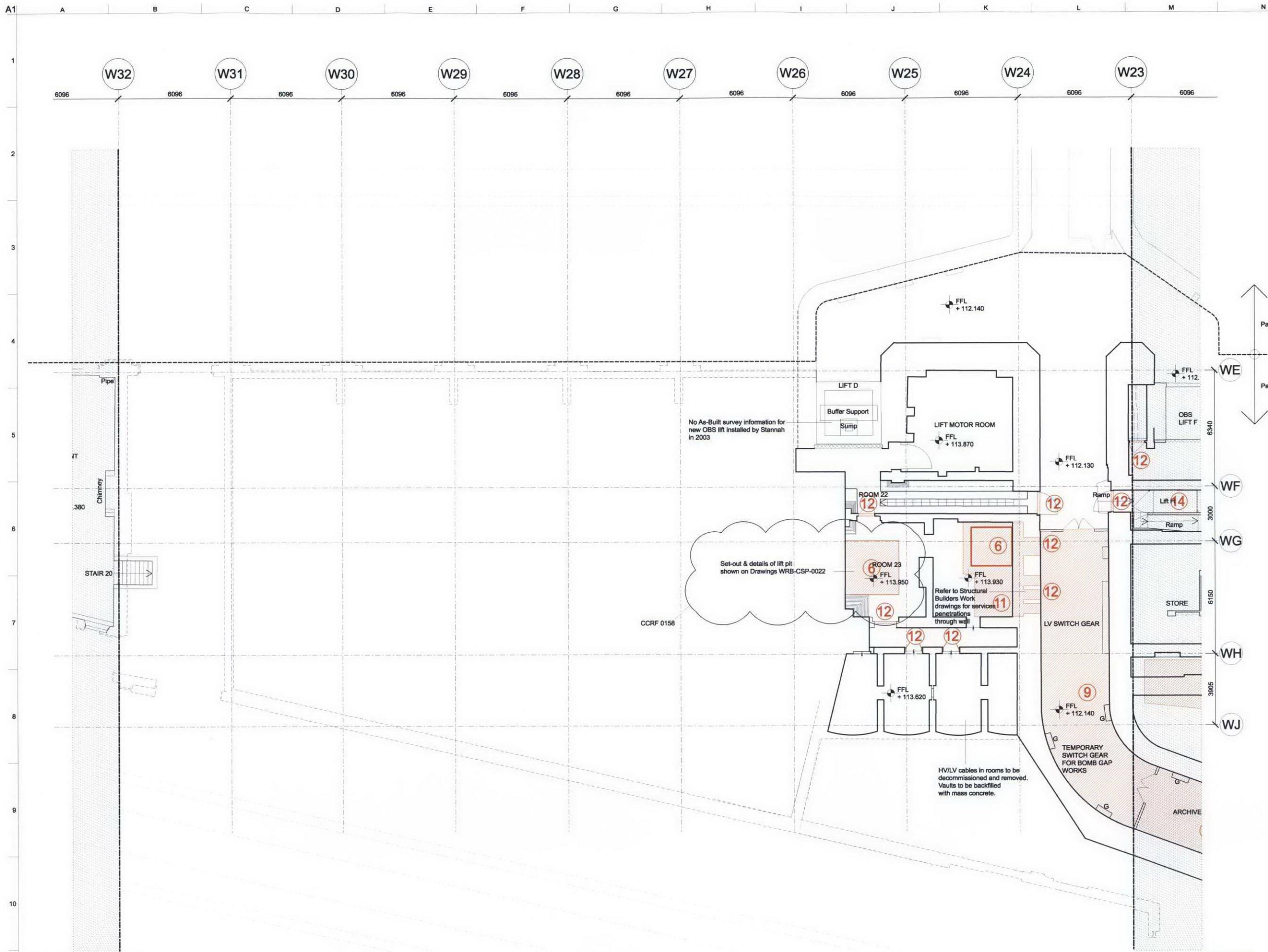

Key
 Area where elements to be removed

Notes
 Drawings are based on survey data and may not accurately represent what is physically present.
 Do not scale from this drawing. All dimensions are to be checked on site and any discrepancies noted in writing to the Employer's Representative. All dimensions are in millimetres unless noted otherwise.
 Where there appears to be ambiguity between the drawings and other information, the Contractor shall seek the advice of the Employer's Representative for clarification.
 Refer to drawing K06-CAG-0000 for general notes and abbreviations. For detail of Architectural Specification codes (shown on drawings as 'LIN-01', for example) refer to the Technical Reference Sheet.
 Drawings to be read in conjunction with the Architectural Specification and other relevant information, including the schedules and Engineer's documents. For individual repair locations, details and scope, refer to the repair schedule and Architectural Specification as applicable.
 Half tone line work shows scope by others. Refer to detail drawings for further scope definition.
 Demolition extent shown to face of finished openings. Refer to Structural Engineer's information for further works to form openings.
 Scope of demolition to be confirmed on site prior to works being carried out.

Package 2
 Package 6

05	23/04/10	JMP	FS	AD
Revised in relation to CCRF 0158.				
04	06/08/09	JMP	GM	AD
Updated in accordance with workshop review records KXBP-PAW-SH-0027 & KX6P-PAW-SH-00023				
03	15/05/09	JMP	GM	AD
Post Value Management coordination issue				
02	29/02/08	JMP	AD	MC
For GRIP 5B Production Information				
01	07/12/07	AS	SS	MC
Issued for GRIP Stage 5A				
Issue	Date	By	Chkd	Appd

ARUP
 13 Filzoy Street
 London W1T 4BQ
 Tel +44(0)20 7636 1531 Fax +44(0)20 7590 3624
 www.arup.com

John McAslan + Partners
 46 Prince Place London W11 4QA
 Tel +44 (0)20 7221 2800
 Fax +44 (0)20 7221 8835
 www.mcaslan.co.uk



Client
Network Rail

Job Title
 King's Cross Station
 Redevelopment Programme
 Package 6

Drawing Title
 Western Range Building
 Basement Floor Plan - Zone 2
 Demolition

Scale at A1 1:100

CCMS No

Drawing Status
For Construction

OAP Job No	Drawing No	Rev
123345-00	WRB-CAP-0021	05

Continued on WRB-CAP-0020

Continued on WRB-CAP-0022

- 1 All sanitary, kitchen fittings and joinery to be removed. Spec Ref. ALT-20k, 23 & 24
- 2 All fittings to be removed. Spec Ref. ALT-20k & 25
- 3 Floor to be removed for lift. Spec Ref. ALT-20b & 20g Refer to Structural Engineers Drawings
- 4 Floor to be removed for stair. Spec Ref. ALT-20b & 20g Refer to Structural Engineers Drawings
- 5 Openings for services as required by M+E/PH. Spec Ref. ALT-20a Refer to Structural Engineers Drawings for opening sizes.
- 6 Floor to be removed for lift, escalator pit or manhole. Spec Ref. ALT-20f Refer to Structural Engineers Drawings
- 7 Carefully remove partitions to reveal original atrium panels. Spec Ref. ALT-26 Refer to Structural Engineers Drawings
- 8 Roof to be removed for lift. Spec Ref. ALT-20a Refer to Structural Engineers Drawings
- 9 All plant to be removed Refer to M&E Engineers Drawings
- 10 Raised floor to be removed. Spec Ref. ALT-27
- 11 Floor to be removed. Spec Ref. ALT-20b & 20g Refer to Structural Engineers Drawings
- 12 Walls or partitions or windows or doors/shutters to be removed. Spec Ref. ALT-19a & ALT-19c. Refer to Structural Engineers Drawings
- 13 Stair or ladder to be removed. Spec Ref. ALT-20h Refer to Structural Engineers Drawings
- 14 Lift shaft, car and motor room equipment to be removed. Spec Ref. ALT-20j Refer to M&E and Structural information
- 15 Roof to be removed. Spec Ref. ALT-19b Refer to Structural Engineers Drawings
- 16 Demolition for new door opening Refer to Door Schedules.

All MEP wiring, plumbing, pipework and ductwork to be disconnected and removed as per specification.
 Builders work penetrations not shown on Demolition drawings.
 To be read in conjunction with the Salvage Strategy report and repair schedule.

DISCLAIMER
 Drawings are based on a survey by others and may not accurately represent what is physically present.
 All drawings must be read with reference to the specifications and by viewing the specific conditions on site.

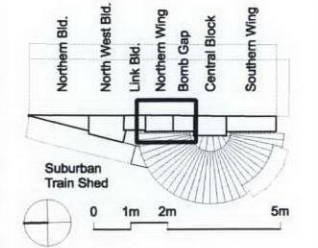
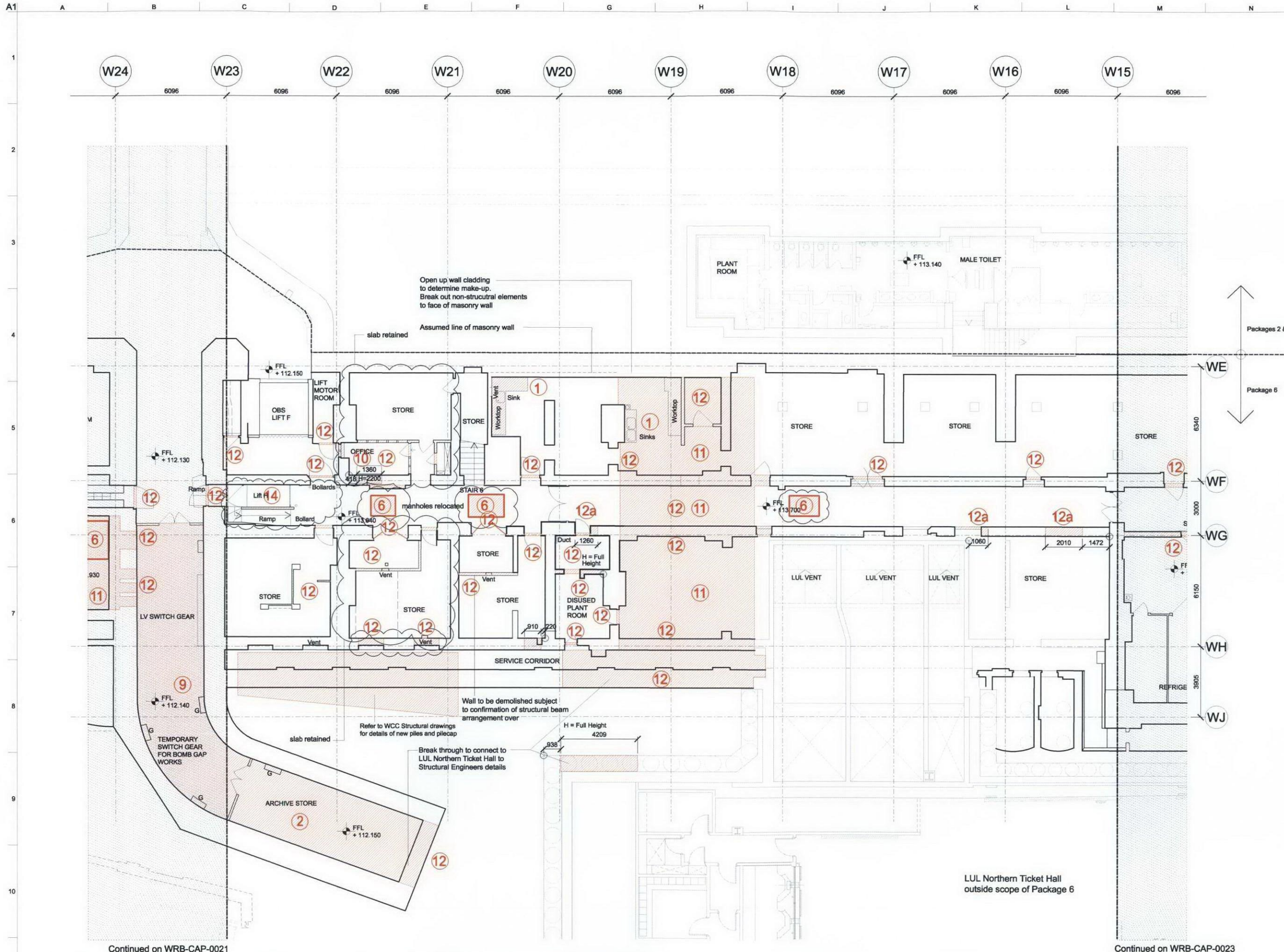

Key
 Area where elements to be removed

Notes
 Drawings are based on survey data and may not accurately represent what is physically present.
 Do not scale from this drawing. All dimensions are to be checked on site and any discrepancies noted in writing to the Employer's Representative. All dimensions are in millimetres unless noted otherwise.
 Where there appears to be ambiguity between the drawings and other information, the Contractor shall seek the advice of the Employer's Representative for clarification.

Refer to drawing KX6-CAG-0000 for general notes and abbreviations. For detail of Architectural Specification codes (shown on drawings as 'LH-01', for example) refer to the Technical Reference Sheet.

Drawings to be read in conjunction with the Architectural Specification and other relevant information, including the schedules and Engineer's documents. For individual repair locations, details and scope, refer to the repair schedule and Architectural Specification as applicable.

Half tone line work shows scope by others. Refer to detail drawings for further scope definition.
 Demolition extent shown to face of finished openings. Refer to Structural Engineer's information for further works to form openings.
 Scope of demolition to be confirmed on site prior to works being carried out.

07	23/04/10	JMP	FS	AD
Revised in relation to CCRF 0084				
06	07/08/09	JMP	GM	AD
Updated in accordance with workshop review records KX6P-PAW-SH-0027 & KX6P-PAW-SH-00023				
05	15/05/09	JMP	GM	AD
Post Value Management coordination issue				
04	31/01/09	JMP	SS	AD
Revised in accordance with GRIP 6 Value Management redesign scope				
03	20/06/08	KM	CD	AD
For GRIP 5B Production Information Door opening to be widened as noted				
02	29/02/08	JMP	AD	MC
For GRIP 5B Production Information				
01	07/12/07	GM	SS	MC
Issued for GRIP Stage 5A				
Issue	Date	By	Chkd	Appd

ARUP
 13 Fitzroy Street
 London W1T 4BQ
 Tel +44(0)20 7638 1531 Fax +44(0)20 7580 3624
 www.arup.com

John McAslan + Partners
 40 Piccadilly Place London W1Y 4QA
 Tel +44 (0)20 7722 2883
 Fax +44 (0)20 7251 8835
 www.mcaslan.co.uk

Architect
 Landscape Architect



Client
Network Rail

Job Title
 King's Cross Station
 Redevelopment Programme
 Package 6

Drawing Title
 Western Range Building
 Basement Floor Plan - Zone 3
 Demolition

Scale at A1
 1:100

CCMS No.
 Drawing Status
For Construction

OAP Job No. **123345-00** Drawing No. **WRB-CAP-0022** Rev. **07**

- 1 All sanitary, kitchen fittings and joinery to be removed. Spec Ref. ALT-20k, 23 & 24
- 2 All fittings to be removed. Spec Ref. ALT-20k & 25
- 3 Floor to be removed for lift. Spec Ref. ALT-20b & 20g Refer to Structural Engineers Drawings
- 4 Floor to be removed for stair. Spec Ref. ALT-20b & 20g Refer to Structural Engineers Drawings
- 5 Openings for services as required by M+E/PH. Spec Ref. ALT-20e Refer to Structural Engineers Drawings for opening sizes.
- 6 Floor to be removed for lift, escalator pit or manhole. Spec Ref. ALT-20f Refer to Structural Engineers Drawings
- 7 Carefully remove partitions to reveal original atrium panels. Spec Ref. ALT-26
- 8 Roof to be removed for lift. Spec Ref. ALT-20e Refer to Structural Engineers Drawings
- 9 All plant to be removed Refer to M&E Engineers Drawings
- 10 Raised floor to be removed. Spec Ref. ALT-27
- 11 Floor to be removed. Spec Ref. ALT-20b & 20g Refer to Structural Engineers Drawings
- 12 Walls or partitions or windows or doors/shutters to be removed. Spec Ref. ALT-19a & ALT-19c. Refer to Structural Engineers Drawings
- 12a Demolition for new door opening Refer to Door Schedules.
- 13 Stair or ladder to be removed. Spec Ref. ALT-20h Refer to Structural Engineers Drawings
- 14 Lift shaft, car and motor room equipment to be removed. Spec Ref. ALT-20j Refer to M&E and Structural information
- 15 Roof to be removed. Spec Ref. ALT-19b Refer to Structural Engineers Drawings

All MEP wiring, plumbing, pipework and ductwork to be disconnected and removed as per specification.
 Builders work penetrations not shown on Demolition drawings.
 To be read in conjunction with the Salvage Strategy report and repair schedule.

DISCLAIMER
 Drawings are based on a survey by others and may not accurately represent what is physically present.
 All drawings must be read with reference to the specifications and by viewing the specific conditions on site.

Continued on WRB-CAP-0021

Continued on WRB-CAP-0023

LUL Northern Ticket Hall
 outside scope of Package 6

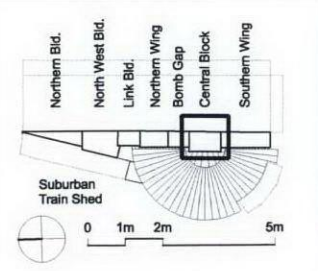
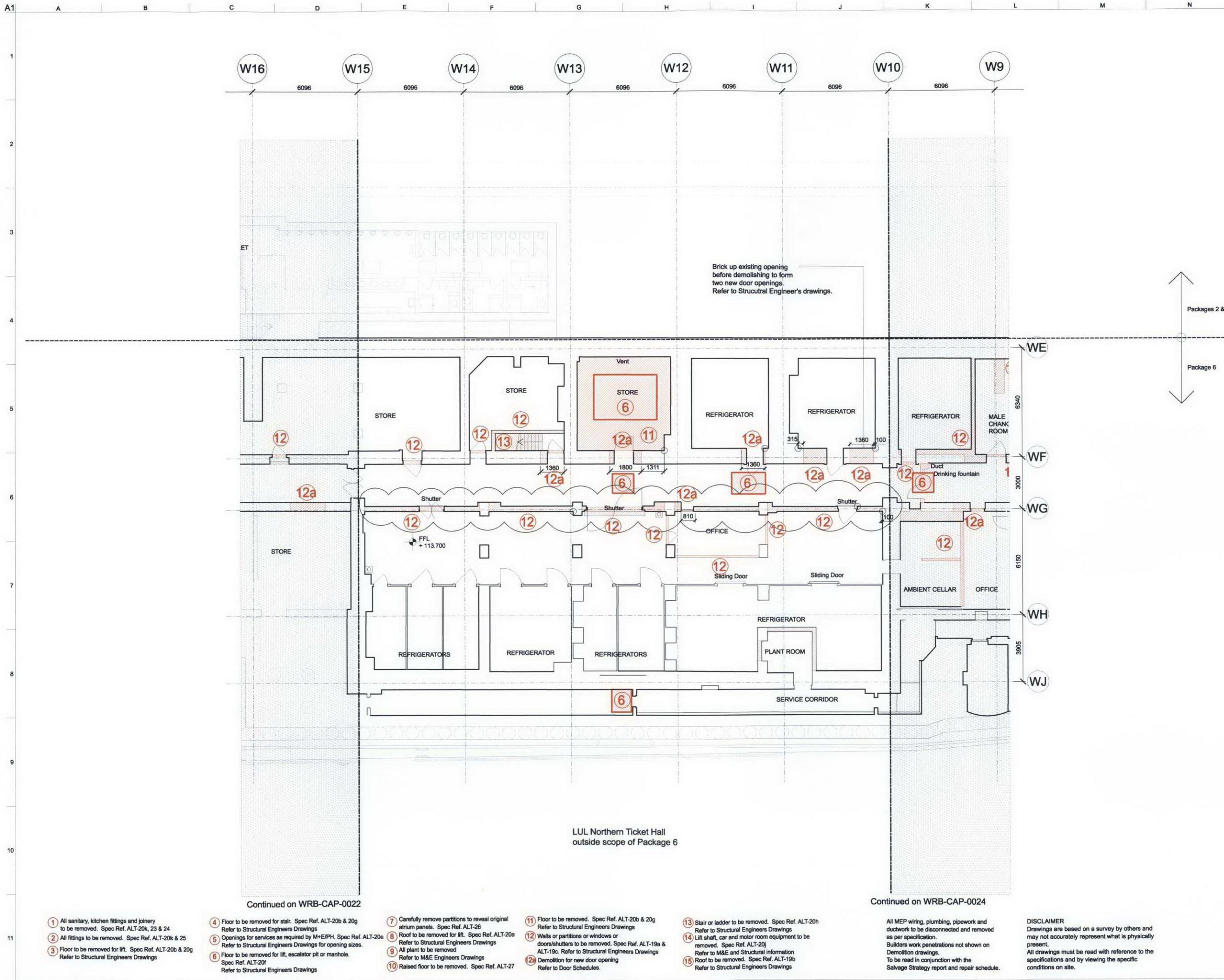

Key
 Area where elements to be removed

Notes
 Drawings are based on survey data and may not accurately represent what is physically present.
 Do not scale from this drawing. All dimensions are to be checked on site and any discrepancies noted in writing to the Employer's Representative. All dimensions are in millimetres unless noted otherwise.
 Where there appears to be ambiguity between the drawings and other information, the Contractor shall seek the advice of the Employer's Representative for clarification.
 Refer to drawing KXG-CAG-0000 for general notes and abbreviations. For detail of Architectural Specification codes (shown on drawings as 'LIN-01', for example) refer to the Technical Reference Sheet.
 Drawings to be read in conjunction with the Architectural Specification and other relevant information, including the schedules and Engineer's documents. For individual repair locations, details and scope, refer to the repair schedule and Architectural Specification as applicable.
 Half tone line work shows scope by others. Refer to detail drawings for further scope definition.
 Demolition extent shown to face of finished openings. Refer to Structural Engineer's information for further works to form openings.
 Scope of demolition to be confirmed on site prior to works being carried out.

07	23/04/10	JMP	FS	AD
Revised in relation to CCRF 0084				
06	07/08/09	JMP	GM	AD
Updated in accordance with workshop review records KX6P-PAW-SH-0027 & KX-PAW-SH-00023.				
05	15/05/09	JMP	GM	AD
Post Value Management coordination issue				
04	31/01/09	JMP	SS	AD
Revised in accordance with GRIP 6 Value management redesign scope				
03	20/06/08	KM	CD	AD
For GRIP 5B Production Information Door opening to be widened as noted				
02	29/02/08	JMP	AD	MC
For GRIP 5B Production Information				
01	07/12/07	GM	SS	MC
Issued for GRIP Stage 5A				

ARUP
 13 Fitzroy Street
 London W1T 4BQ
 Tel +44(0)20 7366 1531 Fax +44(0)20 7360 3924
 www.arup.com

John McAslan + Partners
 40 Piccadilly London W1Y 4QA
 Tel +44 (0)20 7727 2603
 Fax +44 (0)20 7221 8635
 www.mcaslan.co.uk



Client
Network Rail

Job Title
**King's Cross Station
 Redevelopment Programme
 Package 6**

Scale at A1
 1:100

Drawing Title
**Western Range Building
 Basement Floor Plan - Zone 4
 Demolition**

Scale at A1
 1:100
 CCM6 No
 Drawing Status
For Construction
 CAG Job No
123345-00 Drawing No
WRB-CAP-0023 Rev
07

- 1 All sanitary, kitchen fittings and joinery to be removed. Spec Ref. ALT-20k, 23 & 24
- 2 All fittings to be removed. Spec Ref. ALT-20k & 25
- 3 Floor to be removed for lift. Spec Ref. ALT-20b & 20g Refer to Structural Engineers Drawings
- 4 Floor to be removed for stair. Spec Ref. ALT-20b & 20g Refer to Structural Engineers Drawings
- 5 Openings for services as required by M+E/PH. Spec Ref. ALT-20e Refer to Structural Engineers Drawings for opening sizes.
- 6 Floor to be removed for lift, escalator pit or manhole. Spec Ref. ALT-20f Refer to Structural Engineers Drawings
- 7 Carefully remove partitions to reveal original atrium panels. Spec Ref. ALT-26
- 8 Roof to be removed for lift. Spec Ref. ALT-20a Refer to Structural Engineers Drawings
- 9 All plant to be removed Refer to M&E Engineers Drawings
- 10 Raised floor to be removed. Spec Ref. ALT-27
- 11 Floor to be removed. Spec Ref. ALT-20b & 20g Refer to Structural Engineers Drawings
- 12 Walls or partitions or windows or doors/shutters to be removed. Spec Ref. ALT-19a & ALT-19c. Refer to Structural Engineers Drawings
- 12a Demolition for new door opening Refer to Door Schedules.
- 13 Stair or ladder to be removed. Spec Ref. ALT-20h Refer to Structural Engineers Drawings
- 14 Lift shaft, car and motor room equipment to be removed. Spec Ref. ALT-20j Refer to M&E and Structural information
- 15 Roof to be removed. Spec Ref. ALT-19b Refer to Structural Engineers Drawings

All MEP wiring, plumbing, pipework and ductwork to be disconnected and removed as per specification.
 Builders work penetrations not shown on Demolition drawings.
 To be read in conjunction with the Salvage Strategy report and repair schedule.

DISCLAIMER
 Drawings are based on a survey by others and may not accurately represent what is physically present.
 All drawings must be read with reference to the specifications and by viewing the specific conditions on site.

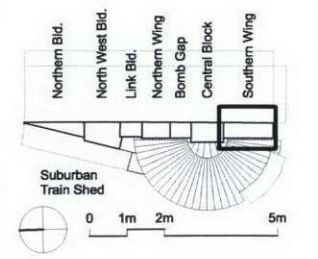
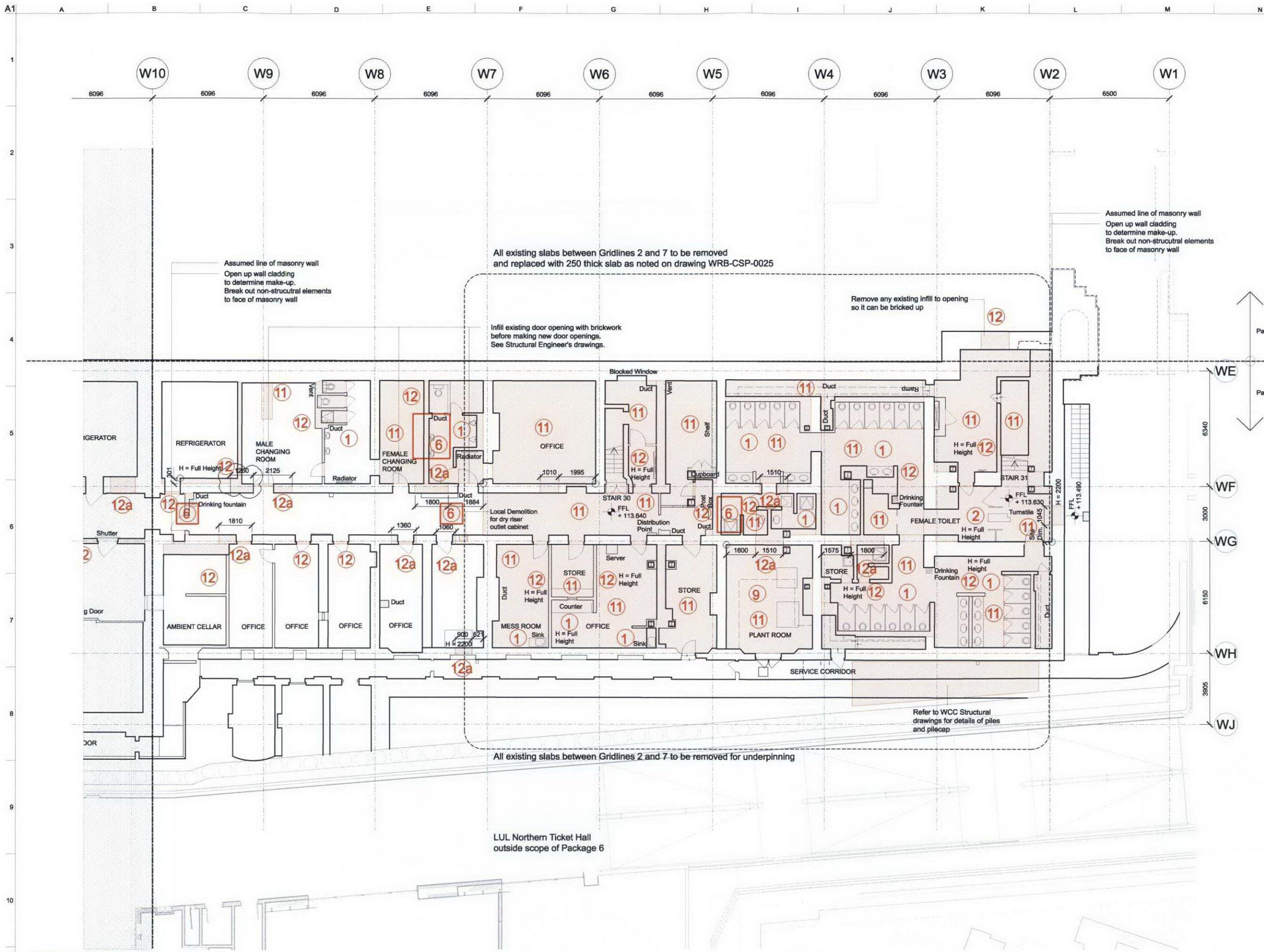

Key
 Area where elements to be removed

Notes
 Drawings are based on survey data and may not accurately represent what is physically present.
 Do not scale from this drawing. All dimensions are to be checked on site and any discrepancies noted in writing to the Employer's Representative. All dimensions are in millimetres unless noted otherwise.
 Where there appears to be ambiguity between the drawings and other information, the Contractor shall seek the advice of the Employer's Representative for clarification.
 Refer to drawing KXB-CAG-0000 for general notes and abbreviations. For detail of Architectural Specification codes (shown on drawings as 'LN-01', for example) refer to the Technical Reference Sheet.
 Drawings to be read in conjunction with the Architectural Specification and other relevant information, including the schedules and Engineer's documents. For individual repair locations, details and scope, refer to the repair schedule and Architectural Specification as applicable.
 Half tone line work shows scope by others. Refer to detail drawings for further scope definition.
 Demolition extent shown to face of finished openings. Refer to Structural Engineer's information for further works to form openings.
 Scope of demolition to be confirmed on site prior to works being carried out.

07	23/04/10	JMP	FS	AD
Revised in relation to CCRF 0084				
06	07/08/09	JMP	GM	AD
Updated in accordance with workshop review records KXBP-PAW-SH-0027 & KXBP-PAW-SH-00023				
05	15/05/09	JMP	GM	AD
Post Value Management coordination issue				
04	31/01/09	JMP	SS	AD
Revised in accordance with GRIP 6 Value management redesign scope				
03	20/06/08	KM	CD	AD
For GRIP 5B Production Information Door openings to be widened as noted				
02	29/02/08	JMP	AD	MC
For GRIP 5B Production Information				
01	07/12/07	GM	SS	MC
Issued for GRIP Stage 5A				

ARUP
 13 Fitzroy Street
 London W1T 4BQ
 Tel +44(0)20 7636 1531 Fax +44(0)20 7580 3524
 www.arup.com

John McAslan + Partners
 40 Phoenix Place London W1T 4GA
 Tel +44 (0)20 7722 2000
 Fax +44 (0)20 7221 8835
 www.mcaslan.co.uk



Client
Network Rail

Job Title
**King's Cross Station
 Redevelopment Programme
 Package 6**

Scale at A1
 1:100

Drawing Title
**Western Range Building
 Basement Floor Plan - Zone 5
 Demolition**

For Construction
 GMP Job No: 123345-00
 Drawing No: WRB-CAP-0024
 Rev: 07

- Continued on WRB-CAP-0023
- 1 All sanitary, kitchen fittings and joinery to be removed. Spec Ref. ALT-20k, 23 & 24
 - 2 All fittings to be removed. Spec Ref. ALT-20k & 25
 - 3 Floor to be removed for lift. Spec Ref. ALT-20b & 20g Refer to Structural Engineers Drawings
 - 4 Floor to be removed for stair. Spec Ref. ALT-20b & 20g Refer to Structural Engineers Drawings
 - 5 Openings for services as required by M+E/PH. Spec Ref. ALT-20b Refer to Structural Engineers Drawings for opening sizes.
 - 6 Floor to be removed for lift, escalator pit or manhole. Spec Ref. ALT-20f Refer to Structural Engineers Drawings
 - 7 Carefully remove partitions to reveal original atrium panels. Spec Ref. ALT-26
 - 8 Roof to be removed for lift. Spec Ref. ALT-20a Refer to Structural Engineers Drawings
 - 9 All plant to be removed Refer to M&E Engineers Drawings
 - 10 Raised floor to be removed. Spec Ref. ALT-27
 - 11 Floor to be removed. Spec Ref. ALT-20b & 20g Refer to Structural Engineers Drawings
 - 12 Walls or partitions or windows or doors/shutters to be removed. Spec Ref. ALT-19a & ALT-19c. Refer to Structural Engineers Drawings
 - 13 Stair or ladder to be removed. Spec Ref. ALT-20h Refer to Structural Engineers Drawings
 - 14 Lift shaft, car and motor room equipment to be removed. Spec Ref. ALT-20j
 - 15 Roof to be removed. Spec Ref. ALT-19b Refer to Structural Engineers Drawings
 - 16 All MEP wiring, plumbing, pipework and ductwork to be disconnected and removed as per specification. Builders work penetrations not shown on Demolition drawings. To be read in conjunction with the Salvage Strategy report and repair schedule.

DISCLAIMER
 Drawings are based on a survey by others and may not accurately represent what is physically present. All drawings must be read with reference to the specifications and by viewing the specific conditions on site.

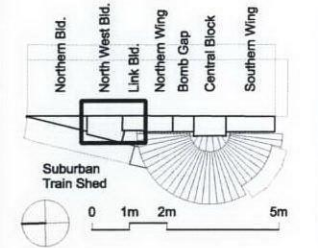
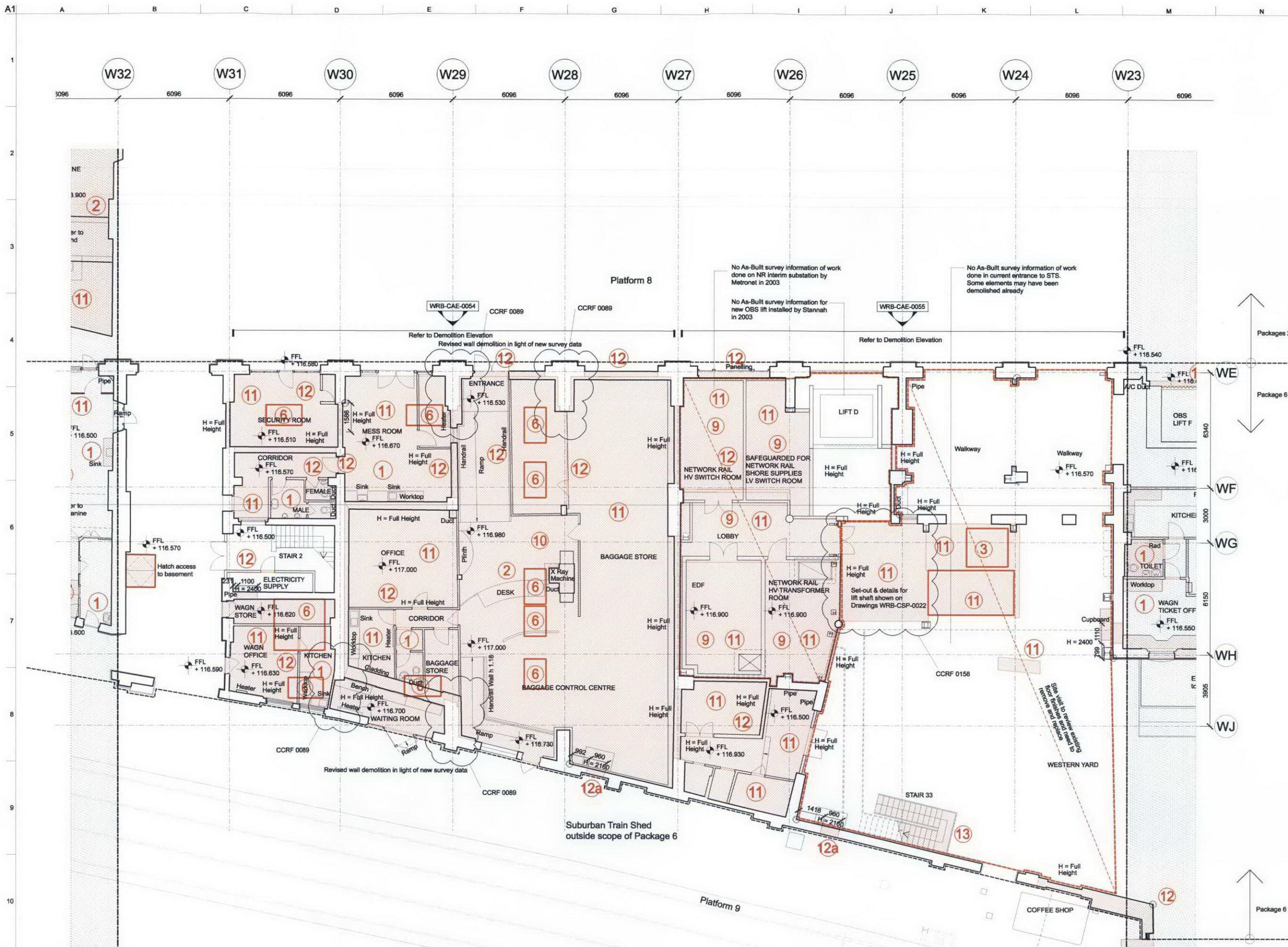

Key
 Area where elements to be removed

Notes
 Drawings are based on survey data and may not accurately represent what is physically present.
 Do not scale from this drawing. All dimensions are to be checked on site and any discrepancies noted in writing to the Employer's Representative. All dimensions are in millimetres unless noted otherwise.
 Where there appears to be ambiguity between the drawings and other information, the Contractor shall seek the advice of the Employer's Representative for clarification.
 Refer to drawing KX6-CAG-0000 for general notes and abbreviations. For detail of Architectural Specification codes (shown on drawings as 'LN-01', for example) refer to the Technical Reference Sheet.
 Drawings to be read in conjunction with the Architectural Specification and other relevant information, including the schedules and Engineer's documents. For individual repair locations, details and scope, refer to the repair schedule and Architectural Specification as applicable.
 Half tone line work shows scope of works. Refer to detail drawings for further scope definition.
 Demolition extent shown to face of finished openings. Refer to Structural Engineer's Information for further works to form openings.
 Scope of demolition to be confirmed on site prior to works being carried out.

08	23/04/10	JMP	FS	AD
Revised in relation to CCRF 0089, 0158.				
07	07/08/09	JMP	GM	AD
Updated in accordance with workshop review records KX6P-PAW-SH-0027 & KX6P-PAW-SH-00023				
06	15/05/09	JMP	GM	AD
Post Value Management coordination issue				
05	30/03/09	GM	KM	AD
CTQ-00546 floor slabs demolished. Pier between Grids W23 & W24 not demolished. New door on Grid W31 not required.				
04	31/01/09	JMP	SS	AD
Revised in accordance with GRIP 6 value management redesign scope				
03	29/02/08	JMP	AD	MC
For GRIP 5B Production Information				

ARUP
 13 Finsbury Street
 London W1T 4BQ
 Tel +44(0)20 7638 1531 Fax +44(0)20 7580 3924
 www.arup.com

John McAslan + Partners
 40 Phoenix Place London W11 4GA
 Tel +44 (0)20 7221 2863
 Fax +44 (0)20 7221 8838
 www.mcaslan.co.uk



Client
Network Rail

Job Title
**King's Cross Station
 Redevelopment Programme
 Package 6**

Drawing Title
**Western Range Building
 Ground Floor Plan - Zone 2
 Demolition**

Scale at A1 1:100
 CCMS No
 Drawing Status
For Construction
 OAP Job No 123345-00 Drawing No WRB-CAP-0026 Rev. 08

Continued on WRB-CAP-0025

Continued on STS-CAP-0060 Continued on WRB-CAP-0027

- 1 All sanitary, kitchen fittings and joinery to be removed. Spec Ref. ALT-20k, 23 & 24
- 2 All fittings to be removed. Spec Ref. ALT-20k & 25
- 3 Floor to be removed for lift. Spec Ref. ALT-20b & 20g Refer to Structural Engineers Drawings
- 4 Floor to be removed for stair. Spec Ref. ALT-20b & 20g Refer to Structural Engineers Drawings
- 5 Openings for services as required by M+E/PH. Spec Ref. ALT-20a Refer to Structural Engineers Drawings for opening sizes.
- 6 Floor to be removed for lift, escalator pit or manhole. Spec Ref. ALT-20f Refer to Structural Engineers Drawings
- 7 Carefully remove partitions to reveal original atrium panels. Spec Ref. ALT-26
- 8 Roof to be removed for lift. Spec Ref. ALT-20a Refer to Structural Engineers Drawings
- 9 All plant to be removed Refer to M&E Engineers Drawings
- 10 Raised floor to be removed. Spec Ref. ALT-27
- 11 Floor to be removed. Spec Ref. ALT-20b & 20g Refer to Structural Engineers Drawings
- 12 Walls or partitions or windows or doors/shutters to be removed. Spec Ref. ALT-19a & ALT-19c. Refer to Structural Engineers Drawings
- 12a Demolition for new door opening Refer to Door Schedules.
- 13 Stair or ladder to be removed. Spec Ref. ALT-20h Refer to Structural Engineers Drawings
- 14 Lift shaft, car and motor room equipment to be removed. Spec Ref. ALT-20j Refer to M&E and Structural Information
- 15 Roof to be removed. Spec Ref. ALT-19b Refer to Structural Engineers Drawings

All MEP wiring, plumbing, pipework and ductwork to be disconnected and removed as per specification.
 Builders work penetrations not shown on Demolition drawings.
 To be read in conjunction with the Salvage Strategy report and repair schedule.

DISCLAIMER
 Drawings are based on a survey by others and may not accurately represent what is physically present.
 All drawings must be read with reference to the specifications and by viewing the specific conditions on site.

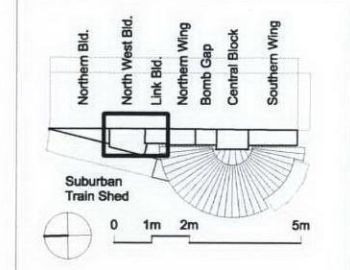
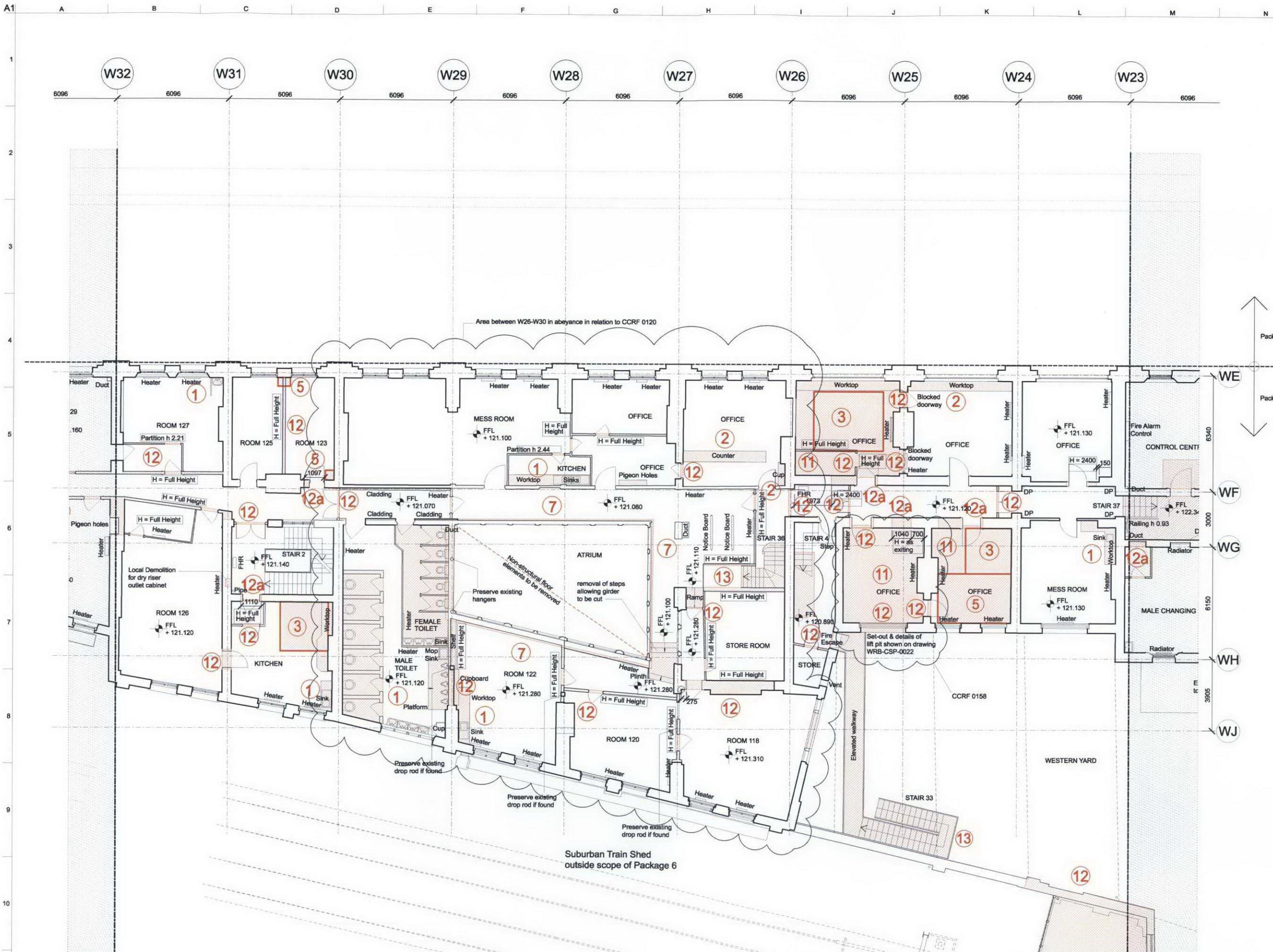

Key
 Area where elements to be removed

Notes
 Drawings are based on survey data and may not accurately represent what is physically present.
 Do not scale from this drawing. All dimensions are to be checked on site and any discrepancies noted in writing to the Employer's Representative. All dimensions are in millimetres unless noted otherwise.
 Where there appears to be ambiguity between the drawings and other information, the Contractor shall seek the advice of the Employer's Representative for clarification.
 Refer to drawing KX6-CAG-0000 for general notes and abbreviations. For detail of Architectural Specification codes (shown on drawings as 'LIN-01', for example) refer to the Technical Reference Sheet.
 Drawings to be read in conjunction with the Architectural Specification and other relevant information, including the schedules and Engineer's documents. For individual repair locations, details and scope, refer to the repair schedule and Architectural Specification as applicable.
 Half tone line work shows scope by others. Refer to detail drawings for further scope definition.
 Demolition extent shown to face of finished openings. Refer to Structural Engineer's information for further works to form openings.
 Scope of demolition to be confirmed on site prior to works being carried out.

Issue	Date	By	Chkd	Appd
06	23/04/10	JMP	FS	AD
Revised in relation to CCRF 0158 and 0120				
05	07/08/09	JMP	GM	AD
Updated in accordance with workshop review records KX6P-PAW-SH-0027 & KX6P-PAW-SH-000023				
04	15/05/09	JMP	GM	AD
Post Value Management coordination issue				
03	31/01/09	JMP	SS	AD
Revised in accordance with GRIP 6 Value management redesign scope				
02	29/02/08	JMP	AD	MC
For GRIP 5B Production Information				
01	07/12/07	GM	SS	MC
Issued for GRIP Stage 5A				

ARUP
 15 Fitzroy Street
 London W1T 4BQ
 Tel +44(0)20 7638 1531 Fax +44(0)20 7590 3624
 www.arup.com

John McAslan + Partners
 49 Piccadilly London W1A 1GA
 Tel +44 (0)20 7727 2603
 Fax +44 (0)20 7721 8939
 www.mcaslan.co.uk

Architect
 Landscape Architect

Client
Network Rail

Job Title
King's Cross Station Redevelopment Programme Package 6

Drawing Title
Western Range Building First Floor Plan - Zone 2 Demolition

Scale at A1 1:100

CCMS No

Drawing Status
For Construction

OAP Job No	Drawing No	Rev
123345-00	WRB-CAP-0031	06

Continued on WRB-CAP-0030

- 1 All sanitary, kitchen fittings and joinery to be removed. Spec Ref. ALT-20k, 23 & 24
- 2 All fittings to be removed. Spec Ref. ALT-20k & 25
- 3 Floor to be removed for lift. Spec Ref. ALT-20b & 20g Refer to Structural Engineers Drawings

- 4 Floor to be removed for stair. Spec Ref. ALT-20b & 20g Refer to Structural Engineers Drawings
- 5 Openings for services as required by M+E/PH. Spec Ref. ALT-20a Refer to Structural Engineers Drawings for opening sizes.
- 6 Floor to be removed for lift, escalator pit or manhole. Spec Ref. ALT-20f Refer to Structural Engineers Drawings

- 7 Carefully remove partitions to reveal original atrium panels. Spec Ref. ALT-26
- 8 Roof to be removed for lift. Spec Ref. ALT-20a Refer to Structural Engineers Drawings
- 9 All plant to be removed Refer to M&E Engineers Drawings
- 10 Raised floor to be removed. Spec Ref. ALT-27

- 11 Floor to be removed. Spec Ref. ALT-20b & 20g Refer to Structural Engineers Drawings
- 12 Walls or partitions or windows or doors/shutters to be removed. Spec Ref. ALT-19a & ALT-19c. Refer to Structural Engineers Drawings
- 28 Demolition for new door opening Refer to Door Schedules.

- 13 Stair or ladder to be removed. Spec Ref. ALT-20h Refer to Structural Engineers Drawings
- 14 Lift shaft, car and motor room equipment to be removed. Spec Ref. ALT-20j Refer to M&E and Structural information
- 15 Roof to be removed. Spec Ref. ALT-19b Refer to Structural Engineers Drawings

All MEP wiring, plumbing, pipework and ductwork to be disconnected and removed as per specification.
 Builders work penetrations not shown on Demolition drawings.
 To be read in conjunction with the Salvage Strategy report and repair schedule.

DISCLAIMER
 Drawings are based on a survey by others and may not accurately represent what is physically present.
 All drawings must be read with reference to the specifications and by viewing the specific conditions on site.

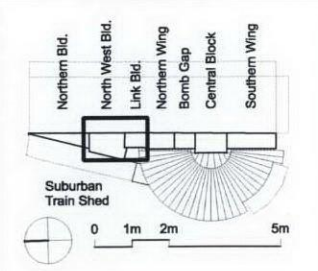

Key
 Area where elements to be removed

Notes
 Drawings are based on survey data and may not accurately represent what is physically present.
 Do not scale from this drawing. All dimensions are to be checked on site and any discrepancies noted in writing to the Employer's Representative. All dimensions are in millimetres unless noted otherwise.
 Where there appears to be ambiguity between the drawings and other information, the Contractor shall seek the advice of the Employer's Representative for clarification.
 Refer to drawing KXG-CAG-0000 for general notes and abbreviations. For detail of Architectural Specification codes (shown on drawings as 'LIN-01', for example) refer to the Technical Reference Sheet.
 Drawings to be read in conjunction with the Architectural Specification and other relevant information, including the schedules and Engineer's documents. For individual repair locations, details and scope, refer to the repair schedule and Architectural Specification as applicable.
 Half line work shows scope for others. Refer to detail drawings for further scope definition.
 Demolition extent shown to face of finished openings. Refer to Structural Engineer's information for further works to form openings.
 Scope of demolition to be confirmed on site prior to works being carried out.

05	23/04/10	JMP	FS	AD
Revised in relation to CCRF 0158 and 0120				
04	07/08/09	JMP	GM	AD
Updated in accordance with workshop review records KXBP-PAW-SH-0027 & KXBP-PAW-SH-000023				
03	15/05/09	JMP	GM	AD
Post Value Management coordination issue				
02	29/02/08	JMP	AD	MC
For GRIP 5B Production Information				
01	07/12/07	GM	SS	MC
Issued for GRIP Stage 5A				

Issue	Date	By	Chkd	Appd
05	23/04/10	JMP	FS	AD
04	07/08/09	JMP	GM	AD
03	15/05/09	JMP	GM	AD
02	29/02/08	JMP	AD	MC
01	07/12/07	GM	SS	MC

ARUP
 13 Fitzroy Street
 London W1T 4BQ
 Tel: +44 (0)20 7536 1531 Fax: +44(0)20 7580 3624
 www.arup.com

John McAslan + Partners
 48 Prince Place London W11 4QA
 Tel: +44 (0)20 7727 2663
 Fax: +44 (0)20 7221 8835
 www.mcaslan.co.uk



Client
Network Rail

Job Title
**King's Cross Station
 Redevelopment Programme
 Package 6**

Scale at A1
 1:100

Drawing Status
For Construction
 OAP Job No: 123345-00
 Drawing No: WRB-CAP-0037
 Rev: 05

Continued on WRB-CAP-0036

Continued on WRB-CAP-0038

- 1 All sanitary, kitchen fittings and joinery to be removed. Spec Ref. ALT-20k, 23 & 24
- 2 All fittings to be removed. Spec Ref. ALT-20k & 25
- 3 Floor to be removed for lift. Spec Ref. ALT-20b & 20g Refer to Structural Engineers Drawings
- 4 Floor to be removed for stair. Spec Ref. ALT-20b & 20g Refer to Structural Engineers Drawings
- 5 Openings for services as required by M+E/PH. Spec Ref. ALT-20e Refer to Structural Engineers Drawings for opening sizes.
- 6 Floor to be removed for lift, escalator pit or manhole. Spec Ref. ALT-20f Refer to Structural Engineers Drawings
- 7 Carefully remove partitions to reveal original atrium panels. Spec Ref. ALT-26
- 8 Roof to be removed for lift. Spec Ref. ALT-20a Refer to Structural Engineers Drawings
- 9 All plant to be removed Refer to M&E Engineers Drawings
- 10 Raised floor to be removed. Spec Ref. ALT-27
- 11 Floor to be removed. Spec Ref. ALT-20b & 20g Refer to Structural Engineers Drawings
- 12 Walls or partitions or windows or doors/shutters to be removed. Spec Ref. ALT-19a & ALT-19c. Refer to Structural Engineers Drawings
- 12a Demolition for new door opening Refer to Door Schedules.
- 13 Stair or ladder to be removed. Spec Ref. ALT-20h Refer to Structural Engineers Drawings
- 14 Lift shaft, car and motor room equipment to be removed. Spec Ref. ALT-20j
- 15 Roof to be removed. Spec Ref. ALT-19b Refer to Structural Engineers Drawings

All MEP wiring, plumbing, pipework and ductwork to be disconnected and removed as per specification.
 Builders work penetrations not shown on Demolition drawings.
 To be read in conjunction with the Salvage Strategy report and repair schedule.

DISCLAIMER
 Drawings are based on a survey by others and may not accurately represent what is physically present.
 All drawings must be read with reference to the specifications and by viewing the specific conditions on site.