

BASEMENT FLOOR PLAN ZONE 5 – CONSENTED DEMOLITIONS

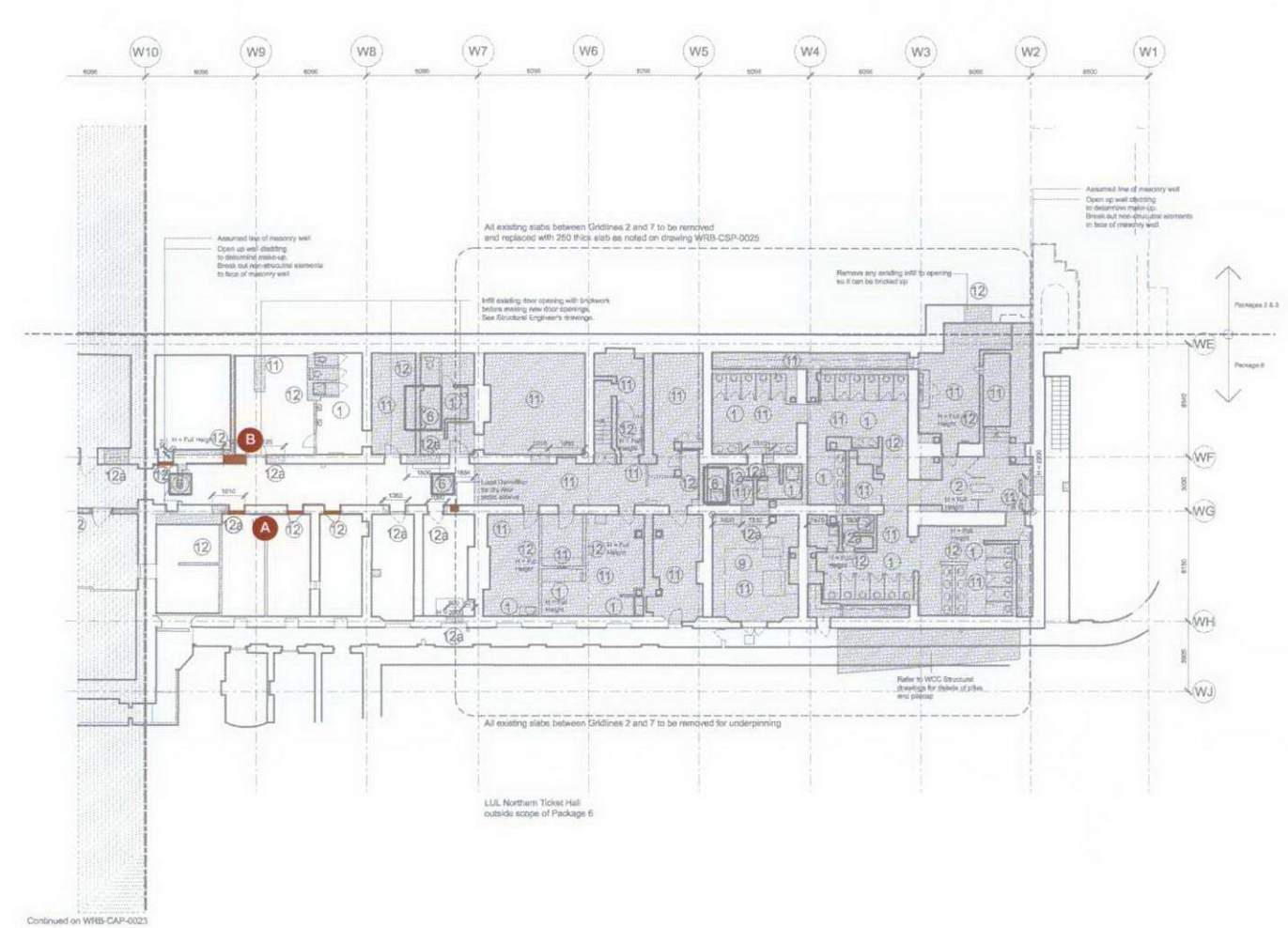

BASEMENT FLOOR PLAN ZONE 5 – PROPOSED DEMOLITIONS

- A** Doors to be removed or blocked up are non-historic, have been identified as 'not for salvage' and are to be removed as they are no longer fit for purpose
- B** Masonry section removed due to new survey data and further structural investigations on-site

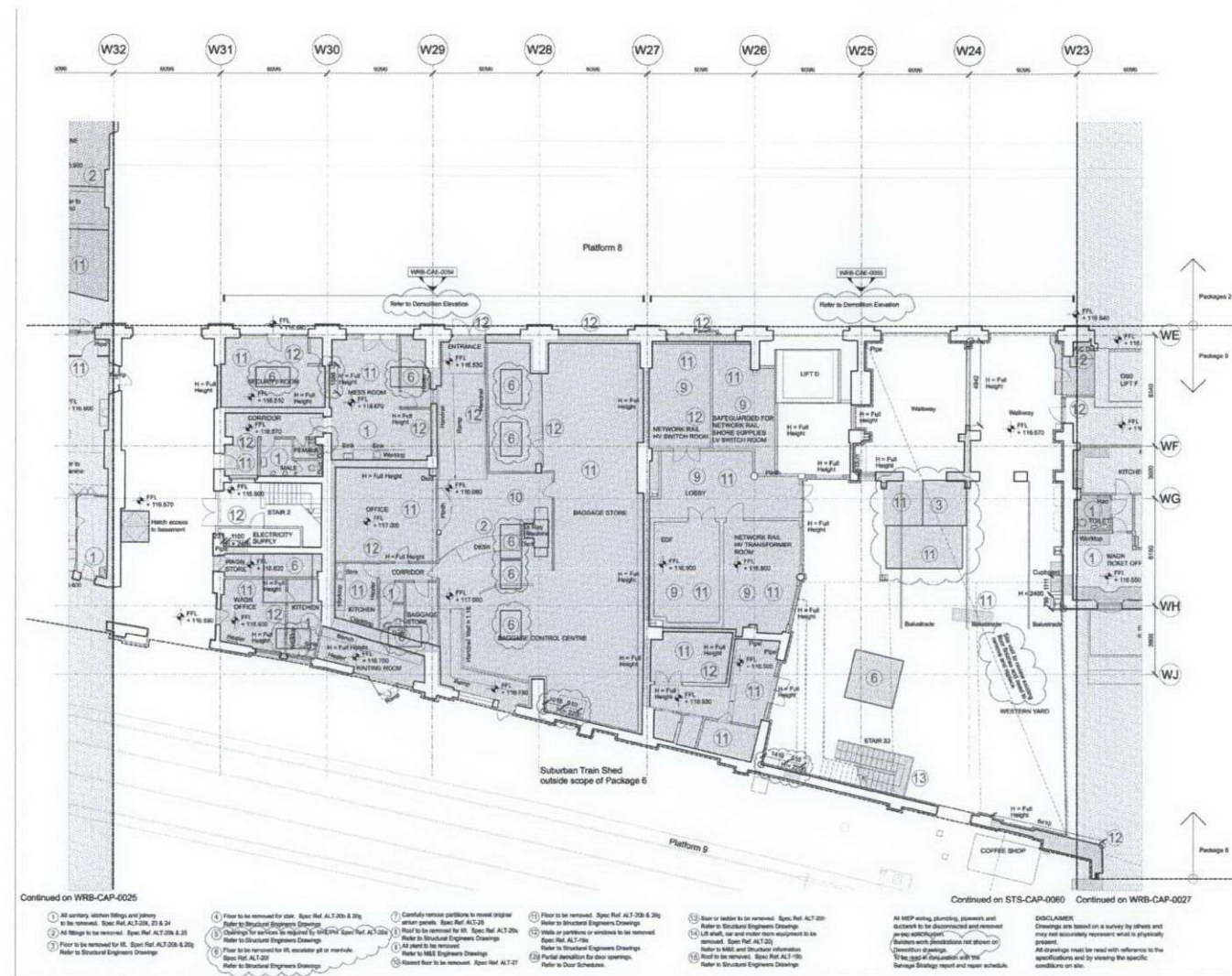

GROUND FLOOR PLAN ZONE 2 - CONSENTED DEMOLITIONS

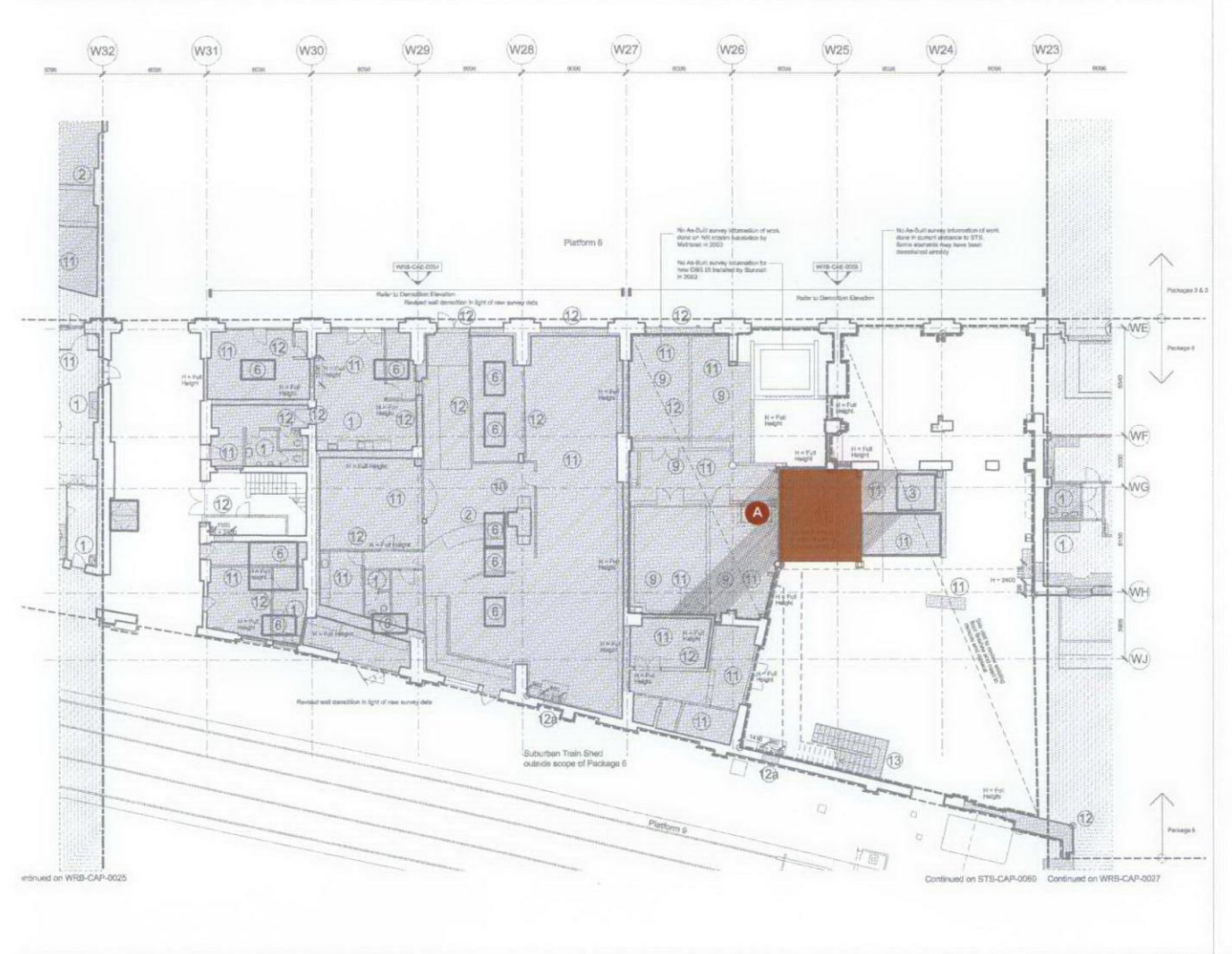

GROUND FLOOR PLAN ZONE 2 - PROPOSED DEMOLITIONS

A Section of floor removed to accommodate new Lift - nature of works covered in consented specification

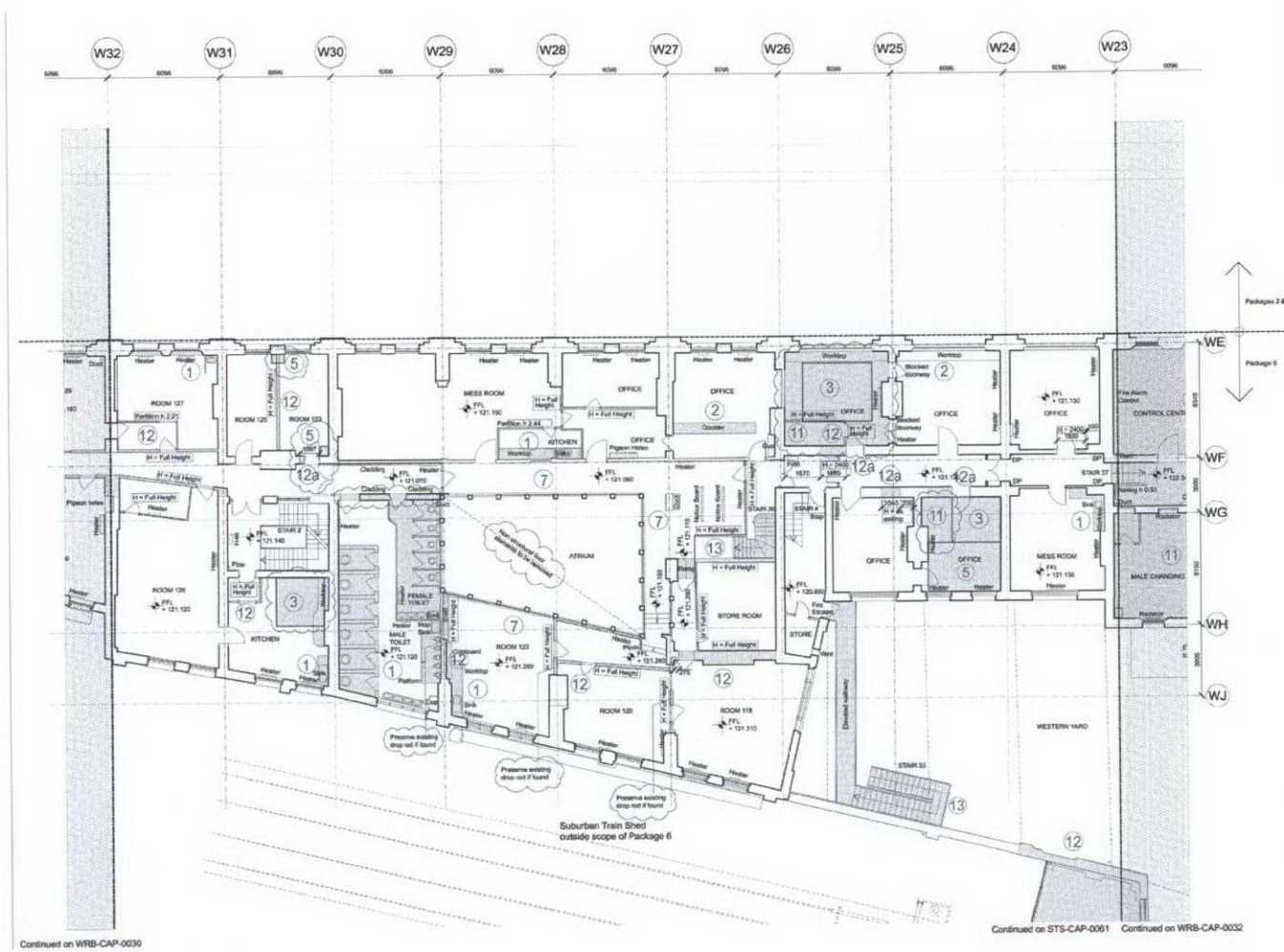

FIRST FLOOR PLAN ZONE 2 - CONSENTED DEMOLITIONS

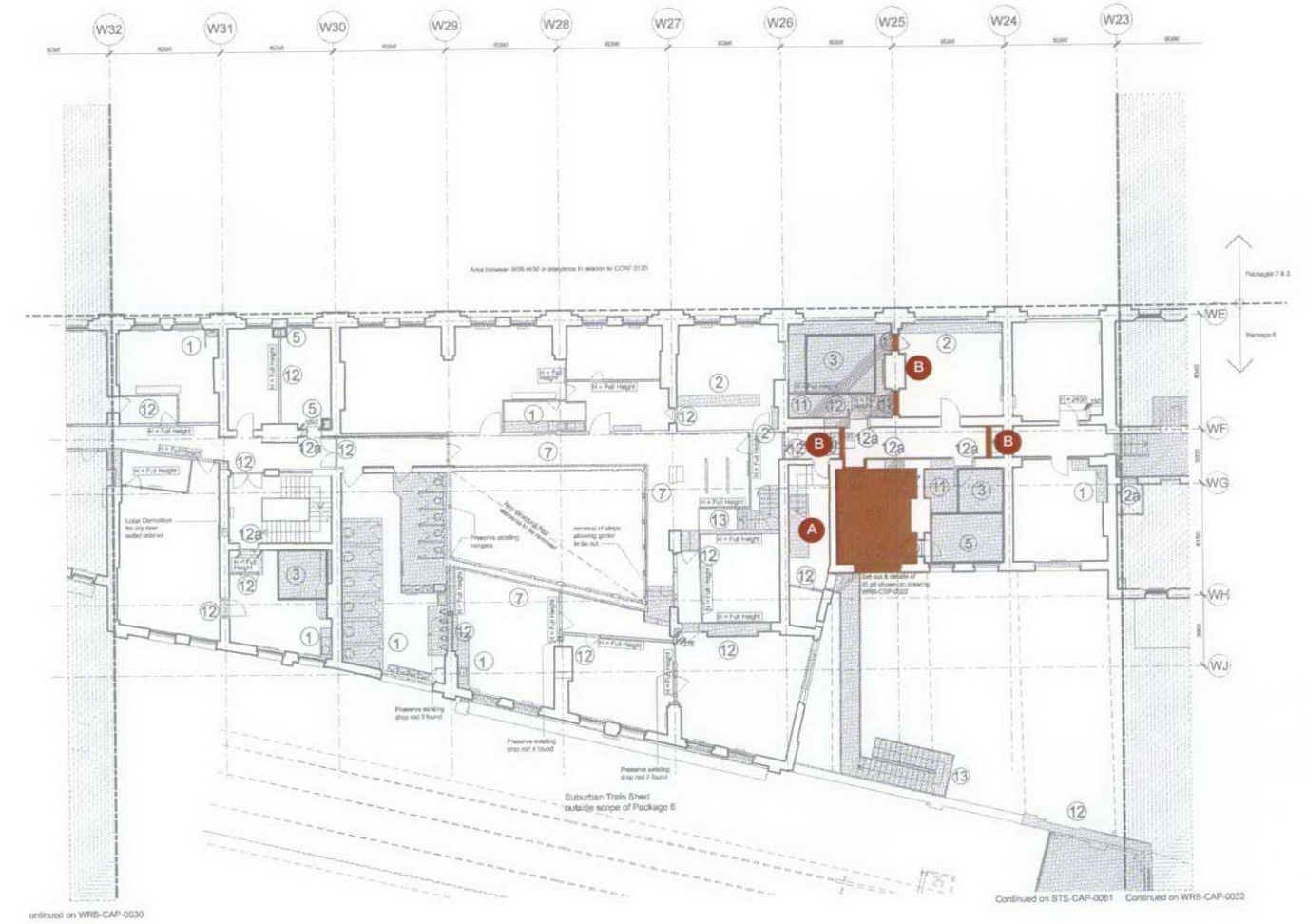

FIRST FLOOR PLAN ZONE 2 - PROPOSED DEMOLITIONS

- A** Section of floor removed to accommodate new Lift - nature of works covered in consented specification
- B** Doors to be removed or blocked. Doors that are historic have been identified for salvage and re-use within the building

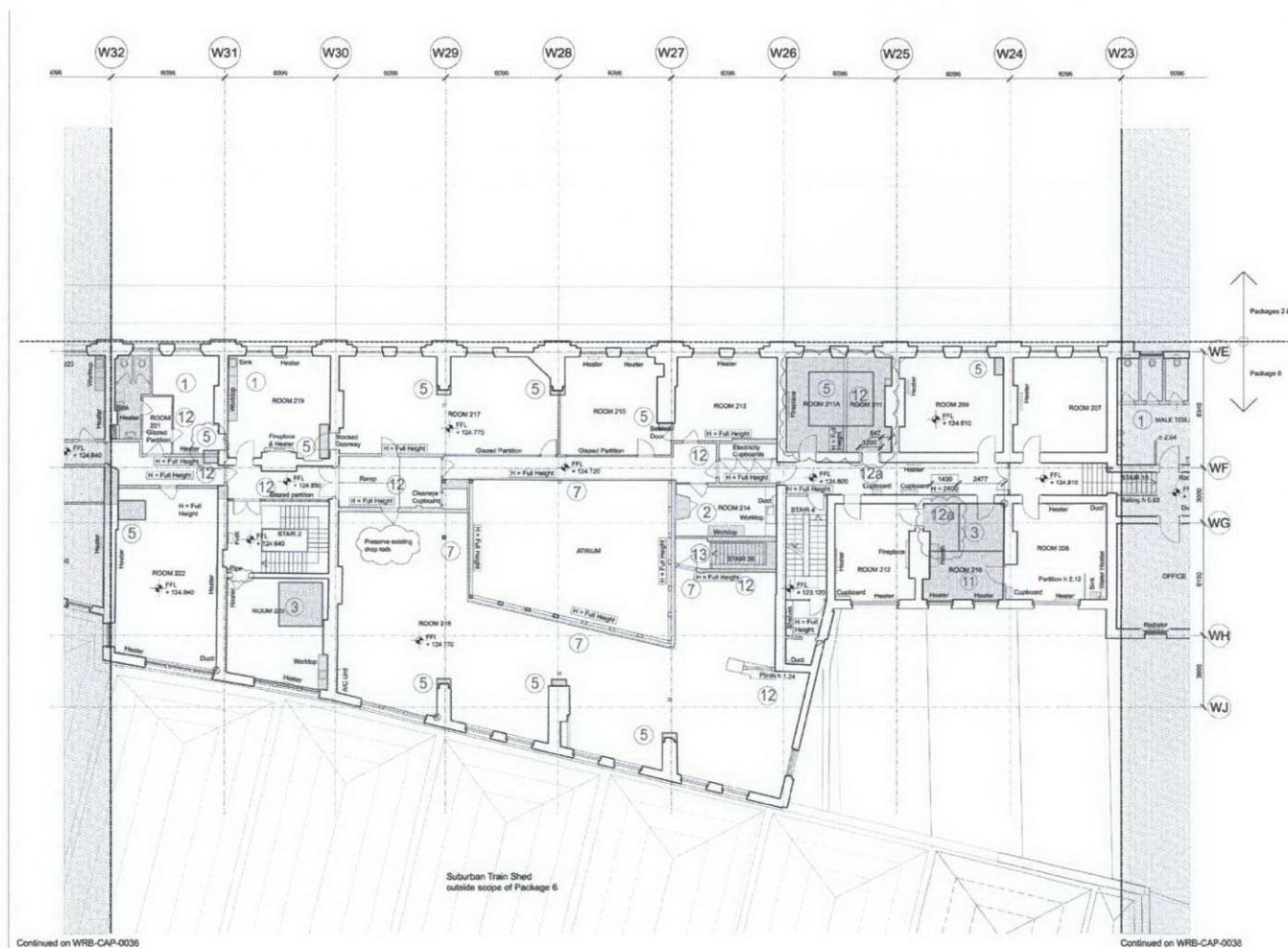

SECOND FLOOR PLAN ZONE 2 - CONSENTED DEMOLITIONS

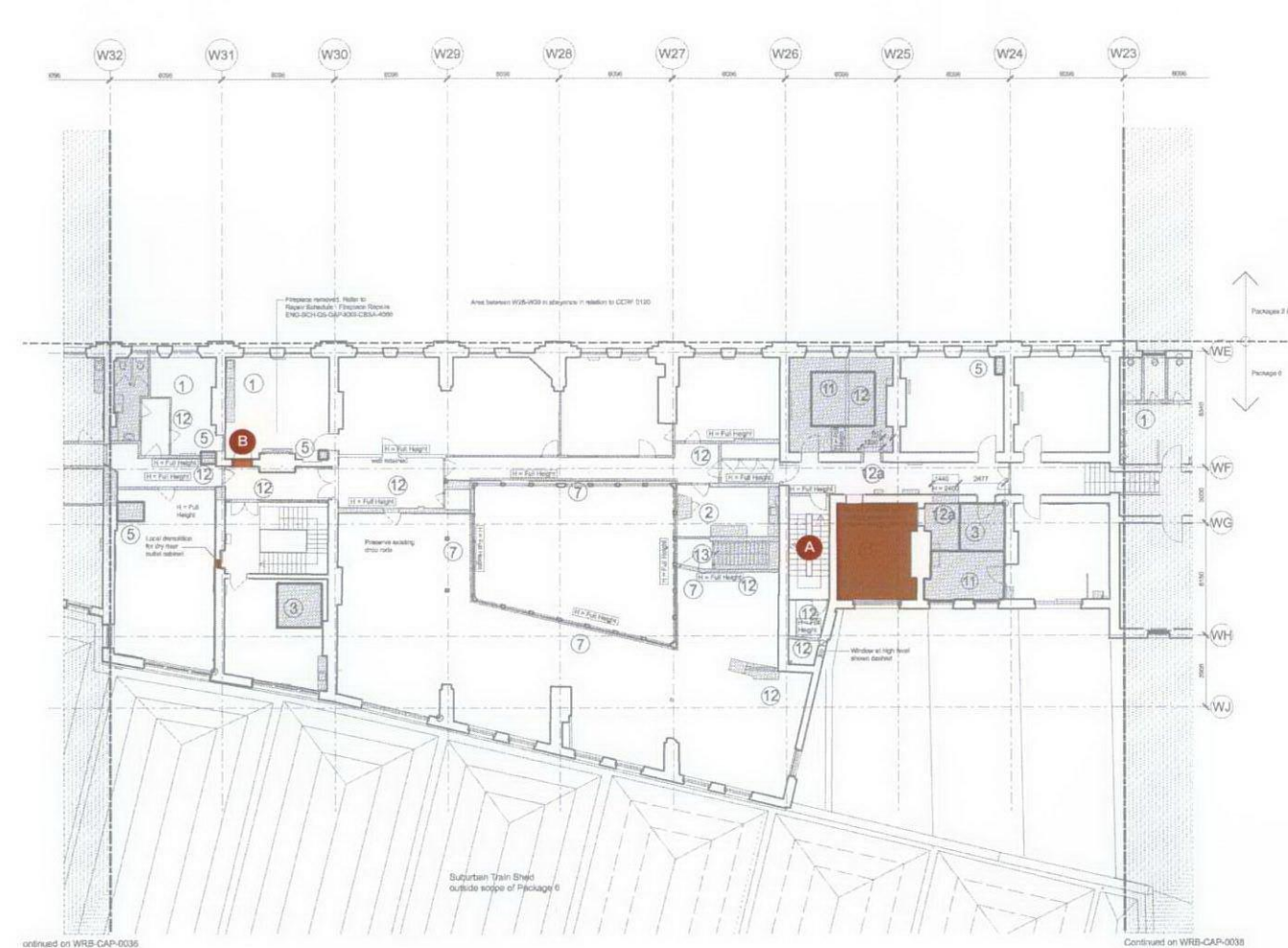

SECOND FLOOR PLAN ZONE 2 - PROPOSED DEMOLITIONS

- A** Section of floor removed to accommodate new Lift - nature of works covered in consented specification
- B** Doors to be removed or blocked. Doors that are historic have been identified for salvage and re-use within the building

3 Conclusions

In order to carry out the station redevelopment project, some limited demolition of historic fabric in the Grade 1 Listed buildings of the station is necessary. The work will be carried out with care and with specific controls on methods used to prevent damage to historic fabric that is intended to remain. Design has minimised the extent of demolition to that required for functional purposes in the new Western Concourse of the station, as described in the planning consented scheme.

Method statements for particular elements of demolition will be submitted for approval by the Package 6 Contractor.

Appendix A

List of Abbreviations

A1 List of Abbreviations

AIP—Approval in Principle
 BS—British Standard
 CAD—Computer Aided Drafting
 C&S – civil and structural
 CCMS—Corporate Content Management system
 CCTV—Closed Circuit Television
 CDM—Construction (Design & Management)
 CIS—Customer Information System
 DDA—Disability Discrimination Act
 DRA—Designer's Risk Assessment
 DfT—Department for Transport
 EACS – Electronic Access Control System
 EMC - Electro Magnetic Compatibility
 ER—Employer's Representative
 ERB – Eastern Range Building
 FCC- First Capital Connect (a TOC)
 FSR – Fire Strategy Report
 FSW - Footbridge and subway works
 FAS - Fire Alarm System,
 GNH - Great Northern Hotel
 GRIP - Guide to Rail Investment Projects
 HAZOP – Hazard Operability Studies
 HAZID – Hazard Identification
 HSQE - Health, Safety, Quality & Environment
 IDC – Inter-Discipline Check
 IP – Ingress Protection
 ITA - Independent Technical Assessment
 ITP - Inspection & Test Plan
 KXRP - King's Cross Station Redevelopment Programme
 LMR - Lift Motor Room
 LNE - London North Eastern
 LPR - Link Plant Room or Network Rail Plant Room
 LUL – London Underground Limited
 MEP – Mechanical Electrical and Public Health Services
 MFTC - Multi Discipline Framework Consultancy
 MIP – Mobility Impaired Person
 MTBF – Mean Time Between Failures
 MTS – Main Train Shed

MTTR – Mean Time to Repair
 NRPR – Network Rail Plant Room or Link Plant Room
 NR - Network Rail
 NRG - Network Records Group
 NRSP - National Rail Security Programme
 NTH - Northern Ticket Hall
 O&M – Operation and Maintenance Manual
 OBS - On Board Servicing
 OLE - Overhead Line Equipment
 PAVA - Public Address / Voice Alarm
 PMO - Programme Management Office
 PPE – Personnel Protective Equipment
 PV – Photo-voltaic
 QA – Quality Assurance
 RAM - Reliability, Availability, Maintainability
 RIBA - Royal Institute of British Architects
 RICS - Royal Institution of Chartered Surveyors
 ROGS - Railway and Other Guided transport Systems
 SCN - Station Change Notice
 SCR – Station Control Room
 SMM7 - Standard Method of Measurement (for Building Works) 7th Edition
 SOR—Station Operations Room (included in and synonymous with Station Control Room)
 SSY – Shared Service Yard
 STS - Suburban Train Shed Buildings
 TBS - Task Briefing Sheet
 TOC - Train Operating Company
 TRANSEC - Transport Security
 VE - Value Engineering
 WCC - Western Concourse (Package 6) – synonymous with WCR
 WCR - Western Concourse (Package 6)
 WI – Works Information
 WRB - Western Range Buildings (Package 6)
 WBS - Work Breakdown Structure
 WPP - Work Package Plan

Appendix B

Location Map

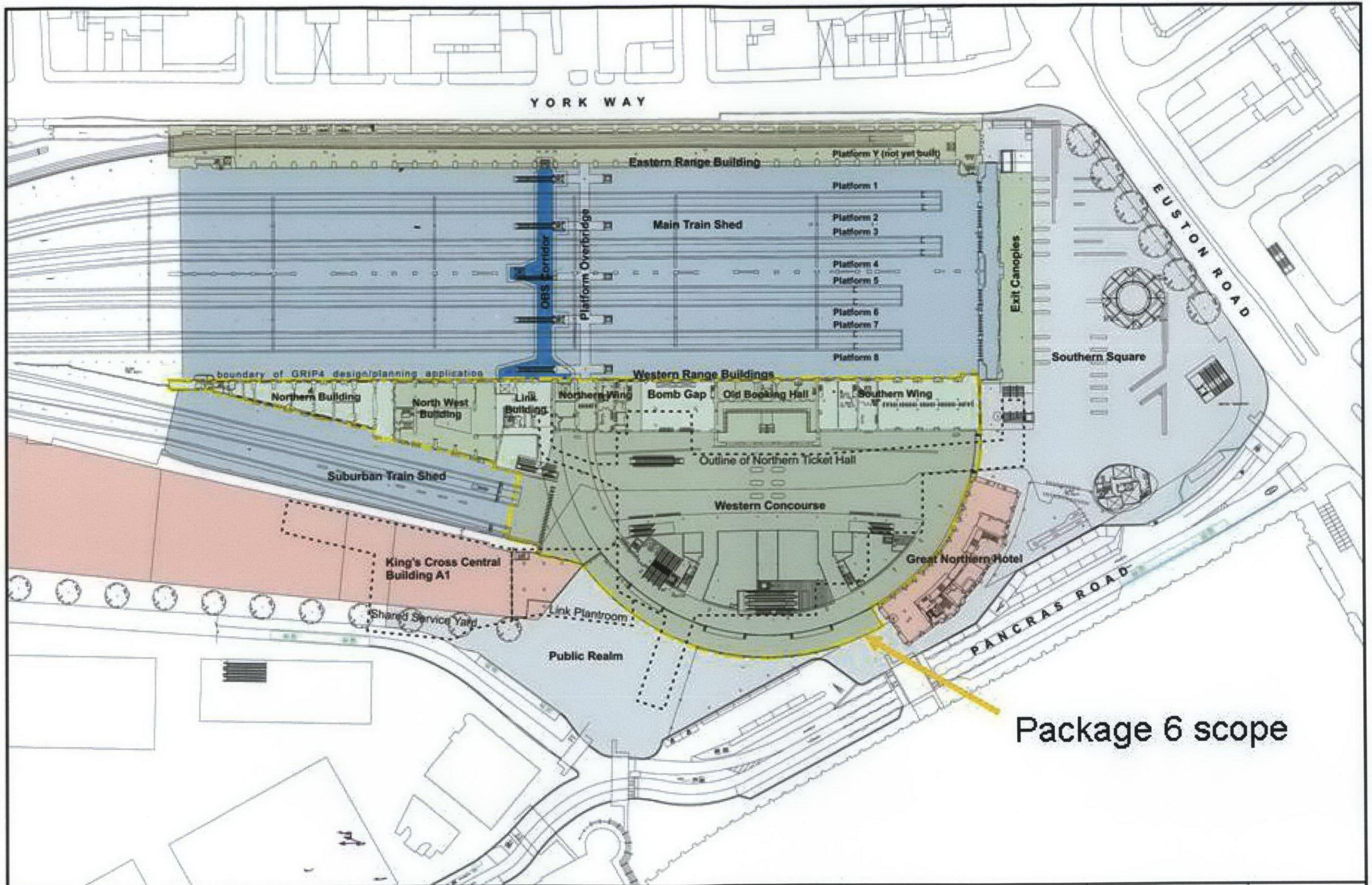

Package 6 scope

Appendix C

Drawings