

WANDA MARTIN GDN FLAT 34 BELSIZÉ PARK NW3 4DX

# LIME *Tilia species*

1. Maximum tree-to-damage distance recorded: 20 m.  
In 90% of cases the tree was closer than 11 m.
2. Normal maximum height in shrinkable clay urban areas:  
*Tilia x europaea*, common lime: 21 – 24 m,  
*T. cordata*, small-leaved lime: 20 m,  
*T. euchlora*, Caucasian lime: 16 – 18 m.
3. Proportion of cases of damage occurring within certain bands of distance from the tree species on shrinkable clay soils:

% of cases of damage	Distance from damage (m)
0	Over 20
10	11 – 20
15	8 – 11
25	6 – 8
25	4 – 6
25	1 – 4

4. Graph showing the reduction in percentage of cases of damage recorded as the distance of trees from buildings increases (for shrinkable clay soils).

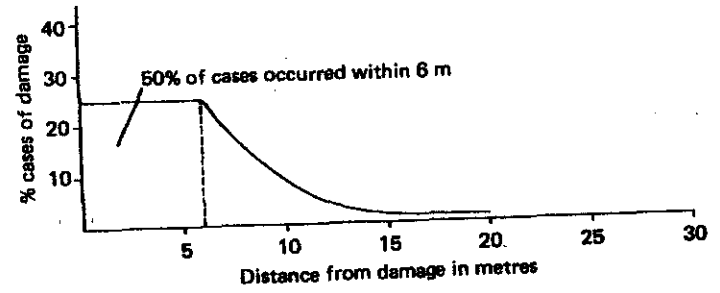

- 5a. Percentage of lime trees relative to the total for all trees reported to have caused damage: 10%.
- 5b. Estimated percentage of lime trees used in street and garden planting relative to sample figures for all such tree plantings: 6.4%.
6. Percentage of cases of damage by lime trees involving shrinkable clay soils: 100%.
7. Sample number: 238 cards.
8. Lime trees were not reported in any cases of damage to drains.

*Notes*  
Lime roots are moderately deep on clay soils.

*User's notes:*

REAR GDN 34 BELSIZE PARK NW3.

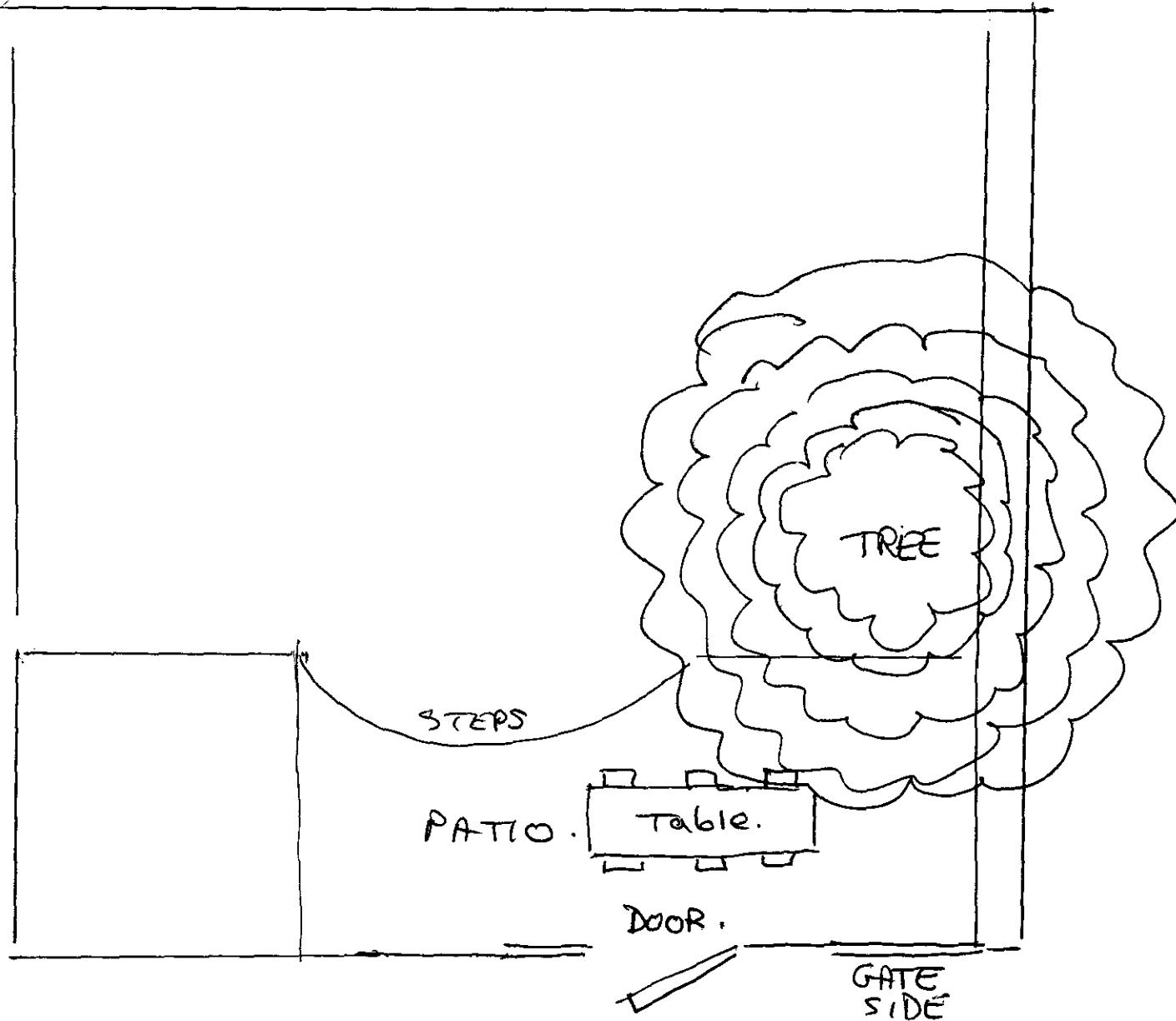

GARDEN SIZE APPROX 40 FT.

