

A3

This drawing is to be read in conjunction with all other contract documents and specifications and all other consultants drawings.
All levels and dimensions should be checked on site and any discrepancies notified to the Architect prior to proceeding with works.
THIS DRAWING IS COPYRIGHT. No drawing shall be reproduced in any form without prior written permission of Eric Parry Architects.

Note:
Setting out of final lift solution
to be reviewed.
Structure and finish to playroom roof tbc
Column sizes are indicative
Refer to Structural Engineer drawings

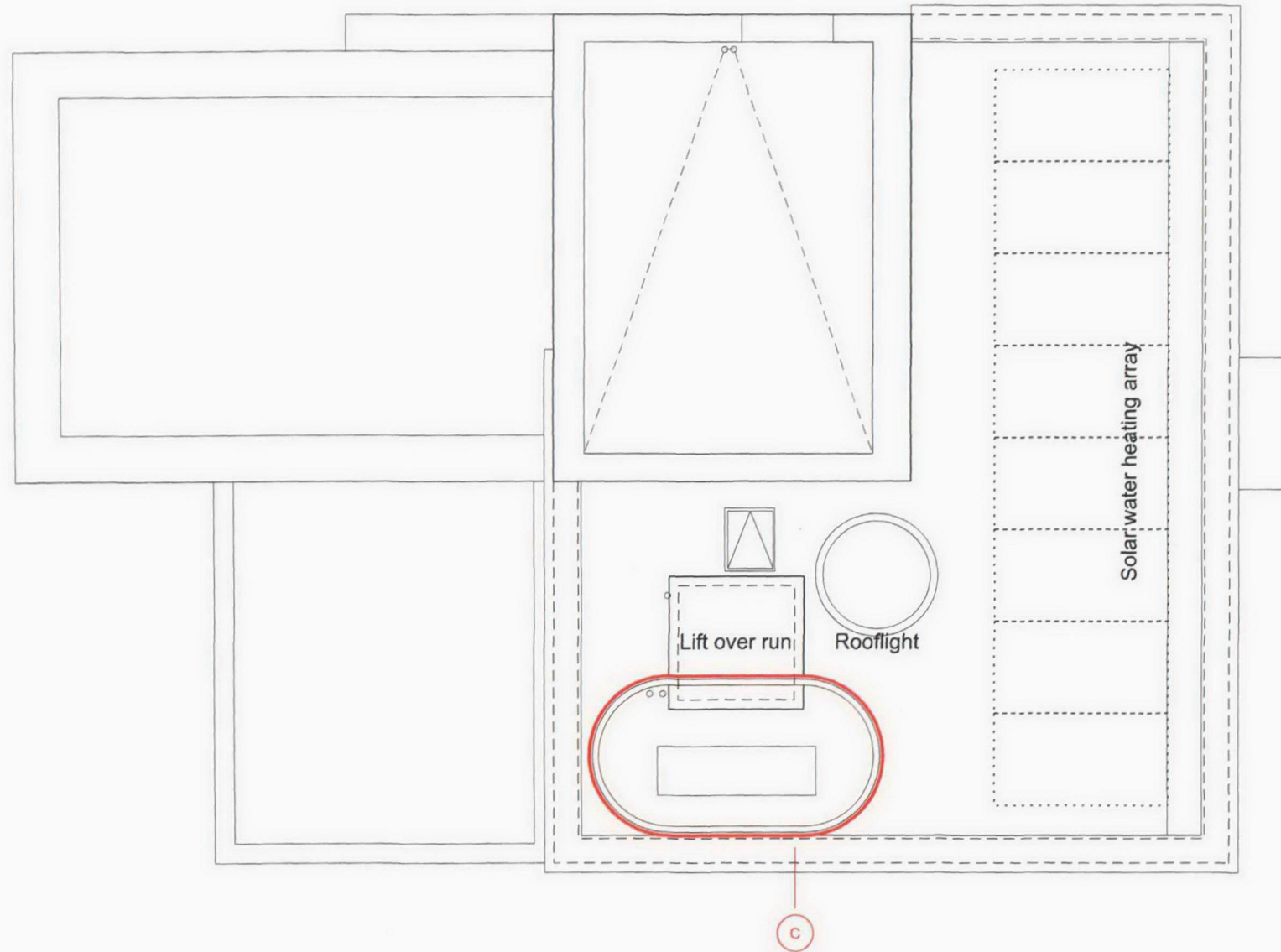

Design Amendments

- C Introduction of a roof top air source heating and cooling in lieu of the combined ground source and heat rejection units at application. The form of the louvred enclosure is curved so it diminishes in street and garden views and about the same height as the chimneys of the neighbouring villas.

Note: Internal partitions have amended to suit revised layouts



PLANNING

Rev	Description	Date	By	Client	Scale	Drawn by	Checked by	Rev
P5	General update - revision clouds added to indicate changes	10.03.10		Queen's Grove Residents	1:100 @ A3	ZF		
P6	Issue to DP9	24.03.10		40 Queen's Grove, NW8	October 2007	RK		
P2	Issued for Information	10.06.09						
P3	General update - issued for information	10.02.10						
P4	Updates client meeting 19.02.10 as minutes. Issued for info.	23.02.10	DL					
				Eric Parry Architects	Proposed Roof Plan			
				28 - 42 Banner Street London EC1Y 8QE Tel 020 7608 9600 Fax 020 7608 9601 www.ericparryarchitects.co.uk	EPA QGR 01 103			
					P6			