

The former Women's 1st Class Pool (now the Grafton Hall) was converted into changing rooms, and the former Women's 2nd Class Pool was reduced in size to allow for the expansion of the laundry, and converted into a small training pool. The two large pools remaining were renamed Grafton Pool and Willes Pool, doing away with the old class and gender-based names.

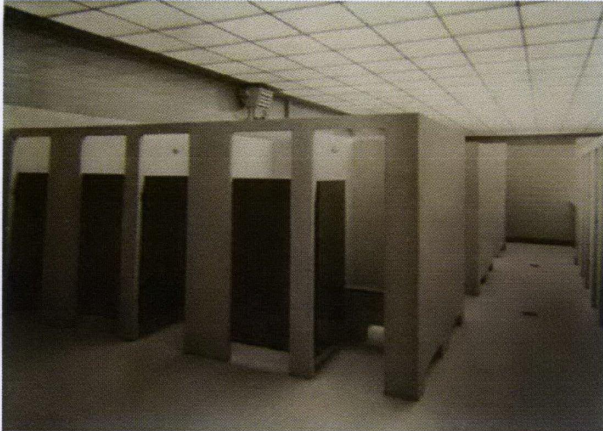

Changing rooms, formerly Grafton Hall, c. 1960 (Camden Local Studies and Archives Centre)



Interior of Wash-house, c. 1960 (Camden Local Studies and Archives Centre)

The building works left the structure of the building largely intact, but reordered the uses and circulation, as well as refurbishing the remaining pools with new tanks, tiling and suspended ceilings. The slipper baths were completely replaced and reduced in number to 91 by removing the former women's baths. The laundry was refitted with new equipment, and the ground floor of its façade along Willes Road was reconstructed. The large square chimney which had stood between the two women's pools was demolished, and a new circular one erected to the north of the new boiler room. This boiler room itself was constructed on the site of a terrace house adjoining the site, that was bought and demolished.

A new communal entrance and reception area was also constructed along Grafton Road, in brick with a flat concrete roof; this gave access directly to the new changing area, but also – via a new corridor partitioned out of the Grafton Pool hall – to the slipper baths in the block along Prince of Wales Road. The original men's entrances along Prince of Wales Road were walled up and the ground floor area was turned into offices. *[The glazed bricks throughout the building were either bush-hammered or painted over, a small section of tiles survive under the stairs to the Men's 1st Class slipper Baths.]*



Reception area, c. 1960 (Camden Local Studies and Archives Centre)

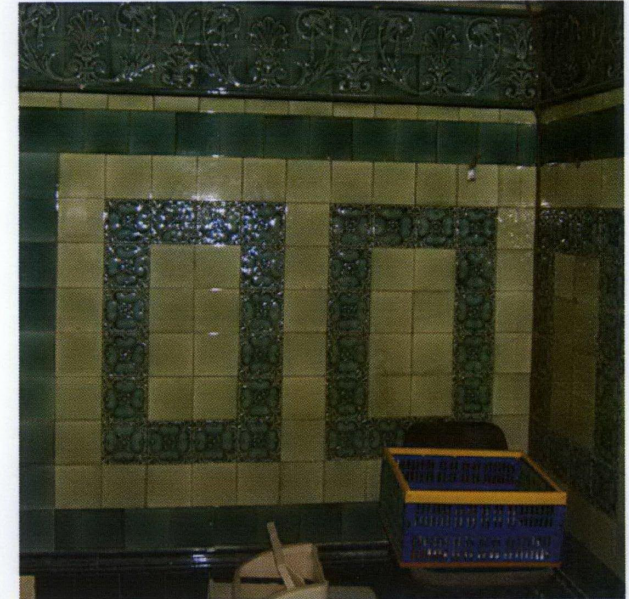

Surviving tiles in the former Mens' 1st Class Entrance, KTSC

In recent times the suspended ceiling over the changing rooms in the Grafton Hall has been removed, revealing the original roof truss.

The following illustrations show the extent of alterations and change to the building.

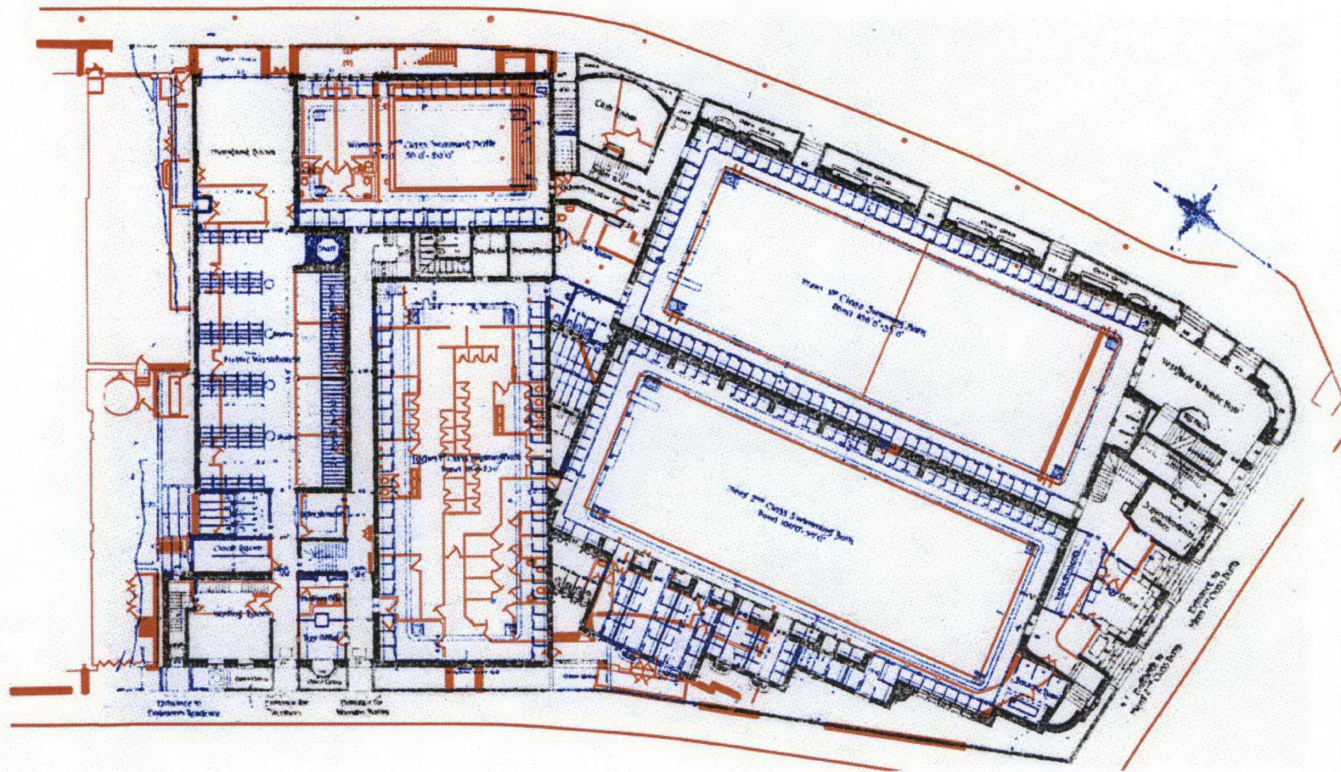

KEY:

- CURRENT FABRIC
- DEMOLISHED - ORIGINAL
- RETAINED - ORIGINAL

KENTISH TOWN SPORTS CENTRE

1901 & EXISTING PLANS OVERLAID
 SHOWING EXTEND OF ALTERATION
 - GROUND FLOOR

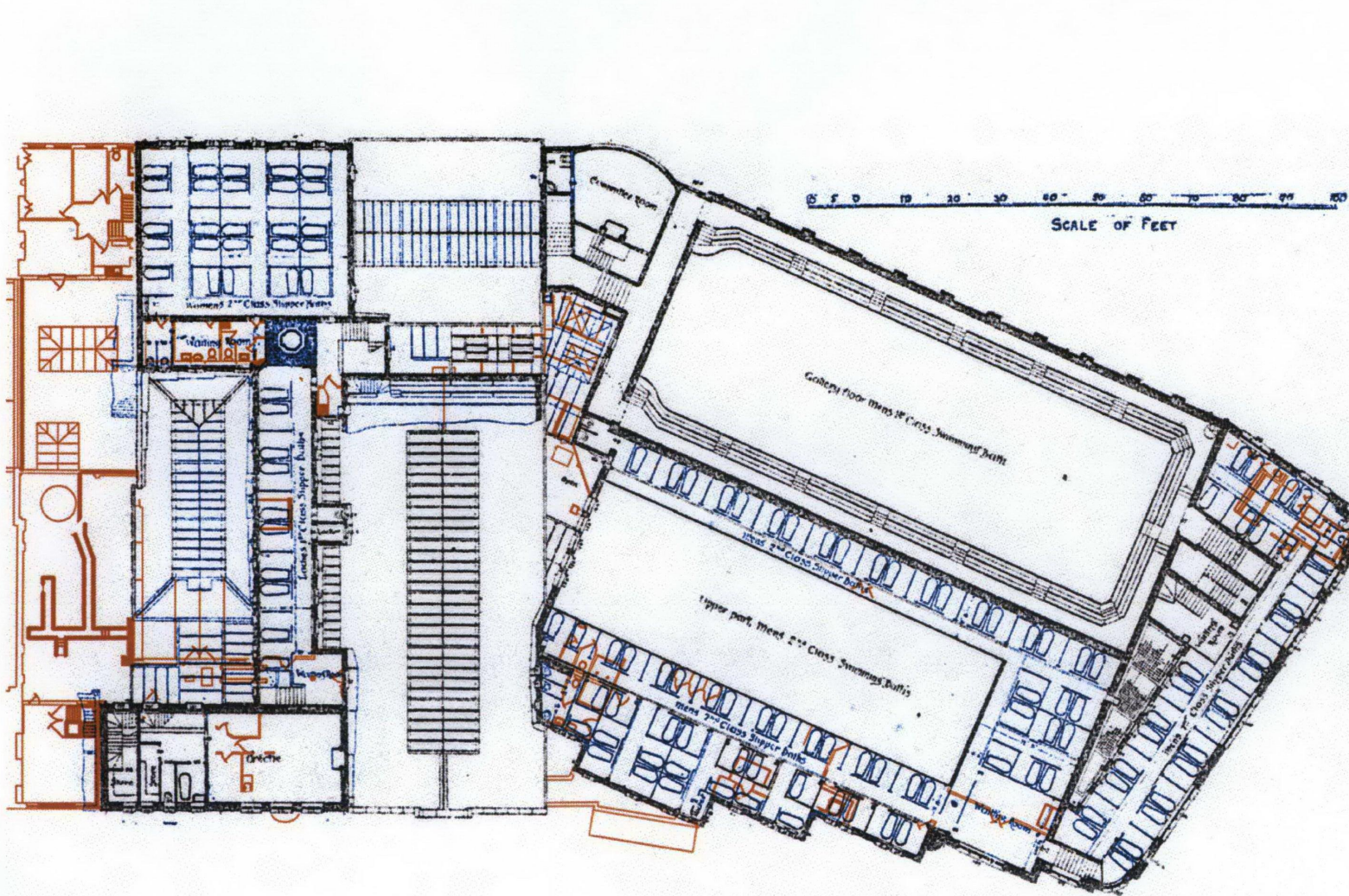

- KEY:
- CURRENT FABRIC
 - DEMOLISHED - ORIGINAL
 - RETAINED - ORIGINAL

KENTISH TOWN SPORTS CENTRE
 1901 & EXISTING PLANS OVERLAID
 SHOWING EXTEND OF ALTERATION
 - FIRST FLOOR

KEY

- EXTENSION
- ALTERATION

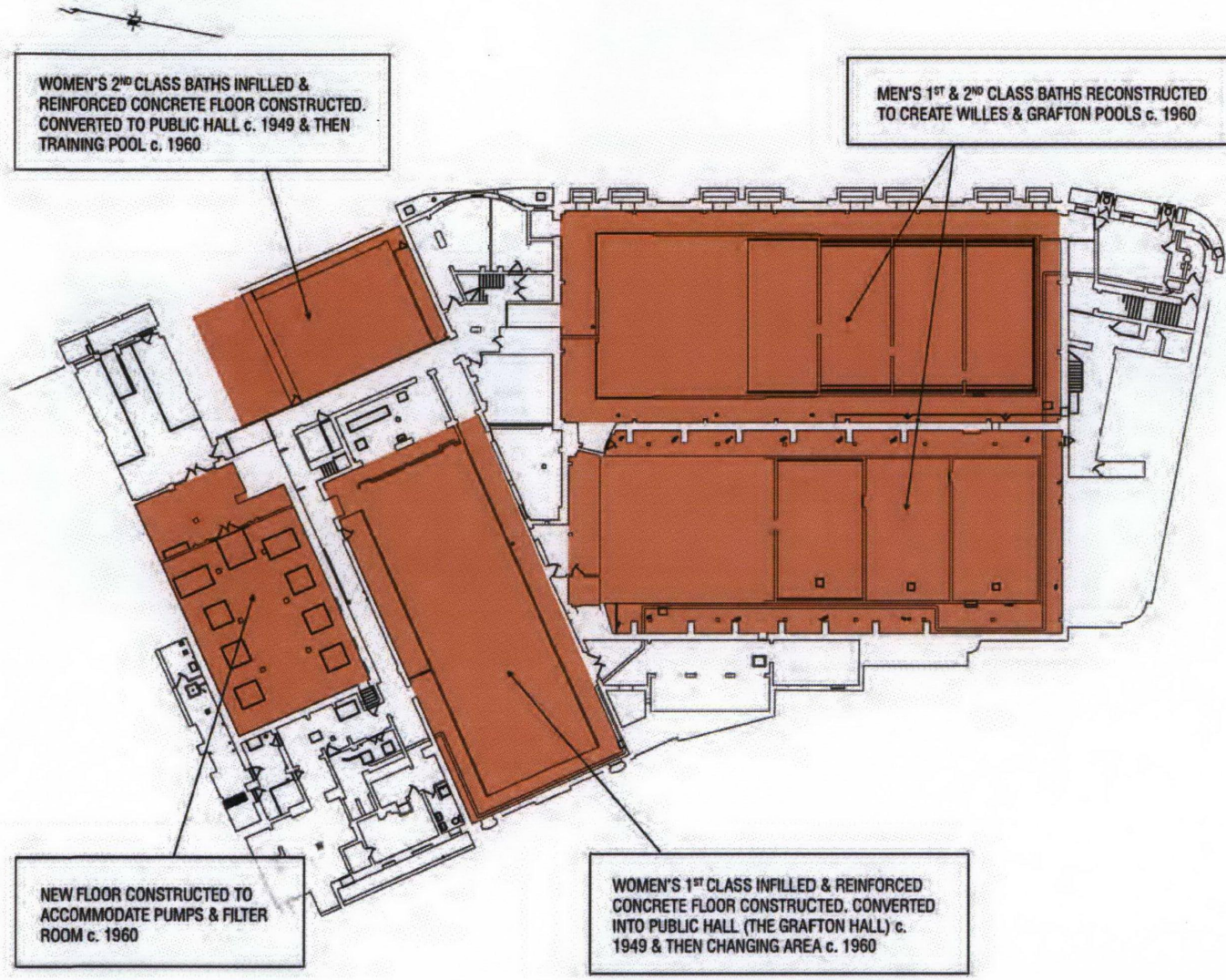

KENTISH TOWN SPORTS CENTRE

**MAIN BUILDING CHANGES
SINCE 1901
- BASEMENT PLAN**

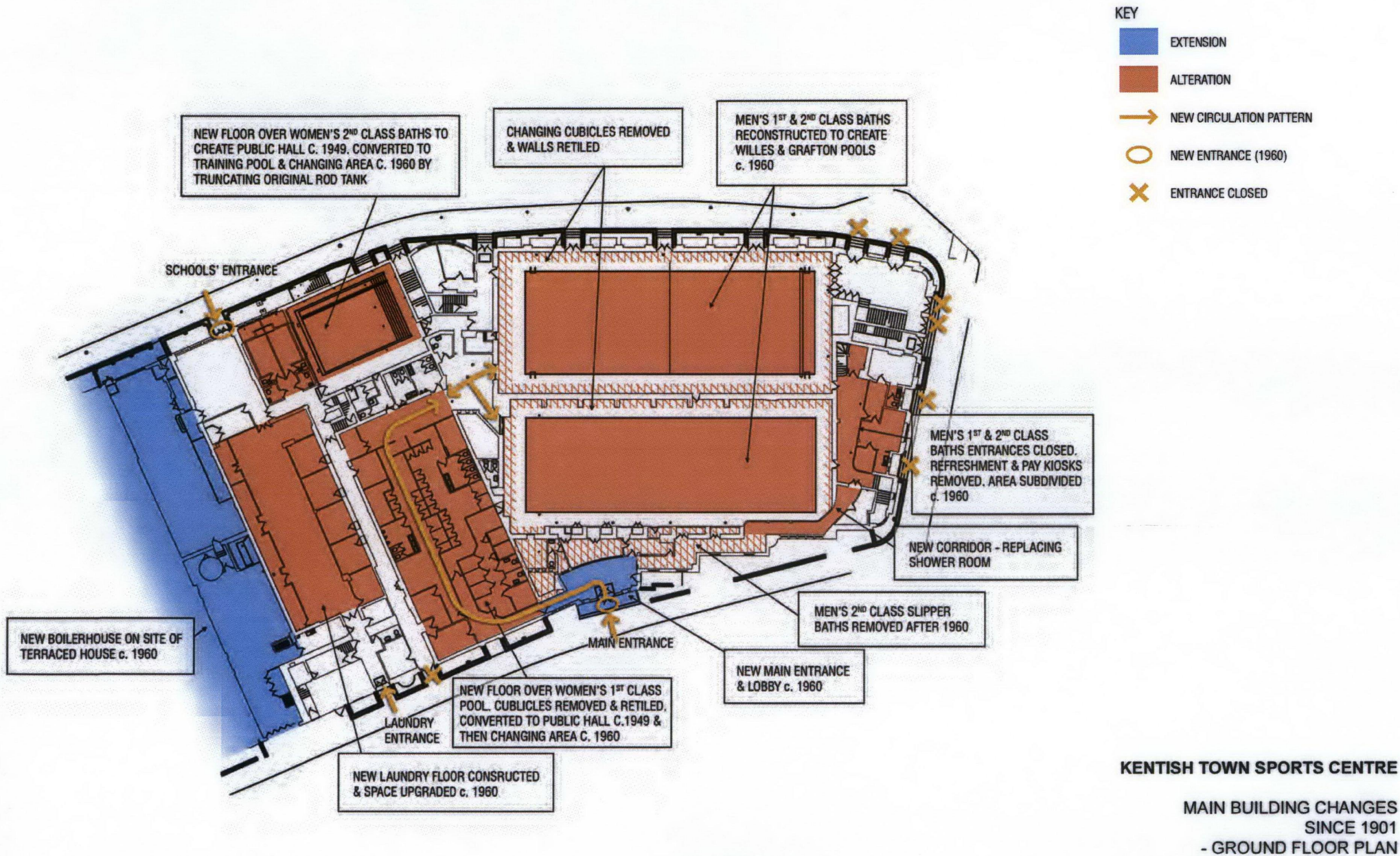

KENTISH TOWN SPORTS CENTRE

**MAIN BUILDING CHANGES
SINCE 1901
- GROUND FLOOR PLAN**

KEY

- EXTENSION
- ALTERATION

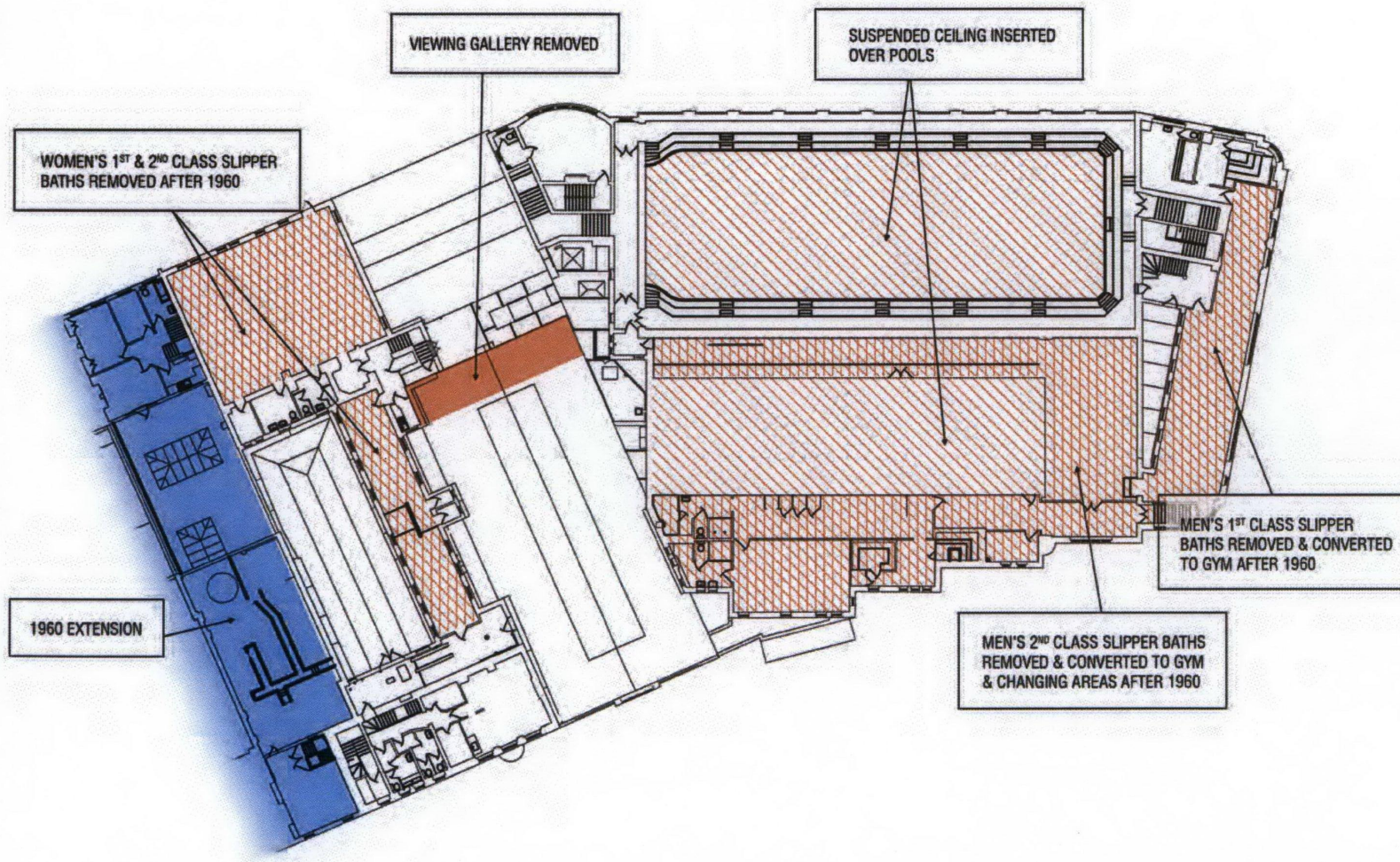

KENTISH TOWN SPORTS CENTRE

MAIN BUILDING CHANGES
SINCE 1901
- FIRST FLOOR PLAN

KEY

- EXTENSION
- ALTERATION

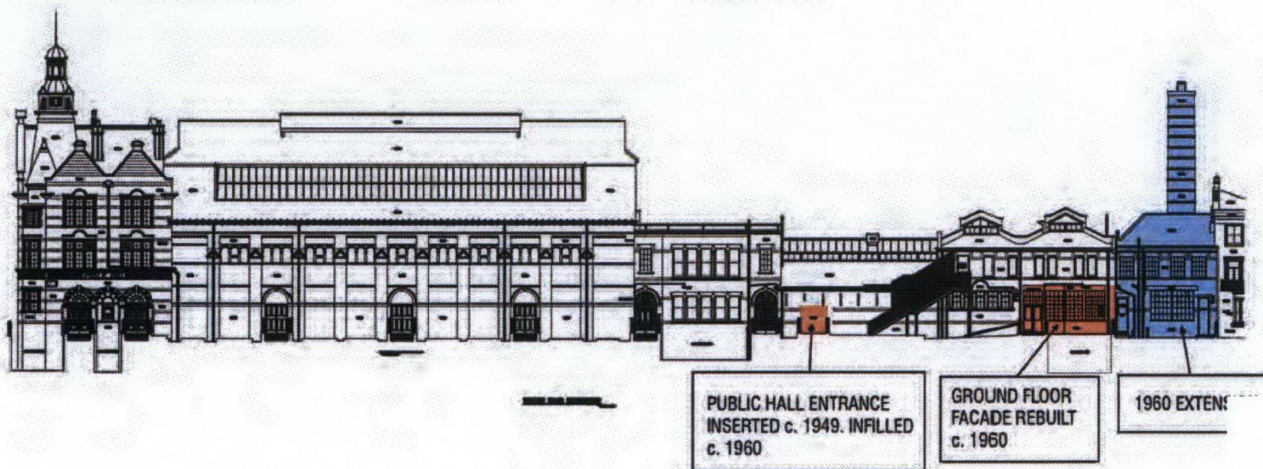
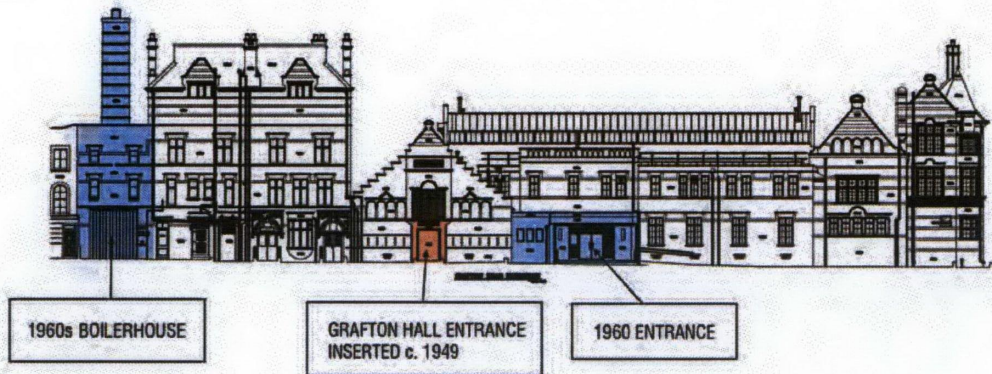

KENTISH TOWN SPORTS CENTRE

MAIN BUILDING CHANGES SINCE 1901
GRAFTON ROAD & WILLES ROAD
ELEVATIONS

KEY

- EXTENSION
- ALTERATION



KENTISH TOWN SPORTS CENTRE

MAIN BUILDING CHANGES SINCE 1901
PRINCE OF WALES ROAD
ELEVATIONS

KEY

- EXTENSION
- ALTERATION

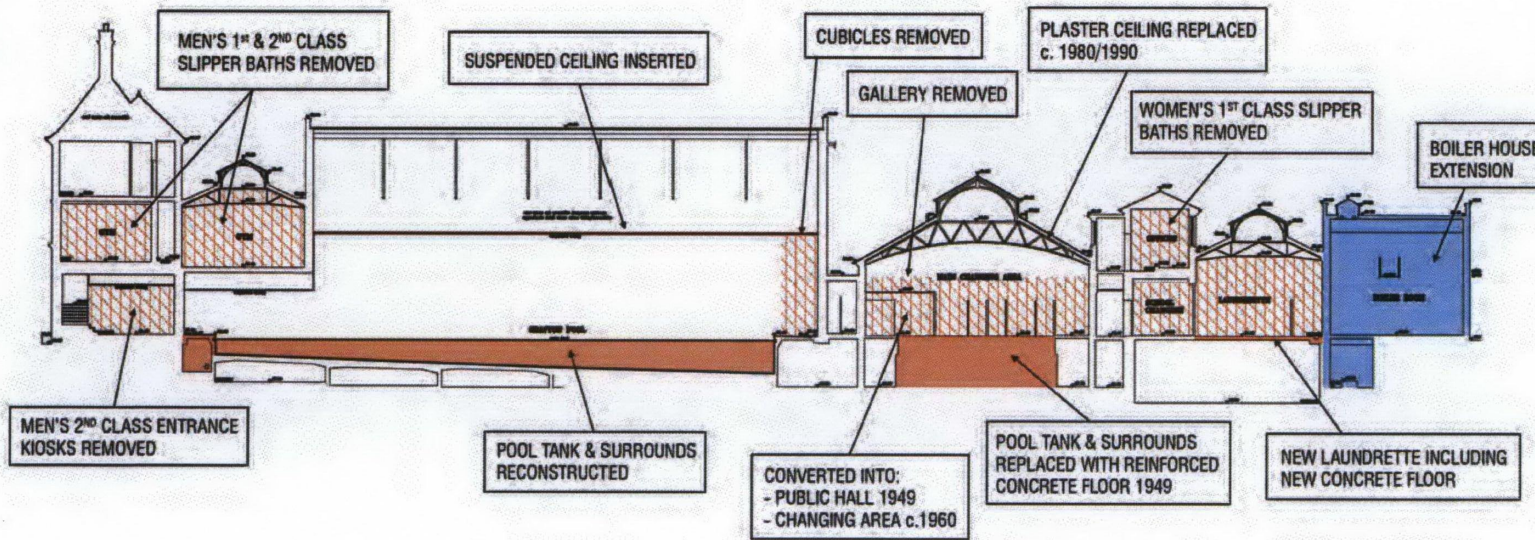

KENTISH TOWN SPORTS CENTRE

MAIN BUILDING CHANGES SINCE 1901
SECTION S - N