

DOUBLE-UP FLAT ROOF JOISTS TO TRIM NEW OPENINGS (6 No. TOTAL)
 PROVIDE PROPRIETARY HANGERS BY SIMPSON STRONG TIE OR SIMILAR AS REQUIRED

REFER ANY DISCREPANCY TO THE ENGINEER.

EXISTING CONSTRUCTION DETAILS TO BE SITE CHECKED TO CONFIRM THE STRUCTURAL PROPOSALS INDICATED & TO DETERMINE THE TEMPORARY WORKS REQUIRED.

EXISTING STEEL BEAMS AND FLAT ROOF JOISTS ARE TO BE LEFT UNDISTURBED (UNLESS NOTED OTHERWISE). TRIMMING TO NEW OPENING AS SHOWN ON DRAWING.

ROOF-PRO NEW PLANT AND ASSOCIATED EQUIPMENT AS SHOWN TO BE SUPPORTED ON ROOF-PRO'S FREE STANDING, GALVANISED STEEL FRAME SUPPORTING SYSTEM.

SUPPORT FRAMES MUST NOT PENETRATE THE ROOF WATERPROOFING MEMBRANE.

REFER TO ROOF-PRO'S DETAILS AND SPECIFICATION. INSTALLATION TO BE STRICTLY IN ACCORDANCE WITH ROOF-PRO'S LITERATURE.

ROOF-PRO SUPPORT HEIGHT TO BE MINIMUM RECOMMENDED CLEARANCE UNDER ALL SERVICES OF 450-500mm.

ROOF-PRO 3 POINT CERTIFICATION DOCUMENTATION SHOWING ROOF-PRO'S PROJECT DESIGN INCLUDING CONSIDERATION OF BUILDING CLEARANCE, SUPPORT STABILITY AND LOAD MANAGEMENT.

ROOF-PRO'S LOAD MANAGEMENT CALCULATIONS TO BE SUBMITTED FOR APPROVAL TO ENGINEER PRIOR TO FABRICATION.

PROPOSED GROUND FLOOR PLAN
 SCALE 1:50

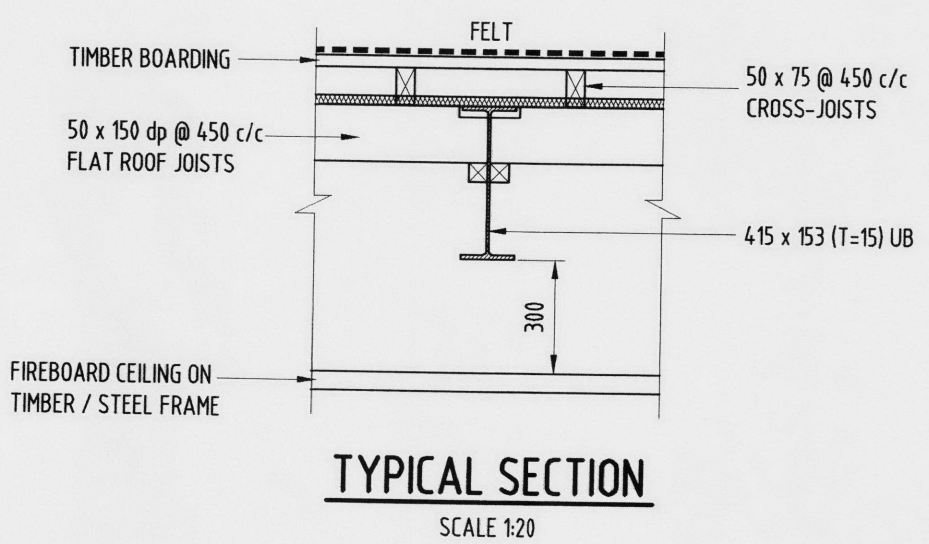

- NOTES**
1. THIS DRAWING SHOULD BE READ IN CONJUNCTION WITH THE M&E ENGINEER'S DRAWINGS AND SPECIFICATION.
 2. CONTRACTOR TO SITE CHECK ALL EXISTING DETAILS/DIMENSIONS PRIOR TO PUTTING ANY WORK IN HAND. REFER ANY DISCREPANCY TO THE ENGINEER
 3. CONTRACTOR TO PROVIDE TEMPORARY PROPS AS REQUIRED.

TENDER ISSUE

Rev	Date	Amendment

K R P
KENNETH R. PAUL
Consulting Engineers
 Structural & Civil
 239 COLLEGE ROAD
 COLLEGE TOWN
 SANDHURST, GU47 8JA
 Tel: 01276 38353
 Fax: 01276 38317
 e-mail: mail@krpconsulting.co.uk

Client
 LONDON BOROUGH OF CAMDEN

Job Title
 RICHARD COBDEN PRIMARY
 SCHOOL
 CAMDEN
 LONDON

Drawing Title
 PLANT LOCATIONS / LOADING

Scale 1:50, 1:20

Date MAY 10 Drawn by Checked by

Dwg. No. 10101 / 01 Rev.