

2010/2010/T.



Planning Services
Camden Town Hall
Argyle Street
London WC1H 8EQ

Email (enquiries only): env.devcon@camden.gov.uk
Telephone : 020 7974 1911
Fax : 020 7974 5713

For office use
Date
Payee
App. No. Fee

Application for tree works: works to trees subject to a tree preservation order (TPO)
and/or notification of proposed works to trees in a conservation area.

Town and Country Planning Act 1990

You can complete and submit this form electronically via the Planning Portal by visiting www.planningportal.gov.uk/apply

Publication of applications on planning authority websites

Please note that the information provided on this application form and in supporting documents may be published on the Authority's website. If you require any further clarification, please contact the Authority's planning department.

Please complete using block capitals and black ink.

You must use this form if you are applying for work to trees protected by a tree preservation order (TPO). (You may also use it to give notice of works to trees in a conservation area).

It is important that you read the accompanying guidance notes before filling in the form. Without the correct information, your application / notice cannot proceed.

1. Applicant Name and Address

Title: First name:

Last name:

Company (optional): DAWLIN ATM LHM.

Unit: House number: House suffix:

House name: OAK HILL PARK

Address 1: HAMPSHIRE

Address 2: LONDON

Address 3:

Town:

County:

Country:

Postcode: NW3 7LN

2. Agent Name and Address

Title: MA First name: SIMON

Last name: STONMANS

Company (optional): SJ STONMANS ASSOCIATES

Unit: House number: House suffix:

House name: SAVERNACK BARN

Address 1: STOKKE COMMON

Address 2: GREAT BOBLYN

Address 3: MARLBOROUGH

Town:

County: WILTSHIRE

Country:

Postcode: SN8 3LL

3. Trees Location

If all trees stand at the address shown in Question 1, go to Question 4. Otherwise, please provide the full address/location of the site where the tree(s) stand (including full postcode where available)

Unit: House number: House suffix:

House name:

Address 1: **SAK HILL**

Address 2: **AS FOR REPORT**

Address 3: **ATTACHED**

Town:

County:

Postcode (if known): **NW3 7LN**

If the location is unclear or there is not a full postal address, either describe as clearly as possible where it is (for example, 'Land to the rear of 12 to 18 High Street' or 'Woodland adjoining Elm Road') or provide an Ordnance Survey grid reference:

Description:

See Report.

4. Trees Ownership

Is the applicant the owner of the tree(s): ☒ Yes ☐ No
If 'No' please provide the address of the owner (if known and if different from the trees location)

Title: First name:

Last name:

Company (optional):

Unit: House number: House suffix:

House name:

Address 1:

Address 2:

Address 3:

Town:

County:

Country:

Postcode:

Telephone numbers

Country code: National number: Extension number:

Country code: Mobile number (optional):

Country code: Fax number (optional):

Email address (optional):

5. What Are You Applying For?

Are you seeking consent for works to tree(s) subject to a TPO? ☒ Yes ☐ No

Are you wishing to carry out works to tree(s) in a conservation area? ☒ Yes ☐ No

6. Tree Preservation Order Details

If you know which TPO protects the tree(s), enter its title or number below.

7. Identification Of Tree(s) And Description Of Works

Please identify the tree(s) and provide a full and clear specification of the works you want to carry out. Continue on a separate sheet if necessary. You might find it useful to contact an arborist (tree surgeon) for help with defining appropriate work. Where trees are protected by a TPO, please number them as shown in the First Schedule to the TPO where this is available. Use the same numbers on your sketch plan (see guidance notes).

Please provide the following information below: tree species (and the number used on the sketch plan) and description of works. Where trees are protected by a TPO you must also provide reasons for the work and, where trees are being felled, please give your proposals for planting replacement trees (including quantity, species, position and size) or reasons for not wanting to replant.

E.g. Oak (T3) - fell because of excessive shading and low amenity value. Replant with 1 standard ash in the same place.

G440, T447, T487, T488, T489, T490, T491, T492, T509
T510, T511
T526 AND T527
SEE REPORT ATTACHED

7. Identification Of Tree(s) And Description Of Works continued ...

8. Trees - Additional Information

Additional information may be attached to electronic communications or provided separately in paper format.

For all trees

A sketch plan clearly showing the position of trees listed in Question 7 must be provided when applying for works to trees covered by a TPO. A sketch plan is also advised when notifying the LPA of works to trees in a conservation area (see guidance notes). It would also be helpful if you provided details of any advice given on site by an LPA officer.

For works to trees covered by a TPO

Please indicate whether the reasons for carrying out the proposed works include any of the following. If so, your application must be accompanied by the necessary evidence to support your proposals. (See guidance notes for further details)

1. **Condition of the tree(s)** - e.g. it is diseased or you have fears that it might break or fall: ☐ Yes ☐ No
If YES, you are required to provide written arboricultural advice or other diagnostic information from an appropriate expert.

2. **Alleged damage to property** - e.g. subsidence or damage to drains or drives. ☐ Yes ☐ No
If YES, you are required to provide for:

Subsidence

A report by an engineer or surveyor, to include a description of damage, vegetation, monitoring data, soil, roots and repair proposals. Also a report from an arboriculturist to support the tree work proposals.

Other structural damage (e.g. drains, walls and hard surfaces)

Written technical evidence from an appropriate expert, including description of damage and possible solutions.

Documents and plans (for any tree)

Are you providing separate information (e.g. an additional schedule of work for Question 7)? ☐ Yes ☐ No

If YES, please provide the reference numbers of plans, documents, professional reports, photographs etc in support of your application. If they are being provided separately from this form, please detail how they are being submitted.

SEE REPORT

9. Authority Employee / Member

With respect to the Authority, I am:

- (a) a member of staff (c) related to a member of staff
(b) an elected member (d) related to an elected member

Do any of these statements apply to you?

☐ Yes

☒ No

If Yes, please provide details of the name, relationship and role

10. Application For Tree Works - Checklist

Only one copy of the application form and additional information (Question 8) is required. Please use the guidance and this checklist to make sure that this form has been completed correctly and that all relevant information is submitted. Please note that failure to supply precise and detailed information may result in your application being rejected or delayed. You do not need to fill out this section, but it may help you to submit a valid form.

Sketch Plan

- A sketch plan showing the location of all trees (see Question 8)

☒

For all trees

(see Question 7)

- Clear identification of the trees concerned
- A full and clear specification of the works to be carried out

☒

☒

For works to trees protected by a TPO

(see Question 7)

Have you:

- stated reasons for the proposed works?
- provided evidence in support of the stated reasons? in particular:
 - if your reasons relate to the condition of the tree(s) - written evidence from an appropriate expert
 - if you are alleging subsidence damage - a report by an appropriate engineer or surveyor and one from an arboriculturist.
 - in respect of other structural damage - written technical evidence
- included all other information listed in Question 8?

☒

☒

☒

☒

☒

11. Declaration - Trees

I/we hereby apply for consent/give notice for tree work as described in this form and the accompanying plans and additional information.

Signed - Applicant:



Or signed - Agent:

 Simon Stephens

Date (DD/MM/YYYY):

10/06/2010 (This date must not be before the date of sending or hand-delivery of the form)

12. Applicant Contact Details

Telephone numbers

Country code: National number: Extension number:

Country code: Mobile number (optional):

Country code: Fax number (optional):

Email address (optional):

13. Agent Contact Details

Telephone numbers

Country code: National number: Extension number:

Country code: Mobile number (optional):

Country code: Fax number (optional):

Email address (optional):
Simon A Stephens. co. uk

Electronic communication - If you submit this form by fax or e-mail the LPA may communicate with you in the same manner.
(Please see guidance notes)



SJ Stephens Associates

ARBORICULTURAL, LANDSCAPE &
MANAGEMENT CONSULTANTS

Savernake Barn
Stokke Common
Great Bedwyn
Marlborough
Wiltshire SN8 3LL
Tel: 01672 871 862
www.sjstephens.co.uk
e: info@sjstephens.co.uk

Tree Work Recommendations

At:-

Oak Hill Park
Hampstead
London NW3 7LN

On behalf of:-

Dawlin RTM Ltd
c/o Faraday Property Management Ltd
3rd floor (West)
52-54 High Holburn,
London WC1V 6RL

Prepared by:

Simon Stephens MA Oxon, Dip
Arb(RFS), MArborA, C Env.
Email: simon@sjstephens.co.uk

Inspection Date:
Report Date:

27th April 2010
29th April 2010

CONTENTS

- 1 BACKGROUND**
- 2 PROPOSALS**

Appendices

- A Site Plan**
- B Tree Work Schedule**
- C Photo of T511**

1 BACKGROUND

- 1.1** A survey of all trees on the site was undertaken in September 2009 and the majority of works recommended have now been undertaken.
- 1.2** At a site meeting attended by Simon Stephens, Arboricultural Consultant, Claire Newbrook, Property Manager and Harvey Rose, Director of the freeholder, on 27/04/10, further works were discussed and are now proposed.
- 1.3** The initial tree report, and these further recommendations, have been prepared by Simon Stephens MA Oxon, Dip Arb (RFS), MArborA, a Registered Consultant with the Arboricultural Association, with over 20 years relevant experience.

2 PROPOSALS

- 2.1** Details of proposed tree works are included in the Tree Schedule included as Appendix B. Particular items requiring further comment are as follow.
- 2.2** G440: Lombardy poplar – these three trees are up to 26m in height and are getting to a stage where failure is possible. In addition, since the previous inspection cracks in the adjacent building have been reported. Large surface roots can be seen growing towards the building, making it possible that vegetation related subsidence could be a factor. Reduction of the trees by 20%, followed by further reduction to the same height every 3 years, will reduce the vigour of tree root growth, which may help prevent a potential problem developing
- 2.3** T487 – T492 are healthy trees but are becoming overlarge, considering their proximity to the tennis court and surrounding properties. Crown reduction is, therefore, recommended which at this stage can be carried out without causing a significant effect on the amenity or health of the trees.
- 2.4** T511 is a mature Beech, growing on a bank, leaning with all its weight towards the adjacent road. The bank between the road and the tree has eroded, leaving a major section of the roots

exposed and unsupported. This reduces compression support for the tree, putting additional tension stress on roots in the bank increasing the risk of injury or damage within the road. Weight reduction, by removal of the two limbs shown in the photo included as appendix C is therefore recommended.

- 2.5** The previous survey recommended an aerial inspection of T526 and T527. These inspections have lead to the proposed works for these trees
- 2.6** All tree work should be undertaken to the standards set out in BS 3998:1989 British Standard recommendations for Tree Work.

| Tree/ Tag No. | Species | Height (m) | Stem Diam. at 1.5m (mm) | Crown Spread (m) | Age Class | Phys. Cond. | Condition | Management Recommendations | Estimated Remaining Contribution (years) | BS 5837 Category Grading |
|-----------------------------------|---------------------|---------------|----------------------------------|------------------------|--------------------|----------------|--|--|---|--------------------------------|
| 16 Market Lodge - G440 | Lombardy poplar X 3 | 26.0 | 350-400 | 4 | Mature | Good | Typically tightly furcated upper crowns, with risk of branch failure. Cracks found in adjacent buildings, with surface roots of poplars growing towards damage - possible subsidence. | Reduce group by 20%. | 20-40 | B |
| 3 Market Lodge. T447 | Ash | 13.0 | 450 | 9 | Mature | Good | Twin stems remaining, following past failure of the remainder of the tree. Evidence of basal decay, fungal fruiting bodies of <i>Kreschmaria deusta</i> evident. This fungus causes brittle fracture. | Remove and replant. | 15-30 | B |
| 15 Market HSE / Tennis et | T487 Sycamore | 18.0 | 400 | 10 | Mature | Good | Showing good overall form and vigour. | Reduce by 20% | >40 | B |
| 11 T488 | Holly | 10.0 | 450 | 9 | Mature | Good | Multi-stemmed. Showing good overall form and vigour. | Reduce elongated leader by 3m to improve shape. | >40 | C |
| 11 T489 | Sycamore | 17.0 | 300 | 7 | Mature | Good | Showing good overall form and vigour. | Reduce by 20% | >40 | B |
| 11 T490 | Sycamore | 17.0 | 300 | 7 | Mature | Good | Showing good overall form and vigour. Possible changes to ground levels. | Reduce by 20% | >40 | B |
| * T491 | Horse chestnut | 16.0 | 700 | 12 | Over mature | Fair | Evidence of root severance to accommodate new tennis court. Infection from leaf miner. | Reduce by 20%. Monitor physiological and structural condition every 18 months. | 10-20 | C |
| * T492 | Horse chestnut | 16.0 | 800 | 11 | Over mature | Fair | Multi-stemmed. Possible changes to ground levels. Possible root severance to accommodate new tennis court. Infection from leaf miner. | Reduce by 20%. Monitor physiological and structural condition every 18 months. | 10-20 | C |
| Market HSE / Oak Hill HSE T509 | Horse chestnut | 17.0 | 350 | 9 | Mature | Good | Drawn up tree, with all weight over road. Partially ivy clad. Minor infection from leaf miner. | Reduce height by 3m to check growth and reduce likelihood of future instability. Monitor physiological and structural condition every 18 months. | 20-40 | B |
| Market HSE / The Lodge. T510 | Oak | 18.0 | 600 | 11 | Mature | Good | Suppressed growth habit due to T511. Unbalanced crown. Showing good overall form and vigour. | Reduce height by 4m, and reduce extended laterals by 20%, to check growth and reduce likelihood of future instability. | >40 | B |
| 11 T511 | Beech | 21.0 | 900 | 14 | Mature/over mature | Good/Fair | Bank eroding, leaving a significant proportion of the root plate exposed and unsupported. All weight over adjacent roadway. Small amount of aerial deadwood. | Remove two limbs shown in photo provided and prune further branches, of no more than 75mm diameter, to balance. Monitor structural condition every year. | 20-40 | B |
| North Wood Lodge. T526 | London plane | 23.0 | 900 | 11 | Mature | Good | Lower stem is ivy clad. Number of decay pockets throughout tree, particularly on main stem at 10m and 12m. Number of tightly furcated areas throughout crown. Leaning towards garages and corner of building. Aerial inspection in spring 2010 revealed numerous cavities in the main trunk and stems. | Reduce and reshape crown by 20-25%, to improve and maintain structural integrity | 20-40 | B |
| 11 T527 | Lime | 11.0 | 250 | 5 | Mature | Good | Ivy clad. Aerial inspection in spring 2010 revealed large pruning wound cavities. | Sever ivy. Re-pollard to previous knuckles. | 20-40 | B |

Appendix C

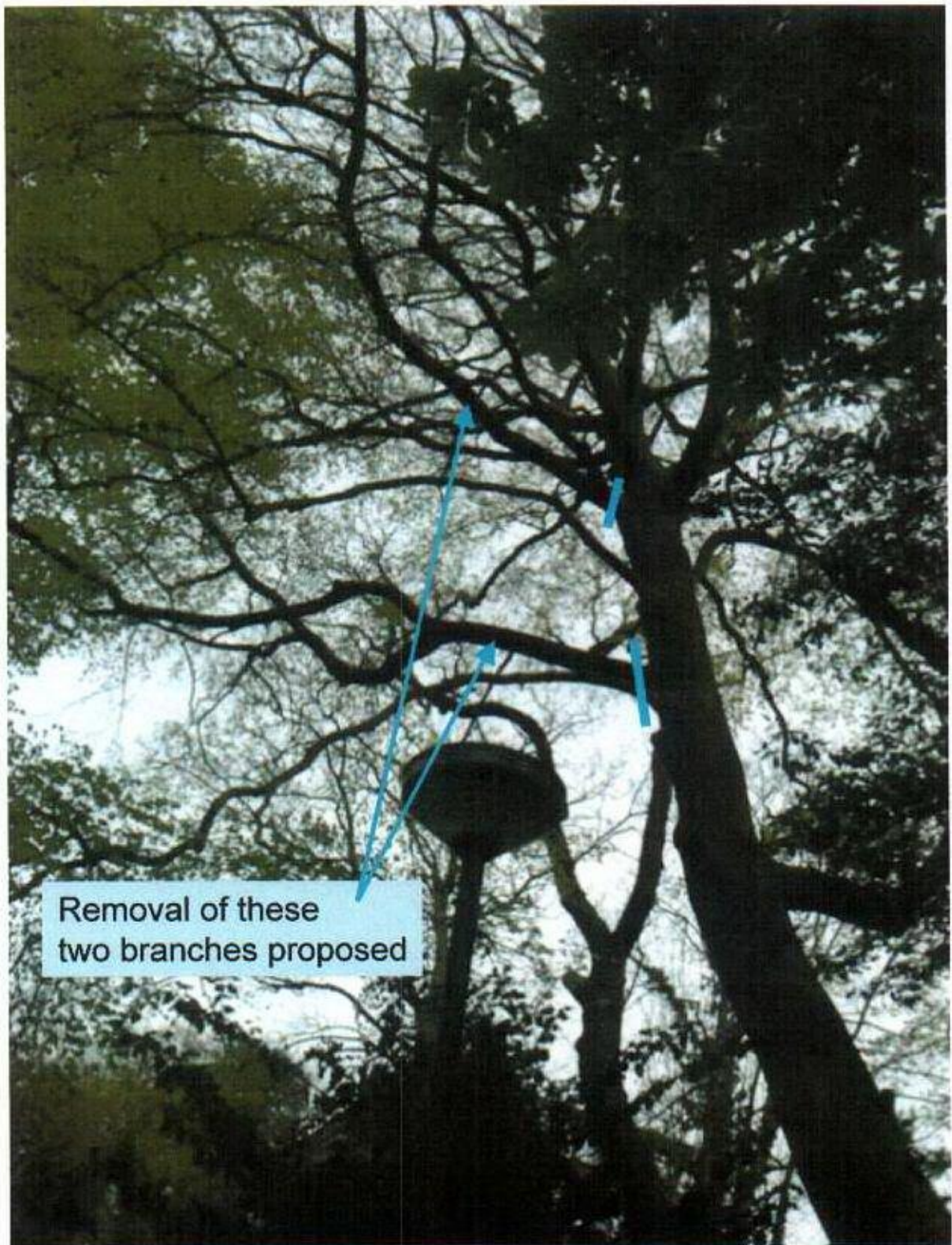

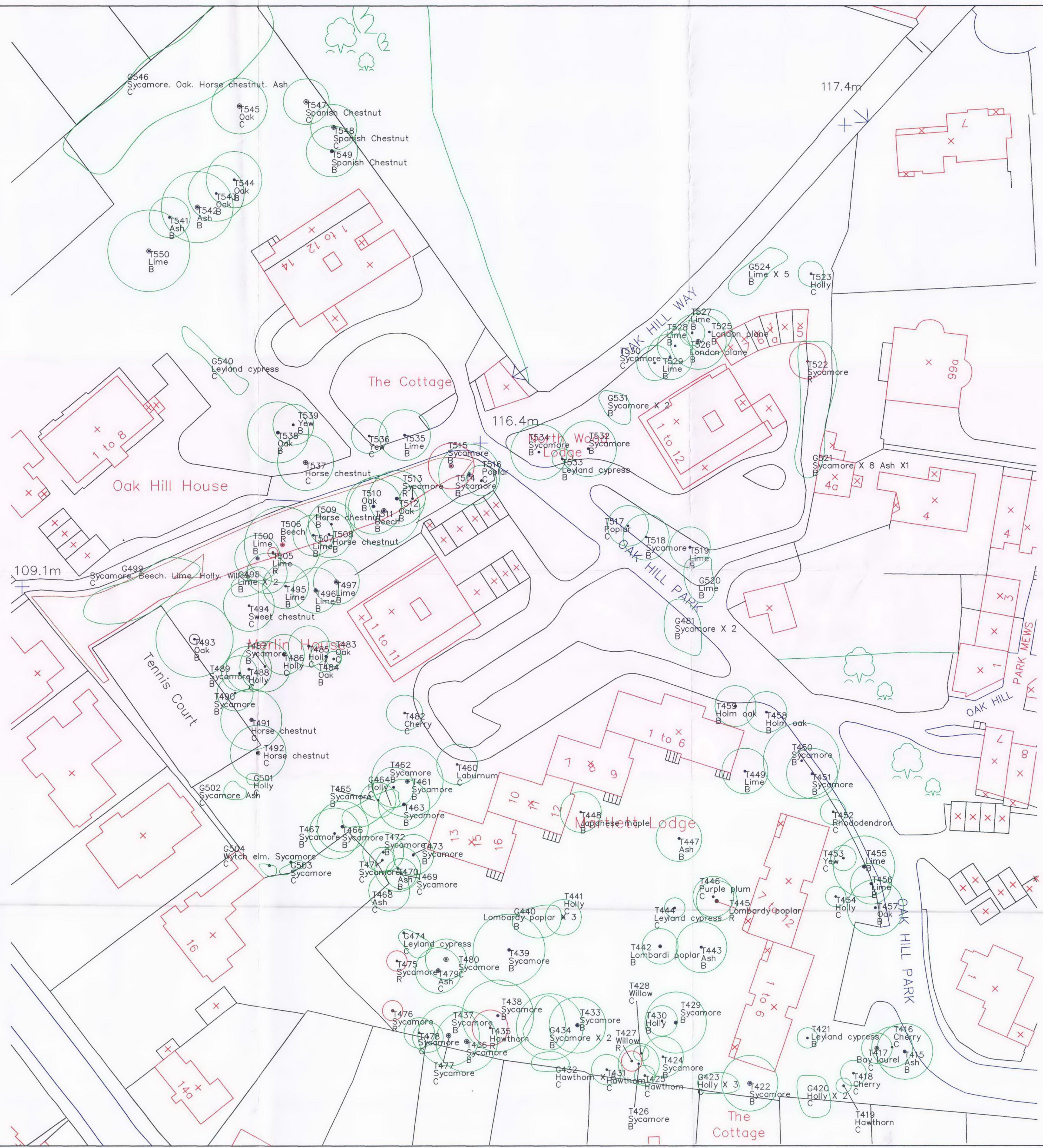

Approved A.

Key

- Category R
- Category A
- Category B
- Category C
- Crown spread: retained trees
- Trees For Removal

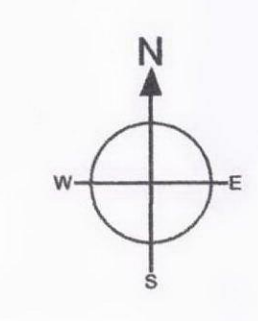

SJ Stephens Associates
Savernake Barn, Stokke Common
Great Bedwyn
Marlborough
Wiltshire SN8 3LL
01672 871862
www.sjstephens.co.uk

JOB TITLE
OAKHILL PARK, HAMPSTEAD

DRAWING TITLE
TREE HAZARD ASSESSMENT

DRAWING NUMBER
2009/ 546

REV

REVISIONS

SCALE
1:400 at A1

DATE
Sep 09

DRAWN BY
S Stephens