

Section BB
Scale 1:100 @ A1 (1:200 @ A3)

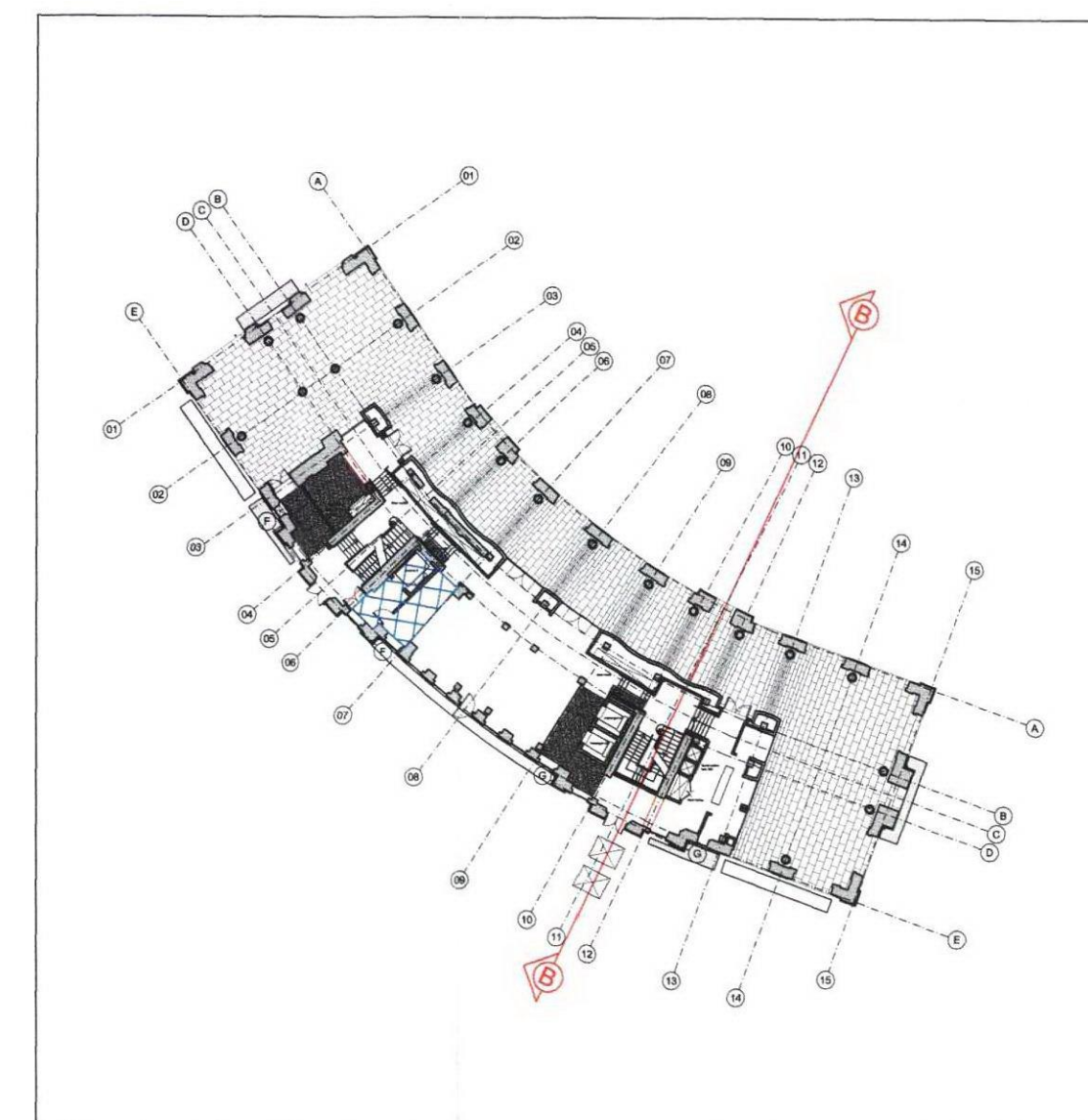
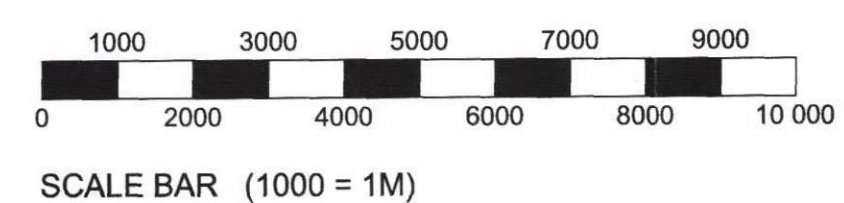

Copyright: All rights reserved. This drawing must not be reproduced without permission.
Only the original drawing should be relied upon. Contractors, subcontractors and suppliers must verify all dimensions on site before commencing any work or making any shop drawings.
All shop drawings to be submitted to the architect for comment prior to fabrication.
This drawing is to be read in conjunction with the Architect's specification, bills of quantities / schedules, structural, mechanical & electrical drawings and all discrepancies are to be reported to the architect.
Do not scale from this drawing. Dimensions are in millimetres unless otherwise stated.

NOTES

Existing section taken from Allies and Morrison drawings reference no. 452_08_201 Rev P6 dated 05 Apr 2007.

Drawing also overlaid against Michael Gallie & Partners Survey drawings reference no. 6303/10 rev B dated Dec 2005.

Structural Floor build up assumed, not accurately drawn.

Green dashed line indicating new internal studwork & plasterboard walls, new suspended plasterboard ceiling & new acoustic floating floor

A ISSUED FOR APPROVAL
ISSUE FOR PRE APPLICATION
rev amendments date by

dexter
moren
associates
architecture urban design
interior design creative media
www.dextermoren.com
dmg@dextermoren.com

project
Great Northern Hotel
King's Cross London
client
Aries GNH (GP) Limited

drawing title
Proposed
Section B B
drawing status

FOR APPROVAL

scale	date	drawn by	checked by
1:100 @ A1	03.02.10	MC	KS
1:200 @ A3			
job no.	drawing no.	revision	
0835	PP-135	A	