

Section AA
Scale 1:100 @ A1 (1:200 @ A3)

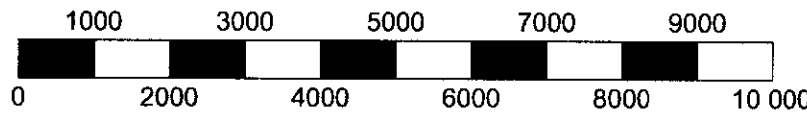

SCALE BAR (1000 = 1M)

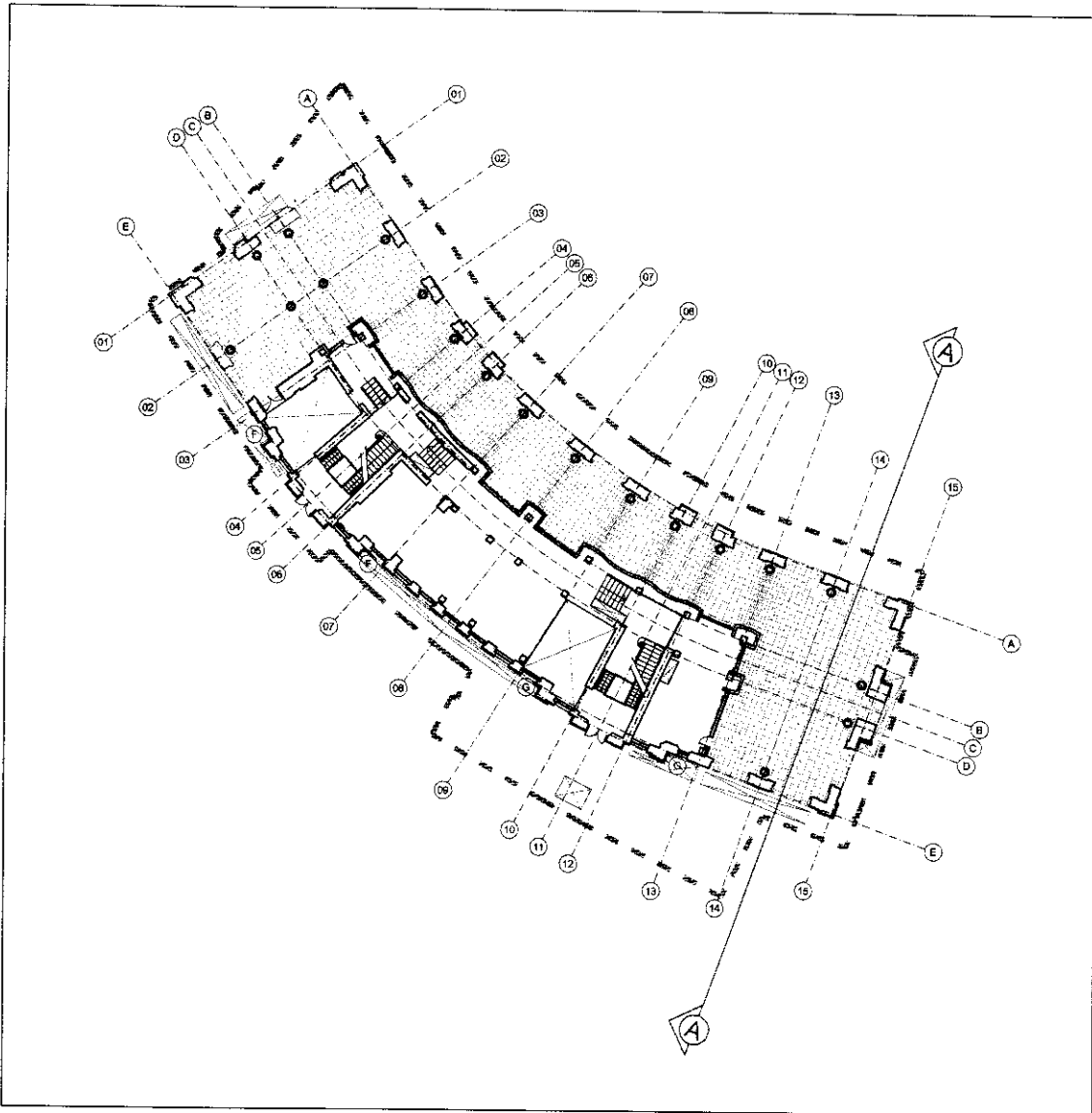

Copyright: All rights reserved. This drawing must not be reproduced without permission.
Only the original drawing should be relied upon. Contractors, subcontractors and suppliers must verify all dimensions on site before commencing any work or making any shop drawings.
All shop drawings to be submitted to the architect for comment prior to fabrication.
This drawing is to be read in conjunction with the Architect's specification, bills of quantities / schedules, structural, mechanical & electrical drawings and all discrepancies are to be reported to the architect.
Do not scale from this drawing. Dimensions are in millimetres unless otherwise stated.

NOTES

Existing section taken from Lawray Architects drawings reference no. 212_04_200 'as built' dated Nov 07.
Drawing also overlaid against Michael Gallie & Partners Survey drawings reference no. 6303/10 rev B dated Dec 2005.
Existing part sections details also taken from Kier Group drawings received from MACE dated 04 Jan 2010.

Existing windows temporary blocked up and rendered by others to be removed.

B	ISSUED FOR APPROVAL	June 2010	MC
A	ISSUE FOR PRE APPLICATION	08.02.10	KS
	Drawing no updated. Drawing updated with Kier Group Drawing information received from MACE dated 04 Jan 2010.	20.01.10	MC
rev	amendments	date	by

**dexter
moren
associates**
architecture urban design
interior design creative media
www.dextermoren.com
dm@dextermoren.com

57d
jamestown road
london nw1 7db
UK

T: 020 7267 4440
F: 020 7267 6044

project
Great Northern Hotel
King's Cross London
client
Aries GNH (GP) Limited

drawing title
**Existing
Section A A**
drawing status

FOR APPROVAL

scale	date	drawn by	checked by
1:100 @ A1 1:200 @ A3	27.11.09	MC	KS

job no.	drawing no.	revision
0835	PP-115	B