

# GBA

## **GEOFFREY BUNYAN ASSOCIATES**

31 Drayton Road ▪ Newton Longville ▪ Milton Keynes ▪ Buckinghamshire ▪ MK17 0BH  
Telephone: 01908 644130 ▪ Fax: 01908 645682 ▪ Mobile: 07702 432656  
Email: [geoff.gba.co.uk@live.co.uk](mailto:geoff.gba.co.uk@live.co.uk)

**3 KIDDERPORE AVENUE  
LONDON NW3**

## **SUPPLEMENTARY ARBORICULTURAL REPORT**

*September 2009*



## **GEOFFREY BUNYAN ASSOCIATES**

31 Drayton Road ▪ Newton Longville ▪ Milton Keynes ▪ Buckinghamshire ▪ MK17 0BH  
Telephone: 01908 644130 ▪ Fax: 01908 645682 ▪ Mobile: 07702 432656  
Email: [geoff.gba.co.uk@live.co.uk](mailto:geoff.gba.co.uk@live.co.uk)

**3 KIDDERPORE AVENUE**

**LONDON NW3**

### **SUPPLEMENTARY ARBORICULTURAL REPORT**

#### **Introduction**

1. Further to the arboricultural report prepared by Geoffrey Bunyan Associates in respect of the ash tree in the north-west corner of the site the local planning authority has asked for an assessment of trees located outside the application site within the gardens of adjoining residential properties.
2. The attached Drg. No. GBA1009.02 (Scale 1:200) indicates trees 1-5 and 7 which are outside the site. There was no access to these six trees and all observations were made from within the curtilage of 3 Kidderpore Avenue.

#### **Ash 1**

3. This tree has an estimated trunk diameter of 350mm and is approximately 5m from the boundary of the site.

There is difference in ground level between the base of this tree and the curtilage of 3 Kidderpore Avenue of approximately 3m. The application site is at the higher level with a retaining wall along the boundary between the two properties.

4. Given this marked difference in ground levels it is likely that the retaining wall and its foundations have provided an effective barrier to root development into the application site at this point and the proposed development is unlikely to have any impact upon the ash tree.

#### **Ash 2**

5. This is a smaller tree than ash 1 and a little closer to the application site. However, as with Ash 1, the retaining wall will have prevented its roots from extending into the curtilage of 3 Kidderpore Avenue and the tree is unlikely to be affected by the proposed development.

#### **Cypresses 3 and 5, Hornbeam 4**

6. These three trees are located within the residential curtilage adjacent to the north-west site boundary. At this point there is no difference in ground levels on either side of the boundary but the ground does fall away south westerly beyond the trees.
7. Within the application site adjacent to the three trees is the wall of a structure built over a swimming pool. The wall is approximately 2m from the boundary and just inside the wall is the pool which at this point is 3m deep. Allowing for the sub-structure of the pool, the overall depth of the wall alongside the three trees must be well in excess of 4m and this will have prevented any root development into this part of the site.
8. It is intended that the wall of the proposed new house will follow the line of the existing pool wall at this point as indicated on the house plans. This means that the soil and any roots therein within this strip of land will not be disturbed or existing ground levels altered. It will be necessary to provide tree protection

barriers for this area during demolition and construction work and the position of protective fencing will need to take account of working space and access. It may also be necessary to provide some form of protection to the ground in order to prevent the compaction of the soil over any roots in the vicinity.

#### **Ash 6**

9. This tree is the only tree located within the curtilage of the site and is the subject of my earlier report submitted in March 2009. At the time of my previous inspection the tree was not in leaf and thus I was unable to assess vigour. However, during my inspection today (16 September 2009) it was noted that there is considerable die-back in the tree, particularly in the upper crown where small branches as well as clusters of twigs and shoots are devoid of foliage. The crown has the appearance of a tree in decline.

#### **London plane 7**

10. This is located adjacent to the south eastern boundary of the rear garden of the house to the south-east of the site. It was only possible to estimate the girth diameter, 800-900mm, and with the tree located approximately ten metres from where the excavation for the new house would take place, whilst there may be some marginal encroachment of the tree's root protection area, this is well within the tolerance recommended in the BS and it is unlikely that the proposals would affect the London plane.

---

G.V. Bunyan

September 2009

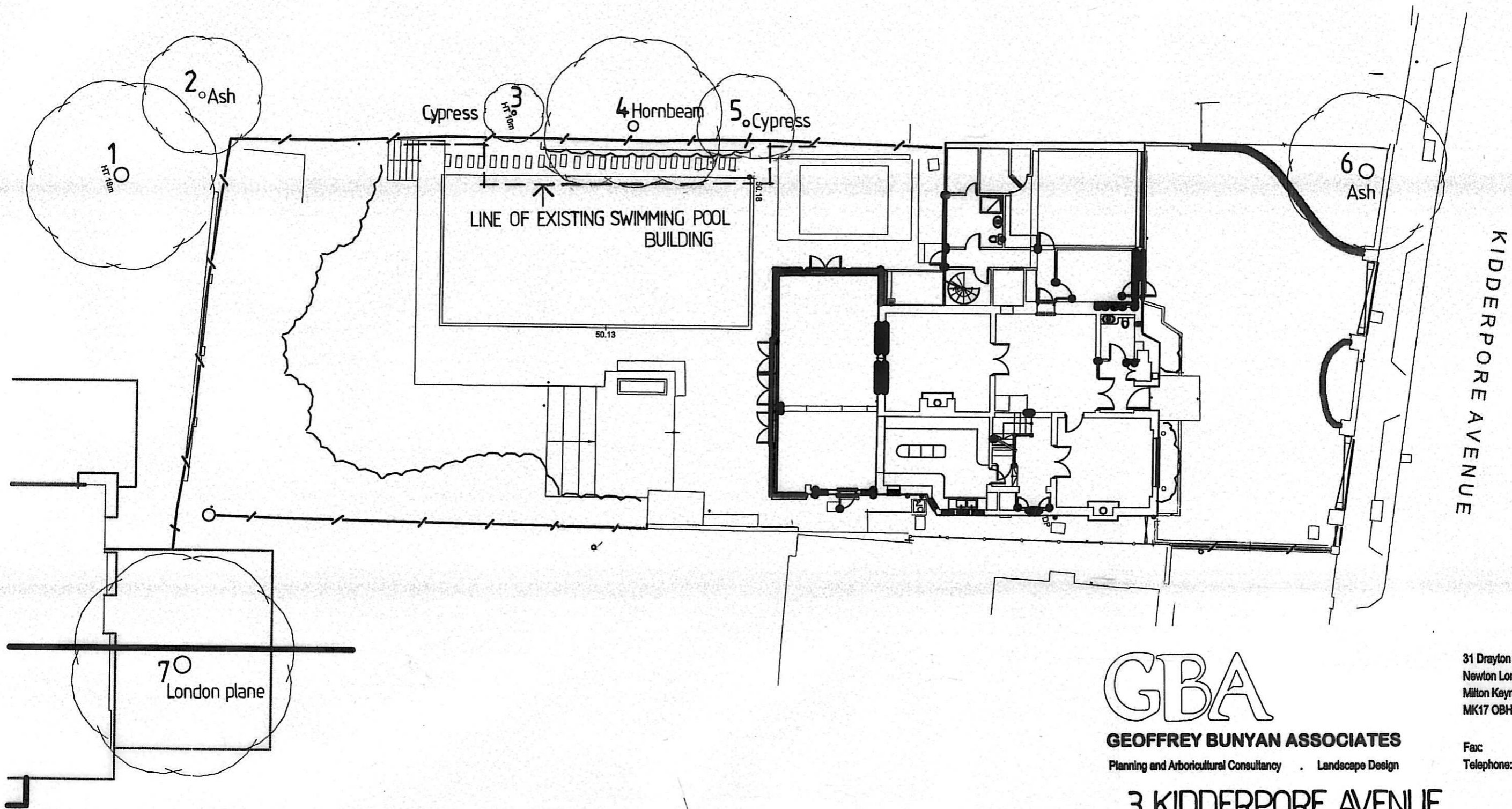

Scale 1:200 (A3)

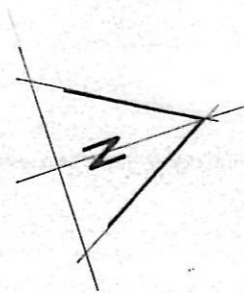

**GBA**

**GEOFFREY BUNYAN ASSOCIATES**  
 Planning and Arboricultural Consultancy . Landscape Design

31 Drayton Road  
 Newton Longville  
 Milton Keynes  
 MK17 0BH

Fax: 01908 645682  
 Telephone: 01908 644130

**3 KIDDERPORE AVENUE**  
**LONDON NW3**  
**Tree Appraisal (2)**

Drp. No. **GBA1009-02**

Date. September '09