

CA

Planning Services
Camden Town Hall
Argyle Street
London WC1H 8EQ

Email (enquiries only): env.devcon@camden.gov.uk
Telephone : 020 7974 1911
Fax : 020 7974 5713

For office use
Date
Payee
App. No. Fee

Application for tree works: works to trees subject to a tree preservation order (TPO) and/or notification of proposed works to trees in a conservation area.
Town and Country Planning Act 1990

Publication of applications on planning authority websites.

Please note that the information provided on this application form and in supporting documents may be published on the Authority's website. If you require any further clarification, please contact the Authority's planning department.

1. Applicant Name, Address and Contact Details

Title: First name: Surname:

Company name:

Street address:

Town/City:
County:
Country:
Postcode:

Telephone number: Country Code National Number Extension Number

Mobile number:

Fax number:

Email address:

Are you an agent acting on behalf of the applicant? Yes No

2. Agent Name, Address and Contact Details

Title: First Name: Surname:

Company name:

Street address:

Town/City:
County:
Country:
Postcode:

Telephone number: Country Code National Number Extension Number

Mobile number:

Fax number:

Email address:

206/3502/T → 2u Well Rd
206/3504/T → 1u Common Place

3. Trees Location

Please provide the address of the site where the tree(s) stands (full address if possible):

House:	24	Suffix:	
House name:			
Street address:	WELL ROAD		
Town/City:	LONDON		
County:			
Postcode:	NW3 1LH		

Description:

If the location is unclear or there is not a full postal address, either describe as clearly as possible where it is (for example, 'Land to rear of 12 to 18 High Street' or 'Woodland adjoining Elm Road') or provide an Ordnance Survey grid reference:

4. Trees Ownership

The applicant is the owner of the trees

5. What Are You Applying For?

Are you seeking consent for works to a tree(s) subject to a TPO?

Yes No

Are you wishing to carry out works to tree(s) in a conservation area?

Yes No

6. Tree Preservation Order Details

If you know which TPO protects the tree(s) enter its title or number below

n/a

7. Identification Of Tree(s) And Description Of Works

Please identify the tree(s) and provide a full and clear specification of the works you want to carry out. Continue on a separate sheet if necessary. You might find it useful to contact an arborist (tree surgeon) for help with defining appropriate work. Where trees are protected by a TPO, please number them as shown in the First Schedule to the TPO where this is available. Use the same numbers on your sketch plan (see guidance notes).

Please provide the following information below : tree species (and the number used on the sketch plan) and description of works. Where trees are protected by a TPO you must also provide reasons for the work and, where trees are being felled, please give your proposals for planting replacement trees (including quantity, species, position and size) or reasons for not wanting to replant.

E.g. Oak (T3) - fell because of excessive shading and low amenity value. Replant with 1 standard ash in the same place.

G1 - Row of sycamore and one Horse Chestnut
To remove the lower overhanging branches and reduce the upper overhanging branches. reason: overhanging new extension roof
T1 - Holly - To reduce the height and reshape.
Reason: general maintenance

8. Trees - Additional Information

For all trees

A sketch plan clearly showing the position of trees listed in Question 7 must be provided when applying for works to trees covered by a TPO. A sketch plan is also advised when notifying the LPA of works to trees in a conservation area (see guidance notes). It would also be helpful if you provided details of any advice given on site by an LPA officer.

For works to trees covered by a TPO

Please indicate whether the reasons for carrying out the proposed works include any of the following. If so, your application must be accompanied by the necessary evidence to support your proposals. (See guidance notes for further details)

1. **Condition of the tree(s)** - e.g. it is diseased or you have fears that it might break or fall:

If YES, you are required to provide written arboricultural advice or other diagnostic information from an appropriate expert.

Yes No

2. **Alleged damage to property** - e.g. subsidence or damage to drains or drives.

If YES, you are required to provide for:

Yes No

Subsidence

A report by an engineer or surveyor, to include a description of damage, vegetation, monitoring data, soil, roots and repair proposals. Also a report from an arboriculturist to support the tree work proposals.

Other structural damage (e.g. drains, walls and hard surfaces)

Written technical evidence from an appropriate expert, including description of damage and possible solutions.

Documents and plans (for any tree)

Are you providing additional information in support of your application?

Yes No

9. Authority Employee/Member

With respect to the Authority, I am:

- (a) a member of staff
- (b) an elected member
- (c) related to a member of staff
- (d) related to an elected member

Do any of these statements apply to you?

Yes No

10. Trees - Declaration

I/we hereby apply for planning permission/consent as described in this form and the accompanying plans/drawings and additional information.



Date:

06/06/2010

TREE LOCATIONS AT 24 WELL ROAD.

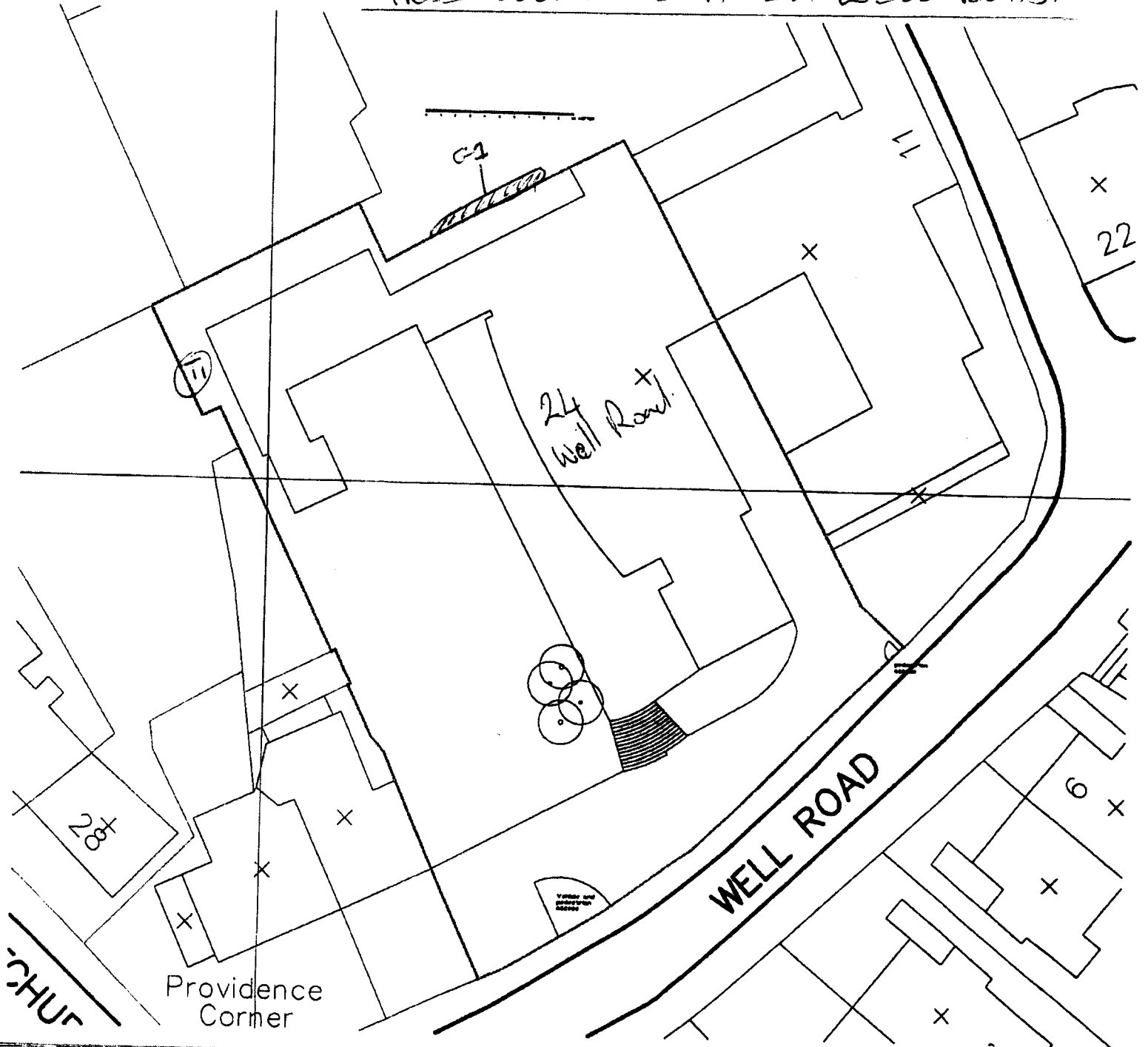

SHUR

Providence
Corner

WELL ROAD

WELL ROAD

6

28

22

24
Well Road

C1