

Contents & Introduction:

Site Location / Existing Use..... 3

Proposed Use ..... 4

Landscape & Appearance..... 5

Previous Applications..... 6

Introduction:

This Design and Access Statement should be read in conjunction with all other application drawings.

Note:  
This report has been prepared by Cordelia Hänel for Camden Council, London and Lior Levin and is solely intended for their use and benefit.  
Nothing in this report shall confer any liability duty or benefit to any other party unless agreed in writing beforehand.  
All intellectual material remain the property of Cordelia Hänel otherwise expressly agreed in writing.

---

## Site Location

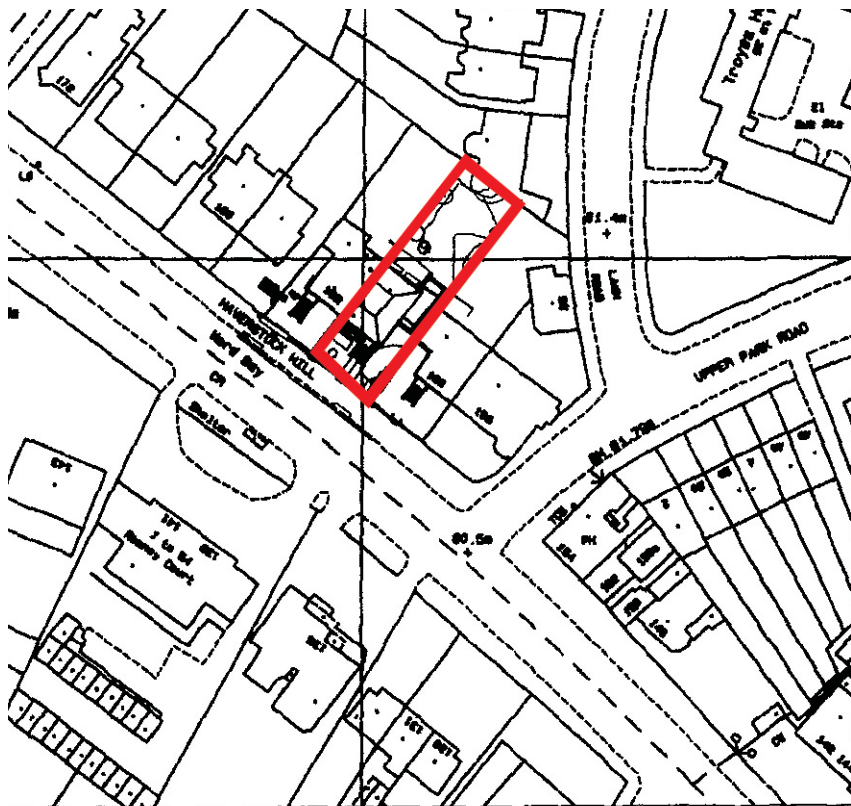

The site is located in Belsize Park, London which is part of London Borough of Camden. The area is predominantly residential use. There does not seem to be any office/commercial use.

## Site Location/ Existing Use



160 Haverstock Hill itself is a Terrace House separated into several flats.



There is a driveway with on-site parking facilities.

## Proposed Use



The scheme exists of a new stainless steel stair connecting the terrace of the Upper Groundfloor with the garden/lower Groundfloor.

It also foresees a Patio door leading from the side extension of the upper groundfloor directly onto the terrace.

## Landscape & Appearance

### Proposed Stairs:

Material:  
Stainless Steel

Colour:  
Anthrazite

### Proposed Patio Doors:

Material:  
White hardwood timber doors

Colour:  
White

### Proposed Folding Sliding Patio Doors:

Material:  
White hardwood timber doors

Colour:  
White

---