

1. THIS DRAWING IS TO BE READ IN CONJUNCTION WITH ALL RELEVANT ARCHITECTS, LANDSCAPE ARCHITECTS AND ENGINEERS' DRAWINGS AND SPECIFICATIONS.
2. ALL WORKING DIMENSIONS TO BE CHECKED ON SITE.
3. DO NOT SCALE.
4. ANY DISCREPANCIES BETWEEN DRAWINGS OF DIFFERENT SCALES AND BETWEEN DRAWINGS AND SPECIFICATION WHERE APPROPRIATE TO BE NOTIFIED TO THE ENGINEER FOR DECISION.
5. COPYRIGHT RESERVED, THIS DRAWING MAY ONLY BE USED FOR THE CLIENT AND LOCATION SPECIFIED IN THE TITLE BLOCK. IT MAY NOT BE COPIED OR DISCLOSED TO ANY THIRD PARTY WITHOUT THE PRIOR WRITTEN CONSENT OF AKT.
6. REFER TO DRAWING A041949-C-511 FOR VERTICAL ALIGNMENT AND TO DRAWING A041949-C-510 FOR OVERALL HORIZONTAL ALIGNMENT.

LEGEND	
	SITE BOUNDARY
	PROPOSED ROAD KERB AND BACK OF FOOTPATH
	PROPOSED ACCESS ROAD MARKINGS
	450mm x 450mm TACTILE PAVERS



Rev.	Description	Date	By	Project No: 08.33062.09	British Library Access
P1	ISSUED FOR PLANNING	23.06.10	MD	Drawn by: DS	Sheet Title: HORIZONTAL GEOMETRY JUNCTION WITH MIDLAND ROAD
P2	PLANNING ISSUE	25.06.10	MD	Drawn Date : APRIL 2010	Sheet Number: C-516
P3	PLANNING ISSUE	15.07.10	MD	Reviewed by : MD	Revision: P4
P4	PLANNING ISSUE	28.07.10	MD	Original drawing is A1 at scale above	
Do not scale dimensions from drawings. Site only to be dimensioned after construction. Report all dimensions after construction. This drawing is to be used in conjunction with all relevant documents and drawings.					

RETAINING WALL SECTION 1

DETAIL 1
C/S

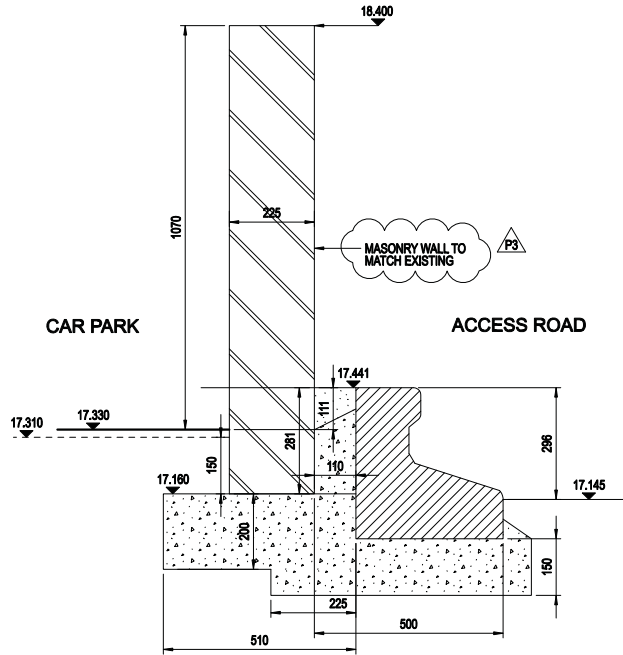

RETAINING WALL SECTION 2

DETAIL 2
C/S

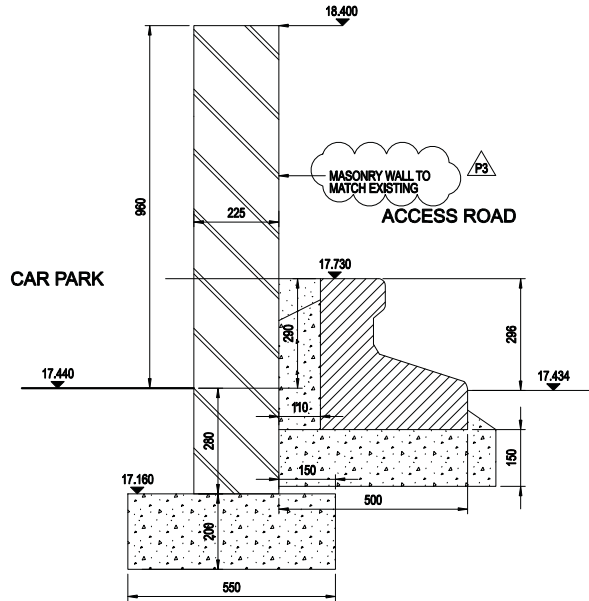

RETAINING WALL SECTION 3

DETAIL 3
C/S

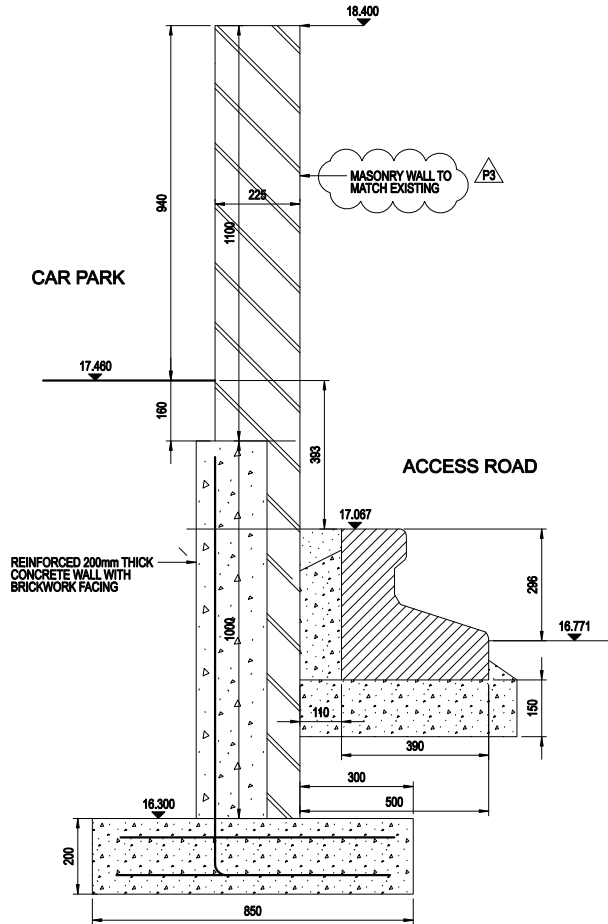

RETAINING WALL:

MASONRY TO BE IN ACCORDANCE WITH BS 5628, MORTAR TO BE DESIGNATION (iii).

BRICKS TO BE CLASS F (20 N/mm² COMPRESSIVE STRENGTH) FROST RESISTANT WITH LOW SOLUBLE SALT CONTENT. COLOR OF BRICKS TO BE CONFIRMED BY LANDSCAPE ARCHITECT AND TO MATCH EXISTING.

CONCRETE TO BE IN ACCORDANCE WITH BS8110. CONCRETE GRADE TO BE C28/35. RIBBED BAR REINFORCEMENT IN ACCORDANCE WITH BS4449 STRENGTH GRADE B500B UNLESS NOTED OTHERWISE. PROVIDE MINIMUM 50mm CONCRETE BLINDING BELOW BASE.

1. THIS DRAWING IS TO BE READ IN CONJUNCTION WITH ALL RELEVANT ARCHITECTS, LANDSCAPE ARCHITECTS AND ENGINEERS' DRAWINGS AND SPECIFICATIONS.
2. ALL WORKING DIMENSIONS TO BE CHECKED ON SITE.
3. DO NOT SCALE.
4. ANY DISCREPANCIES BETWEEN DRAWINGS OF DIFFERENT SCALES AND BETWEEN DRAWINGS AND SPECIFICATION WHERE APPROPRIATE TO BE NOTIFIED TO THE ENGINEER FOR DECISION.
5. COPYRIGHT RESERVED. THIS DRAWING MAY ONLY BE USED FOR THE CLIENT AND LOCATION SPECIFIED IN THE TITLE BLOCK. IT MAY NOT BE COPIED OR DISCLOSED TO ANY THIRD PARTY WITHOUT THE PRIOR WRITTEN CONSENT OF AKT.
6. MASONRY WALL DESIGNED AS VISUAL BARRIER ONLY.
7. REINFORCEMENT CONCRETE RETAINING WALL DESIGNED FOR SURCHARGE LOADING OF MAXIMUM 10 kN/m².

Key Plan:



Rev.	Description	Date	By	Project No: 06.33062.09
P1	ISSUED FOR PLANNING	23.06.10	MD	Drawn by: DS
P2	PLANNING ISSUE	01.07.10	MD	Drawn Date: APRIL 2010
P3	NOTES ADDED	28.07.10	MD	Reviewed by: MD
Original drawing is A1 at scale above				
Do not scale dimensions from drawings				
Site work to dimensions unless otherwise stated				
Reprint of drawings after amendments				
This drawing is to be used in conjunction with all relevant documents and drawings				

Rev.	Description	Date	By
P1	ISSUED FOR PLANNING	23.06.10	MD
P2	PLANNING ISSUE	01.07.10	MD
P3	NOTES ADDED	28.07.10	MD

British Library Access

Sheet Title:

ROAD ARRANGEMENT
RETAINING WALL SECTIONS

Sheet Number:

C-517

Revision:

P3

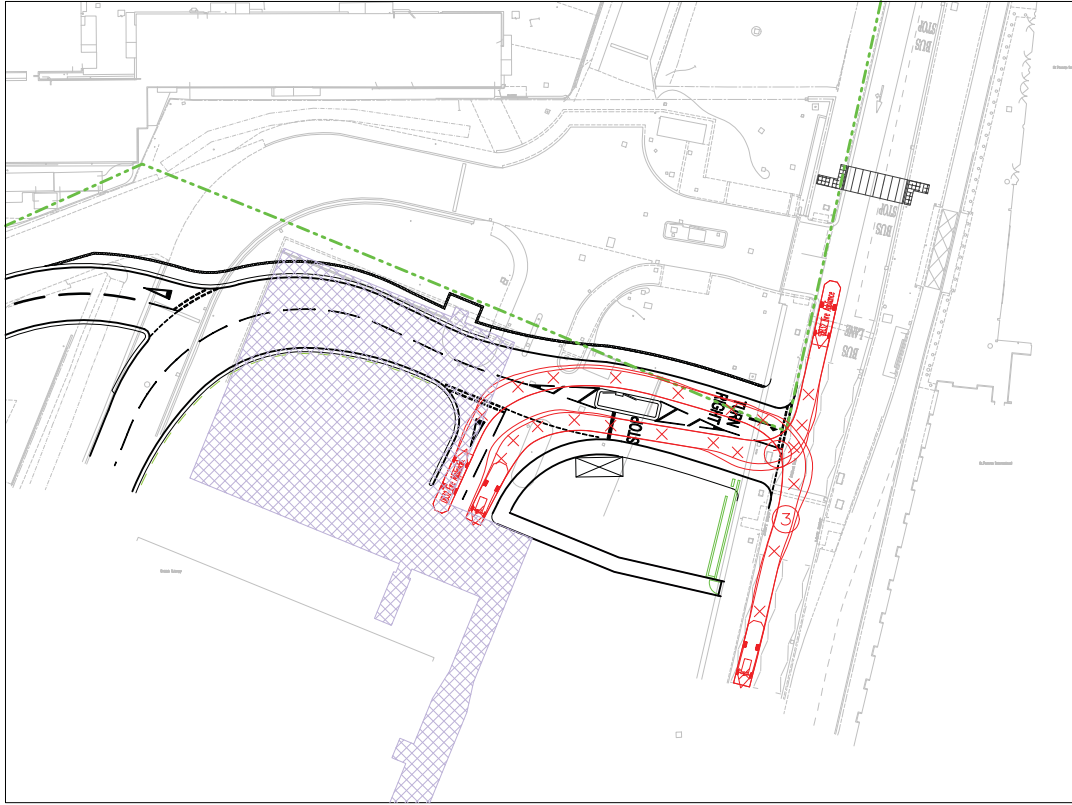

FIRE APPLIANCE SWEPT PATH

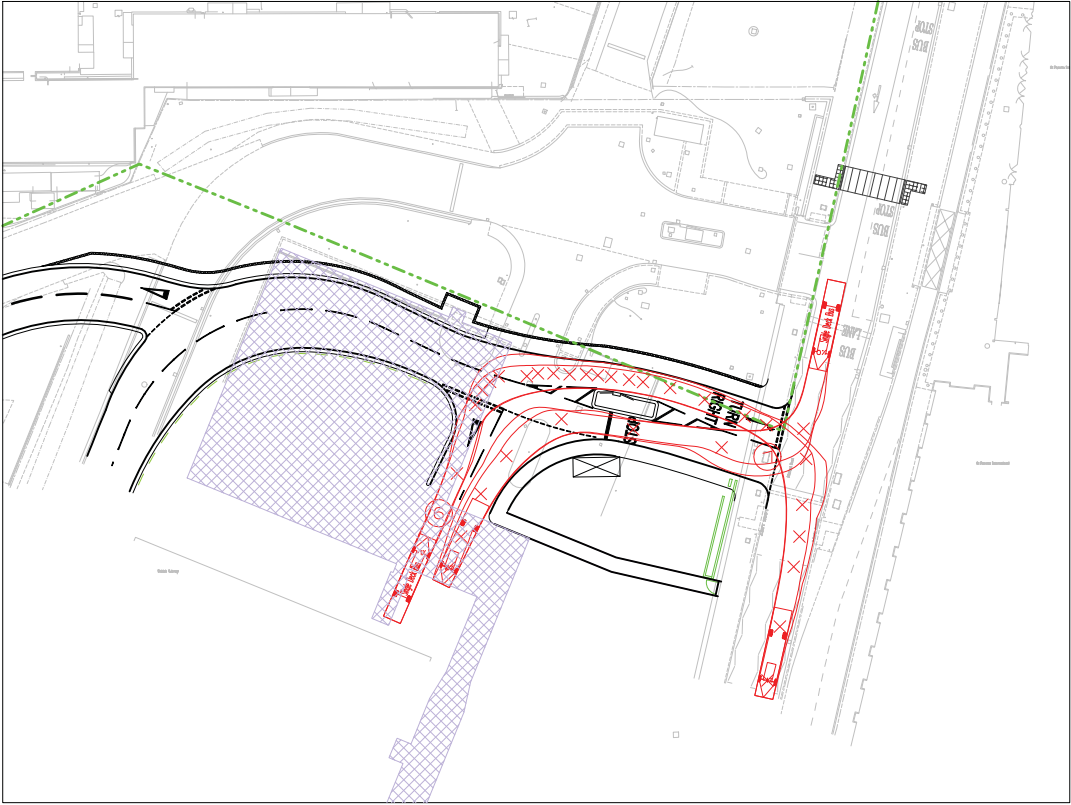

COACH SWEPT PATH

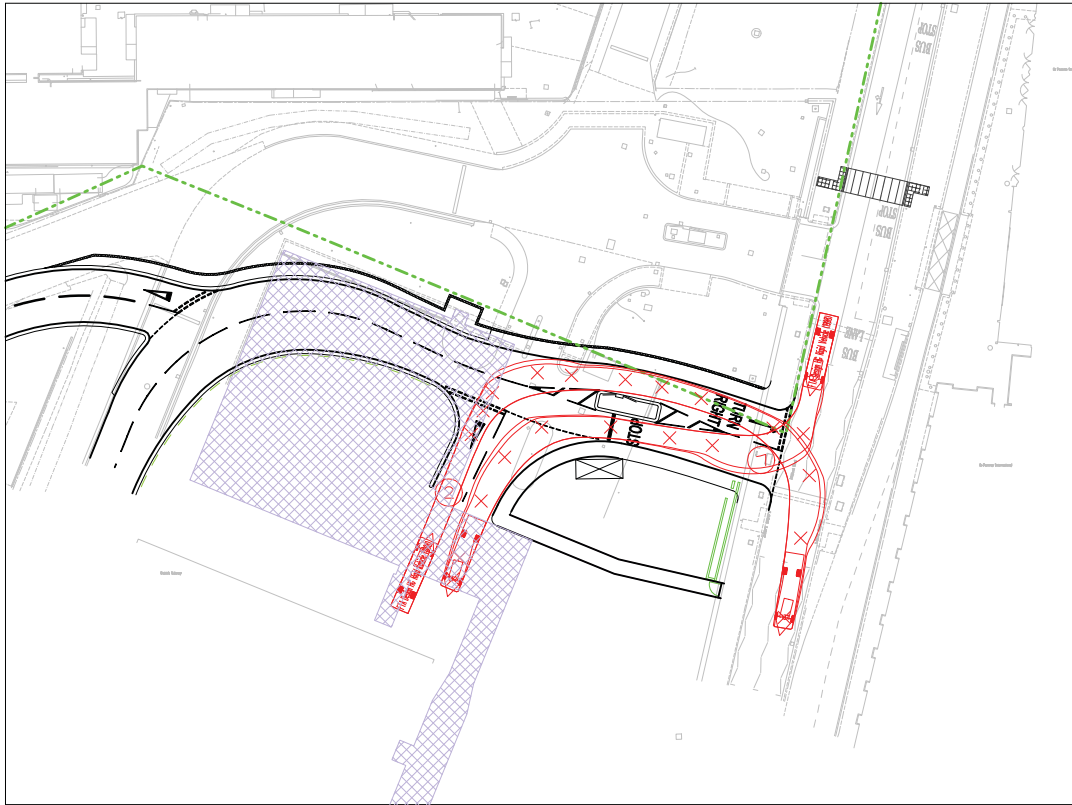

RIGID HGV SWEPT PATH

1. THIS DRAWING IS TO BE READ IN CONJUNCTION WITH ALL RELEVANT ARCHITECTS, LANDSCAPE ARCHITECTS AND ENGINEERS' DRAWINGS AND SPECIFICATIONS.
2. ALL WORKING DIMENSIONS TO BE CHECKED ON SITE.
3. DO NOT SCALE.
4. ANY DISCREPANCIES BETWEEN DRAWINGS OF DIFFERENT SCALES AND BETWEEN DRAWINGS AND SPECIFICATION WHERE APPROPRIATE TO BE NOTIFIED TO THE ENGINEER FOR DECISION.
5. COPYRIGHT RESERVED. THIS DRAWING MAY ONLY BE USED FOR THE CLIENT AND LOCATION SPECIFIED IN THE TITLE BLOCK. IT MAY NOT BE COPIED OR DISCLOSED TO ANY THIRD PARTY WITHOUT THE PRIOR WRITTEN CONSENT OF AKT.
6. THE SWEEP PATH CHECK HAS BEEN DONE FOR A FIRE ENGINE TYPE VEHICLE.

- LEGEND
- SITE BOUNDARY
 - PROPOSED RETAINING WALL
 - British Library Tank Farm
 - XXXXX PROPOSED LOCATION FOR BUND DESIGN TO BE CONFIRMED
 - PROPOSED ROAD KERB AND BACK OF FOOTPATH
 - Proposed Relocated Pedestrian Crossing



Rev.	Description	Date	By	Project No: 08.33062.09	British Library Access
P1	ISSUED FOR PLANNING	23.06.10	MD	Drawn by: DS	Sheet Title:
P2	ISSUED FOR COMMENTS	25.06.10	MD	Drawn Date: APRIL 2010	SWEPT PATH PLAN
P3	PLANNING ISSUE	01.07.10	MD	Reviewed by: MD	
P4	PLANNING ISSUE	16.07.10	MD	Original drawing is A1 at scale above	
P6	PLANNING ISSUE	28.07.10	MD	Do not scale dimensions from drawings Site only as dimensions after construction Report all dimensions after construction This drawing is to be used in conjunction with all relevant documents and drawings	Sheet Number: C-518
					Revision: P5