

6.0 Public Realm East Side Strategy

71

6.8

At the north east corner, the building addresses Midland Road with its principal entrances opening on to a generous public space mediating between the public roadway and the entrance lobby. This space fulfils a number of functions.

6.9

It serves as the front door to the building. The public realm provides a welcoming open aspect with spaces for visitors and researchers to enjoy and inhabit.

6.10

The public realm provides a new civic space with access to the building for members of the public at ground level and a separate staff entrance via steps and ramps to the secure upper level. The public space is envisaged as an urban space – open and welcoming.

6.11

The public realm is softened by birch trees on its northern edge where it connects with Purchase Street Open Space. The paving is a mixture of York stone and Caithness stone arranged in bands of varying texture and colour. The pattern reflects the building façades in their articulation and helps create a lively dynamic space.

6.12

As a result of below ground constraints, all of the trees will be in raised planters which also support generous public seating. Also located within the public realm are pedestrian scale light fixtures, cycle stands for visitors and stainless steel bollards.

6.13

Although not designed into the scheme, the generous public realm provides ample opportunity for public and private art installations to further enliven the public realm.

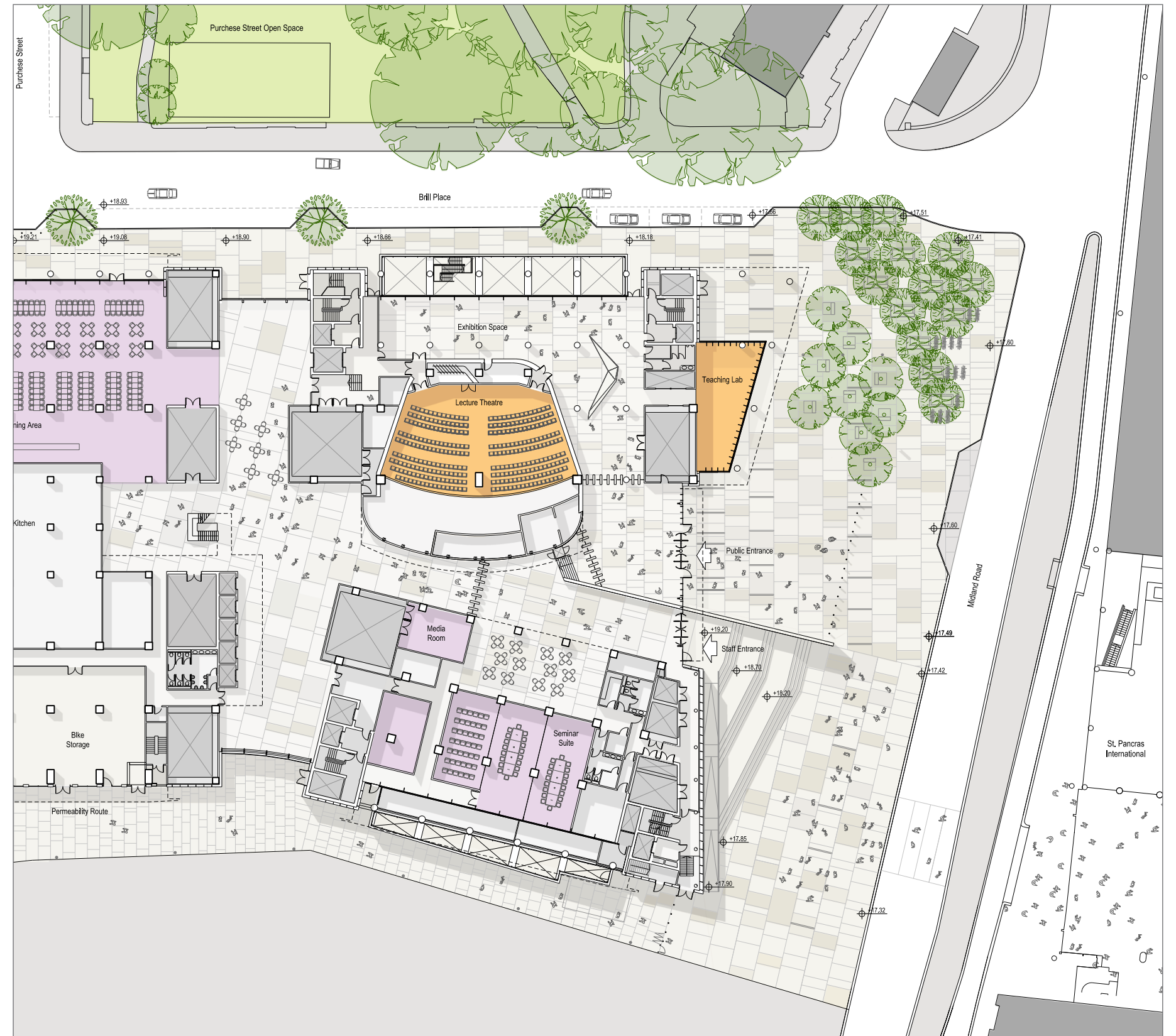

Fig 6-8. Public realm plan east; boundary trees are subject to approval of LBC as highways authority and affected utility companies