

EXISTING PLAN

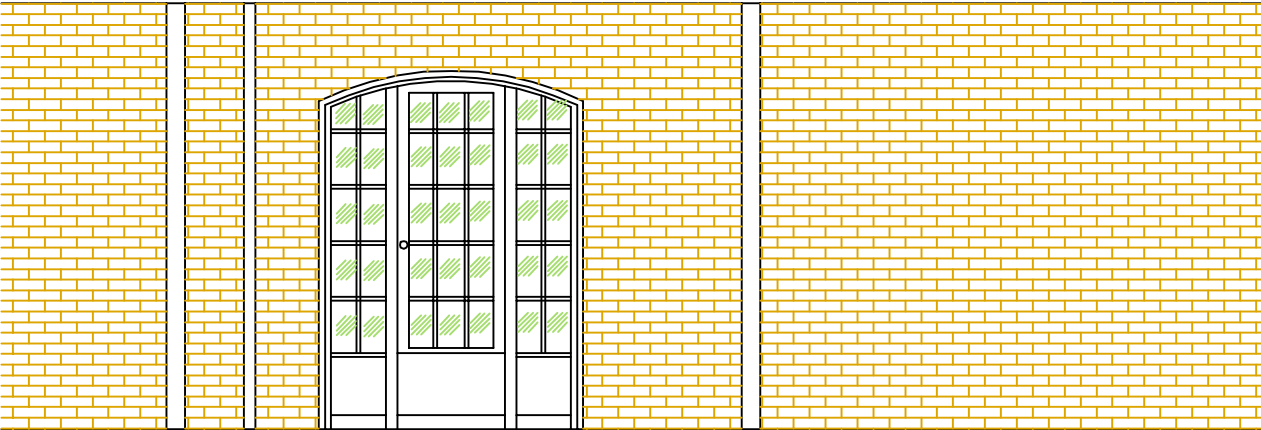

EXISTING ELEVATION

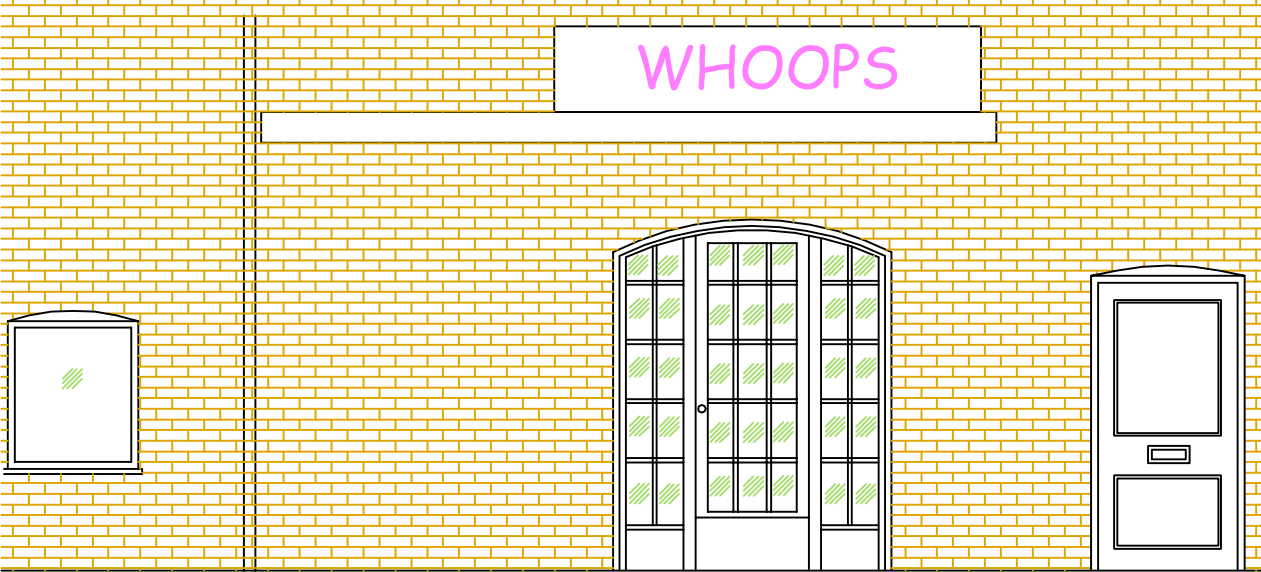
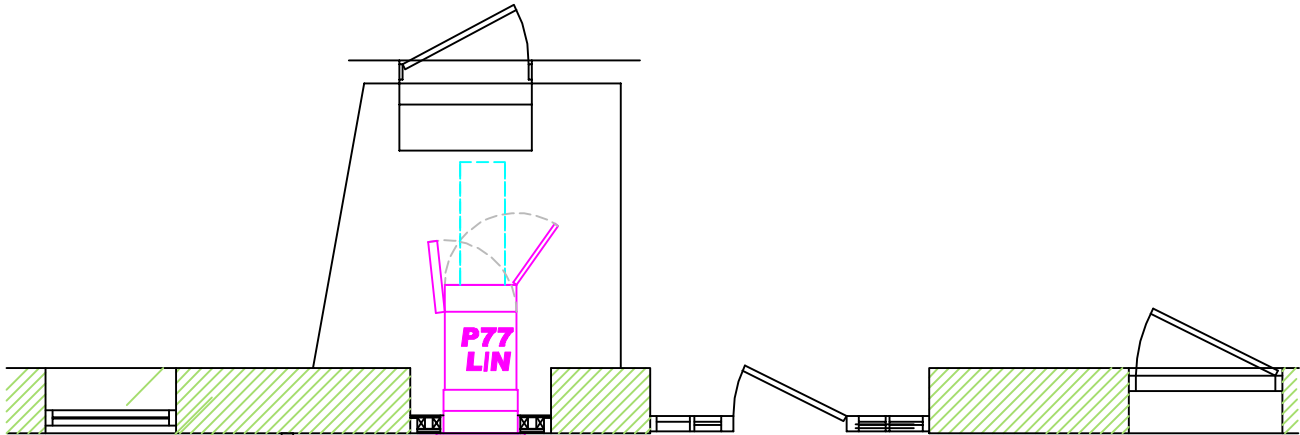

PROPOSED (PART) PLAN

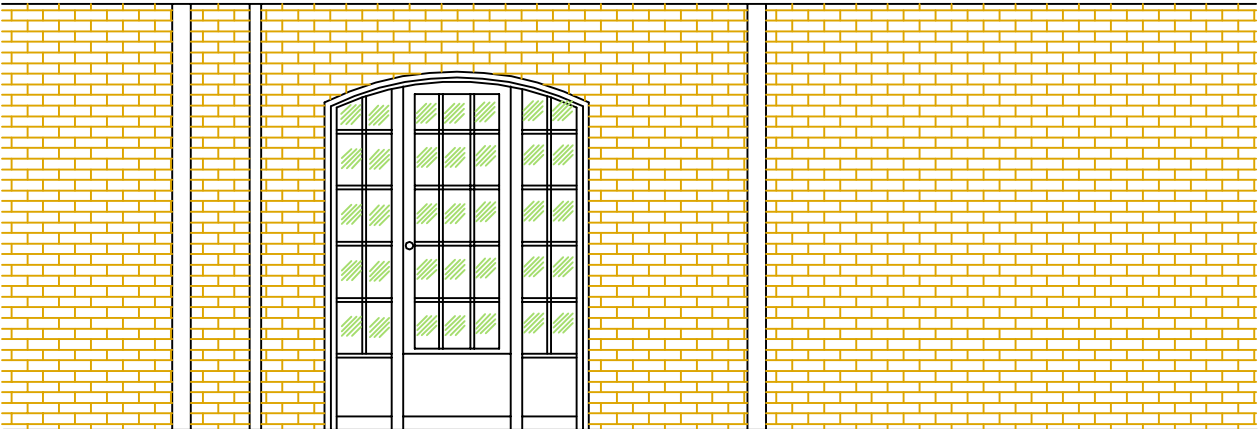
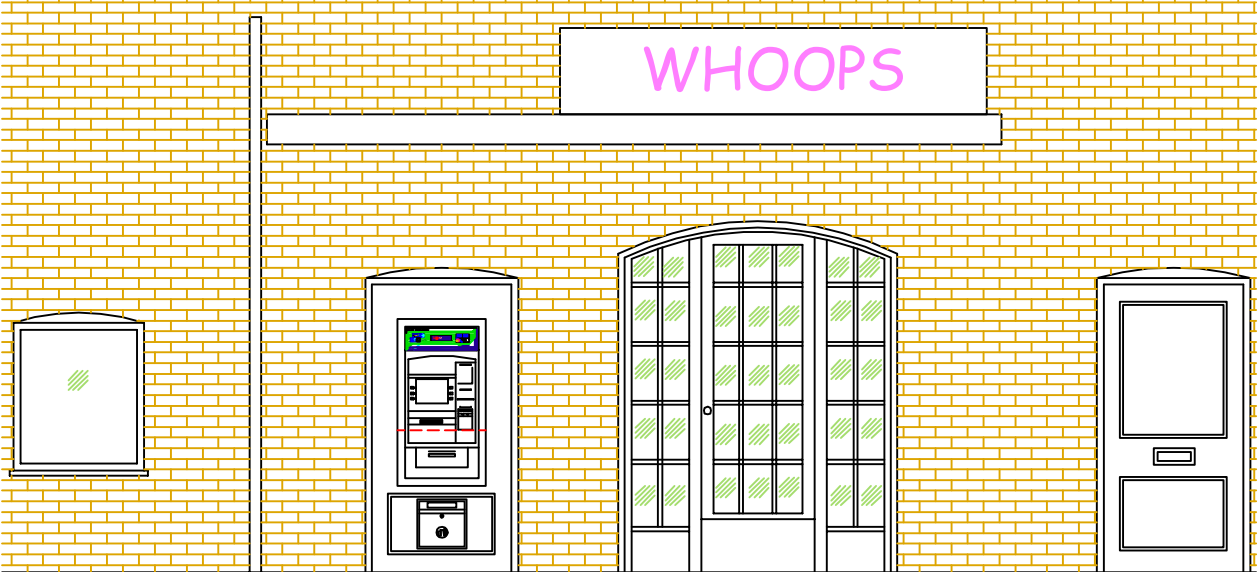

PROPOSED ELEVATION

SECTION AT ATM LOCATION
1:50

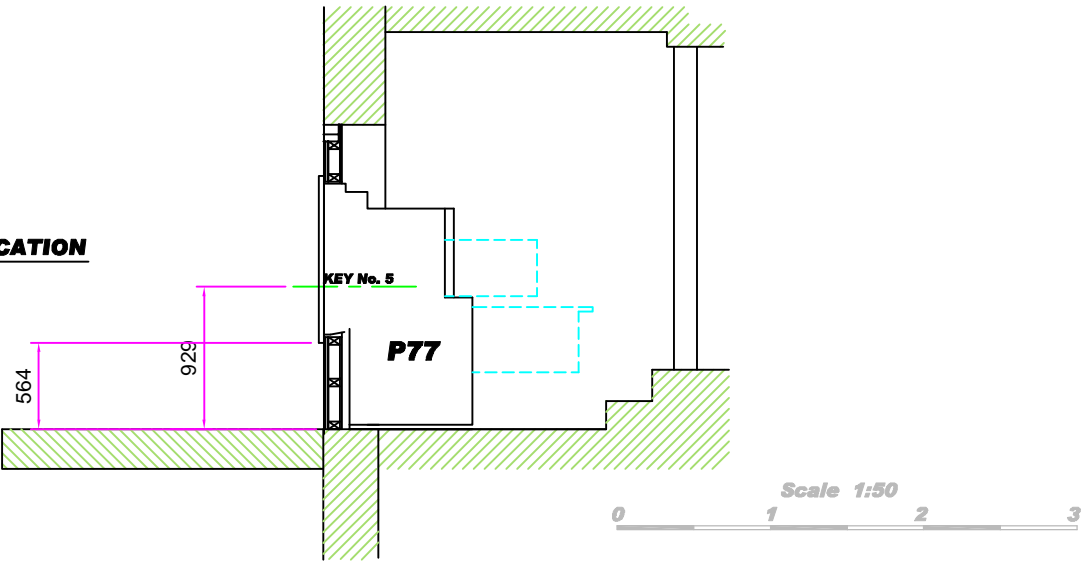

AND BUILDING REGULATION PURPOSES.

GENERAL NOTES

LIGHTING :-
ALL LIGHTING TO BE POSITIONED TO AVOID
DIRECT GLARE ON THE EYES OF THE USER AND
UNWANTED REFLECTIONS FROM THE SCREEN OR
OPERATING FEATURES. GLARE FROM LIGHTING
TO BE AVOIDED

ACCESS TO ATM :-
COMFORTABLE SIDE REACH CONTOURS FOR
WHEELCHAIR USERS TO COMPLY WITH FIGURE 10
OF THE DOCUMENT "ACCESS TO ATMs UK DESIGN
GUIDELINES 2002".

COMFORTABLE VIEWING ANGLES FOR AMBULANT
DISABLED PERSONS TO COMPLY TO FIGURE 4 OF
THE DOCUMENT "ACCESS TO ATMs UK GUIDELINES
2002".

COMFORTABLE VIEWING ANGLES AND REACH
CONTOURS FOR NON DISABLED PEOPLE TO
COMPLY WITH FIGURE 15 OF THE DOCUMENT
"ACCES TO ATMs UK GUIDLINES 2002".

SIGNAGE :-

ALL SIGNAGE TO CONFORM TO BS 8300:2001
SECTIONS 9.2.2 LOCATION & DESIGN OF SIGNS &
INFORMATION AND 9.2.3 VISUAL SIGNS.

ALL NEW GLAZING TO BS 6206

ALL ELECTRICAL WORK DONE TO BS 7671

SITE NOTES

FLOOR CONSTRUCTION :-
CARPET ON CONCRETE

WALL TO BE REMOVED TO ALLOW ATM ACCESS
INTO ROOM.

ATM, PLINTH,ELECTRICS,EXTERNAL LIGHT & NEW
SECURE FRAME AND DOOR (DOOR HUNG OUTWARDS)
TO BE INSTALLED

LAMINATE PANEL WITH SECURITY STUDWORK TO
BE INSTALLED, APERTURE TO BE FORMED IN
SECURITY STUDWORK.

LINTELS AND CAVITY CLOSURES TO BE INSTALLED.

WORK TO BE CARRIED OUT BY OTHERS

04			
03			
02			
01	atm changed to a 5877	28-05-10	

REVISION	DESCRIPTION	DATE
----------	-------------	------

SITE ADDRESS
CAMDEN LOCK MARKET,
CAMDEN LOCK PLACE, CHALK FARM ROAD
LONDON, NW1 8AF

TITLE
PROPOSED AUTOMATED TELLER MACHINE (ATM)
INSTALLATION FOR BANKMACHINE

DRAWN	BM	DATE	SCALE
REF/DRG No.	ER00702	SHEET	ATM
REVISION			1

CLIENT



Complete Technical Services Ltd.



ATM Installation &
Project Management
www.complete-tech.co.uk
01709 821757