

TreeWork Contractors and Consultants
R. G. Usher – Director of Arboriculture

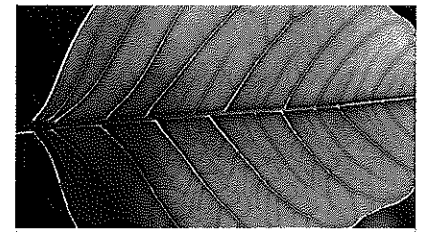

IMS (Ushers) Ltd
Arboriculture

4th October 2010

Mr K Fisher - Planning Department
London Borough of Camden
Planning Services
Town Hall
Argyle Street
London WC1H 8ND

5 Pond Close, Walkern Road
Stevenage, Herts. SG1 3QP
t 01438 727-252
f 01438 351-335

Email louise.v@imsushers.co.uk

Dear Mr Fisher

NOTICE OF INTENT

Re: 009978 - Tree work at 122 Frognal, London NW3 6XU

Please quote the above reference number on all correspondence.

We have been contracted to carry out tree work at the above site.

Please confirm by return, whether or not this is in a conservation area or if there are any TPO's on the trees in question.

If so, then the specification for works is as per attached schedule.

If you require any further information please do not hesitate to contact me at the office. Otherwise I will expect to hear from you within the due statutory six-week period.

Your earliest response would be greatly appreciated.

Thank you.

Yours sincerely

Louise Valentine
IMS (Ushers) Ltd

Enc:

Planning Services
Camden Town Hall
Argyle Street
London WC1H 8EQ

Email (enquiries only): env.devcon@camden.gov.uk
Telephone : 020 7974 1911
Fax : 020 7974 5713

For office use
Date
Payee
App. No. Fee

Application for tree works: works to trees subject to a tree preservation order (TPO)
and/or notification of proposed works to trees in a conservation area.

Town and Country Planning Act 1990

Publication of planning applications on planning authority websites

Please note that with the exception of applicant contact details, the information provided on this application form and in supporting documents may be published on the authority's website.

If you have provided any other information as part of your application which falls within the definition of personal data under the Data Protection Act which you do not wish to be published on the authority's website, please contact the authority's planning department.

Please complete using block capitals and black ink.

You must use this form if you are applying for work to trees protected by a tree preservation order (TPO). (You may also use it to give notice of works to trees in a conservation area).

It is important that you read the accompanying guidance notes before filling in the form. Without the correct information, your application / notice cannot proceed.

1. Applicant Name and Address

Title:		First name:	JENNA		
Last name:	BREWSTER				
Company (optional):	P C H A				
Unit:		House number:		House suffix:	
House name:					
Address 1:	192-196 HIGH RD				
Address 2:					
Address 3:					
Town:	WILKESDEN				
County:	LONDON				
Country:					
Postcode:	NW10 2PB				

2. Agent Name and Address

Title:		First name:	LOUISE		
Last name:	VALENTINUS				
Company (optional):	IMS USHERS LTD				
Unit:	5	House number:		House suffix:	
House name:					
Address 1:	POND CROSS				
Address 2:	WALKER ROAD				
Address 3:					
Town:	STUBBAGE				
County:	Herts				
Country:					
Postcode:	SG1 3QP				

3. Trees Location

If all trees stand at the address shown in Question 1, go to Question 4. Otherwise, please provide the full address/location of the site where the tree(s) stand (including full postcode where available)

Unit: House number: House suffix:

House name:

Address 1:

Address 2:

Address 3:

Town:

County:

Postcode (if known):

If the location is unclear or there is not a full postal address, either describe as clearly as possible where it is (for example, 'Land to the rear of 12 to 18 High Street' or 'Woodland adjoining Elm Road') or provide an Ordnance Survey grid reference:

Description:

JOB Ref:
009948

4. Trees Ownership

Is the applicant the owner of the tree(s): ☒ Yes ☐ No
If 'No' please provide the address of the owner (if known and if different from the trees location)

Title: First name:

Last name:

Company (optional):

Unit: House number: House suffix:

House name:

Address 1:

Address 2:

Address 3:

Town:

County:

Country:

Postcode:

Telephone numbers

Country code:	National number:	Extension number:
<input type="text" value="0208"/>	<input type="text" value="451 8100"/>	<input type="text"/>
Country code:	Mobile number (optional):	
<input type="text"/>	<input type="text"/>	
Country code:	Fax number (optional):	
<input type="text"/>	<input type="text"/>	
Email address (optional): <input type="text"/>		

5. What Are You Applying For?

Are you seeking consent for works to tree(s) subject to a TPO? ☐ Yes ☐ No not sure

Are you wishing to carry out works to tree(s) in a conservation area? ☐ Yes ☐ No not sure

6. Tree Preservation Order Details

If you know which TPO protects the tree(s), enter its title or number below.

7. Identification Of Tree(s) And Description Of Works

Please identify the tree(s) and provide a full and clear specification of the works you want to carry out. Continue on a separate sheet if necessary. You might find it useful to contact an arborist (tree surgeon) for help with defining appropriate work. Where trees are protected by a TPO, please number them as shown in the First Schedule to the TPO where this is available. Use the same numbers on your sketch plan (see guidance notes).

Please provide the following information below: tree species (and the number used on the sketch plan) and description of works. Where trees are protected by a TPO you must also provide reasons for the work and, where trees are being felled, please give your proposals for planting replacement trees (including quantity, species, position and size) or reasons for not wanting to replant.

E.g. Oak (T3) - fell because of excessive shading and low amenity value. Replant with 1 standard ash in the same place.

**PLEASE SEE ATTACHED
SPECIFICATION**

7. Identification Of Tree(s) And Description Of Works continued ...

8. Trees - Additional Information

Additional information may be attached to electronic communications or provided separately in paper format.

For all trees

A sketch plan clearly showing the position of trees listed in Question 7 must be provided when applying for works to trees covered by a TPO. A sketch plan is also advised when notifying the LPA of works to trees in a conservation area (see guidance notes). It would also be helpful if you provided details of any advice given on site by an LPA officer.

For works to trees covered by a TPO

Please indicate whether the reasons for carrying out the proposed works include any of the following. If so, your application must be accompanied by the necessary evidence to support your proposals. (See guidance notes for further details)

1. **Condition of the tree(s)** - e.g. it is diseased or you have fears that it might break or fall: ☐ Yes ☒ No
If YES, you are required to provide written arboricultural advice or other diagnostic information from an appropriate expert.

2. **Alleged damage to property** - e.g. subsidence or damage to drains or drives. ☐ Yes ☒ No
If YES, you are required to provide for:

Subsidence

A report by an engineer or surveyor, to include a description of damage, vegetation, monitoring data, soil, roots and repair proposals. Also a report from an arboriculturist to support the tree work proposals.

Other structural damage (e.g. drains, walls and hard surfaces)

Written technical evidence from an appropriate expert, including description of damage and possible solutions.

Documents and plans (for any tree)

Are you providing separate information (e.g. an additional schedule of work for Question 7)? ☐ Yes ☒ No

If YES, please provide the reference numbers of plans, documents, professional reports, photographs etc in support of your application. If they are being provided separately from this form, please detail how they are being submitted.

9. Application For Tree Works - Checklist

Only one copy of the application form and additional information (Question 8) is required. Please use the guidance and this checklist to make sure that this form has been completed correctly and that all relevant information is submitted. Please note that failure to supply precise and detailed information may result in your application being rejected or delayed. You do not need to fill out this section, but it may help you to submit a valid form.

Sketch Plan

- A sketch plan showing the location of all trees (see Question 8)

☒

For all trees

(see Question 7)

- Clear identification of the trees concerned
- A full and clear specification of the works to be carried out

☒☒

For works to trees protected by a TPO

(see Question 8)

Have you:

- stated reasons for the proposed works?
- provided evidence in support of the stated reasons? in particular:
 - if your reasons relate to the condition of the tree(s) - written evidence from an appropriate expert
 - if you are alleging subsidence damage - a report by an appropriate engineer or surveyor and one from an arboriculturist.
 - in respect of other structural damage - written technical evidence
- included all other information listed in Question 8?

☐☐☐☐☐

10. Declaration - Trees

I/we hereby apply for consent/give notice for tree work as described in this form and the accompanying plans and additional information.

Signed - Applicant:

Signed - Agent:

Date (DD/MM/YYYY):

(This date must not be before the date of sending or hand-delivery of the form)

11. Applicant Contact Details

Telephone numbers

Country code:

National number:

Extension number:

Country code:

Mobile number (optional):

Country code:

Fax number (optional):

Email address (optional):

12. Agent Contact Details

Telephone numbers

Country code:

National number:

Extension number:

Country code:

Mobile number (optional):

Country code:

Fax number (optional):

Email address (optional):

Electronic communication - If you submit this form by fax or e-mail the LPA may communicate with you in the same manner.

(Please see guidance notes)

PLANNING Work instruction

01 October 2010

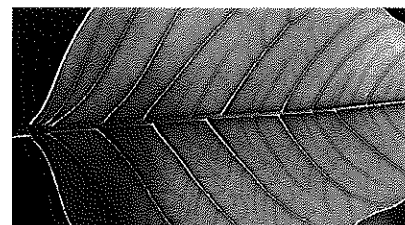

I M S (Ushers) Ltd
Arboriculture

Jemma Brewster
Paddington Churches Housing
Association
192-196 High Road
Willesden
London, NW10 2PB

5 Pond Close, Walkern Road
Stevenage, Herts. SG1 3QP
t: 01438 727 252 f: 01438 351 335

Louise Valentine
Louise.v@imsushers.co.uk



Quotation No: 009978
Estimator: James Forrest
Work date:

Site Address: 122 Frognal, London, NW3 6XU
Site Contact: Ms J Barrett Tel: 0207 692 2104
Client Contact: Tel: Mob: Fax: 0208 451 8119

Job description

REAR OF 122 with access
T1 - PRUNUS - roots lifting tenant's decking and causing trip hazard - fell
as close as possible to ground level
COMMUNAL AREA with open access
T2 - PRUNUS - roots are lifting paving and causing trip hazard - fell as
close as possible to ground level

Job completion record

Arrival time	Departure time	Completed?

Please note any of the following that are relevant to this job:

- the trees done (name and number on the map)
- new instructions from the client
- special requirements for the next site visit
- any incidents to vehicles, persons or property
- any other information about this job that would be helpful



Site Plan
Address:
Ref:

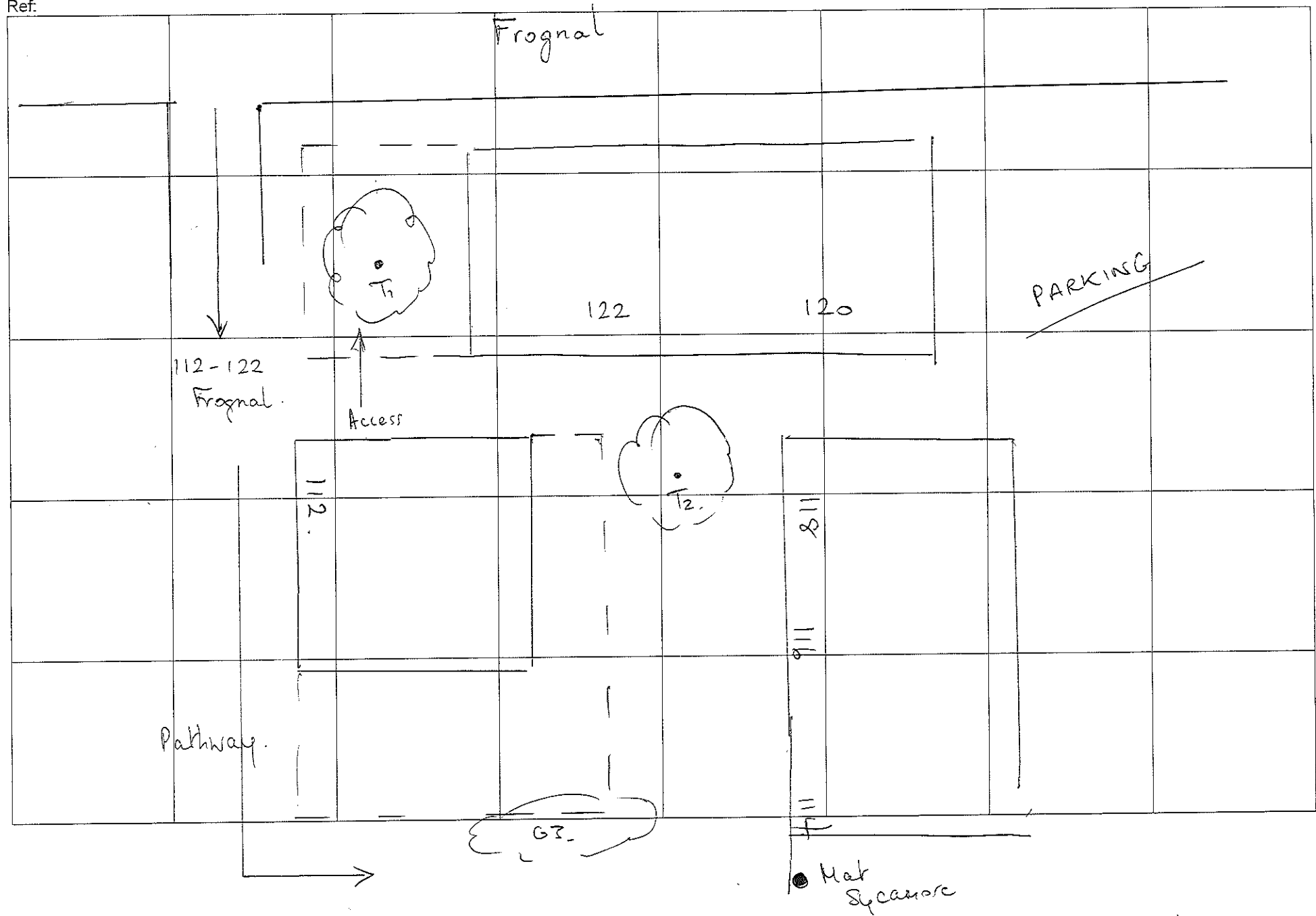



05.08.2010

