

Planning Services  
Camden Town Hall  
Argyle Street  
London WC1H 8EQ

Email (enquiries only): [env.devcn@camden.gov.uk](mailto:env.devcn@camden.gov.uk)  
Telephone : 020 7974 1911  
Fax : 020 7974 5713

For office use

Date

Page

App No.

Fee

CA  
206/6782/1

## Application for tree works: works to trees subject to a tree preservation order (TPO) and/or notification of proposed works to trees in a conservation area.

### Town and Country Planning Act 1990

You can complete and submit this form electronically via the Planning Portal by visiting [www.planningportal.gov.uk/apply](http://www.planningportal.gov.uk/apply)

#### Publication of applications on planning authority websites

Please note that the information provided on this application form and in supporting documents may be published on the Authority's website. If you require any further clarification, please contact the Authority's planning department.

Please complete using block capitals and black ink.

You must use this form if you are applying for work to trees protected by a tree preservation order (TPO). (You may also use it to give notice of works to trees in a conservation area).

It is important that you read the accompanying guidance notes before filling in the form. Without the correct information, your application / notice cannot proceed.

#### 1. Applicant Name and Address

Title:  First name:

Last name:

Company (optional):

Unit:  House number:  House suffix:

House name:

Address 1:

Address 2:

Address 3:

Town:

County:

Country:

Postcode:

#### 2. Agent Name and Address

Title:  First name:

Last name:

Company (optional):

Unit:  House number:  House suffix:

House name:

Address 1:

Address 2:

Address 3:

Town:

County:

Country:

Postcode:

### 3. Trees Location

If all trees stand at the address shown in Question 1, go to Question 4. Otherwise, please provide the full address/location of the site where the tree(s) stand (including full postcode where available)

Unit:		House number:	125	House suffix:	
House name:					
Address 1:	KING HENRY'S ROAD				
Address 2:					
Address 3:					
Town:	LONDON				
County:					
Postcode (if known):	NW3 3RB				

If the location is unclear or there is not a full postal address, either describe as clearly as possible where it is (for example, 'Land to the rear of 12 to 18 High Street' or 'Woodland adjoining Elm Road') or provide an Ordnance Survey grid reference:

Description:

--

### 4. Trees Ownership

Is the applicant the owner of the tree(s): ☐ Yes ☒ No  
If 'No' please provide the address of the owner (if known and if different from the trees location)

Title:		First name:	
Last name:			
Company (optional):	125 KING HENRY'S ROAD MANAGEMENT LTD		
Unit:	FLAT 1	House number:	125
House name:			
Address 1:	KING HENRY'S ROAD		
Address 2:			
Address 3:			
Town:	LONDON		
County:			
Country:	UK		
Postcode:	NW3 3RB		

Telephone numbers

Country code:	National number:	Extension number:
44	20 77 22 81 59	
Country code:	Mobile number (optional):	
44	7887 510131	
Country code:	Fax number (optional):	
Email address (optional):		
jill_babington@hotmail.com		

### 5. What Are You Applying For?

Are you seeking consent for works to tree(s) subject to a TPO? ☐ Yes ☒ No

Are you wishing to carry out works to tree(s) in a conservation area? ☒ Yes ☐ No

### 6. Tree Preservation Order Details

If you know which TPO protects the tree(s), enter its title or number below.

NONE WE CAN FIND

### 7. Identification Of Tree(s) And Description Of Works

Please identify the tree(s) and provide a full and clear specification of the works you want to carry out. Continue on a separate sheet if necessary. You might find it useful to contact an arborist (tree surgeon) for help with defining appropriate work. Where trees are protected by a TPO, please number them as shown in the First Schedule to the TPO where this is available. Use the same numbers on your sketch plan (see guidance notes).

Please provide the following information below: tree species (and the number used on the sketch plan) and description of works. Where trees are protected by a TPO you must also provide reasons for the work and, where trees are being felled, please give your proposals for planting replacement trees (including quantity, species, position and size) or reasons for not wanting to replant.

E.g. Oak (T3) - fell because of excessive shading and low amenity value. Replant with 1 standard ash in the same place.

SILVER BIRCH TREE JUST INSIDE NE GATEPOST  
IN FRONT AREA OF 125 KING HENRY'S ROAD

## 7. Identification Of Tree(s) And Description Of Works continued ...

SILVER BIRCH NEXT TO N.E. GATE POST :

SHALLOW ROOTS CAUSING PAVING TO RISE AND IT IS BECOMING A BIT UNSAFE TO WALK AND IS INCREASINGLY WORSE.

ROOTS WILL SOON DAMAGE BUILDING AS THE BASEMENT EXTENDS RIGHT OUT UNDER THE STEPS

PLAN IS TO PUT SUITABLE HEDGE IN THE BED ALONG THE FENCE

SKETCH PLAN ATTACHED

## 8. Trees - Additional Information

Additional information may be attached to electronic communications or provided separately in paper format.

### For all trees

A sketch plan clearly showing the position of trees listed in Question 7 must be provided when applying for works to trees covered by a TPO. A sketch plan is also advised when notifying the LPA of works to trees in a conservation area (see guidance notes). It would also be helpful if you provided details of any advice given on site by an LPA officer.

### For works to trees covered by a TPO

Please indicate whether the reasons for carrying out the proposed works include any of the following. If so, your application must be accompanied by the necessary evidence to support your proposals. (See guidance notes for further details)

1. **Condition of the tree(s)** - e.g. it is diseased or you have fears that it might break or fall:

If YES, you are required to provide written arboricultural advice or other diagnostic information from an appropriate expert.

☐ Yes

☒ No

2. **Alleged damage to property** - e.g. subsidence or damage to drains or drives.

If YES, you are required to provide for:

☒ Yes

☐ No

#### *Subsidence*

A report by an engineer or surveyor, to include a description of damage, vegetation, monitoring data, soil, roots and repair proposals. Also a report from an arboriculturist to support the tree work proposals.

#### *Other structural damage* (e.g. drains, walls and hard surfaces)

Written technical evidence from an appropriate expert, including description of damage and possible solutions.

### Documents and plans (for any tree)

Are you providing separate information (e.g. an additional schedule of work for Question 7)?

☒ Yes

☐ No

If YES, please provide the reference numbers of plans, documents, professional reports, photographs etc in support of your application. If they are being provided separately from this form, please detail how they are being submitted.

- 1) LETTER FROM BACKHOG LTD RE PLANNED REPAIRS
- 2) QUOTE FROM ORANGE TREES.NET — TREE SURGEONS WITH STATEMENT OF NON-SUITABILITY
- 3) SKETCH PLAN: 125 KING HENRY'S ROAD — FRONT OF BUILDING

## 9. Authority Employee / Member

With respect to the Authority, I am:

- (a) a member of staff (c) related to a member of staff  
(b) an elected member (d) related to an elected member

Do any of these statements apply to you?

☐ Yes

☒ No

If Yes, please provide details of the name, relationship and role

## 10. Application For Tree Works - Checklist

Only one copy of the application form and additional information (Question 8) is required. Please use the guidance and this checklist to make sure that this form has been completed correctly and that all relevant information is submitted. Please note that failure to supply precise and detailed information may result in your application being rejected or delayed. You do not need to fill out this section, but it may help you to submit a valid form.

### Sketch Plan

- A sketch plan showing the location of all trees (see Question 8)



### For all trees

(see Question 7)

- Clear identification of the trees concerned
- A full and clear specification of the works to be carried out

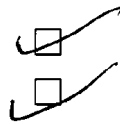

### For works to trees protected by a TPO

(see Question 7)

N/A

Have you:

- stated reasons for the proposed works?
- provided evidence in support of the stated reasons? in particular:
  - if your reasons relate to the condition of the tree(s) - written evidence from an appropriate expert
  - if you are alleging subsidence damage - a report by an appropriate engineer or surveyor and one from an arboriculturist.
  - in respect of other structural damage - written technical evidence
- included all other information listed in Question 8?

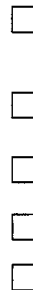

## 11. Declaration - Trees

I/we hereby apply for consent/give notice for tree work as described in this form and the accompanying plans and additional information.

Signed - Applicant:

Jill Babington

Or signed - Agent:

Date (DD/MM/YYYY):

13/12/2010

(This date must not be before the date of sending or hand-delivery of the form)

## 12. Applicant Contact Details

Telephone numbers

Country code:

National number:

Extension number

+44

20 77 22 8159

X

Country code:

Mobile number (optional):

+44

7887 510131

Country code:

Fax number (optional):

Email address (optional):

jill\_babington@hotmail.com

## 13. Agent Contact Details

Telephone numbers

Country code:

National number:

Extension number:

Country code:

Mobile number (optional):

Country code:

Fax number (optional):

Email address (optional):

Electronic communication - If you submit this form by fax or e-mail the LPA may communicate with you in the same manner.  
(Please see guidance notes)

**Backhog Ltd**  
**1 All Saints Road**  
**London W11 1HA**

Tel: 07720 149898 Fax: 020 7565 5861

Jill Babington  
Basement Flat  
125 King Henry's Road  
London

30<sup>th</sup> November 2010

Dear Jill

REF: Tree damage repairs at 125 King Henry's Road

Thank you for asking us to quote for the repair of the paved area directly outside the front of your building and adjacent to your boiler room.

As discussed on the phone, it would be futile to commence any repair works until the tree, which is obviously causing the problem, is removed. I suggest you get this done first by a qualified person and apply to the council for the necessary permission.

I don't foresee this being a problem, as the tree is causing damage to the building itself as well as the paved area. In time it can only cause more damage as it is far too close to the building, and is likely to make problems in your boiler room if the roots go through the damp proofing and into the floor area. It will also of course be a problem for the insurance company.

Please let me know when the tree has been removed, and we will be happy to come and carry out the repairs. Before then we shall be returning to complete the work on your flat roof so we can discuss costs and finishes then.

Best regards



Charles Hickey  
Backhog Ltd



# ORANGETREES.NET

EXPERIENCED TREE SURGEONS ■ FREE QUOTES ■ FULLY INSURED

07949 48 55 78 ■ LEE@ORANGETREES.NET ■ 020 8510 9646

Basement Flat, 74 Forburg Road, London, N16 6HT

Date: 13/08/10

Jill Babington

125 King Henrys Road

London

NW3 3RB

Dear Jill

Further to my recent meeting, please find quotation below.

**PROPOSED TREE WORK IN FRONT GARDEN OF 125 KING HENRYS ROAD**

Tree	Work to be carried out	Price
SILVER BIRCH (NEXT TO PILLAR)	UNSUITABLE LOCATION - FELL TO GROUND LEVEL AND POISON ROOT TO PREVENT RE- GROWTH	£160

**PROPOSED TREE WORK IN REAR GARDEN OF 123 KING HENRYS ROAD**

N/A

Tree	Work to be carried out	Price
GLEDTISIA	CROWN REDUCE BY 25% TO CONTAIN LATERAL SPREAD	£350

**WE ARE HAPPY TO OFFER A 10% REDUCTION FOR OBTAINING YOUR OWN  
COUNCIL PERMISSION.**

**Total price Excluding VAT £510**

(Prices include removal of all timber and brush arising from work carried out)

3) 125 KING HENRY'S ROAD - FRONT OF BUILDING

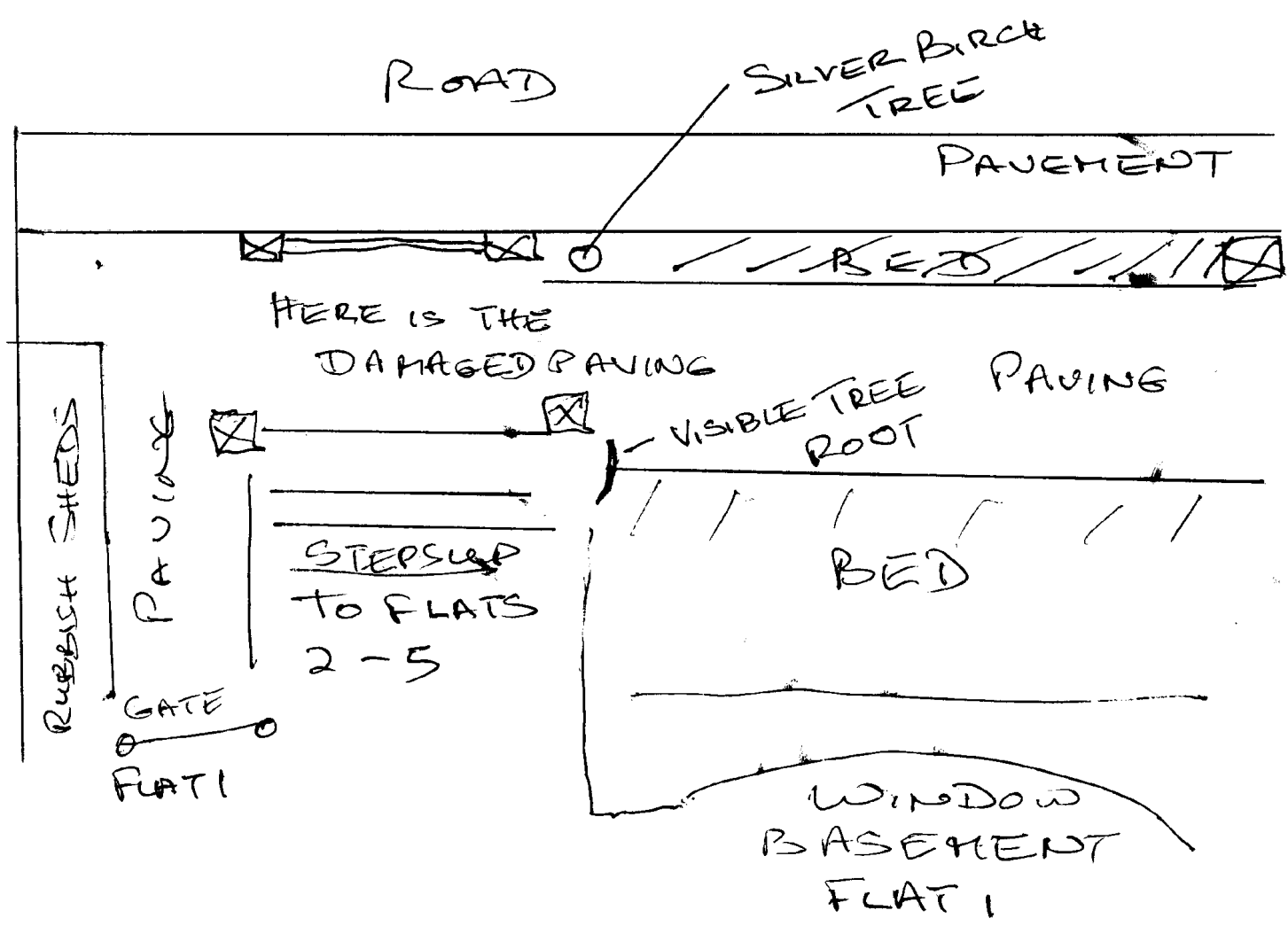

SKETCH PLAN NOT TO SCALE