

THIS DRAWING IS BASED ON DIMENSIONAL SURVEY INFORMATION PROVIDED BY AIAA INCORPORATED. THE ARCHITECT ASSUMES RESPONSIBILITY FOR THE ACCURACY OF THIS SURVEY INFORMATION. THIS DRAWING REMAINS THE COPYRIGHT OF BURRELL, FOLEY, FISCHER LLP.

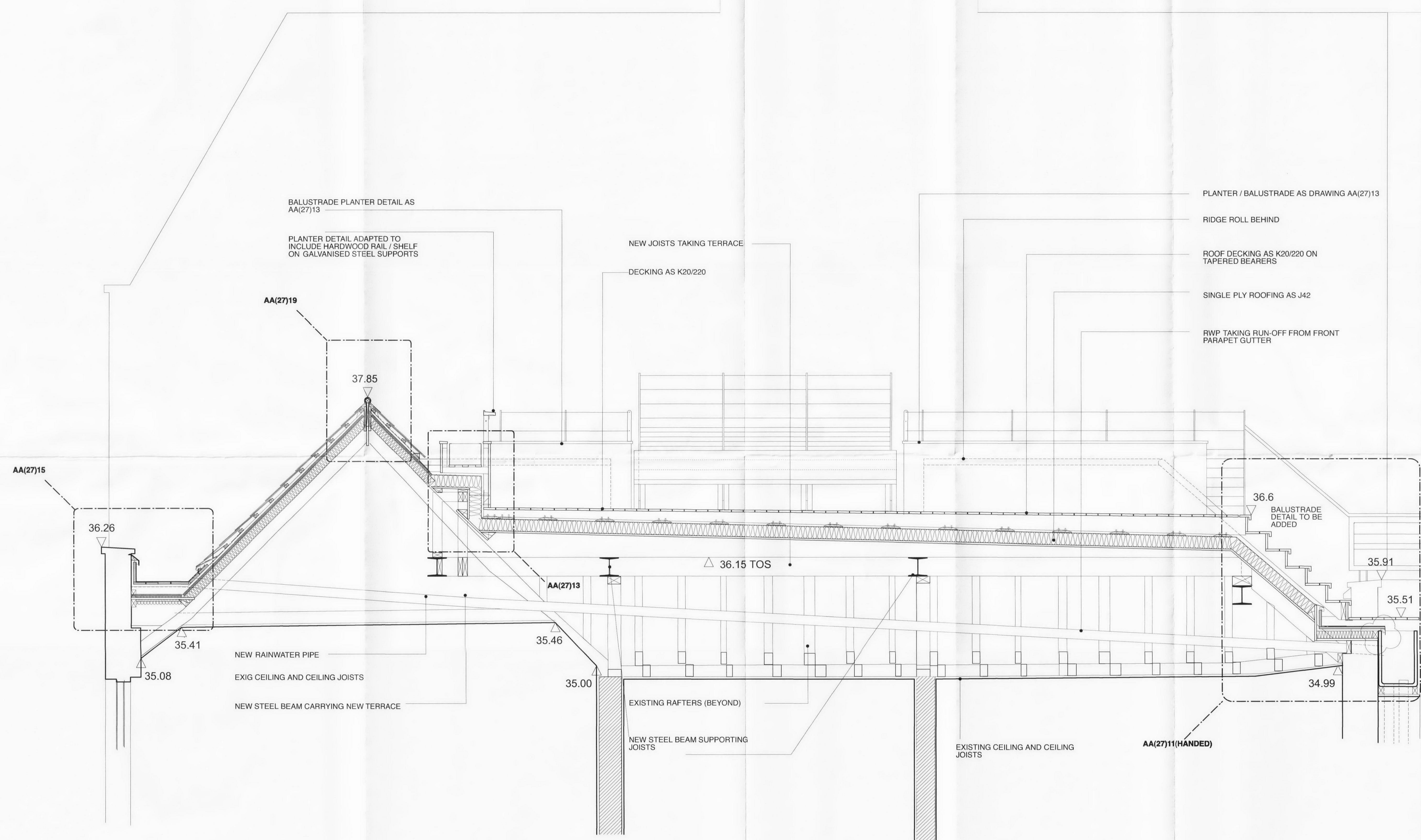

BALUSTRADE PLANTER DETAIL AS AA(27)13

PLANTER DETAIL ADAPTED TO INCLUDE HARDWOOD RAIL / SHELF ON GALVANISED STEEL SUPPORTS

NEW JOISTS TAKING TERRACE

DECKING AS K20/220

PLANTER / BALUSTRADE AS DRAWING AA(27)13

RIDGE ROLL BEHIND

ROOF DECKING AS K20/220 ON TAPERED BEARERS

SINGLE PLY ROOFING AS J42

RWP TAKING RUN-OFF FROM FRONT PARAPET GUTTER

AA(27)15

AA(27)19

AA(27)13

AA(27)11(HANDED)

NEW RAINWATER PIPE

EXISTING CEILING AND CEILING JOISTS

NEW STEEL BEAM CARRYING NEW TERRACE

EXISTING RAFTERS (BEYOND)

NEW STEEL BEAM SUPPORTING JOISTS

EXISTING CEILING AND CEILING JOISTS

BALUSTRADE DETAIL TO BE ADDED

NOTES:
The accuracy of this survey drawing is dependent upon the accuracy of the survey data provided. Check all levels on the drawing without comment.
All level values refer to the following DATUM:
East Face, South East Angle, 1-4 Wilsonton House, Newson Street, Value 22.57m.

REV NO.	REV DETAILS	BY	CHKD	DATE
TENDER				
DO NOT SCALE OFF THIS DRAWING				
BURRELL, FOLEY, FISCHER LLP				
BURRELL, FOLEY, FISCHER LLP - ARCHITECTS INC. 1000 WEST 10TH AVENUE SUITE 2000 WILSONTON, ALBERTA T4P 1L6 CANADA				
TEL: 780 773 3333 FAX: 780 773 3331 E: info@burrellfoleyfisher.com				
WWW.BURRELLFOLEYFISCHER.COM				
JOB NO.	5 LINCOLNS INN FIELDS			
FOR	PRIVATE CLIENT			
AT	5 LINCOLNS INN FIELDS			
DRAWING TITLE	LONG SECTION BB THROUGH NEW TERRACE			
DATE	27.11.10	SCALE	1:20 @ A1	
DRAWN BY	AJ	CHECKED BY	SF	
JOB NO.	BFF1019	DWG NO.	AL(27)219-220.T2	