

LEGEND

- SVP Soil vent pipe
- RWP Rainwater pipe
- RWO Rainwater outlet
- Stairs up
- ▬ Proposed work
- ▨ Make good brickwork where wall demolished
- ↔ Probable joist direction
- ↔ Assumed joist direction
- ▨ Demolition in plan/section
- ▨ Demolition in elevation
- IC Drainage inspection chamber
- ⊙ Gas meter
- ⊙ Electricity meter
- HWC Hot water cylinder

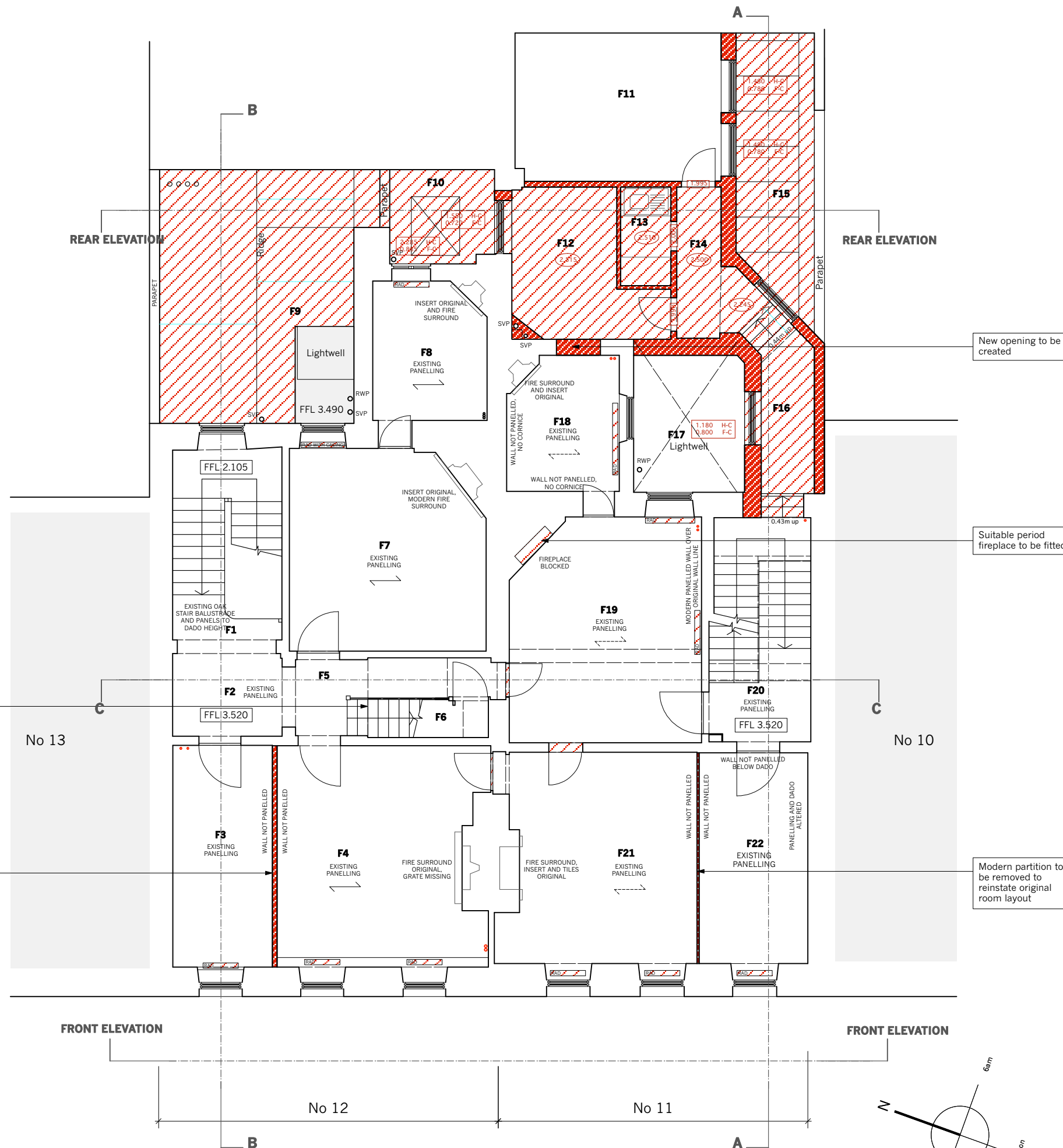

New opening to be created

Suitable period fireplace to be fitted

1920's stair to remain, new handrail and balustrade

Modern partition to be removed to reinstate original room layout

Modern partition to be removed to reinstate original room layout

MEASURED SURVEY SHOWS ALL WALLS AS PERPENDICULAR BUT IN FACT THEY ARE NOT. CHECK ALL CRITICAL DIMENSIONS AND ANGLES ON SITE.

MBA, 1 Compton Road
Wimbledon, London SW19 7QA
Phone +44 (0) 20 8946 4141
Fax +44 (0) 20 8946 2299
Email mba@marcus-beale.co.uk
www.marcus-beale.co.uk

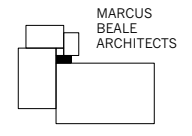

11-12 GREAT JAMES STREET	
FIRST FLOOR PLAN EXISTING	
Scale	423/ 105 P1
Date	Nov 2007

