

*Lidia Szopinska*  
47 Arlington Road, Camden  
London NW1 7ES  
mobile: 07515746267

7th February 2011

FAO: Planning Department

## Design and Access Statement

For: 47, Arlington Road, Camden, London, NW1 7ES.

The amendment for the above property, approved Planning Permission Ref: 2006/2453/P. Attached, approval and drawing 06\_20\_01B.

All access and design of build are to stay the same shape as original, with the addition of a 'Green Wall' added to the sloping side wall. These is shown on drawings:

100\_20\_220, 100\_20\_214, 100\_20\_215, 100\_20\_210, 286\_20\_400, 286\_20\_420, 286\_20\_224

With the addition of the internal staircase and the glass section on approved Ref: 2006/2453/P. Attached, approval and drawing 06\_20\_01B.

The amended planning application adds an extra 1.7m maximum to the existing approved.

This length is to correspond with the Approved lengths of extensions of neighbours at no 51 and no 53 Arlington Road. Their extensions are all 5.5m long and this will line up to create even line from viewing out of the back windows. These extensions also fall in line with no's 55 and 57 as seen on photos in following page.

The planning application for No 51 is: 2008/0271/P listed bc 2008/0274/L revision 2008/539

The planning application for No 53 is: 20076422/P listed bc 2007/6423/L

These were both completed in December 2010.

This will also allow a more comfortable size dwelling area as my extension is not full width and therefore would be cramped at 3.8m x 3.0m internal space. The walls can now be thicker to allow UV values which have increased in the last couple of years with thicker insulation and the party wall is an insulated cavity wall.

The sloping wall will now be a green wall to add to the biodiversity of the garden. The glass canopy over the house back door exit is single glazed and will help the green wall from freezing and prevent any slimy patches building up over what would otherwise be a long thin dark corridor pathway.

I have indicated the extended area with a red line to show it clearly on drawings:

286\_20\_232, 286\_20\_233, 286\_20\_225, 286\_20\_201, 286\_20\_224, 286\_20\_221

I hope this is sufficient, if you have any further questions please call me on: 0207 209 7355 or 07515746267

Lidia Szopinska



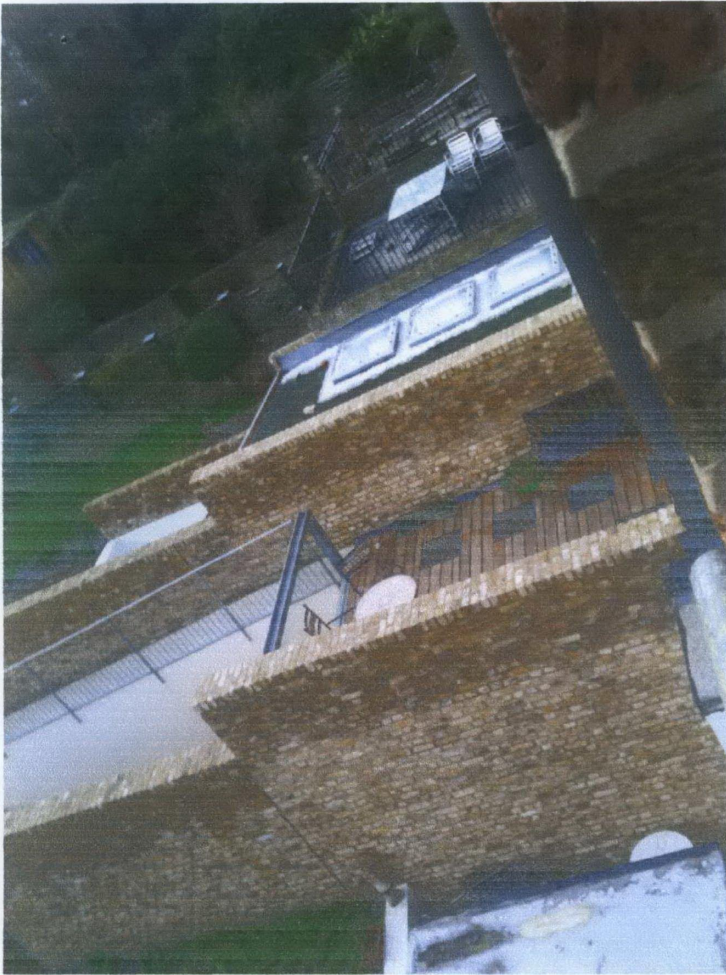

NUMBER 57

NUMBER 55

NUMBER 53

NUMBER 51

NUMBER 49

MY HOUSE NUMBER 47



View from 2nd floor level