

3 metres

Galv. ms. pergola @ 300 centres

# 1SR/107

Section CC 1:50@A4  
1 Sandy Road NW3 7EY 28/3/2011  
BRENDAN WOODS Architect  
84 Foundling Court- WC1N 1AN  
Tel: 020 7837 8208 Fax: 020 7837 8298  
Email: brendan@bw-architect.co.uk

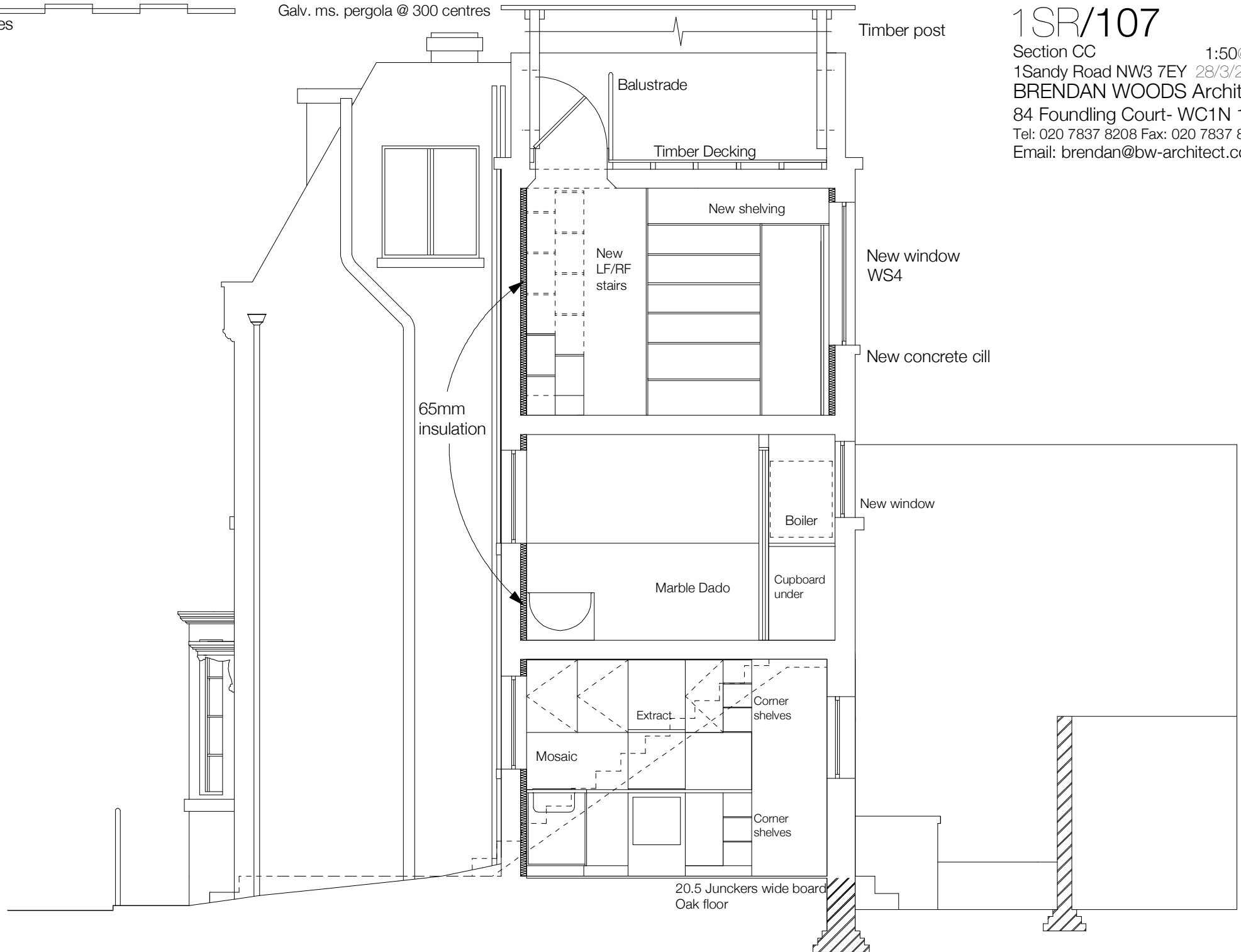

Timber post

Balustrade

Timber Decking

New shelving

New LF/RF stairs

New window WS4

New concrete cill

65mm insulation

New window

Boiler

Marble Dado

Cupboard under

Extract

Corner shelves

Mosaic

Corner shelves

20.5 Junckers wide board  
Oak floor