

**Notes**  
 Copyright remains the property of Canaway Fleming Architects and this drawing is not to be used for any purposes without the express permission of the Architect. No implied License is given for its use.

Do not scale from this drawing. All dimensions should be checked on site for accuracy.

**Planning**  
 These drawings are for Planning Purposes must not be used for any other purpose without the express permission of Canaway Fleming Architects. These are not for detailed construction purposes.

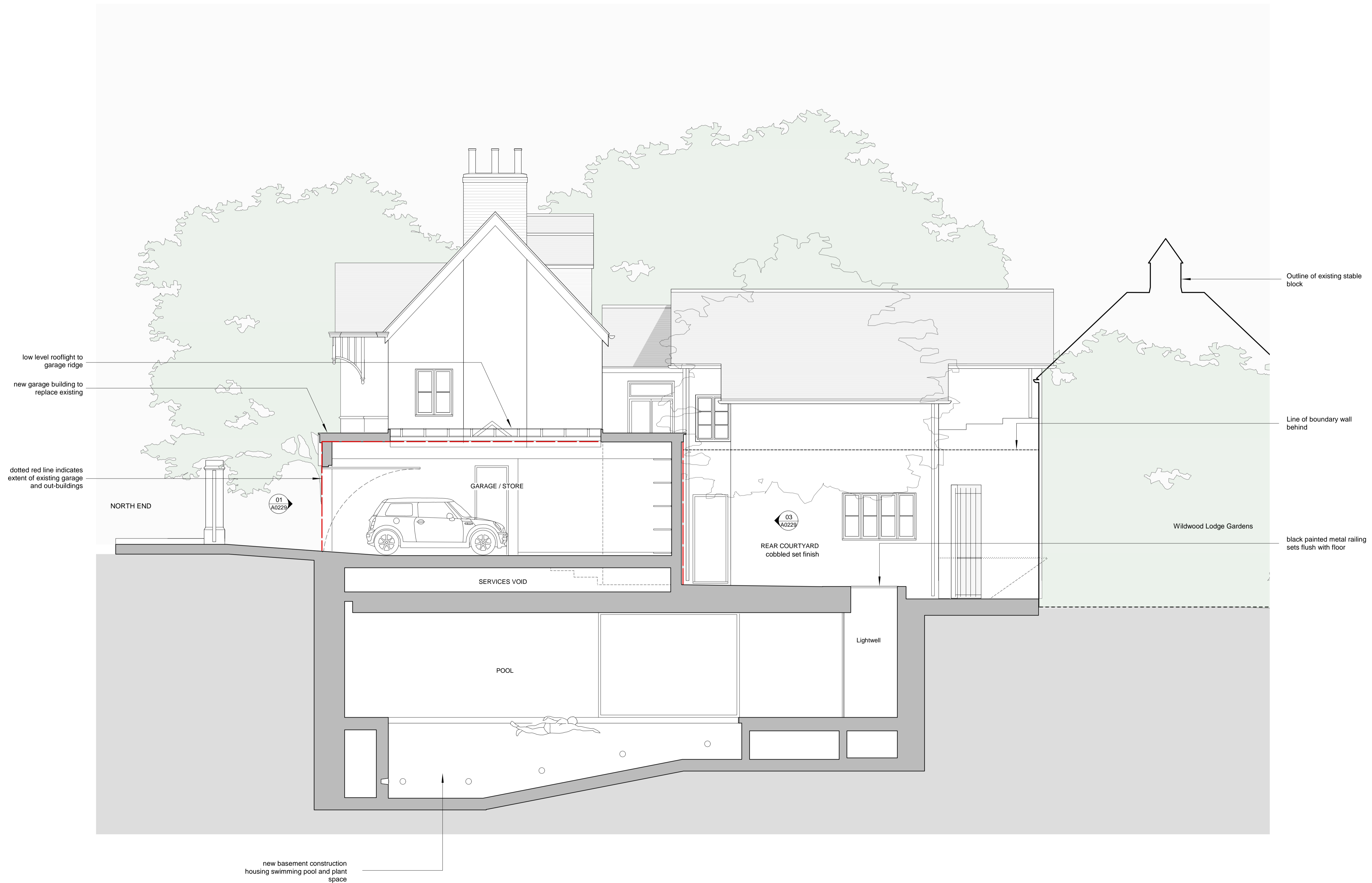

Rev. A 26.09.07 NF Garage size altered. Lightwell reduced and railings set flush with floor level  
 Revisions

**CANAWAY FLEMING ARCHITECTS**  
 Canaway Fleming Architects Ltd  
 1 Dyers Buildings  
 London EC1N 2JT  
 T: 020 7430 2262  
 F: 020 7430 2274  
 E: mailbox@canawayfleming.com

Client Mr. & Mrs. Trainer

Project Wildwood Lodge, North End  
 New Extension and Alterations

Drawing Title Basement Extension  
 Proposed Section AA

Date May 2007 Scale 1:50@A1

01 SECTION AA  
 A0224 PROPOSED 1:50

Project	Origin	No.	Revision
025	A	0224	A
Status	Planning	Drawn	AR
		Checked	MC