

**Notes**  
 Copyright remains the property of Canaway Fleming Architects and this drawing is not to be used for any purposes without the express permission of the Architect. No implied License is given for its use.

Do not scale from this drawing. All dimensions should be checked on site for accuracy.

**Planning**  
 These drawings are for Planning Purposes must not be used for any other purpose without the express permission of Canaway Fleming Architects. These are not for detailed construction purposes.

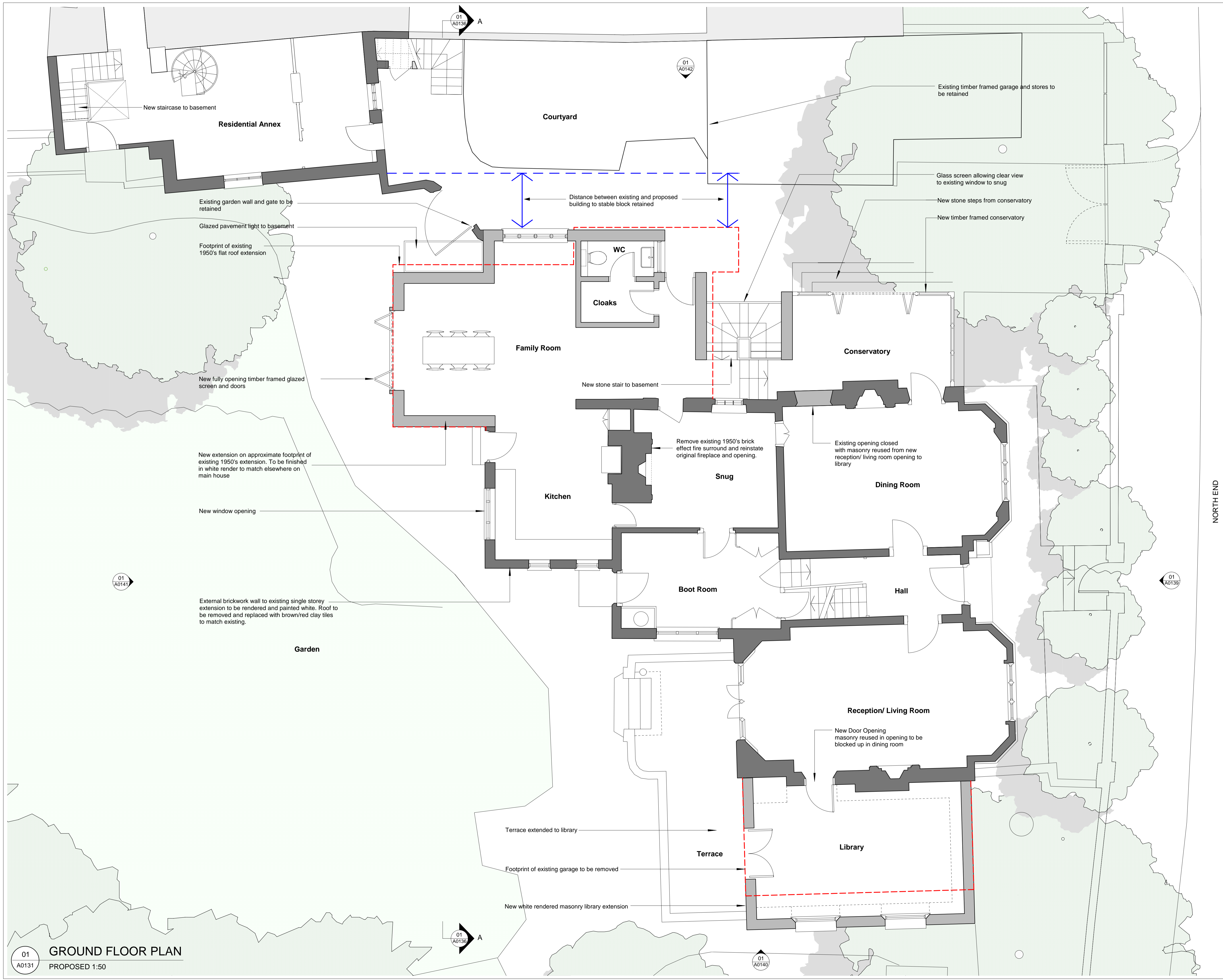

NORTH END

A - 18.07.06: Window to ground floor added as shown on elevation. Small window removed. Basement connection to stable block added.

Revisions

**CANAWAY FLEMING ARCHITECTS**

Canaway Fleming Architects Ltd  
 1 Dyers Buildings  
 London EC1N 2JT  
 T: 020 7430 2262  
 F: 020 7430 2274  
 E: mailbox@canawayfleming.com

Client: Mr. & Mrs. Trainer

Project: Wildwood Lodge, North End  
 New Extension and Alterations

Drawing Title: Proposed Ground Floor Plan

Date: July 2006 Scale: 1:50@A1

01 A0131  
**GROUND FLOOR PLAN**  
 PROPOSED 1:50

Project	Origin	No.	Revision
025	A	0131	A
Status	Drawn	Checked	MC
PLANNING	AR		