

Notes
 Copyright remains the property of Canaway Fleming Architects and this drawing is not to be used for any purposes without the express permission of the Architect. No implied License is given for its use.

Do not scale from this drawing. All dimensions should be checked on site for accuracy.

Planning
 These drawings are for Planning Purposes must not be used for any other purpose without the express permission of Canaway Fleming Architects. These are not for detailed construction purposes.

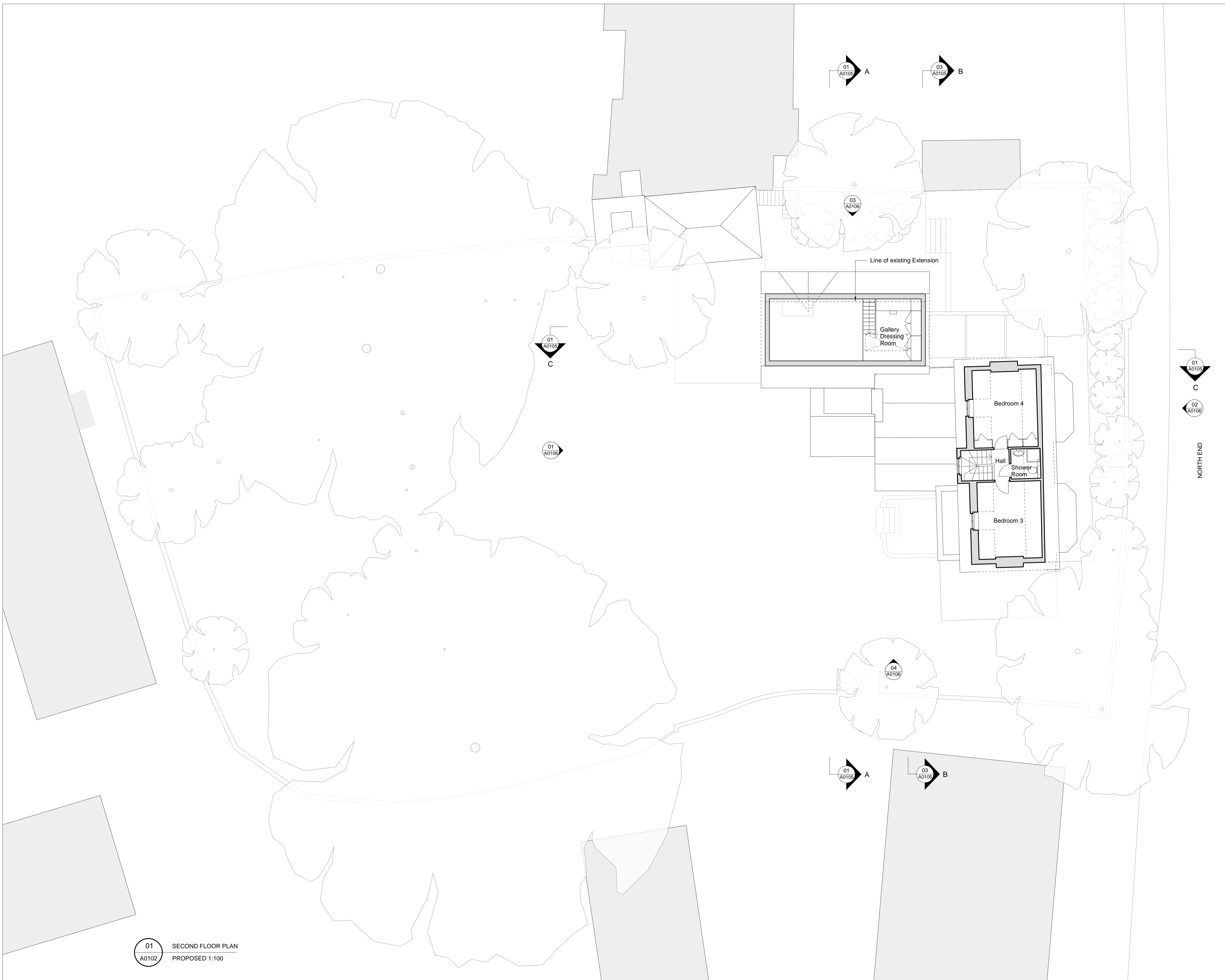

01 SECOND FLOOR PLAN
 A0102 PROPOSED 1:100

Revisions

CANAWAY FLEMING ARCHITECTS

Canaway Fleming Architects Ltd
 1 Dyers Buildings
 London EC1N 2JT
 T: 020 7430 2262
 F: 020 7430 2274
 E: mailbox@canawayfleming.com

Client Mr. & Mrs. Trainer

Project Wildwood Lodge, North End
 New Extension and Alterations

Drawing Title Proposed Second Floor Plan

Date 02.02.2006 Scale 1:100@A1
 1:200@A3

Project	Origin	No.	Revision
025	A	0102	--
Status	Drawn	Checked	
Planning	AR	MC	