

DO NOT SCALE THIS DRAWING

CONTRACTORS ARE TO CHECK ALL DIMENSIONS PRIOR TO COMMENCEMENT ON SITE AND NOTIFY THE ARCHITECT OF ANY ERRORS, OMISSIONS, OR DISCREPANCIES.

TATE & HINDLE DESIGN LIMITED RETAIN COPYRIGHT OF THIS DRAWING. IT MAY NOT BE COPIED, ALTERED OR REPRODUCED IN ANY WAY WITHOUT THEIR WRITTEN AUTHORITY.



Refer to document
8900 L01 004 Unit 09
for photographs of
existing unit

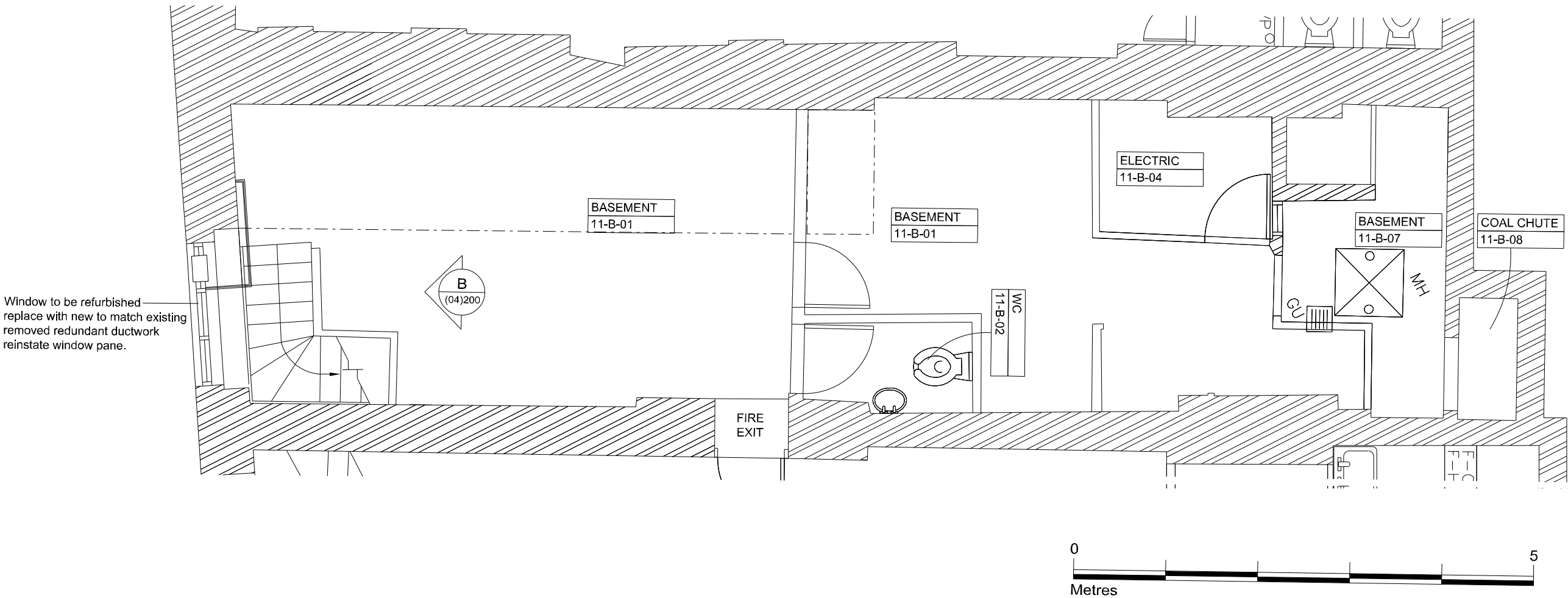

00	FIRST ISSUE	31.03.11
rev	description	date checked

status
FOR PLANNING

client
HOLBORN LINKS

project
SICILIAN AVENUE

drawing
EXISTING BASEMENT PLAN
UNIT 11
SICILIAN AVENUE

scale	drawn	checked	date
1:50@A3	OH	-	19-11-10

project no.	drg	revision
8900	(03)201	00

TATE HINDLE
ARCHITECTURE + DESIGN

1 Lindsey Street, Smithfield, London EC1A 9HP T 020 7332 4850
mail@tatehindle.co.uk www.tatehindle.co.uk F 020 7332 4888
© Tate and Hindle Design Limited