

FLOOR FRAMING PLAN

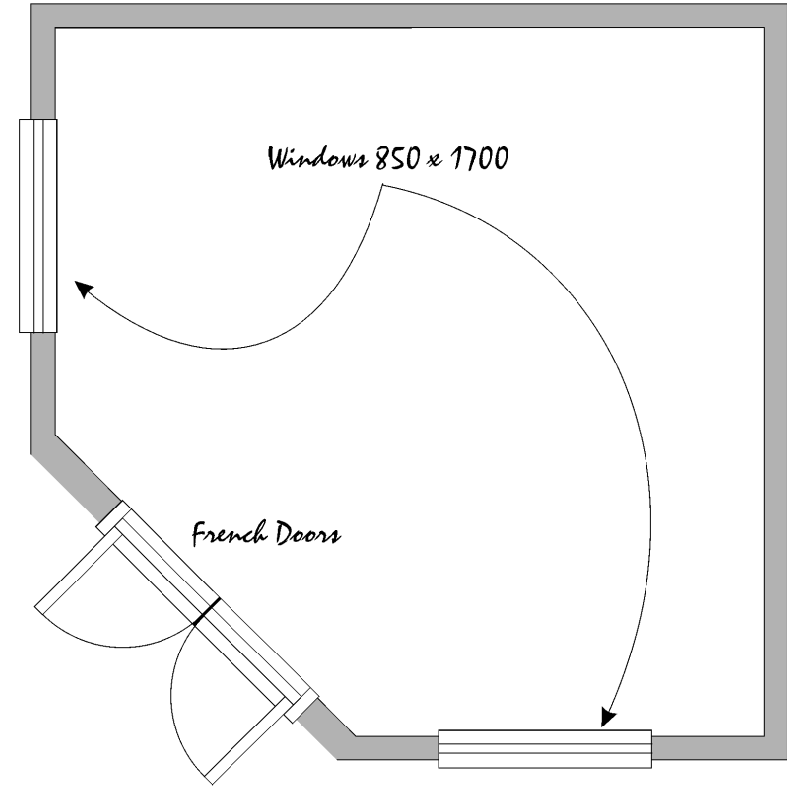

GENERAL ARRANGEMENT

Notes:

- All dimensions in millimeters
- Concrete pier Foundations down to solid bearing
- Floor edge timbers - 2 x 200 x 50 Pressure Treated
- Floor joists - 150 x 50 Pressure Treated @ 400 c/c
- Wall framing - 100 x 50 Pressure Treated @ 400 c/c
- Roof framing - 150 x 50 Pressure Treated @ 600c/c
- Roof hips - 200 x 50 Pressure Treated
- Roof board - 18mm sheathing and asphalt shingles
- Exterior finish - Pressure Treated 200 x 25 boards and 50 x 25 PT battens

Scale 1:40

Garden Studio - Floor Plan

June 2011

Maison d'etre Properties Limited

The Conifers, Down End, Hook Norton

Drg. N^o GS/BD