

Check adequacy of existing ceiling joists over head of stairs replace where necessary and board out above in 18mm T&G chipboard to form storage platform with 22mm painted MDF cupboard doors on softwood framing

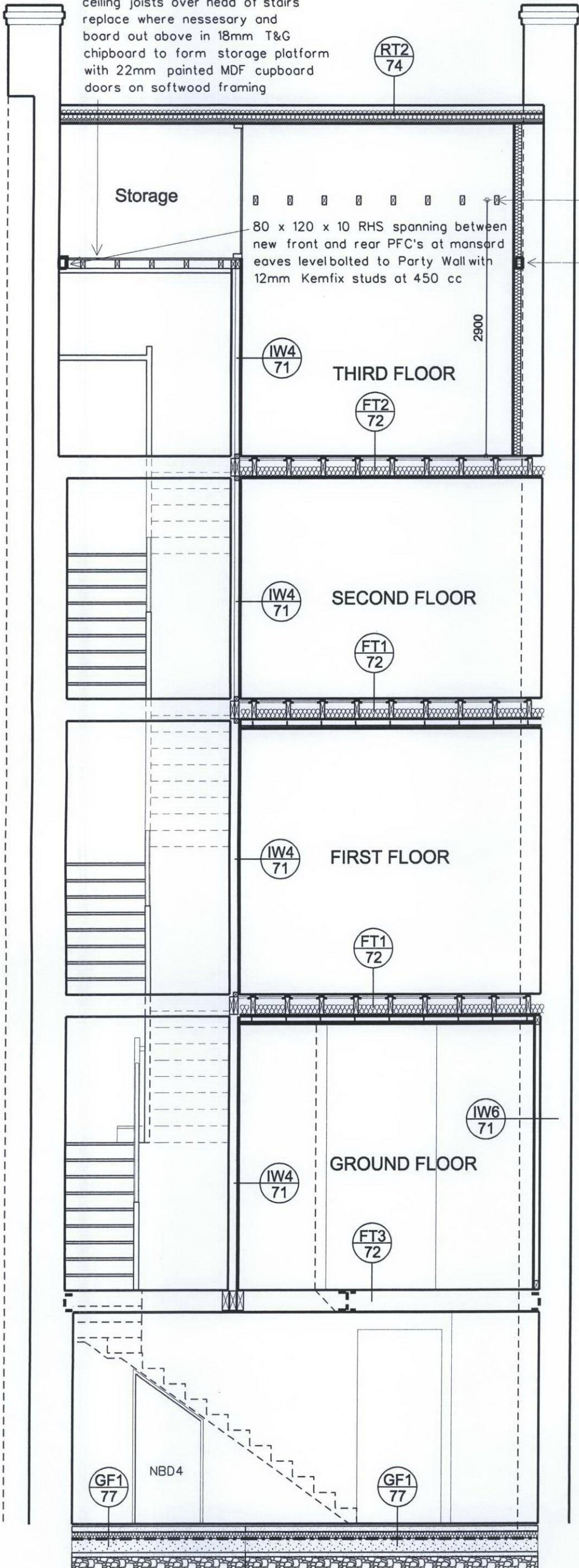

50 x 100 plained timber cosmetic collars between rafters

80 x 120 x 10 RHS's spanning from new front and rear PFC's at mansard eaves level to adjacent chimney breast inner returns across face of chimney breast hidden by new independant wall linings.

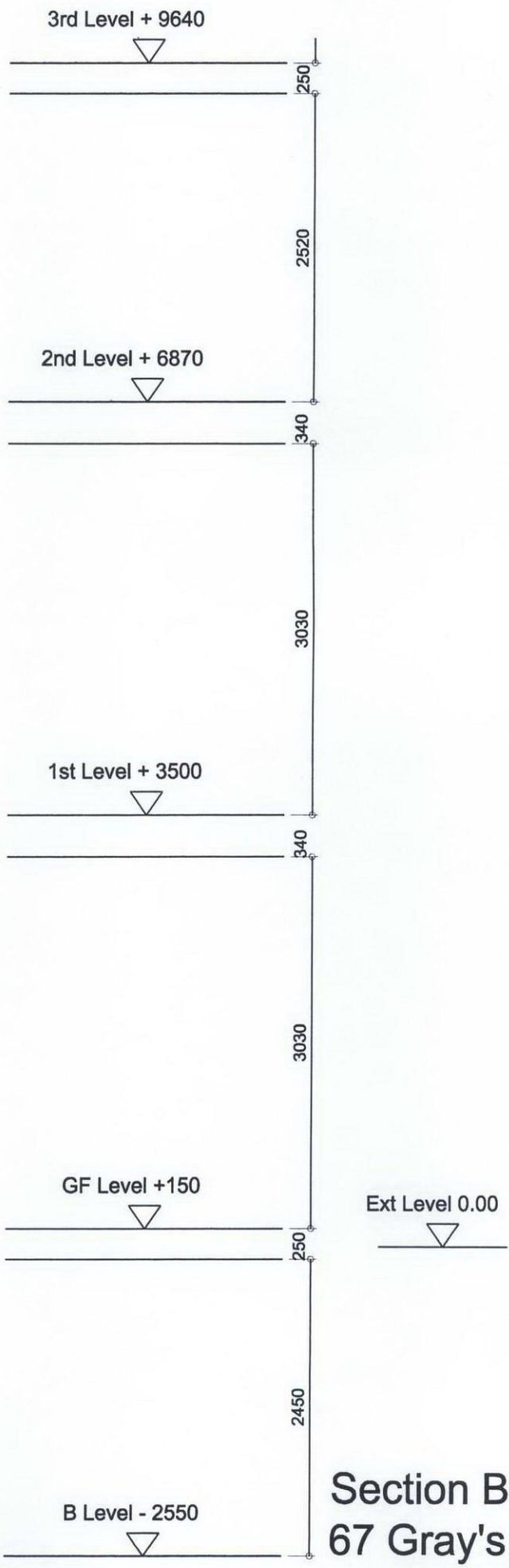

Section B
67 Gray's Inn Road
London WC1X 8TL

Section B

BRILL OWEN CHARTERED ARCHITECTS Grove House, 2B Lichfield Grove, London N3 2JP Telephone: 020 8349 0037 Fax: 020 8349 0092 E-mail: architects@brillowen.co.uk		SCALE	1:50
		DATE	DRAWN
		Nov 10	DJC
		DRG.NO.	10/725/37