

New steelbeams and padstones under new extension walls to structural engineers drawings and specification

Line stair soffits with 2 layers of 12.5mm Gyproc Fireline and skim. When soffits are exposed strengthen stairs, refix strings to wall and replace landing trimmers and supports all to structural engineers drawings and specification

1100 x 1300 plateau roof light by the roof light company triple up joists to trim opening centred above stair below

New window in revised opening with new catnic CN71A and Catnic CN5XA above. New contrastic brick arch to match existing. existing door opening infilled with matching facing brickwork fully toothed and bonded into existing

Piece in new panelling to match existing under window NWF04 where missing up to dado height

For Bathroom pod F7 layout partitions and details see drawing 66

DF01 painted with intumescent paint, Finesse acoustic, smoke and fire strips rebated in to frame sides, head and bottom of door. Door Fixed Shut

Wall between F2 and F3 upgraded to 1 hour fire rated. Carefully remove number and retain panelling from F3 side. Remove lath and plaster, denail studs and apply 2 staggered layers of 12.5mm Gyproc Fire Line and skim. Replace panelling

See kitchen enclosure joinery drawing 65 for layout and details

Box Services risers in 2 layers of 12.5mm gyproc fireline

Ground, 1st, 2nd and 3rd floor joists strengthened at every third point of span with full depth noggins as structural engineers drawings 724809/BF/P1 and SK104

All non original glazing panes in WF01 and WF02 replaced with 4mm high performance acoustic glazing

Note: No panelling is to be removed or replaced without prior written consent from the Architect and the Conservation officer. All panelling is to be restored

First Floor Construction
67 Gray's Inn Road
London WC1X 8TL

| | | | |
|--|--|----------|-----------|
| BRILL ■ OWEN CHARTERED ARCHITECTS Grove House, 2B Lichfield Grove, London N3 2JP Telephone: 020 8349 0037 Fax: 020 8349 0092 E-mail: architects@brillowen.co.uk | | SCALE | 1:50 |
| | | DATE | Nov 10 |
| | | DRG. NO. | 10/725/32 |

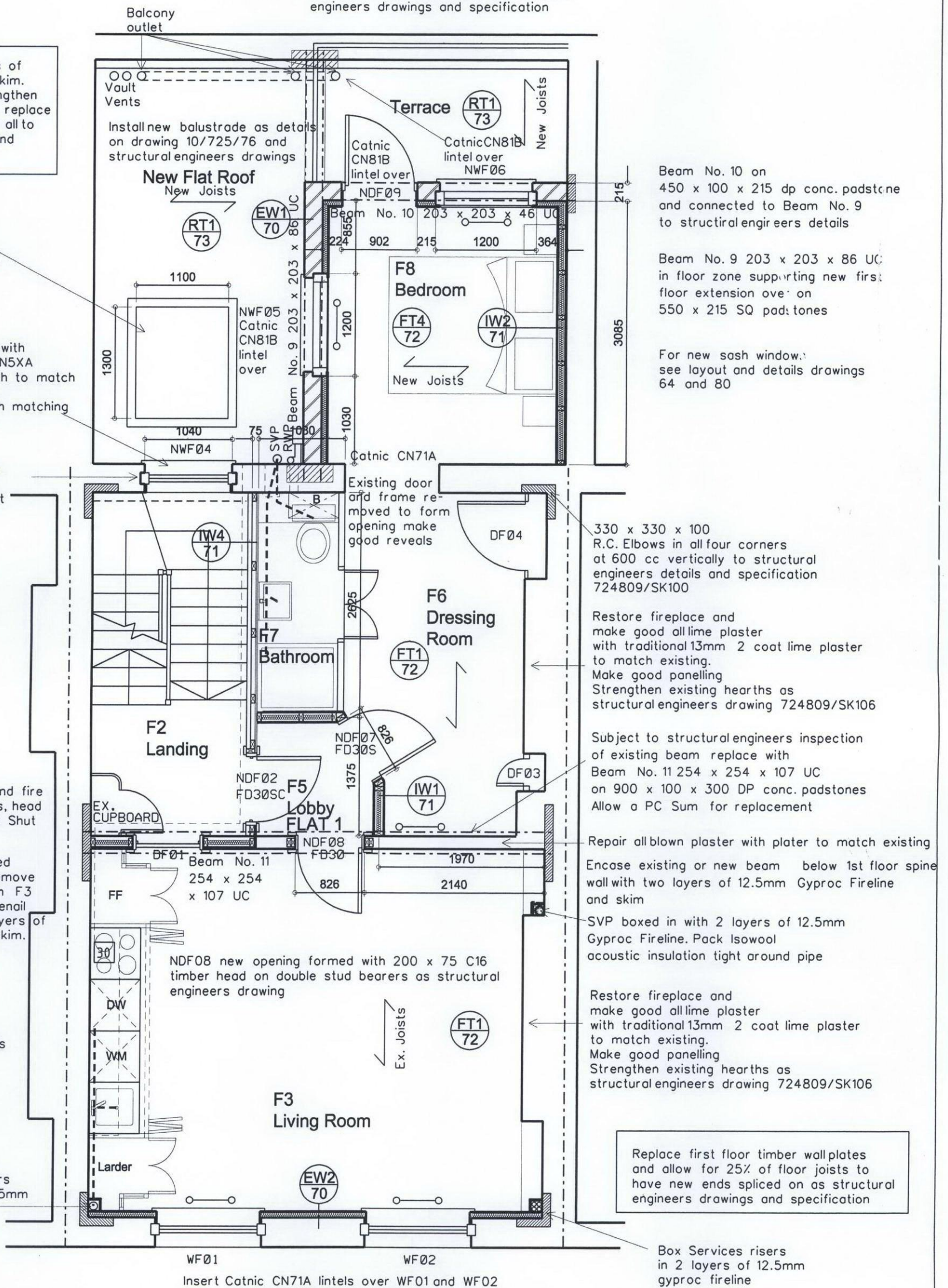

Beam No. 10 on 450 x 100 x 215 dp conc. padstone and connected to Beam No. 9 to structural engineers details

Beam No. 9 203 x 203 x 86 UC in floor zone supporting new first floor extension over on 550 x 215 SQ padstones

For new sash window: see layout and details drawings 64 and 80

330 x 330 x 100 R.C. Elbows in all four corners at 600 cc vertically to structural engineers details and specification 724809/SK100

Restore fireplace and make good all lime plaster with traditional 13mm 2 coat lime plaster to match existing. Make good panelling. Strengthen existing hearths as structural engineers drawing 724809/SK106

Subject to structural engineers inspection of existing beam replace with Beam No. 11 254 x 254 x 107 UC on 900 x 100 x 300 DP conc. padstones Allow a PC Sum for replacement

Repair all blown plaster with plater to match existing Encase existing or new beam below 1st floor spine wall with two layers of 12.5mm Gyproc Fireline and skim

SVP boxed in with 2 layers of 12.5mm Gyproc Fireline. Pack Isowool acoustic insulation tight around pipe

Restore fireplace and make good all lime plaster with traditional 13mm 2 coat lime plaster to match existing. Make good panelling. Strengthen existing hearths as structural engineers drawing 724809/SK106

Replace first floor timber wallplates and allow for 25% of floor joists to have new ends spliced on as structural engineers drawings and specification

Box Services risers in 2 layers of 12.5mm gyproc fireline