

NOTES:
 DO NOT SCALE FROM THIS DRAWING.
 ALL DIMENSIONS TO BE CHECKED ON SITE.
 ALL OMISSIONS AND DISCREPANCIES TO BE REPORTED TO THE ARCHITECT IMMEDIATELY.

ALL RIGHTS RESERVED. THIS WORK IS COPYRIGHT AND CANNOT BE REPRODUCED OR COPIED OR MODIFIED IN ANY FORM OR BY ANY MEANS, GRAPHIC ELECTRONIC OR MECHANICAL, INCLUDING PHOTOCOPYING WITHOUT THE WRITTEN PERMISSION OF SQUIRE AND PARTNERS ARCHITECTS.

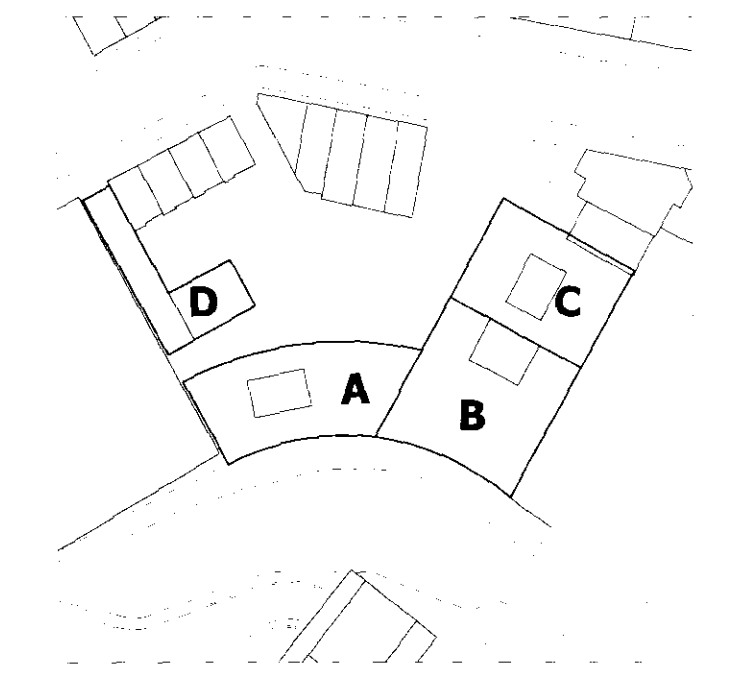

Block D

Bonny Street

Block C

Block A

Block B

Camden Road

Regents Canal

B.4.3
3 Bed
123 Sq. m

B.4.2
1 Bed
53 Sq. m

B.4.3
1 Bed
47 Sq. m

B.4.1
1 Bed
53 Sq. m

B.4.4
1 Bed
46 Sq. m

B.4.2
2 Bed
107 Sq. m

B.4.1
2 Bed
99 Sq. m

Revision description	Date	Check	Rev
Issued for Planning	21/04/11	SG	A

Squire and Partners

77 Wicklow Street London WC1X 9JY
 T: 020 7278 5555 F: 020 7239 0495
 info@squireandpartners.com
 www.squireandpartners.com

Project
 Twyman House
 London, NW1

Drawing
 Proposed Fourth Floor Plan

Drawn	Date	Scale
SG	03/03/2011	1: 125@A1 1: 250@A3
Job number	Drawing number	Revision
10003	P_04_G200_003	A