

Appendix 6: CCL Arboricultural Report Ref 08475/D

Tree Protection Plan (Proposals Overlaid)

Poorly formed, low quality laburnum trees dia 15cm

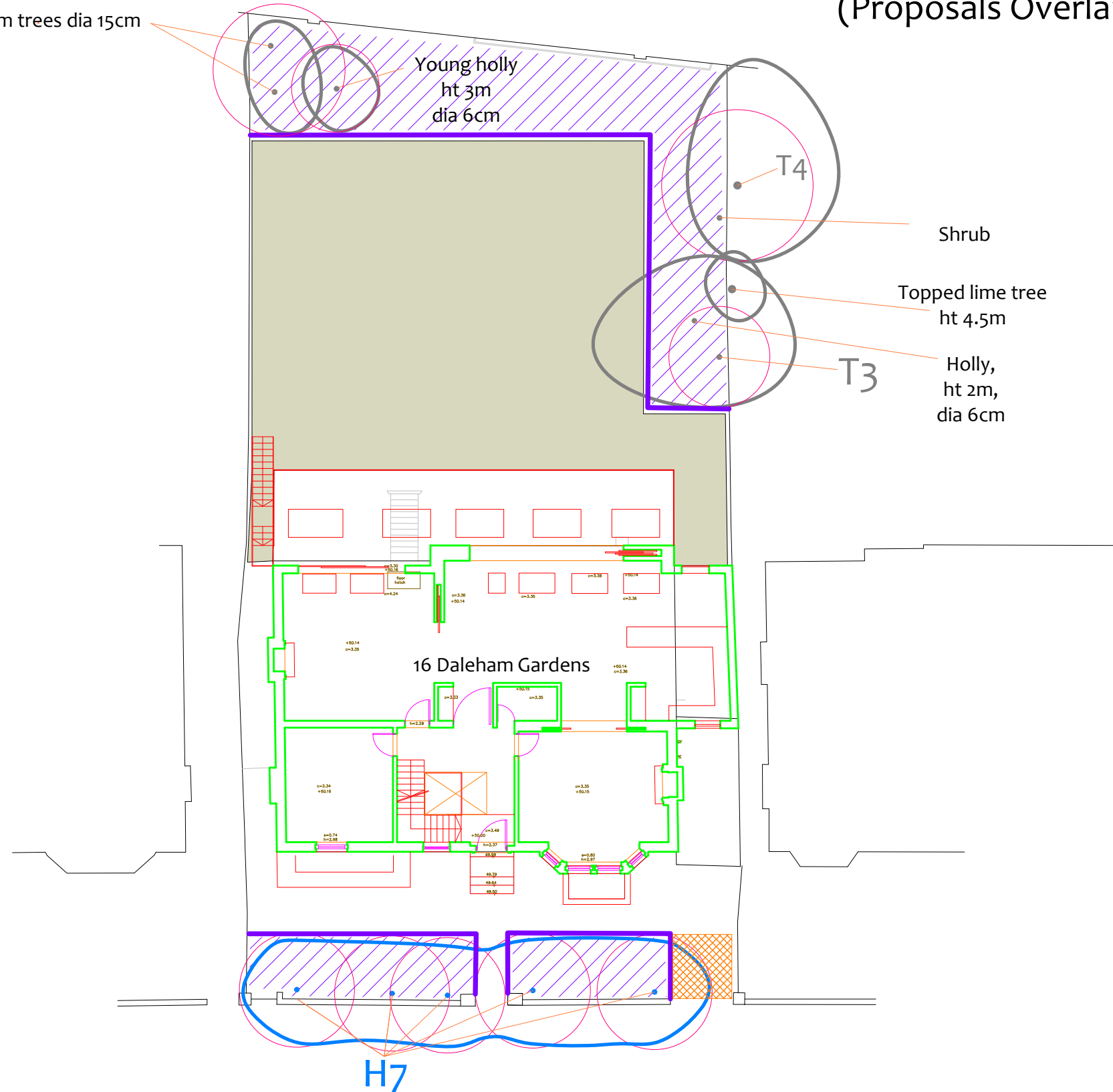

Tree Protection Fencing The 'In-Ground' System

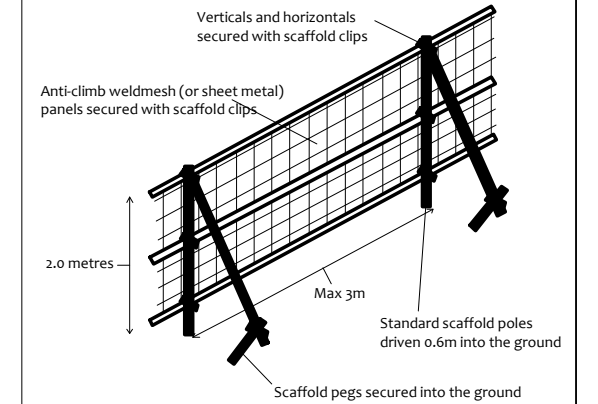

The 'Back Stay System' (an alternative to 'The In-Ground System')

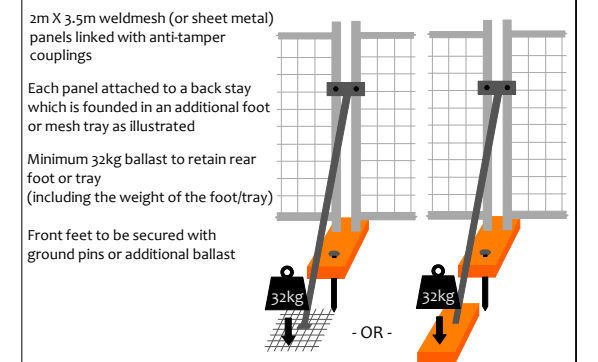

Construction Exclusion Zone

Within this area the following restrictions shall apply:

- No excavation or land regrading whatsoever.
- No storage of materials, rubble, soil or spoil.
- No fires within the exclusion zone or within 10m of any tree canopy.
- No site cabins or other temporary structures.
- No discharge of polluted water, cement or chemicals of any kind.
- No use of any machinery, or passage or parking of vehicles.
- No tree works without council consent.

Restricted Activity Zone

Within this zone construction activity is restricted. Restrictions are detailed within the accompanying Method Statement Report (Section 5.10)

Dedicated Mixing and Cleaning Area

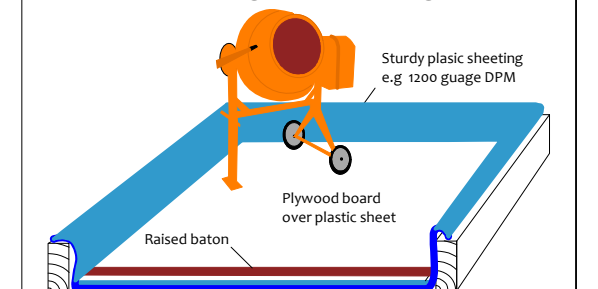

Site:
16 Daleham Gardens

Ref No: 08475/TPP
Scale: 1:200
Paper Size: A3

- BS 5837 Root Protection Area
- T1 Tree number 1
- G2 Group number 2
- H3 Hedge number 3

- Stem & canopy of Category A tree
- Stem & canopy of Category B tree
- Stem & canopy of Category C tree
- Stem & canopy of Category R tree

- Fixed protective fencing The 'In-Ground System' or the 'Backstay System' To remain in place for all construction activity
- Restricted Activity Zone
- Construction Exclusion Zones

