

Basement Floor Plan

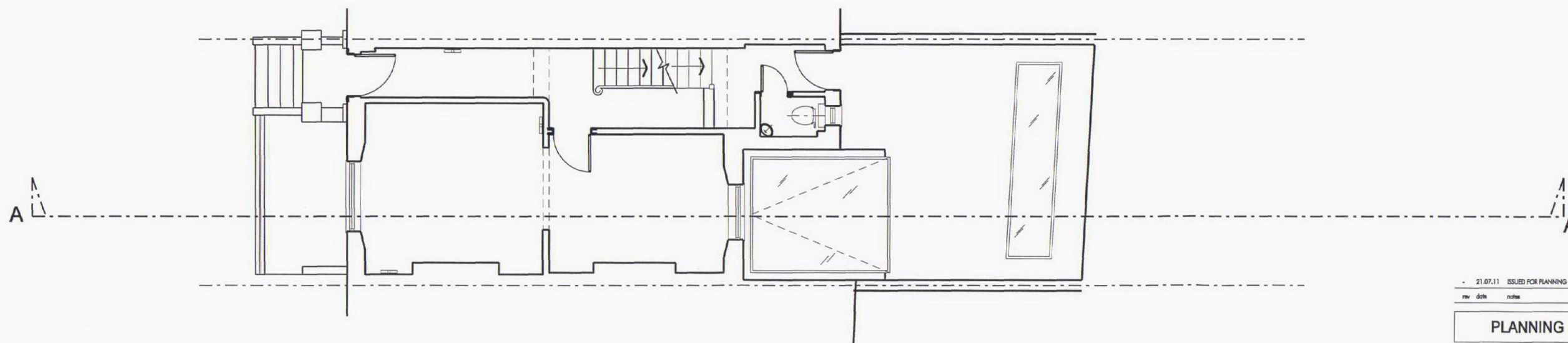

Ground Floor Plan

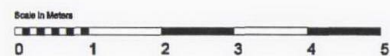

21.07.11	ISSUED FOR PLANNING	CH	NW
rev	date	note	drawn by checked by

**PLANNING ISSUE**

**AndArchitects**

16 Manselville Courtyard, 142 Battersea Park Road, London SW11 4NB  
 tel: +44 (0) 20 7720 5999 email: mail@andarchitects.co.uk

client Mr & Mrs Gillam

project 12 Chamberlain Street  
 NW1 8XB

drawing title Proposed Basement & Ground  
 Floor Plan - Planning No2

date June 2011 scale 1:50 @ A1  
 1:100 @ A3

drawing number 346 PL(2)102 revision -

All drawings must be checked on site and any discrepancies reported to the architect before any work commences. DO NOT SCALE from this drawing. This drawing is the copyright of AND Architects Ltd and may not be copied or printed without express written permission from AND Architects Ltd