

**Notes**  
Copyright remains the property of Canaway Fleming Architects and this drawing is not to be used for any purposes without the express permission of the Architect. No implied License is given for its use.

Do not scale from this drawing. All dimensions should be checked on site for accuracy.

**Planning**  
These drawings are for planning application and must not be used for any other purpose without the express permission of Canaway Fleming Architects. These are not for detailed construction purposes.

**Structural Work**  
All indications as to structure are for graphic purposes only and must not be relied upon for accuracy in terms of size, detail or position. All structure and temporary propping to be confirmed by a suitably qualified structural engineer before beginning works.

**Mechanical & Engineering Work**  
All indications as to M&E items are for graphic purposes only and must not be relied upon for accuracy in terms of size, detail or position. All M&E items to be confirmed by a suitably qualified M&E engineer before beginning works.

**Survey Information**  
This survey has been carried out and drawn by Plowman Craven in October 2010.

- KEY**
- CO: None    Cornice Type: (No.)
  - DR: None    Dado Type: (No.)
  - SK: 000    Skirting Type: (No.)
  - AR: 000    Architrave Type: (No.)
  - D1    Door Reference: (No)
  - DN1    New/Replacement Door Reference: (No)
  - WB 1    Window Reference: (Level: No)
  - WB N1    New/Replacement Window Reference: (Level: No)
  - Denotes areas of fabric damaged by water ingress.
  - Denotes areas of ceiling damaged by water ingress.
  - Denotes approximate location of cracks
  - Denotes removal of existing elements
  - Removal of existing elements as currently approved (application ref.: 2011/1073/P, 2011/1075/L)

Refer to drawing 064/A/0425 for architectural details (types)

Revisions

**CANAWAY FLEMING ARCHITECTS**

Canaway Fleming Architects Ltd  
The Dutch House  
307 - 308 High Holborn  
London WC1V 7LL  
T: 020 7430 2262  
F: 020 7430 2274  
E: mailbox@canawayfleming.com

Client    Holborn Links Limited.

Project    16-19 Southampton Place, London.

Drawing Title    No.17 SP  
Proposed Basement Plan  
WC B08-1

Date    July 2011    Scale    1:20@A1

Project	Origin	No.	Revision
064	A	0505	-
Status	Drawn	Checked	
PLANNING	MN	MC	

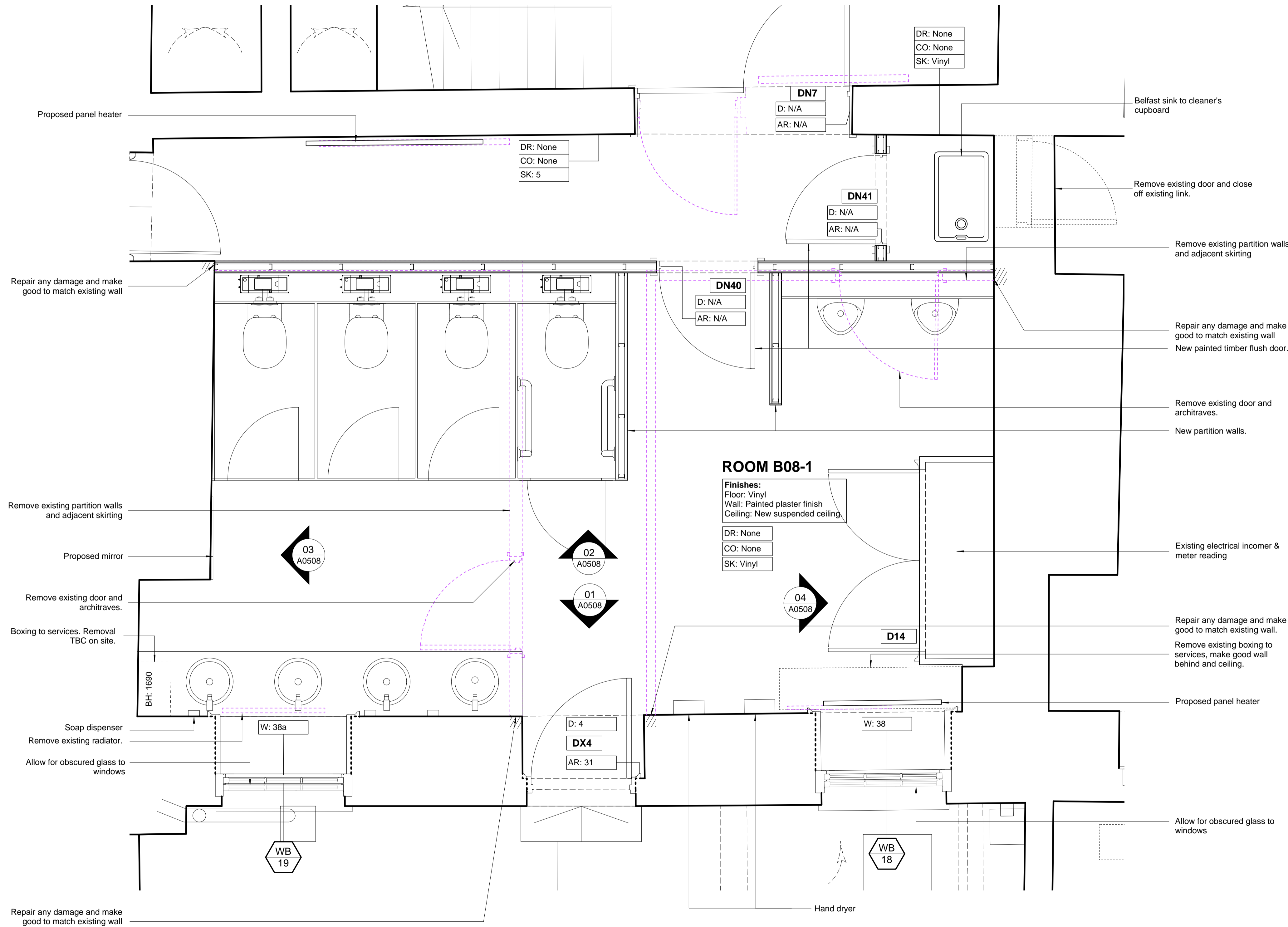

01 NO.17 SP BASEMENT FLOOR PLAN ROOM B08-1  
A0505 PROPOSED 1:20