

Plotted 11/10/2011
Filename: L:\Projects\4250_etc\4280\CAD\Plot\20_GA_20_503.dgn

SHEPPARDROBSON

ARCHITECTURE URBAN DESIGN PLANNING INTERIORS



LOCATION 77 PARKWAY . CAMDEN TOWN
LONDON . NW1 7PU
PHONE +44 0 20 7504 1700
FAX +44 0 20 7504 1701
WEBSITE www.sheppardrobson.com
E-MAIL sr.mail@sheppardrobson.com

HARDWICKE
NEW AQUARE
LINCOLN'S INN
WC2A 3SB

DRAWING NO. 4280 -20-503 REV. -

DRAWING	GROUND FLOOR PROPOSED ENLARGED PLAN	SCALE @ A3	1:50
NOTES	EXISTING ELEVATION AND PLAN SUPPLIED BY WEIGHTMAN & BULLEN EXISTING STONE PANELS TO BE REPLACED WITH FULLY, DOUBLE GLAZED SCREEN WITH MASTERED JOINTS. THE PROPOSED CHANGE WILL ALLOW NATURAL LIGHT INTO THE RECEPTION (MAIN CLIENT FACING) AND BECOME MORE SPACE EFFICIENT. THE PROPOSED SCREEN DOES NOT AFFECT THE STRUCTURAL FABRIC OF THE BUILDING. THERE WILL BE NO VISUAL IMPACT ON LINCOLNS INN.	DATE	10.10.2011
		ORIGINATED BY	RG
		CHECKED BY	LH
		AUTHORISED BY	RM
		STATUS	PLANNING

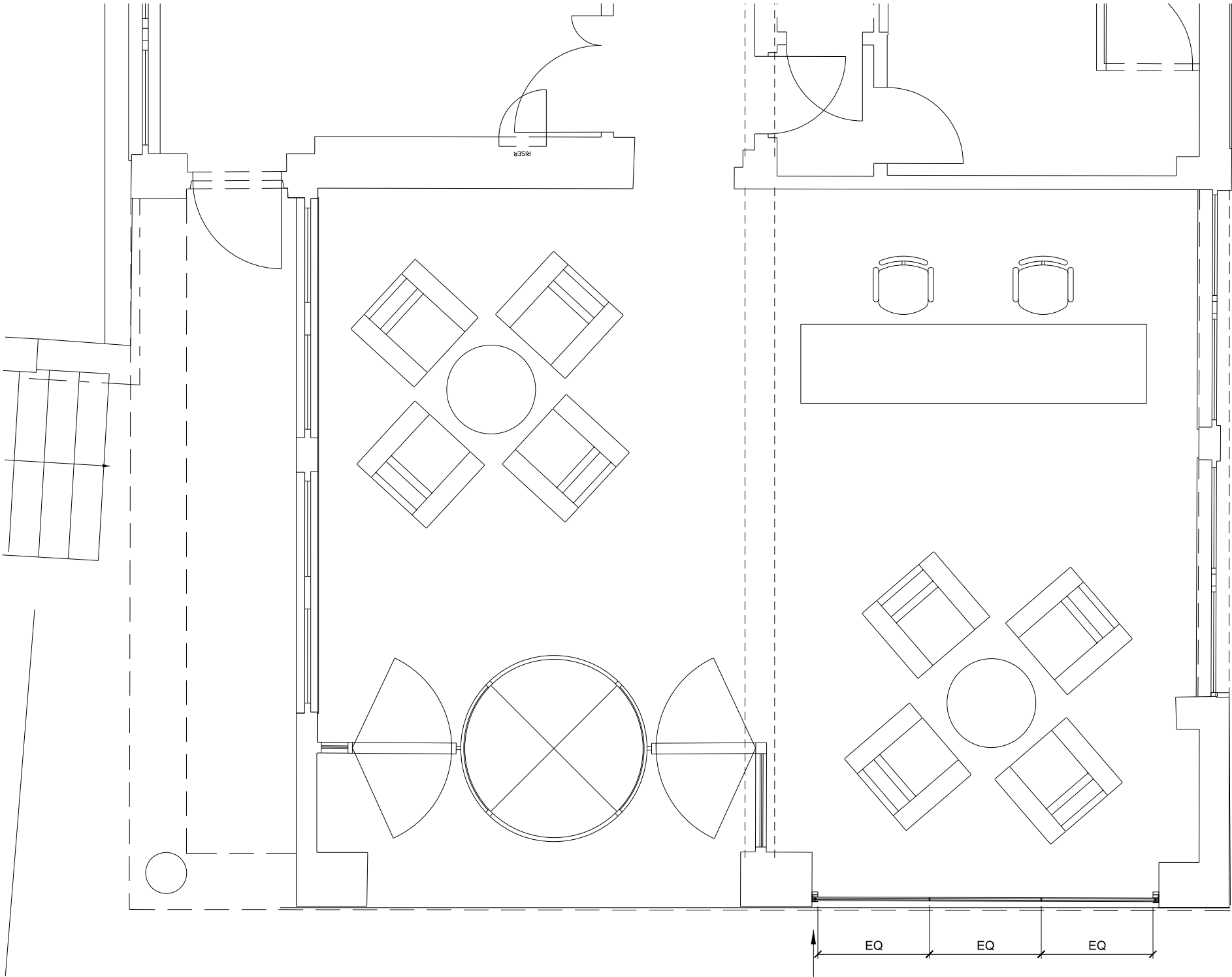
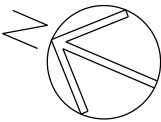

NEW FULL HEIGHT DOUBLE GLAZED SCREEN WITH 50MM
STAINLESS STEEL PERIMETER FRAMEWORK TO MATCH EXISTING.
SURROUNDING NATURAL EXISTING STONE TO BE CAREFULLY
RETAINED.
MANIFESTATION WILL BE APPLIED TO THE GLAZING



© COPYRIGHT

The copyright in this drawing is vested in Sheppard Robson and no licence or assignment of any kind has been, or is, granted to any third party whether by provision of copies or originals of the drawings or otherwise unless otherwise agreed in writing.

DO NOT SCALE FROM THIS DRAWING

The contractor shall check and verify all dimensions on site and report any discrepancies in writing to Sheppard Robson before proceeding with work.

FOR ELECTRONIC DATA ISSUE

Electronic data / drawings are issued as "read only" and should not be interrogated for measurement. All dimensions and levels should be read, only from those values stated in text, on the drawing.